

P- 22332/10

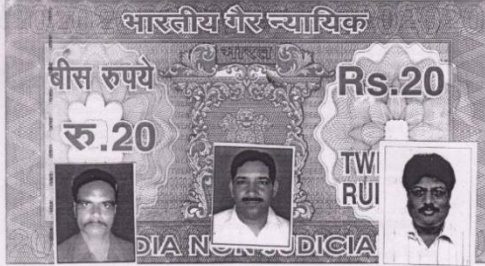

उत्तर प्रदेश UTTAR PRADESH

Jeenu - Deed

11AA 786268

Stamp Duty Paid in Cash Certificate in favour of
 In Presence of the Signature
 No. 11AA 786268 of the Stamp Duty and
 section 10-A of the Stamp Act is certified that
 an amount of Rs. 20.00 has been paid in
 full of the Stamp Duty on the Deed
 of the Jeenu - Deed dated 27/9/2010
 by Mr. Jeenu - Deed in favour of
 a Copy of which is annexed hereto.

M/s JKG Construction Pvt Ltd.
B-174, Yagna Vihar, Delhi
Rs. 20.00 are cash number 100 to be paid on
only
Dr. Jeenu - Deed
27/9/10 27/9/2010
Signature
Dr. Jeenu - Deed
27/9/2010
Signature
Dr. Jeenu - Deed

Signature
Dr. Jeenu - Deed
27/9/2010

For JKG CONSTRUCTION PVT. LTD.
Signature
 DIRECTOR

LEASE DEED

This Lease Deed made on 18th day of OCTOBER 2010 between the GREATER NOIDA INDUSTRIAL DEVELOPMENT AUTHORITY, a body corporate constituted under Section 3 read with 2 (d) of the Uttar Pradesh Industrial Area Development Act, 1976 (U.P. Act No. 6 of 1976 hereinafter called the Lessor which expression shall unless the context does not so admit, include its successors, assigns) of the One Part and M/s JKG CONSTRUCTION PVT.LTD., a company within the meaning of Companies Act, 1956, having its registered office at B-174, Yojna Vihar, Delhi-110092 through its Director Mr. J.K. Goel S/o Shri N.L. Goel R/o B-174, Yojna Vihar, Delhi-110092 duly authorized by its Board of Directors vide Resolution dated 14th June 2010 (hereinafter called the Lessee which expression shall unless the context does not so admit, include its representatives, administrators and permitted assigns of the Other Part.)

WHEREAS the plot hereinafter described forms part of the land acquired under the Land Acquisition Act 1994 and developed by the Lessor for the purpose of setting up an urban and industrial township.

AND WHEREAS the Lessor has agreed to demise and the Lessee has agreed to take on lease the plot on the terms and conditions hereinafter appearing for the purpose of constructing Residential Flats and/or Plots according to the set backs and building plan approved by the Lessor.

AND WHEREAS the Lessor has through a Sealed Two-Bid tender System awarded to the CONSORTIUM CONSISTING OF -

- M/s Exotica Housing & Infrastructure Company Pvt.Ltd. – Lead Member
- M/s JNC Constructions Pvt.Ltd. – Relevant Member
- M/s JKG Construction Pvt.Ltd. – Relevant Member
- M/s Radicon Infrastructure & Housing Pvt.Ltd. – Relevant Member
- M/s Jyoti Super Construction & Housing Pvt.Ltd. – Relevant Member
- M/s Gulshan Home Pvt.Ltd. – Relevant Member

the plot NO. GH-01 SECTOR-16C, GREATER NOIDA, Area 100000.00 sq.m. (Actual Area as per lease plan is 101593.00 square metre) after fulfilling the terms and conditions prescribed in the brochure and its corrigendum, if any, vide Reservation/Acceptance Letter No.PROP/BRS-02/2010/1470 dated 30.03.2010 and Allotment Letter No.PROP/BRS-02/2010/1514 dated 29.04.2010 and for the development and marketing of Group Housing Pockets/ Flats/Plots (in case of plotted development) on the detailed terms and conditions set out in the said allotment letter and brochure of the said Scheme.

The consortium consists of following :-

S.No.	Name of member	Shareholding	Status
1.	M/s Exotica Housing & Infrastructure Company Pvt.Ltd.	36%	Lead Member
2.	M/s JNC Constructions Pvt.Ltd.	17%	Relevant Member
3.	M/s JKG Construction Pvt.Ltd.	17%	Relevant Member

LESSOR

जयकांत गोयल
देव शीला अधिकारी

LESSEE

J.K. GOEL
DIRECTOR

4.	M/s Radicon Infrastructure & Housing Pvt.Ltd.	10%	Relevant Member
5.	M/s Jyotiper Construction & Housing Pvt.Ltd.	10%	Relevant Member
6.	M/s Gulshan Homz Pvt. Ltd.	10%	Relevant Member

Whereas the above registered consortium who jointly qualify for the bid and secured the allotment of said plot being highest bidder. They through its lead member M/s Exotica Housing & Infrastructure Company Pvt.Ltd. has approached to the lessor in accordance with the clause C-8 of the brochure/bid document of the scheme to sub-divide the said plot of land with the following status of holding lease rights:-

Sl.No.	Group Housing Plot No.	Sector	Sub Divided area as per Lease Plan (in sq.m.)	Name of member	Status
1.	01A	16C	40657.50	M/s Exotica Housing & Infrastructure Projects Pvt.Ltd. (An SPC of M/s Exotica Housing & Infrastructure Company Pvt.Ltd. & M/s Gulshan Homz Private Limited	SPC
2.	01B	16C	20005.50	M/s Jyotimay Infracon Pvt.Ltd. (An SPC of M/s Radicon Infrastructure & Housing (P) Ltd. and M/s Jyotiper Construction & Housing Pvt.Ltd.	SPC
3.	01C	16C	20015.90	M/s JNC Constructions Pvt.Ltd.	Relevant Member
4.	01D	16C	20914.10	M/s JKG Construction Pvt.Ltd.	Relevant Member

Whereas the said registered consortium has given an undertaking dated 07-09-2010 (Copy annexed as Annexure A to this Lease Deed) to indemnify the lessor which shall be part of this lease deed and shall in no way exonerate from their liability to perform and pay as per the terms of allotment till all the payments are made to the lessor.

Whereas the lessor approved aforesaid sub-division and the name and status of **M/s JKG Construction Pvt.Ltd.**, on the request of consortium in accordance with the Clause C-8(e) of the brochure/bid document of the scheme, to develop and market the project on demarcated/sub divided Group Housing plot No. 01D, Sector 16C, Greater Noida measuring 20914.10 square metre vide letter No. Builders/2010/BRS-72/29 dated 07th September 2010

प्रधान निदेशक
देवर भूखण्ड अधिकार
LESSOR

2

LESSEE

For JKG CONSTRUCTION PVT. LTD.
DIRECTOR

AND it has been represented to the lessor that the Consortium member have agreed amongst themselves that M/s JKG Construction Pvt.Ltd. shall solely develop the project on the demarcated/sub-divided Builders Residential/Group Housing Plot No. 01D, Sector-16C, Greater Noida measuring an area 20914.10 square metre. and lessee shareholding in the Company shall remain unchanged till the occupancy/ completion certificate of at least one phase of the project is obtained from the Lessor. However, the Lessee will be allowed to Transfer/Sell up to 49% of its shareholding, subject to the conditions that the original Shareholders as indicated above (on the date of submission of the tender) shall continue to hold at least 51% of the shareholding till the temporary occupancy/ completion certificate of at least one phase of the project is obtained from the Lessor.

And it has been represented to the lessor that the CONSORTIUM member have agreed amongst themselves that M/s JKG Construction Pvt.Ltd. having its registered office at B-174, Yojna Vihar, Delhi-110092 shall solely develop the project on the demarcated Builders Residential/Group Housing Plot No. 01D, Sector 16C, Greater Noida measuring an area 20914.10 sqm.

II. NOW THIS LEASE DEED WITNESSETH AS FOLLOWS:-

1. This in consideration of the total proportionate premium of 20914.10 Sq.m. sub divided area is Rs. 21,47,87,910.00 (Rs. Twenty One Crore Forty Seven Lac Eighty Seven Thousand Nine Hundred Ten only) out of which Rs. 3,09,89,910.00 (Rupees Three Crore Nine Lac Eighty Nine Thousand Nine Hundred Ten only) which have been paid by the Lessee to the Lessor (the receipt where of the Lessor doth hereby acknowledge). There shall be moratorium of 24 months from the date of allotment and only the interest @ 12% per annum compounded half yearly , accrued during the moratorium period, shall be payable in equal half yearly instalments. After expiry of moratorium period, the balance approx. 90% premium i.e. Rs. 18,37,98,000.00 (Rs. Eighteen Crore Thirty Seven Lac Ninety Eight Thousand only) of the plot along with interest will be paid in 16 half yearly instalments in the following manner :-

Head	PAYMENT PLAN		Interest	Total	bal prop 90% prem (proportionate)	183798000 balance premium
	Due date	Premium				
Instalment No.1	29.10.2010	-	11,027,880	11,027,880	-	183,798,000
Instalment No.2	29.04.2011	-	11,027,880	11,027,880	-	183,798,000
Instalment No.3	29.10.2011	-	11,027,880	11,027,880	-	183,798,000
Instalment No.4	29.04.2012	-	11,027,880	11,027,880	-	183,798,000
Instalment No.5	29.10.2012	11,487,376	11,027,880	22,515,256	-	172,310,625
Instalment No.6	29.04.2013	11,487,376	10,338,638	21,826,013	-	160,823,250
Instalment No.7	29.10.2013	11,487,376	9,649,395	21,136,770	-	149,335,876

LESSOR

 सहायक निदेशक
 बचत निधि संस्थान

3

For JKG CONSTRUCTION PVT. LTD.

 DIRECTOR

Instalment No. 8	29.04.2014	11,487,375	8,960,153	20,447,528	137,848,500
Instalment No. 9	29.10.2014	11,487,375	8,270,910	19,768,285	128,361,125
Instalment No. 10	29.04.2015	11,487,375	7,581,668	19,089,043	114,873,750
Instalment No. 11	29.10.2015	11,487,375	6,892,425	18,379,800	103,386,375
Instalment No. 12	29.04.2016	11,487,375	6,203,183	17,690,558	91,899,000
Instalment No. 13	29.10.2016	11,487,375	5,513,940	17,001,315	80,411,625
Instalment No. 14	29.04.2017	11,487,375	4,824,698	16,312,073	68,924,250
Instalment No. 15	29.10.2017	11,487,375	4,135,455	15,622,830	57,436,875
Instalment No. 16	29.04.2018	11,487,375	3,446,213	14,933,588	45,949,500
Instalment No. 17	29.10.2018	11,487,375	2,756,970	14,244,345	34,462,125
Instalment No. 18	29.04.2019	11,487,375	2,067,728	13,555,103	22,974,750
Instalment No. 19	29.10.2019	11,487,375	1,378,485	12,865,860	11,487,375
Instalment No. 20	29.04.2020	11,487,375	689,243	12,176,618	

In case of default in depositing the installments or any payment, interest @ 15% compounded half yearly shall be leviable for defaulted period on the defaulted amount.

All payment should be made through a demand draft/pay order drawn in favour of "GREATER NOIDA INDUSTRIAL DEVELOPMENT AUTHORITY" and payable at any Scheduled Bank located in New Delhi/GREATER NOIDA. The Lessee should clearly indicate his name and details of plots applied for / allotted on the reverse of the demand draft/pay order.

Premium referred to in this document means total amount payable to the Lessor for the allotted plot.

All payments should be remitted by due date. In case the due date is a bank holiday then the Lessee should ensure remittance on the previous working day.

The payment made by the Lessee will first be adjusted towards the interest due, if any, and thereafter the balance will be adjusted towards the premium due and the lease rent payable.

In case of allotment of additional land, the payment of the premium of the additional land shall be made in lump sum within 30 days from the date of communication of the said additional land.

The amount deposited by the Lessee will first be adjusted against the interest and thereafter against allotment money, installment, and lease rent respectively. No request of the Lessee contrary to this will be entertained.

A. EXTENSION OF TIME

- In exceptional circumstances, the time of deposit for the payment of balance due amount may be extended by the Chief Executive Officer of the Lessor.

LESSOR प्रमुख निदेशक
ग्रैंड नोएडा प्राइवेट लिमिटेड

4

For JKG CONSTRUCTION PVT. LTD.
21/11/20
DIRECTOR

2. However, in such cases of time extension, interest @ 15% per annum compounded half yearly shall be charged on the outstanding amount for such extended period.
3. Extension of time, in any case, shall not be allowed for more than 60 days for each instalment to be deposited, subject to maximum of three (3) such extensions during the entire payment schedule.
4. For the purpose of arriving at the due date, the date of issuance of allotment letter will be reckoned as the date of allotment.

And also in consideration of the yearly lease rent hereby reserved and the covenants provisions and agreement herein contained and on the part of the Lessee to be respectively paid observed and performed, the Lessor doth hereby demise on lease to the Lessee that sub divided plot of land numbered as Group Housing Plot No.01D, Sector-16C, in the GREATER NOIDA, Distt. Gautam Budh Nagar (U.P.) contained by measurement 20914.10 Sq. mtrs. be the same a little more or less and bounded:

On the North by :
 On the South by : As per Lease Plan attached
 On the East by :
 On the West by :

And the said plot is more clearly delineated and shown in the attached lease plan.

TO HOLD the said plot (hereinafter referred to as the demised premises with their appurtenances up to the Lessee for the term of 90 (ninety) years commencing from 18th DAY OF OCTOBER 2010 except and always reserving to the Lessor.

- a) A right to lay water mains, drains, sewers or electrical wires under or above the demised premises, if deemed necessary by the Lessor in developing the area.
- b) The Lessor reserves the right to all mine and minerals, claims, washing goods, earth oil, quarries, in over & under the allotted plot and full right and power at the time to do all acts and things which may be necessary or expedient for the purpose of searching for working and obtaining removing and enjoy the same without providing or leaving any vertical support for the surface of the residential plot or for any building for the time being standing thereon provided always that the Lessor shall make reasonable compensation to the Lessee for all damages directly occasioned by the exercise of such rights. To decide the amount of reasonable compensation the decision of the Lessor will be final and binding on the Lessee.

LESSOR

 प्रकाश विवेक
 सेक्टर नौदा नोएडा

5

For JKG CONSTRUCTION PVT. LTD.

 DIRECTOR

PLOT NO:- 1D

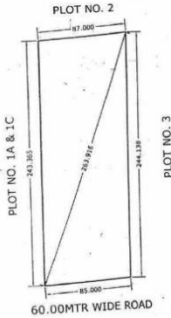

60.00MTR WIDE ROAD

AREA OF PLOT = 20914.10 sqm.

SIGN POSSESSION TAKEN OVER ALLOTTEE	SIGN POSSESSION HANDLED OVER		N ↑	
	PROJ. DEPTT.	<i>[Signature]</i>		<i>[Signature]</i>
	LAND DEPTT.	<i>[Signature]</i>		<i>[Signature]</i>
	LAW DEPTT.	<i>[Signature]</i>		<i>[Signature]</i>
	PLNG. DEPTT.	<i>[Signature]</i>		<i>[Signature]</i>



GREATER NOIDA INDUSTRIAL DEVELOPMENT AUTHORITY

प्रधानमन्त्री
केन्द्र नगरपालिका

For JKG CONSTRUCTION PVT. LTD.
[Signature]
DIRECTOR

(ii) AND THE LESSEE DOTH HEREBY DECLARE AND CONVENANTS WITH THE LESSOR IN THE MANNER FOLLOWING:

a) Yielding and paying therefore yearly in advance during the said term unto the Lessor yearly lease rent indicated below:-

(i) Lessee has paid Rs. 21,47,879/- (Ra. Twenty One Lac Forty Seven

Thousand Eight Hundred Seventy Nine only) as annual lease rent being 1% of the plot premium for the first 10 years of lease period.

(ii) The lease rent may be enhanced by 50% after every 10 years i.e. 1.5 times of the prevailing lease rent.

(iii) The lease rent shall be payable in advance every year. First such payment shall fall due on the date of execution of lease deed and thereafter, every year, on or before the last date of previous financial year.

(iv) Delay in payment of the advance lease rent will be subject to interest @15% per annum compounded half yearly on the defaulted amount for the defaulted period.

(v) The Lessee has to pay lease rent equivalent to 11 years @1% of the premium of the plot as "One Time Lease Rent" phasewise before getting permission to execute Tripartite Sub-Lease Deed in favour of their prospective buyers unless the Lessor decides to withdraw this facility. On payment of One Time Lease Rent, no further annual lease rent would be required to be paid for the balance lease period. This option may be exercised at any time during the lease period, provided the Lessee has paid the earlier lease rent due and lease rent already paid will not be considered in One Time Lease Rent option.

b) The Lessee shall be liable to pay all rates, taxes, charges and assessment leviable by whatever name called for every description in respect of the plot of land or building constructed thereon assessed or imposed from time to time by the Lessor or any Authority/ Government. In exceptional circumstances the time of deposit for the payment due may be extended by the Lessor. But in such case of extension of time an interest @ 15% p.a. compounded every half yearly shall be charged for the defaulted amount for such delayed period. In case Lessee fails to pay the above charges it would be obligatory on the part or its members/ sub Lessee to pay proportional charges for the allotted areas.

c) The Lessee shall use the allotted plot for construction of Group Housing/flats/plots. However, the Lessee shall be entitled to allot the dwelling units on sublease basis to its allottee and also provide space for facilities like Roads, Parks etc. as per their requirements, convenience with the allotted plot, fulfilling requirements or building bye-laws and prevailing and under mentioned terms and conditions to the Lessor. Further transfer/sub lease shall be governed by the transfer policy of the Lessor.

i) Such allottee/sub Lessee should be citizen of India and competent to contract.

ii) Husband/wife and their dependent children will not be separately eligible for the purpose of allotment and shall be treated as single entity.

LESSOR
जनक विहार
सक नगर अधिकाय

6

For JKG CONSTRUCTION PVT. LTD.
6. 01.2019
DIRECTOR

9-222211

iii) Normally, the permission for part transfer of plot shall not be granted under any circumstances. The Lessee shall not be entitled to complete transaction for sale, transfer, assign or otherwise part with possession of the whole or any part of the building constructed thereon before making payment according to the schedule specified in the lease deed of the plot to the Lessor. However, after making payment of premium of the plot to the Lessor as per schedule specified in the lease deed, permission for transfer of built up flats or to part with possession of the whole or any part of the building constructed on the Group Housing Plot, shall be granted and subject to payment of transfer charges as per policy prevailing at the time of granting such permission of transfer. However, the Lessor, reserves the right to reject any transfer application without assigning any reason. The Lessee will also be required to pay transfer charges as per the policy prevailing at the time of such permission of transfer. The permission to transfer the part or the built up space will be granted subject to execution of tripartite sub-lease deed which shall be executed in a form and format as prescribed by the Lessor. On the fulfillment of the following conditions:-

- a) The Lease Deed of plot has been executed and the Lessee has made the payment according to the schedule specified in the lease deed of the plot, interest and one time lease rent. Permission of sub-lease deed shall be granted phase-wise on payment of full premium (with interest upto the date of deposit) of the plot of that phase.
- b) Every sale done by the Lessee shall have to be registered before the physical possession of the property is handed over.
- c) The Lessee has obtained building occupancy certificate from Planning Department, Greater Noida.
- d) The Lessee shall submit list of individual allottees of flats within 6 months from the date of obtaining occupancy certificate.
- e) The Lessee shall have to execute sub lease in favour of the individual allottees for the developed flats/plots in the form and format as prescribed by the LESSOR.
- f) The Sub-Lessee undertakes to put to use the premises for the residential use of residential area only.
- g) The Lessee shall pay an amount of Rs. 1000/- towards processing fee and proportionate (pro-rata basis) transfer charges and lease rent as applicable at the time of transfer and shall also execute sub lease deed between Lessor, Lessee and proposed transferee (sub-Lessee). The Lessor/ sub Lessee shall also ensure adherence to the building regulations and directions of the Lessor. The Lessee as well as sub Lessee shall have to follow rules and regulations prescribed in respect of lease hold properties and shall have to pay the charges as per rules of the Lessor/ Government of U.P.

The transfer charges shall not be payable in case of transfer between son/daughter, husband/wife, mother/father and vice versa or between these six categories. A processing fee of Rs. 1000/- will be payable in

LESSOR
[Signature]
[Signature]
[Signature]
[Signature]
[Signature]
[Signature]

7

For JKG CONSTRUCTION PVT. LTD.
[Signature]
DIRECTOR

such case. The transfer of the flat in favour of 1st sub-Lessee shall be allowed without any transfer charges but sub lease deed will be executed between the Lessor & Lessee and allottee. However, a processing fee of the Rs. 1000/- will be payable at the time of transfer/execution of sub-lease deed. The physical possession of dwelling units/flats/plots will be permitted to be given after execution of sub-lease deed.

- i) Every transfer done by the Lessee shall have to be registered before the physical possession of the flat/plot is handed over.
- j) Except otherwise without obtaining the completion certificate, the Lessee shall have option upto 30.09.2010, or as decided by the Lessor, to divide the allotted plot and to sub-lease the same with the prior approval of Lessor on payment of transfer charges @ 2% of allotment rate. However, the area of each of such sub divided plots should not be less than 20,000 sq. mtrs.
- k) Rs. 1000/- shall be paid as processing fee in each case of transfer of flat in addition to transfer charges.

NORMS OF DEVELOPMENT

The Lessee is allowed to develop the plots/construct the flats subject to achieving the density with the following norms.

Maximum permissible Ground Coverage	35 %
Maximum permissible FAR	2.75
Set backs	As per Building Bye-laws
Maximum Height	No Limit

CONSTRUCTION

1. The Lessee is required to submit building plan together with the master plan showing the phases for execution of the project for approval within 6 months from the date of possession and shall start construction within 12 months from the date of possession. Date of execution of lease deed shall be treated as the date of possession. The Lessee shall be required to complete the construction of group housing pockets on allotted plot as per approved layout plan and get the occupancy certificate issued from Building Cell Department of the LESSOR in maximum 5 phases within a period of 7 years from the date of execution of lease deed. The Lessee shall be required to complete the construction of minimum 15% of the total F.A.R. of the allotted plot as per approved layout plan and get occupancy/completion certificate of the first phase accordingly issued from the building cell of the LESSOR within a period of three years from the date of execution of lease deed.

In case of plotted development, the final purchaser/sub-Lessee of plot shall have to obtain completion certificate from the LESSOR within the period of 5 years from the date of execution of lease deed.

2. All the peripheral/external development works as may be required to be carried out up to the allotted plot including construction of approach road, drains,

LESSOR

प्रमुख निदेश
वेद नारायण शर्मा

8

LESSOR
For JKG CONSTRUCTION PVT. LTD.
G. K. J. K. G.
DIRECTOR

culverts, electricity distribution/transmission lines, water supply, sewerage will be provided by the Lessor. However, all the expenses as may be required to connect these services with the internal system of services of plot shall be incurred by the Lessee.

3. Without prejudice to the Lessor's right of cancellation, the extension of time for the completion of Project, can be extended for a maximum period of another three years only with penalty as under:

- For first year the penalty shall be 4% of the total premium.
- For second year the penalty shall be 6% of the total premium.
- For third year the penalty shall be 8% of the total premium.

Extension for more than three years, normally will not be permitted.

4. In case the Lessee does not construct building within the time provided including extension granted, if any, for above, the allotment/ lease deed as the case may be, shall be liable to be cancelled. Lessee shall lose all rights to the allotted land and buildings appurtenant thereto.
5. There shall be total liberty at the part of allottee /Lessee to decide the size of the flats / plots (in case of plotted development) or to decide the ratio of the area for flatted/ plotted development. The F.A.R. earmarked for commercial/institutional use would be admissible but the allottee /Lessee may utilize the same for residential use as per their convenience.
6. The allottee /Lessee may implement the project in maximum five phases and the occupancy certificate/completion certificate shall be issued by the LESSOR phase wise accordingly enabling them to do phase-wise marketing.

MORTGAGE

The Lessee may, with prior permission of the Lessor, mortgage the land to any Financial Institution(s) / Bank(s) for raising loan for the purpose of financing his investment in the project on receipt of payment by allottee or on receipt of assurance of payment by bank or under any other suitable arrangement in the mutual settlement amongst the LESSOR, developer and the financial institution(s)/Bank(s). As regards the case of mortgaging the land to any Financial Institution(s)/ Bank(s) to mortgage the said land to facilitate the housing loans of the final purchasers, N.O.C may be issued subject to such terms and conditions as may be decided by the LESSOR at the time of granting the permission.

Provided that in the event of sale or foreclosure of the mortgaged/charged property the LESSOR shall be entitled to claim and recover such percentage, as decided by the LESSOR, of the unearned increase in values of properties in respect of the market value of the said land as first charge, having priority over

LESSOR
संस्था-निर्देश
भारत-निर्देश

9

LESSOR
FOR JAG CONSTRUCTION PVT. LTD.
DIRECTOR

the said mortgage charge, the decision of the LESSOR in respect of the market value of the said land shall be final and binding on all the parties concerned.

The LESSOR's right to the recovery of the unearned increase and the pre-emptive right to purchase the property as mentioned herein before shall apply equally to involuntary sale or transfer, be it bid or through execution of decrees of insolvency/court.

TRANSFER OF PLOT

1. Without obtaining the completion certificate the Lessee shall have the right to sub-divide the allotted plot into suitable smaller plots as per planning norms and to transfer the same to the interested parties upto 30.09.2010, or as decided by the Lessor, with the prior approval of LESSOR on payment of transfer charges @ 2% of allotment rate. However, the area of each of such sub-divided plots should not be less than 20,000 sq. mtrs. However, individual flat/plot will be transferable with prior approval of the LESSOR as per the following conditions :-
 - (i) The dues of LESSOR towards cost of land shall be paid in accordance with the payment schedule specified in the Lease Deed before executing of sub-lease deed of the flat.
 - (ii) The lease deed has been executed.
 - (iii) Transfer of flat will be allowed only after obtaining completion certificate for respective phase by the Lessee.
 - (iv) The sub-Lessee undertakes to put to use the premises for the residential use only.
 - (v) The Lessee has obtained building occupancy certificate from Building Cell/Planning Department, Greater NOIDA Industrial Development Authority.
 - (vi) First sale/transfer of a flat/plot to an allottee shall be through a Sub-lease/Lease Deed to be executed on the request of the Lessee to the LESSOR in writing.
 - (vii) No transfer charges will be payable in case of first sale, including the built-up premises on the sub-divided plot(s) as described above. However, on subsequent sale, transfer charges shall be applicable on the prevailing rates as fixed by the LESSOR.
 - (viii) Rs. 1000/- shall be paid as processing fee in each case of transfer of flat in addition to transfer charges.

MISUSE, ADDITIONS, ALTERATIONS ETC.

The Lessee shall not use flat for any purpose other than for residential purpose.

LESSOR 
प्रधान अधिकारी
देव भूमा प्राधिकरण

10

LESSEE
For JKG CONSTRUCTION PVT. LTD.

DIRECTOR

9-2233210

In case of violation of the above conditions, allotment shall be liable to be cancelled and possession of the premises along with structure thereon, if any, shall be resumed by the Lessor (Authority).

The Lessee will not make, any alteration or additions to the said building or other erections for the time being on the demised premises, erect or permit to erect any new building on the demised premises without the prior written consent of the Lessor and in case of any deviation from such terms of plan, shall immediately upon receipt of notice from the Lessor requiring him to do so, correct such deviation as aforesaid.

If the Lessee fails to correct such deviation within a specified period of time after the receipt of such notice, then it will be lawful for the Lessor to cause such deviation to be corrected at the expense of Lessee who hereby agrees to reimburse by paying to the Lessor such amounts as may be fixed in that behalf.

LIABILITY TO PAY TAXES

The Lessee shall be liable to pay all rates, taxes, charges and assessment of every description imposed by any Lessor empowered in this behalf, in respect of the plot, whether such charges are imposed on the plot or on the building constructed thereon, from time to time.

OVERRIDING POWER OVER DORMANT PROPERTIES

The Lessor reserves the right to all mines, minerals, coals, washing gold earth's oils, quarries on or under the plot and full right and power at any time to do all acts and things which may be necessary or expedient for the purpose of searching for, working and obtaining removing and enjoying the same without providing or leaving any vertical support for the surface of the plot(s)/flats or for the structure time being standing thereon provided always, that the Lessor shall make reasonable compensation to the Lessee for all damages directly occasioned by exercise of the rights hereby reserved. The decision of the Chief Executive Officer/ Lessor on the amount of such compensation shall be final and binding on the Lessee/sub-Lessee.

MAINTENANCE

1. The Lessee at his own expenses will take permission for sewerage, electricity and water connections from the concerned departments.
2. That the Lessee shall have to plan a maintenance programme whereby the entire demised premises and buildings shall be kept-
 - a. In a state of good and substantial repairs and in good sanitary condition to the satisfaction of the Lessor at all times.
 - b. And to make available required facilities as well as to keep surroundings in all times neat and clean, good healthy and safe

LESSOR

प्रबन्धक निदेशक
रेलवे क्षेत्रीय कार्यालय

11

For JKD CONSTRUCTION PVT. LTD.
1/2/2016

OTHER CLAUSES

1. The Lessor reserves the right to make such additions / alternations or modifications in the terms and conditions of allotment/lease deed/sub lease deed from time to time, as may be considered just and expedient.
2. In case of any clarification or interpretation regarding these terms and conditions, the decision of Chief Executive Officer of the Lessor shall be final and binding.
3. If due to any "Force Majeure" or such circumstances beyond the Lessor's control, the Lessor is unable to make allotment or facilitate the Lessee to undertake the activities in pursuance of executed lease deed, the deposits depending on the stages of payments will be refunded along with simple interest @ 4% p.a., if the delay in refund is more than one year from such date.
4. If the Lessee commits any act of omission on the demised premises resulting in nuisance, it shall be lawful for the Lessor to ask the Lessee to remove the nuisance within a reasonable period failing which the LESSOR shall itself get the nuisance removed at the Lessee's cost and charge damages from the Lessee during the period of submission of nuisance.
5. Any dispute between the Lessor and Lessee/ Sub-Lessee shall be subject to the territorial jurisdiction of the Civil Courts having jurisdiction over District . Gautam Budh Nagar or the Courts designated by the Hon'ble High Court of Judicature at Allahabad
6. The Lease Deed/allotment will be governed by the provisions of the U.P. Industrial Area Development Act, 1976 (U.P. Act No. 9 of 1976) and by the rules and/or regulations made or directions issued, under this act.
7. The Lessor will monitor the implementation of the project. Applicants who do not have a firm commitment to implement the project within the time limits prescribed are advised not to avail the allotment.
8. The Lessee/sub-Lessee of the Lessee shall be liable to pay all taxes/ charges livable from time to time Lessor or any other authority duly empowered by them to levy the tax/charges.
9. Dwelling units/flats shall be used for residential purpose only. In case of default, render the allotment/lease liable for cancellation and the Allottee/ Lessee/sub-Lessee will not be paid any compensation thereof.
10. Other buildings earmarked for community facilities can not be used for purposes other than community requirements.
11. All arrears due to the Lessor would be recoverable as arrears of land revenue.
12. The Lessee shall not be allowed to assign or change his role, otherwise the lease shall be cancelled and entire money deposited shall be forfeited.
13. The Lessor in larger public interest may take back the possession of the land/building by making payment at the prevailing rate.
14. In case the Lessor is not able to give possession of the land in any circumstances, deposited money will be refunded to the allottee with simple interest.
15. All terms and conditions of brochure and its corrigendums, allotment, building bye-laws and as amended from time to time shall be binding on the Lessee.

LESSOR

सचिव निवेश
श्री श्री निवेश निगम

13

For JKG CONSTRUCTION SVT. LTD.
DIRECTOR

IN WITNESS WHEREOF the parties have see their hands on the day and in the year herein first above written.
In presence of:

Witnesses:

1. *[Signature]*
M. S. K. Gupta
R/o B-14/40/3/2
Vishal delhi-110042

[Signature]
for and on behalf of LESSOR प्रमोद विहार
शेखर नगरा

2. *[Signature]*
S. K. Sharma
S/O M. L. Sharma
T. C. 42/B

For and on behalf of LESSEE
For JIG CONSULTANTS
[Signature]
DIRECTOR

[Signature]
प्रमोद विहार
शेखर नगरा

[Signature]

LESSOR

LESSEE

FOR K&C CONSTRUCTION PVT. LTD

A. H. Pathan
20/10/2010

DIRECTOR

आज दिनांक 19/10/2010 को
वर्ग सं 1 खण्ड सं 7463
प्लॉट सं 1 से 56 पर क्रमांक 22332
नियंत्रीकृत किया गया।

A. H. Pathan
(राजबहादुर सिंह)
उपनिर्देशक, सहर
गीतमकुडनगर
19/10/2010

