

PROPOSED GROUP HOUSING SCHEME UNDER INFORMAL CATEGORY IN SECTOR XU-III, GREATER NOIDA	
PLOT AREA (SQMT.)	19999
PERMISSIBLE GR. COV. @ 40% OF TOTAL PLOT AREA	7999.6
PERMISSIBLE FAR AREA @ 200	39998

NAME	PLOT AREA	PERM. GR. COV. (%)	PERM. GR. COV. (SQMT.)	PERM. F.A.R. (%)	PERM. F.A.R. (SQMT.)	PERM. HEIGHT	REMARKS
GROUP HOUSING	19999	40	7999.6	200	39998	15	

CHART-02 FAR CALCULATIONS FOR EACH TOWER				
FLOOR NO.	PROPOSED COVERED AREA OF SINGLE BLOCK (SQM.)	ADD. FAR FOR MUMTY (IF ANY)	TOTAL NO'S OF TOWER	PROPOSED COVD AREA OF ALL BLOCKS
GROUND FLOOR	143.68 (as area detail)	0	52	7471.36
FIRST FLOOR	143.68 (as area detail)	0	52	7471.36
COND FLOOR	143.68 (as area detail)	0	52	7471.36
THIRD FLOOR	143.68 (as area detail)	0	52	7471.36
MUMTY	0	17.04	52	886.08
STAIR TANK	0	17.04	52	886.08
TOTAL	574.72	34.08	52	31657.6

CHART-03 FAR CALCULATIONS FOR ANCILLARY FACILITIES FOR AFFORDABLE HOUSING			
NAME	PROPOSED GR. COVERAGE OF BLOCK (SQM.)	PROPOSED FAR OF BLOCK (SQM.)	PROPOSED GR. COVERAGE OF BLOCK (SQM.)
WARD ROOM	9X2=18	18	18
WATER ROOM	25	25	25
TOTAL		43	

BUILT UP AREA OF AFFORDABLE HOUSING (FAR AREA OF HOUSING + FAR AREA OF ANCILLARY FACILITIES)	31700.6
--	---------

CHART-04 GROUND COVERAGE CALCULATIONS FOR EACH TOWER & ANCILLARY FACILITIES FOR AFFORDABLE HOUSING				
S.NO.	NAME	AREA AT GR. FLOOR FOR EACH BLOCK	NO'S OF BLOCKS	TOTAL GROUND COVERAGE
1	GROUP HOUSING	143.68	52	7471.36
2	ANCILLARY FACILITY	43	1	43
TOTAL				7514.36

TOTAL BUILT UP AREA OF AFFORDABLE HOUSING (FAR AREA OF HOUSING + FAR AREA OF ANCILLARY FACILITIES)	7514.36
--	---------

CHART-05 GROUND COVERAGE AND FAR AREA COMPARTIVE AREA STATEMENT					
S.NO.	NAME	PERMISSIBLE FAR	ACHIEVED FAR	PERMISSIBLE GR. COVERAGE	ACHIEVED GR. COVERAGE
1	GROUP HOUSING (SQMT.)	39998	31700.6	7999.6	7514.36
GRAND TOTAL (IN %)		200	129.36	40	32.21

CHART-06 GREEN AREA CALCULATION		
S.NO.	NAME	AREA IN SQMT.
1	TOTAL GREEN AREA REQUIRED	50% OF TOTAL OPEN AREA
2	TOTAL GREEN AREA REQUIRED	6240.57
3	TOTAL GREEN AREA PROPOSED	7444.62
4	TOTAL NO'S OF TREES REQUIRED	1 NO'S / 100SQMT. = 128
5	TOTAL NO'S OF TREES PROPOSED	400.00 NOS
		200 EVERGREEN & 200 ONRMENTAL

CHART-07 PARKING CALCULATION (AS/REPORT FROM PROPERTY DEPARTMENT)			
S.NO.	NAME	AREA IN SQMT.	
1	TOTAL 02 WHEELER REQUIRED	544	1632
2	TOTAL 04 WHEELER REQUIRED	31	620
3	TOTAL 02 WHEELER PROVIDED	600	1800
4	TOTAL 04 WHEELER PROVIDED	40	900

Greater Noida Industrial Dev. Authority  
**APPROVED**  
 28/07/2019  
 Valid upto Date: 14/8/2019  
 Dr. Gan. Misra  
 (Planning)  
 Dr. Gan. Misra  
 (Planning)  
 Checked & Verified By  
 SK (Planning)

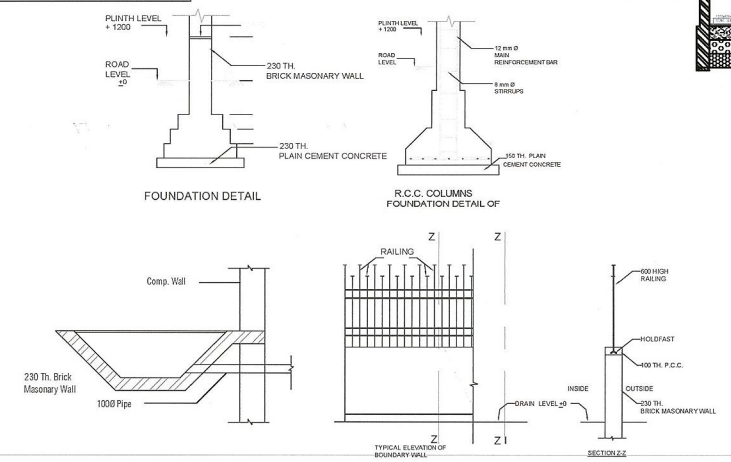
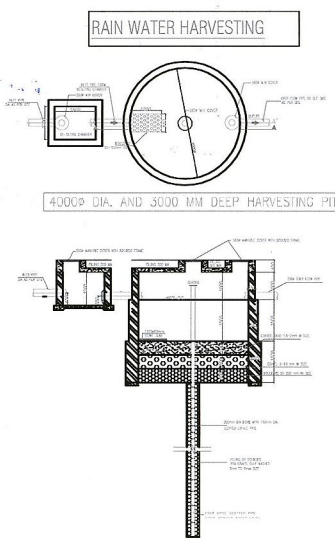

PROJECT :  
**PROPOSED AFFORDABLE HOUSING UNDER INFORMAL CATEGORY AT SECTOR-XU-III, GREATER NOIDA (UP).**

INDEX FOR FIRE FIGHTING	
SYMBOL	DESCRIPTION
□	UNDERGROUND WATER TANK FOR FIRE FIGHTING (AS INDICATED IN SITE PLAN)
⊕	MANUALLY OPERATED FIRE ALARM SYSTEM
⊕	YARD HYDRANT
⊕	DOWN COMMER
⊕	TERRACE TANK
⊕	WET RISER
⊕	FIRE HOUSE REEL
⊕	HOUSE BOX WITH TWO DELIVERY HOSES & ONE BRANCH PIPE
⊕	FIRST AID HOSE REEL
⊕	FIRE BUCKETS SET OF 6 SAND & WATER BUCKETS

OWNER'S SIGNATURE

ARCHITECT'S SIGNATURE

NORTH -	DATE -	SHEET NO -
	JULY-17	01

BUILDING:

DRG. TITLE:

SITE LAYOUT PLAN

SUB TITLE:

SUBMISSION DRAWING

SCALE : 1:500

CHECKED BY :

IMPLEMENTING AGENCY :

CONSULTING ARCHITECTS:

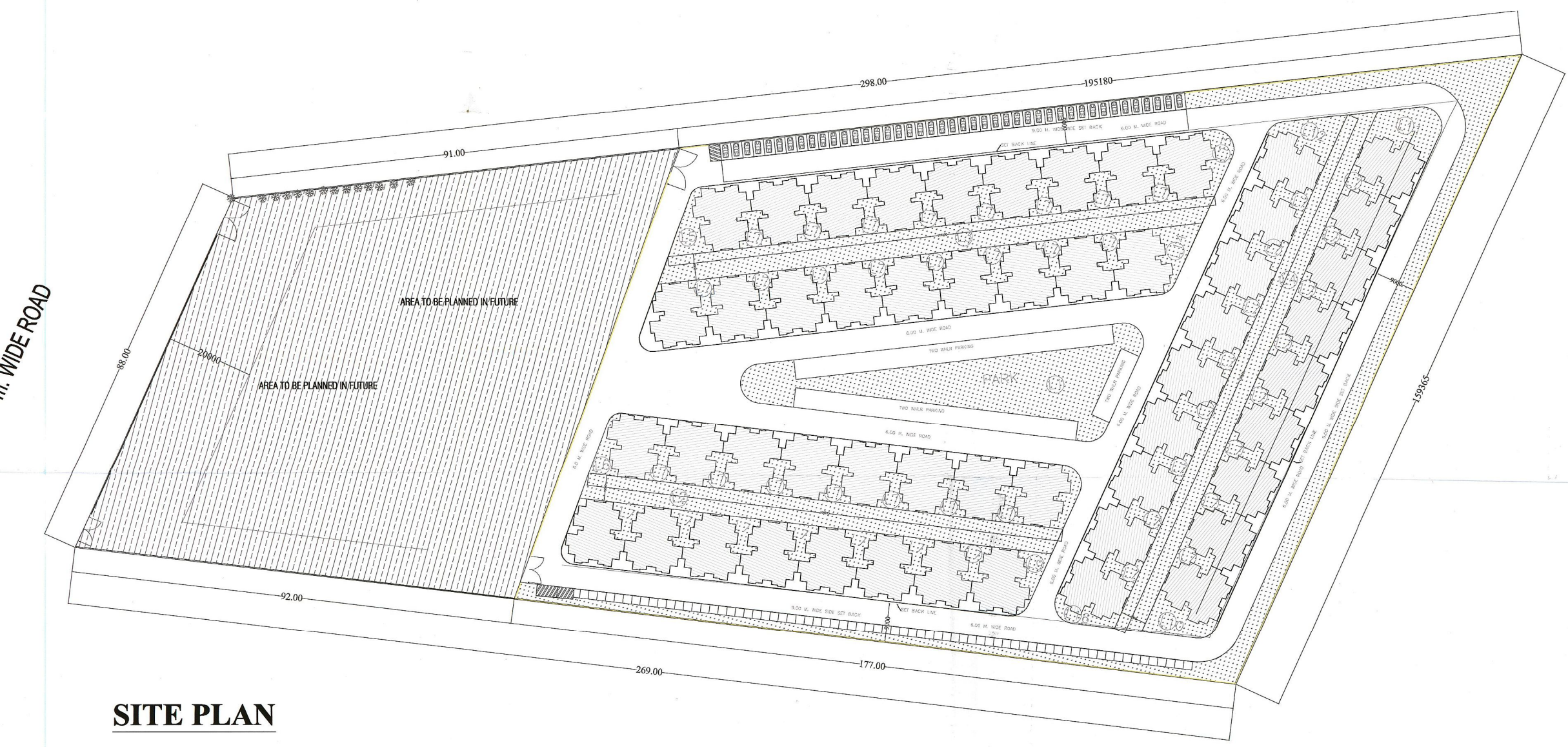

**SITE PLAN**