

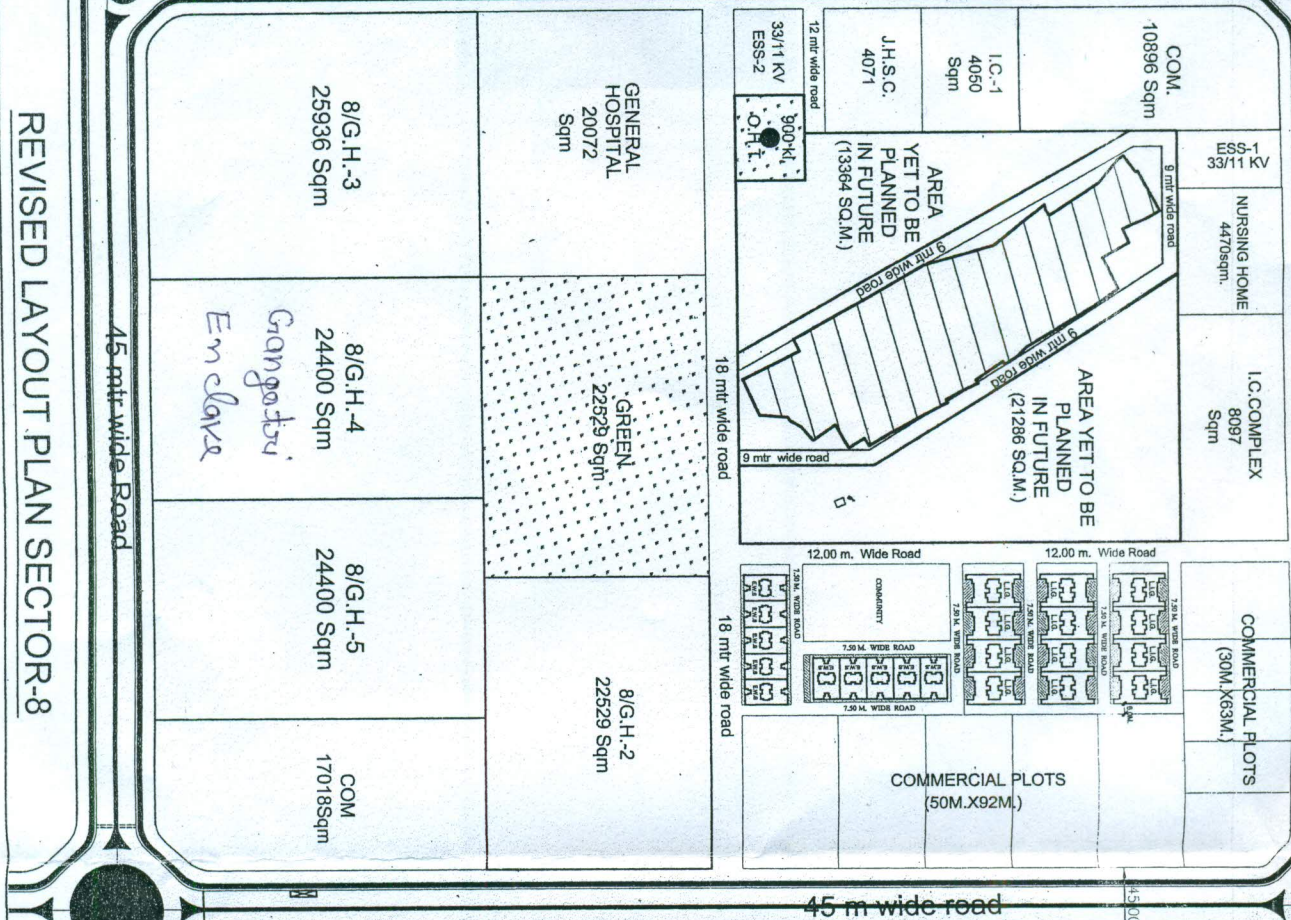

~~45.0 M WIDE ROAD~~

SECTOR-9

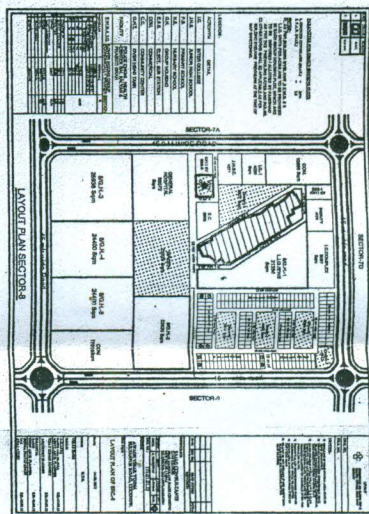

ACRONYM	DETAIL
I.C.	INTER COLLEGE
J.H.S.	JUNIOR HIGH SCHOOL
P.S.	PRIMARY SCHOOL
N.S.	NURSARY SCHOOL
G.H.	GROUP HOUSING
E.S.S.	ELECT. SUB STATION
COM.	COMMERCIAL
C.C.	COMMUNITY CENTER
O.H.T.	OVER HEAD TANK
FACILITY	POLICE CHOKI, HEALTH CENTER BAL KALYAN & PRASUTI GRAH
E.W.S./L.I.G.	FLOWER INCOME GROUP ECONOMICALLY WEAKER SECTION

S.NO.	COLOUR	INDICATE
1.		O.H.T.
2.		BUS BAY

1) DETAILING OF COMMERCIAL AREA SHALL BE
2) SHALL ALLOWED INSIDE COMMERCIAL SHALL
3) BE PERMITTED UNDER REGULATION COMMERCIAL
4) SHALL BE 11.1G. IN E.W.S. 11.1G.
5) UNITS PER ACRE ARE TO BE PROVIDED IN EACH
6) GROUP HOUSING PLOT, WHICH ARE TO BE
7) PROVIDED BY PARISHAD AS PER THE
8) PREVALING RATES.
9) RESIDENTIAL USE ABOVE GROUND FLOOR ON
10) COMMERCIAL PLOT SHALL BE ALLOWED
11) SECTION AREA IS MEASURED FROM T.O.C
12) ISLANDS OF ANY SORTARY IF NOT SHOWN THEN
13) PLEASE LOOK FOR ITS DETAIL ON THE
14) PLAN DRAWING.

PARAMETER FOR GROUP HOUSING PLOTS

1. GROUND COVERAGE (MAX.)	=	35%
2. F.A.R. (MAX.)	=	2.5

NOTES:

01. AS PER BUILDING BYE LAWS, 5 E.W.S. & 6
02. L.G. UNITS PER ACRE ARE TO BE PROVIDED
03. IN EACH GROUP HOUSING PLOT, WHICH ARE
04. TO BE DISPOSED / ALLOTTED BY PARISHAD
05. AS PER THE PREVALING RATES AND RULES
06. ON OTHER WORKS SHALL BE APPLICABLE AS PER
07. BUILDING BYE LAWS PREVALING AT THE TIME OF
08. MAINTAINING.

1. THIS A/TOU PLAN HAS BEEN REVISED ON THE BASIS OF INFORMATION RECEIVED FROM E.E.C.D-15
VIDE HIS LETTER NO.-2311/149 DATED : 28.12.2013.
2. THIS LAYOUT PLAN HAS BEEN FINALISED ON THE BASIS OF FEASIBILITY RECEIVED FROM E.E.C.D-15
VIDE HIS LETTER NO.-171 DATED : 23.01.2014.

	DRAWN	DATE		INITIALS
REVISION				
ARCH.				
	ARVIND	M.M.		

REVISED LAYOUT PLAN OF

SCALE: N.T.S

VIKAS SINGH	
D/MAN	
A.D.ARYA	

ASSISTANT ARCH. PLANNER	9/5.1.1.2
VILAY KUMAR PANDEY	
ARCHITECT PLANNER	9/5.1.1.2
G.S GOYAL	
BATCH.	
CHIEF ARCH. PLANNER	
M.K.S SUNDARAM	
IAS	
AVAS AYUKT	