

VILLAGE

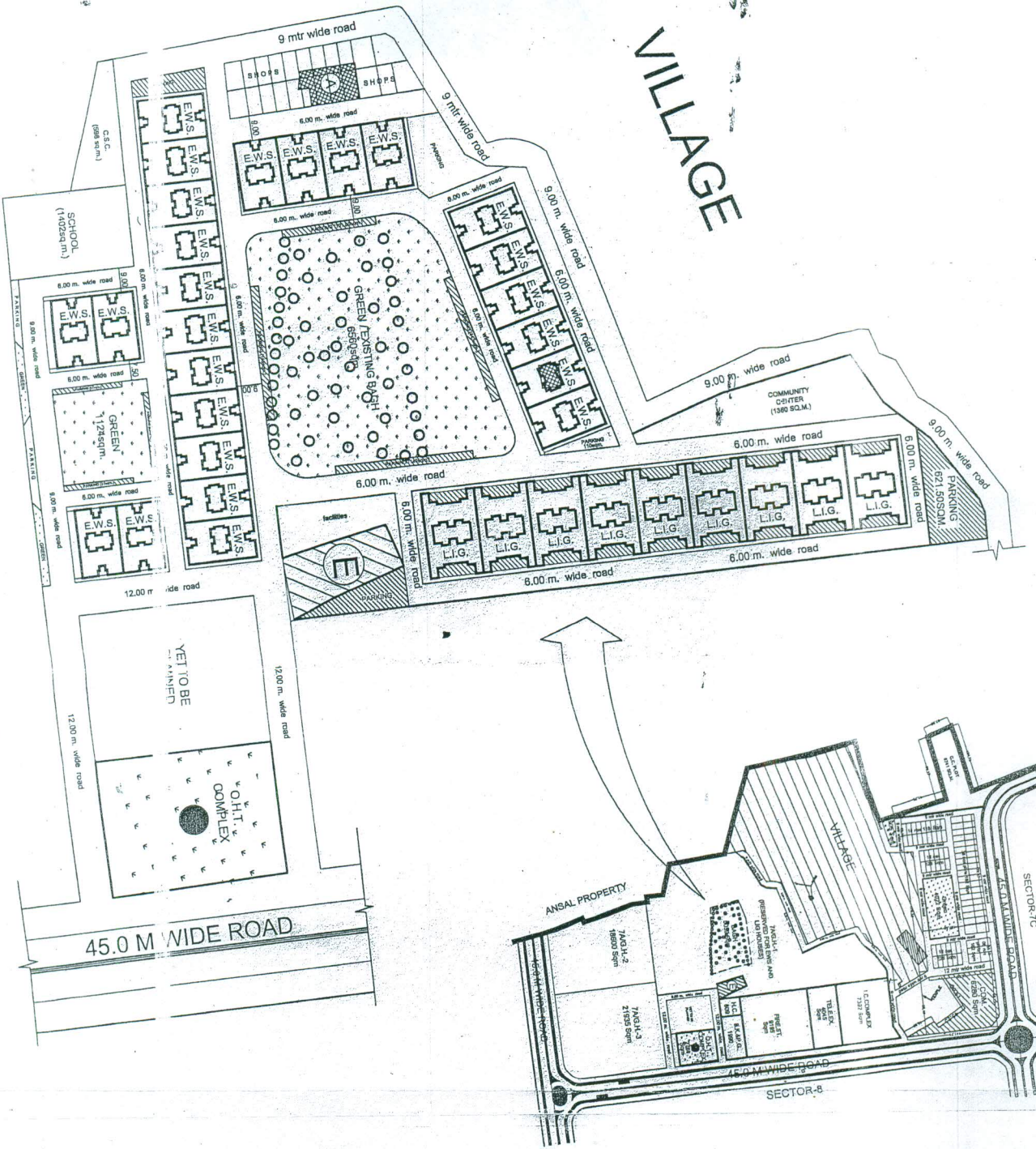

UPAPV
ARCHITECTURE AND PLANNING UNIT - 3
REJURE COMPLEX, NINRA, NAGAR
LUCKNOW

DRG. NO. Saa 7A/91A.06 (Residential) / H/23/24/25/26/27/28/29/30/31/32/33/34/35/36/37/38/39/40/41/42/43/44/45/46/47/48/49/50/51/52/53/54/55/56/57/58/59/60/61/62/63/64/65/66/67/68/69/70/71/72/73/74/75/76/77/78/79/80/81/82/83/84/85/86/87/88/89/90/91/92/93/94/95/96/97/98/99/100

FILE NO. 44454.00

PARTICULAR		TOTAL AREA	
01 RESIDENTIAL			44454.00
02 PARKING			
03 GREEN			

Sl. No.	Particulars	Area (sq.m)	Area (sq.ft)	Area (ac)	Area (hect)
(A)	Green	288	3120.00	0.07	0.07
(B)	Parking	821.50	8870.00	0.20	0.20
(C)	Other	4153.50	44644.00	1.09	1.09
TOTAL		5263.00	56734.00	1.36	1.36

UNAUTHORISED CONSTRUCTION WILL BE DEMOLISHED

GREEN AREA

PARKING AREA

NOTE:
1. THIS LAYOUT PLAN HAS BEEN REVISED ON THE BASIS OF INFORMATION RECEIVED FROM E.E.C.D.-15 VIDE HIS LETTER NO.-592/W-1342 DATED: 11.04.14 AND FINALISED ON THE BASIS OF FEASIBILITY RECEIVED FROM E.E.C.D.-15 VIDE HIS LETTER NO.-884/W-1349 DATED: 12.06.2014.

PROJECT:
AVADH VIHAR YOJNA
SULTANPUR ROAD, LUCKNOW.

DRG. TITLE:
REVISED LAYOUT PLAN OF GH PLOT NO.-7A/GH-01 (EWS/LIG HOUSES)

DATE:
18.06.2014

SCALE:	N.I.S.
drawn by: VIKAS SINGH DRAKAR(DVD)	
A.D.DARYA	
ASSTT. ARCH. PLANNER	
VUJAY KUMAR PANDEY	
ARCHITECT PLANNER	
G.S.GOYAL	
CHIEF ARCH. PLANNER	
RUDRA PRATAP SINGH	
I.A.S.	
SACHIV/ AVAS AYUKT	