

# LUCKNOW DEVELOPMENT AUTHORITY

LEASE TO SRI/SMT./KM./ : R.D. INFOSOLUTIONS PRIVATE LIMITED  
 COMMERCIAL PLOT NO. : C.P.- 4/1  
 SIZE : AS / DRAWING  
 AREA : 2291.00 sq.m.

BOUNDRY  
 NORTH : 39.00 m WD. RD  
 SOUTH : PLOT NOS. 1/751 - 1/760 TO 1/762 & 9.0 m.wd.rd.  
 EAST : 9.00 m WD.RD.  
 WEST : C.P.- 4/2

KHAND — RATAN KHAND

SCHEME : SHARDA NAGAR SCHEME

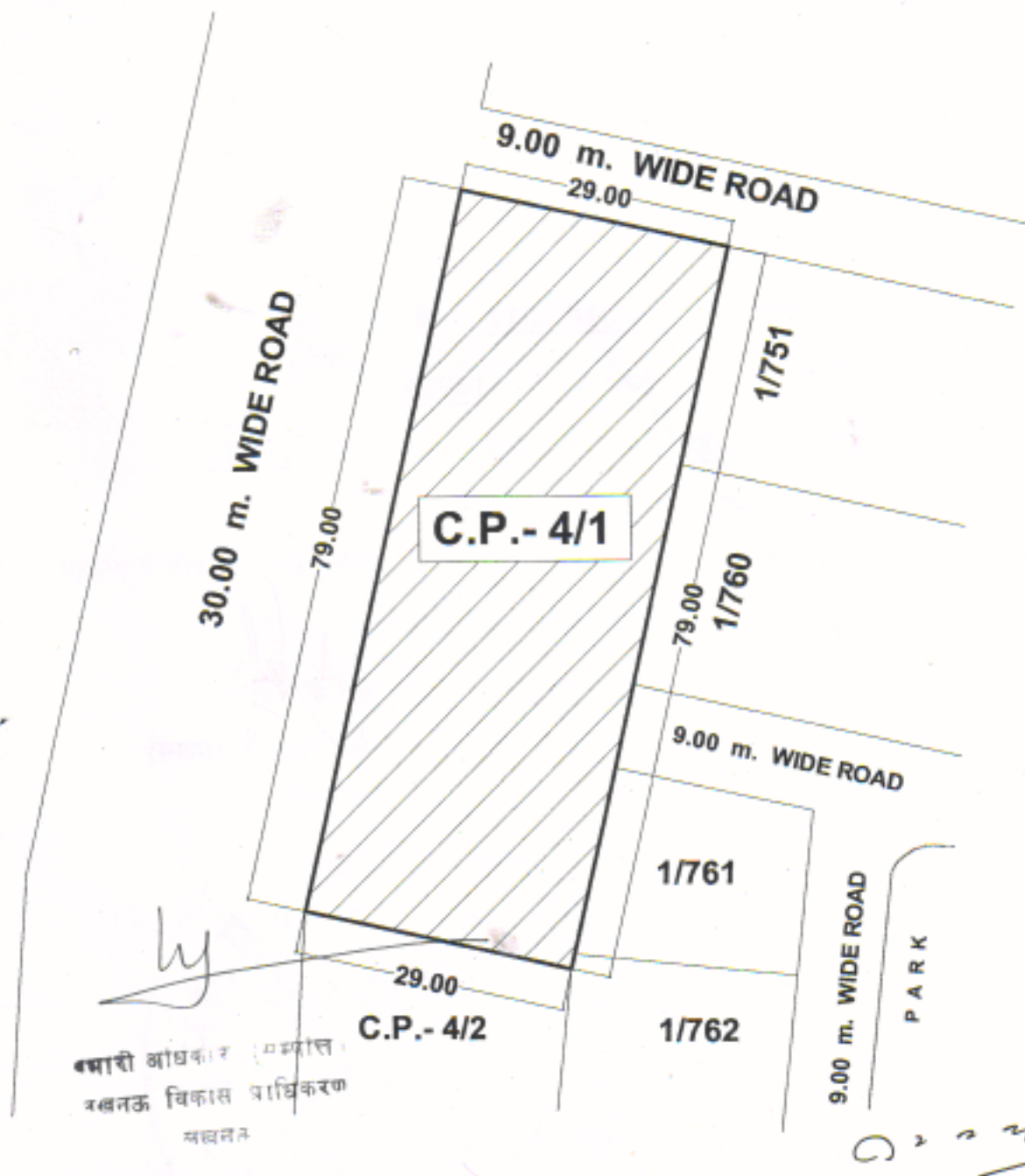

DATE: 02/01/2010 REP. FILE NO. - 690/CTP/Index/2008

DRG.NO. :- 275 / RATAN KHAND / S.N.Y/10

THIS PLAN IS PREPARED ON THE BASIS OF EXECUTION PLAN OF RATAN KHAND AT RAIBAREILY ROAD SCHEME LUCKNOW, DATED MAY-06

THIS PLAN IS PREPARED AS PER SURVEY REPORT GIVEN BY E.E. ZONE- 4, DATED 21/12/09, ON FILE OF COMMERCIAL PLOT NO. C.P.- 4/1, AT RATAN KHAND, SHARDA NAGAR SCHEME, LKO.



ORIENTATION

*Signature*  
 02-01-10

HASIB AHMAD  
 D/M

*Signature*  
 02/01/10

ANITA SRIVASTAVA  
 A.T.P.

*Signature*

J.N.REDDY  
 T.P.