

AREA STATEMENT		VERSION NO. 1.0	VERSION DATE. 30/01/2024
PROJECT DETAIL			
Authority	Meerut Development Authority	Plot Use	Residential
Authority Class	Category B	Plot Sub Use	Picoted Res. development / Picoted Housing
Authority Grade	Development Authority (DA)	Development Plan	Master Plan
Case Track	Regular	Land Use Zone	Residential Use Zone
Project Type	Layout Development	Land Sub Use Zone	Residential Zone
Nature of Development	NEW	Layout Type	NA
Development Area	New Area		
Subdevelopment Area	Village Area		
Special Project	NA		
Site Address	District Meerut, Tehsil Meerut, Village NA		
AREA DETAILS		Sq.Mts.	
1. Area of Plot As per record			
Document Area		118461.70	
As per site condition		105909.96	
Area of Plot Considered		97286.03	
2. Deduction for			
(a) Proposed roads		0.00	
(b) Any reservations		8623.93	
Area not in Proposal		23.00	
Total (a + b)		8623.93	
3. Net Area of plot (1 - 2) AREA OF PLOT		97286.03	
Area not in Proposal		8623.93	
Green and open space		14620.66	
C. Tenement Statement			
A. Tenement Proposed As			

Color Index

PLOT BOUNDARY	Black
ABUTTING ROAD	Green
PROPOSED CONSTRUCTION	Red
COMMON PLOT	Yellow
ROAD ALIGNMENT (ROAD WIDENING AREA)	Blue
FUTURE T.P SCHEME DEDUCTION AREA	Light Blue
EXISTING (To be retained)	Light Green
EXISTING (To be demolished)	Light Yellow

Number of EWS/LIG unit required

Sl. No.	Plot Type	No. of Plot	No. of unit in one plot	Total Number of Unit	Proposed LG/EWS Unit
1.	Single Dwelling Unit	223	1	223	-
Total		223		223	-
Number of EWS/LIG unit required (10% LG)					
				23.00	0
Number of EWS/LIG unit required (10% EWS)					
				23.00	0
Total		223		269	-

Tenements Density Check

Net housing density	No. Of Tenements		No. Of Persons	
	Repld	Prop	Repld	Prop
750/hec	1460	884	7297	4420

Green and open space Area

Name	Prop. Area
GREEN 6	2731.22
GREEN 5	1214.76
GREEN 8	1535.53
GREEN 5	1085.68
GREEN 3	989.11
GREEN 4	799.91
GREEN 2	1368.61
GREEN 10	1925.77
GREEN 1	3010.47

Individual Amenity Check b)

Name	Repld	Minimum Area	Prop	Repld	Minimum Count	Prop
Convenient Shops	120.00	725.03	-	-	1.00	1.00
Sector Shopping	575.00	686.97	-	-	1.00	1.00
Kiosk/booth/Platform	67.50	142.94	-	-	9.00	9.00
Garbage Collection Center	135.00	156.30	9.00	9.00	9.00	9.00

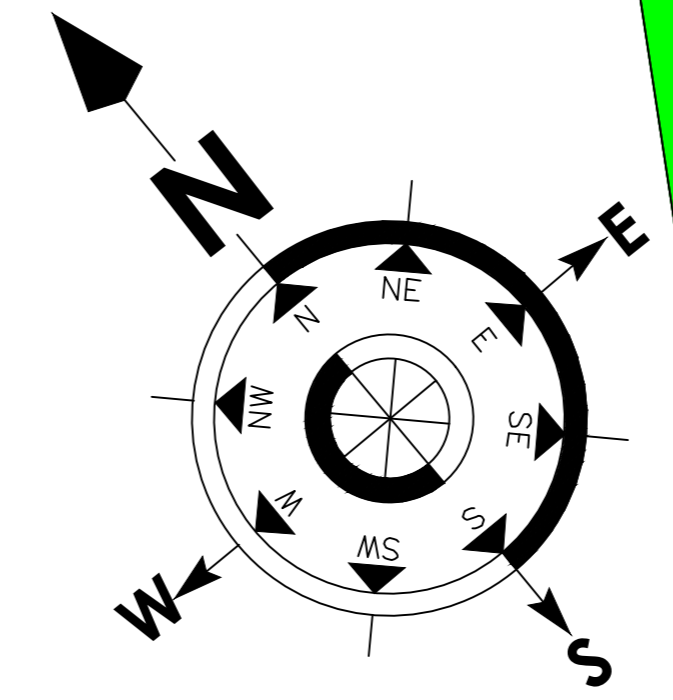
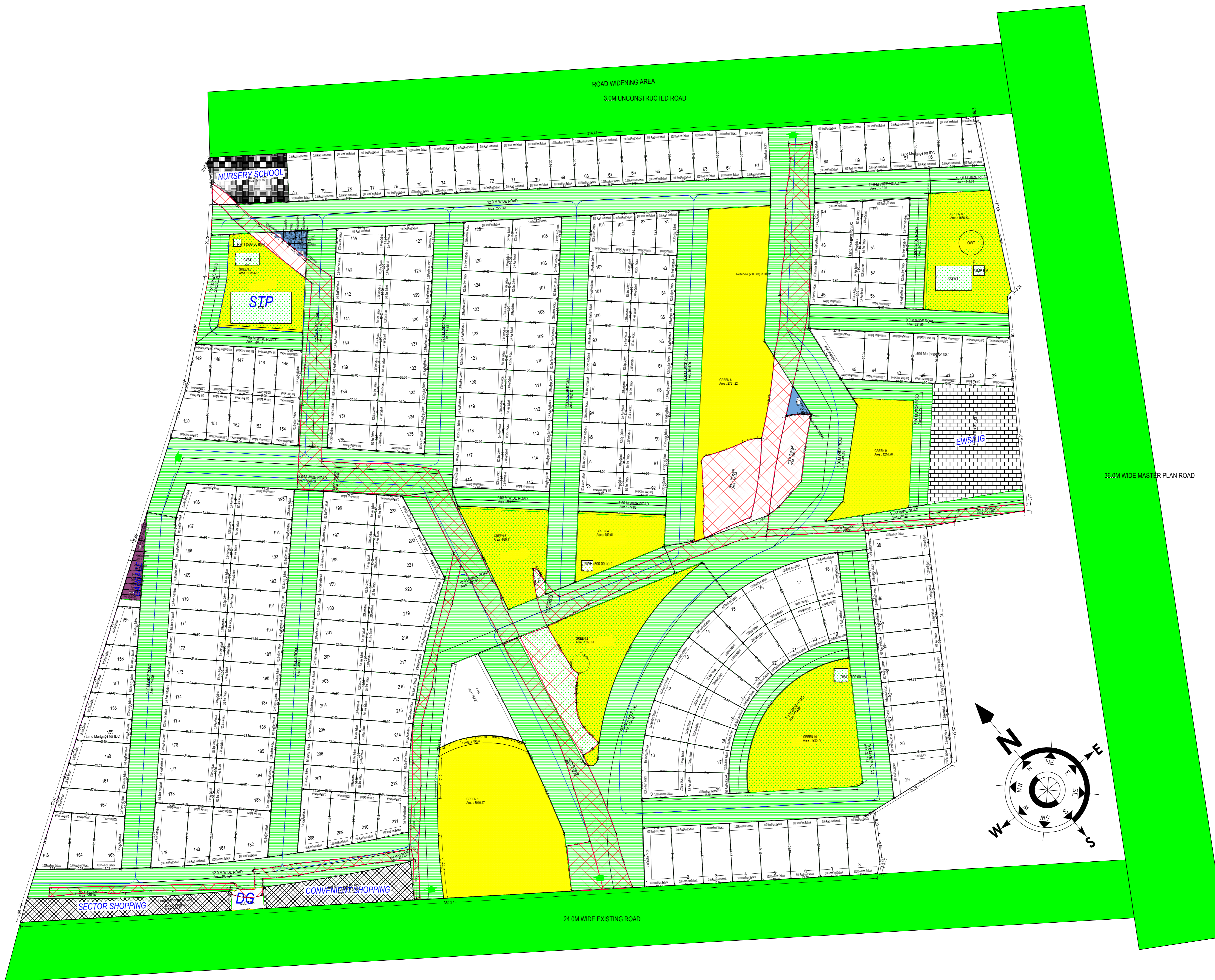

LAYOUT PLAN
(Scale - 1:2000)

Land use analysis/Area distribution (Table 2c)

Area covered under	Proposed Area in sq. mt	Percentage(%)
Plotted Area	48007.82	49.35
Provision For LG/EWS Area	1654.38	1.70
Road Area	29999.30	30.80
Garbage Collection Center	13.06	0.02
Garbage Collection Center	19.44	0.02
Garbage Collection Center	20.67	0.02
Garbage Collection Center	16.71	0.02
Garbage Collection Center	19.77	0.02
Garbage Collection Center	15.75	0.02
Garbage Collection Center	16.69	0.02
Garbage Collection Center	13.48	0.02
Garbage Collection Center	16.72	0.02
For Informal Area Kiosk/booth/Platform	7.54	0.01
For Informal Area Kiosk/booth/Platform	7.54	0.01
For Informal Area Kiosk/booth/Platform	13.84	0.01
For Informal Area Kiosk/booth/Platform	9.84	0.01
For Informal Area Kiosk/booth/Platform	13.18	0.01
For Informal Area Kiosk/booth/Platform	11.29	0.01
For Informal Area Kiosk/booth/Platform	7.61	0.01
For Informal Area Kiosk/booth/Platform	10.00	0.01
For Informal Area Kiosk/booth/Platform	61.40	0.06
Sector Shopping	686.87	0.71
Convenient Shops	725.03	0.75
Club	753.27	0.77
Nursery School	681.15	0.69
Public Open Space	14620.66	15.03
Total net layout	97286.51	100.00

OWNER'S NAME AND SIGNATURE
RAPID BUILDTECH PRIVATE LIMITED.
kunal.rish@rapidbuildtech.com, 9711312848

ARCHITECT'S NAME AND SIGNATURE
Arshi Agarwal
CA2016/79064

MEERUT DEVELOPMENT AUTHORITY

Building Plan Application Number
MDA/LD/22-23/0902

Sanctioned On
29 Apr 2024

Valid Till
26 May 2029

Approved By
Abhishek Pandey (Vice Chairman)

Examined By
Suresh Kumar Gupta (Junior engineer)

Vijay Kumar Singh (Town Planner)

Vijay Kumar Singh (Chief Town Planner)

Anand Kumar Singh (Secretary)

Abhishek Pandey (Vice Chairman)

Note: - 1) This drawing is prepared as per the current prevailing Building Bye Laws.
2) If Map sanctioned is used for purpose anything other than stated in application will lead to rejection of Map.

Total Plot Area: -	97286.03	Total FAR Area: -	0.00
Total Coverage Area: -	0.00	Total BUA Area: -	0.00

Plot No.	Plot Area	Frontage			Coverage			FAR Area			
		Road	Prop	Prop	Prop	Prop	Prop	Prop	Prop	Prop	
1	24.0M WIDE EXISTING ROAD	40.00	-	285.62	3.50	12.12	0.00	0.00	0.00	-	0.00
2	24.0M WIDE EXISTING ROAD	40.00	-	290.08	3.50	12.00	0.00	0.00	0.00	-	0.00
3	24.0M WIDE EXISTING ROAD	40.00	-	290.07	3.50	12.00	0.00	0.00	0.00	-	0.00
4	24.0M WIDE EXISTING ROAD	40.00	-	290.07	3.50	12.00	0.00	0.00	0.00	-	0.00
5	24.0M WIDE EXISTING ROAD	40.00	-	290.07	3.50	12.00	0.00	0.00	0.00	-	0.00
6	24.0M WIDE EXISTING ROAD	40.00	-	290.07	3.50	12.00	0.00	0.00	0.00	-	0.00
7	24.0M WIDE EXISTING ROAD	40.00	-	290.07	3.50	12.00	0.00	0.00	0.00	-	0.00
8	24.0M WIDE EXISTING ROAD	40.00	-	293.70	3.50	11.55	0.00	0.00	0.00	-	0.00
9	18.0M WIDE ROAD	40.00	-	192.06	3.50	11.34	0.00	0.00	0.00	-	0.00
10	18.0M WIDE ROAD	40.00	-	240.79	3.50	14.81	0.00	0.00	0.00	-	0.00
11	18.0M WIDE ROAD	40.00	-	240.79	3.50	14.81	0.00	0.00	0.00	-	0.00
12	18.0M WIDE ROAD	40.00	-	240.79	3.50	14.81	0.00	0.00	0.00	-	0.00
13	18.0M WIDE ROAD	40.00	-	240.79	3.50	14.81	0.00	0.00	0.00	-	0.00
14	18.0M WIDE ROAD	40.00	-	240.79	3.50	14.81	0.00	0.00	0.00	-	0.00
15	18.0M WIDE ROAD	40.00	-	240.79	3.50	14.81	0.00	0.00	0.00	-	0.00
16	18.0M WIDE ROAD	40.00	-	240.79	3.50	14.81	0.00	0.00	0.00	-	0.00
17	18.0M WIDE ROAD	40.00	-	240.79	3.50	14.81	0.00	0.00	0.00	-	0.00
18	18.0M WIDE ROAD	40.00	-	206.20	3.50	12.86	0.00	0.00	0.00	-	0.00
19	18.0M WIDE ROAD	40.00	-	155.27	3.50	25.21	0.00	0.00	0.00	-	0.00
20	7.5 M WIDE ROAD	40.00	-	188.73	3.50	9.03	0.00	0.00	0.00	-	0.00
21	7.5 M WIDE ROAD	40.00	-	188.73	3.50	9.03	0.00	0.00	0.00	-	0.00
22	7.5 M WIDE ROAD	40.00	-	188.73	3.50	9.03	0.00	0.00	0.00	-	0.00
23	7.5 M WIDE ROAD	40.00	-	188.73	3.50	9.03	0.00	0.00	0.00	-	0.00
24	7.5 M WIDE ROAD	40.00	-	188.73	3.50	9.03	0.00	0.00	0.00	-	0.00
25	7.5 M WIDE ROAD	40.00	-	188.73	3.50	9.03	0.00	0.00	0.00	-	0.00
26	7.5 M WIDE ROAD	40.00	-	188.73	3.50	9.03	0.00	0.00	0.00	-	0.00
27	7.5 M WIDE ROAD	40.00	-	188.73	3.50	9.03	0.00	0.00	0.00	-	0.00
28	12.0M WIDE ROAD	40.00	-	166.90	3.50	18.07	0.00	0.00	0.00	-	0.00
29	12.0M WIDE ROAD	40.00	-	300.50	3.50	17.89	0.00	0.00	0.00	-	0.00
30	12.0M WIDE ROAD	40.00	-	256.61	3.50	10.00	0.00	0.00	0.00	-	0.00
31	12.0M WIDE ROAD	40.00	-	257.79	3.50	10.00	0.00	0.00	0.00	-	0.00
32	12.0M WIDE ROAD	40.00	-	258.67	3.50	10.00	0.00	0.00	0.00	-	0.00
33	12.0M WIDE ROAD	40.00	-	257.98	3.50	10.00	0.00	0.00	0.00	-	0.00
34	12.0M WIDE ROAD	40.00	-	257.39	3.50	10.00	0.00	0.00	0.00	-	0.00
35	12.0M WIDE ROAD	40.00	-	256.79	3.50	10.00	0.00	0.00	0.00	-	0.00
36	12.0M WIDE ROAD	40.00	-	256.20	3.50	10.00	0.00	0.00	0.00	-	0.00
37	12.0M WIDE ROAD	40.00	-	255.61	3.50	10.00	0.00	0.00	0.00	-	0.00
38	18.0M WIDE ROAD	40.00	-	229.24	3.50	31.94	0.00	0.00	0.00	-	0.00
39	8.0M WIDE ROAD	40.00	-	212.84	3.50	9.55	0.00	0.00	0.00	-	0.00
40	8.0M WIDE ROAD	40.00	-	200.00	3.50	10.00	0.00	0.00	0.00	-	0.00
41	8.0M WIDE ROAD	40.00	-	200.00	3.50	10.00	0.00	0.00	0.00	-	0.00
42	8.0M WIDE ROAD	40.00	-	200.00	3.50	10.00	0.00	0.00	0.00	-	0.00
43	8.0M WIDE ROAD	40.00	-	200.00	3.50	10.00	0.00	0.00	0.00	-	0.00
44	8.0M WIDE ROAD	40.00	-	200.00	3.50	10.00	0.00	0.00	0.00	-	0.00
45	18.0M WIDE ROAD	40.00	-	324.16	3.50	24.38	0.00	0.00	0.00	-	0.00
46	18.0M WIDE ROAD	40.00	-	195.00	3.50	29.50	0.00	0.00	0.00	-	0.00
47	18.0M WIDE ROAD	40.00	-	195.00	3.50	10.00	0.00	0.00	0.00	-	0.00
48	18.0M WIDE ROAD	40.00	-	195.00	3.50	10.00	0.00	0.00	0.00	-	0.00
49	18.0M WIDE ROAD	40.00	-	243.16	3.50	31.10	0.00	0.00	0.00	-	0.00
50	12.0M WIDE ROAD	40.00	-	280.99	3.50	34.98	0.00	0.00	0.00	-	0.00
51	7.5 M WIDE ROAD	40.00	-	195.00	3.50	10.00	0.00	0.00	0.00	-	0.00
52	7.5 M WIDE ROAD	40.00	-	195.00	3.50	10.00	0.00	0.00	0.00	-	0.00
53	8.0M WIDE ROAD	40.00	-	195.00	3.50	19.50	0.00	0.00	0.00	-	0.00
54	18.0M WIDE ROAD	40.00	-	140.76	3.50	8.57	0.00	0.00	0.00	-	0.00
55	18.0M WIDE ROAD	40.00	-	200.00	3.50	10.00	0.00	0.00	0.00	-	0.00
56	12.0M WIDE ROAD	40.00	-	200.00	3.50	10.00	0.00	0.00	0.00	-	0.00
57	12.0M WIDE ROAD	40.00	-	200.00	3.50	10.00	0.00	0.00	0.00	-	0.00
58	12.0M WIDE ROAD	40.00	-	200.00	3.50	10.00	0.00	0.00	0.00	-	0.00
59	12.0M WIDE ROAD	40.00	-	200.00	3.50	10.00	0.00	0.00	0.00	-	0.00
60	18.0M WIDE ROAD	40.00	-	230.00	3.50	11.50	0.00	0.00	0.00	-	0.00
61	18.0M WIDE ROAD	40.00	-	232.83	3.50	11.64	0.00	0.00	0.00	-	0.00
62	12.0M WIDE ROAD	40.00	-	196.00	3.50	9.80	0.00	0.00	0.00	-	0.00
63	12.0M WIDE ROAD	40.00	-	196.00	3.50	9.80	0.00	0.00	0.00	-	0.00
64	12.0M WIDE ROAD	40.00	-	196.00	3.50	9.80	0.00	0.00	0.00	-	0.00

65	12.0M WIDE ROAD	40.00	-	196.00	3.50	9.80	0.00	0.00	0.00	-	0.00
66	12.0M WIDE ROAD	40.00	-	196.00	3.50	9.80	0.00	0.00	0.00	-	0.00
67	12.0M WIDE ROAD	40.00	-	196.00	3.50	9.80	0.00	0.00	0.00	-	0.00
68	12.0M WIDE ROAD	40.00	-	196.00	3.50	9.80	0.00	0.00	0.00	-	0.00
69	12.0M WIDE ROAD	40.00	-	196.00	3.50	9.80	0.00	0.00	0.00	-	0.00
70	12.0M WIDE ROAD	40.00	-	196.00	3.50	9.80	0.00	0.00	0.00	-	0.00
71	12.0M WIDE ROAD	40.00	-	196.00	3.50	9.80	0.00	0.00	0.00	-	0.00
72	12.0M WIDE ROAD	40.00	-	196.00	3.50	9.80	0.00	0.00	0.00	-	0.00
73	12.0M WIDE ROAD	40.00	-	196.00	3.50	9.80	0.00	0.00	0.00	-	0.00
74	12.0M WIDE ROAD	40.00	-	196.00	3.50	9.80	0.00	0.00	0.00	-	0.00
75	12.0M WIDE ROAD	40.00	-	196.00	3.50	9.80	0.00	0.00	0.00	-	0.00
76	12.0M WIDE ROAD	40.00	-	196.00	3.50	9.80	0.00	0.00	0.00	-	0.00
77	12.0M WIDE ROAD	40.00	-	196.00	3.50	9.80	0.00	0.00	0.00	-	0.00
78	12.0M WIDE ROAD	40.00	-	196.00	3.50	9.80	0.00	0.00	0.00	-	0.00
79	12.0M WIDE ROAD	40.00	-	196.00	3.50	9.80	0.00	0.00	0.00	-	0.00
80	12.0M WIDE ROAD	40.00	-	196.00	3.50	9.80	0.00	0.00	0.00	-	0.00
81	12.0M WIDE ROAD	40.00	-	162.95	3.50	18.54	0.00	0.00	0.00	-	0.00
82	12.0M WIDE ROAD	40.00	-	159.99	3.50	9.04	0.00	0.00	0.00	-	0.00
83	12.0M WIDE ROAD	40.00	-	180.00	3.50	10.00	0.00	0.00	0.00	-	0.00
84	12.0M WIDE ROAD	40.00	-	180.00	3.50	10.00	0.00	0.00	0.00	-	0.00
85	12.0M WIDE ROAD	40.00	-	180.00	3.50	10.00	0.00	0.00	0.00	-	0.00
86	12.0M WIDE ROAD	40.00	-	180.00	3.50	10.00	0.00	0.00	0.00	-	0.00
87	12.0M WIDE ROAD	40.00	-	180.00	3.50	10.00	0.00	0.00	0.00	-	0.00
88	12.0M WIDE ROAD	40.00	-	180.00	3.50	10.00	0.00	0.00	0.00	-	0.00
89	12.0M WIDE ROAD	40.00	-	180.00	3.50	10.00	0.00	0.00	0.00	-	0.00
90	12.0M WIDE ROAD	40.00	-	180.00	3.50	10.00	0.00	0.00	0.00	-	0.00
91	12.0M WIDE ROAD	40.00	-	180.00	3.50	10.00	0.00	0.00	0.00	-	0.00
92	12.0M WIDE ROAD	40.00	-	161.96	3.50	9.03	0.00	0.00	0.00	-	0.00
93	12.0M WIDE ROAD	40.00	-	161.96	3.50	27.00	0.00	0.00	0.00	-	0.00
94	12.0M WIDE ROAD	40.00	-	180.00	3.50	10.00	0.00	0.00	0.00	-	0.00
95	12.0M WIDE ROAD	40.00	-	180.00	3.50	10.00	0.00	0.00	0.00	-	0.00
96	12.0M WIDE ROAD	40.00	-	180.00	3.50	10.00	0.00	0.00	0.00	-	0.00
97	12.0M WIDE ROAD	40.00	-	180.00	3.50	10.00	0.00	0.00	0.00	-	0.00
98	12.0M WIDE ROAD	40.00	-	180.00	3.50	10.00	0.00	0.00	0.00	-	0.00
99	12.0M WIDE ROAD	40.00	-	180.00	3.50	10.00	0.00	0.00	0.00	-	0.00
100	12.0M WIDE ROAD	40.00	-	180.00	3.50	10.00	0.00	0.00	0.00	-	0.00
101	12.0M WIDE ROAD	40.00	-	180.00	3.50	10.00	0.00	0.00	0.00	-	0.00
102	12.0M WIDE ROAD	40.00	-	180.00	3.50	10.00	0.00	0.00	0.00	-	0.00
103	12.0M WIDE ROAD	40.00	-	147.22	3.50	9.04	0.00	0.00	0.00	-	0.00
104	12.0M WIDE ROAD	40.00	-	139.36	3.50	15.05	0.00	0.00	0.00	-	0.00
105	12.0M WIDE ROAD	40.00	-	258.24	3.50	13.88	0.00	0.00	0.00	-	0.00
106	12.0M WIDE ROAD	40.00	-	200.00	3.50	10.00	0.00	0.00	0.00	-	0.00
107	12.0M WIDE ROAD	40.00	-	200.00	3.50	10.00	0.00	0.00	0.00	-	0.00
108	12.0M WIDE ROAD	40.00	-	200.							

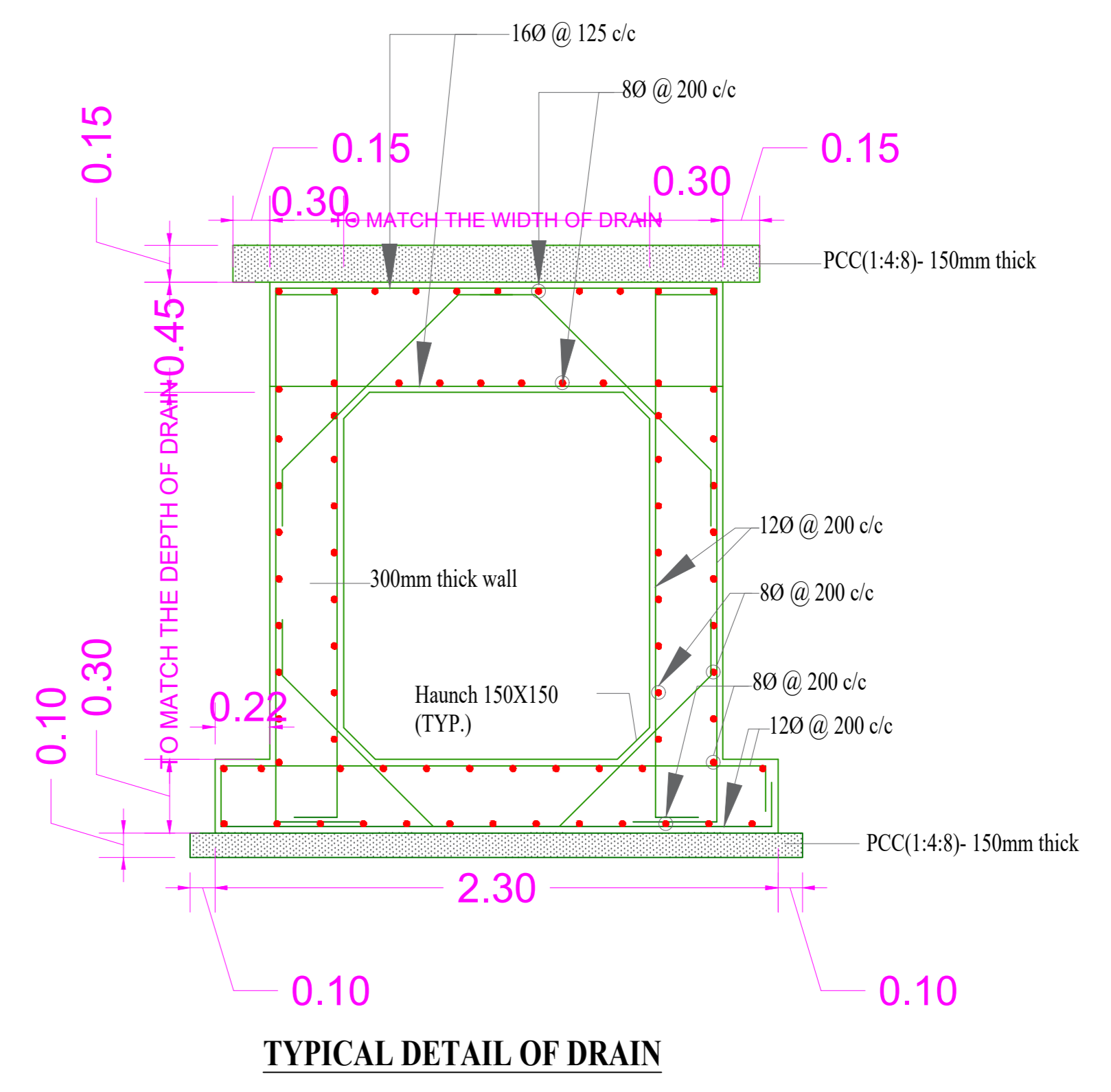
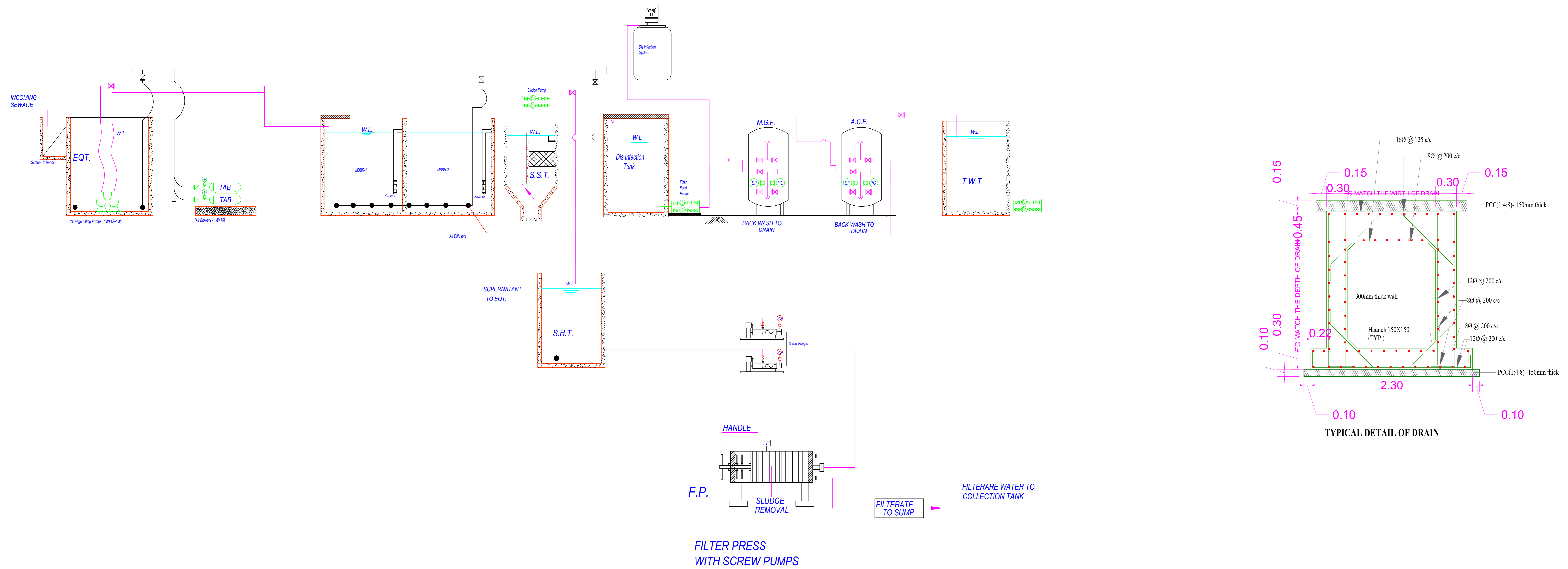

FILTER PRESS WITH SCREW PUMPS

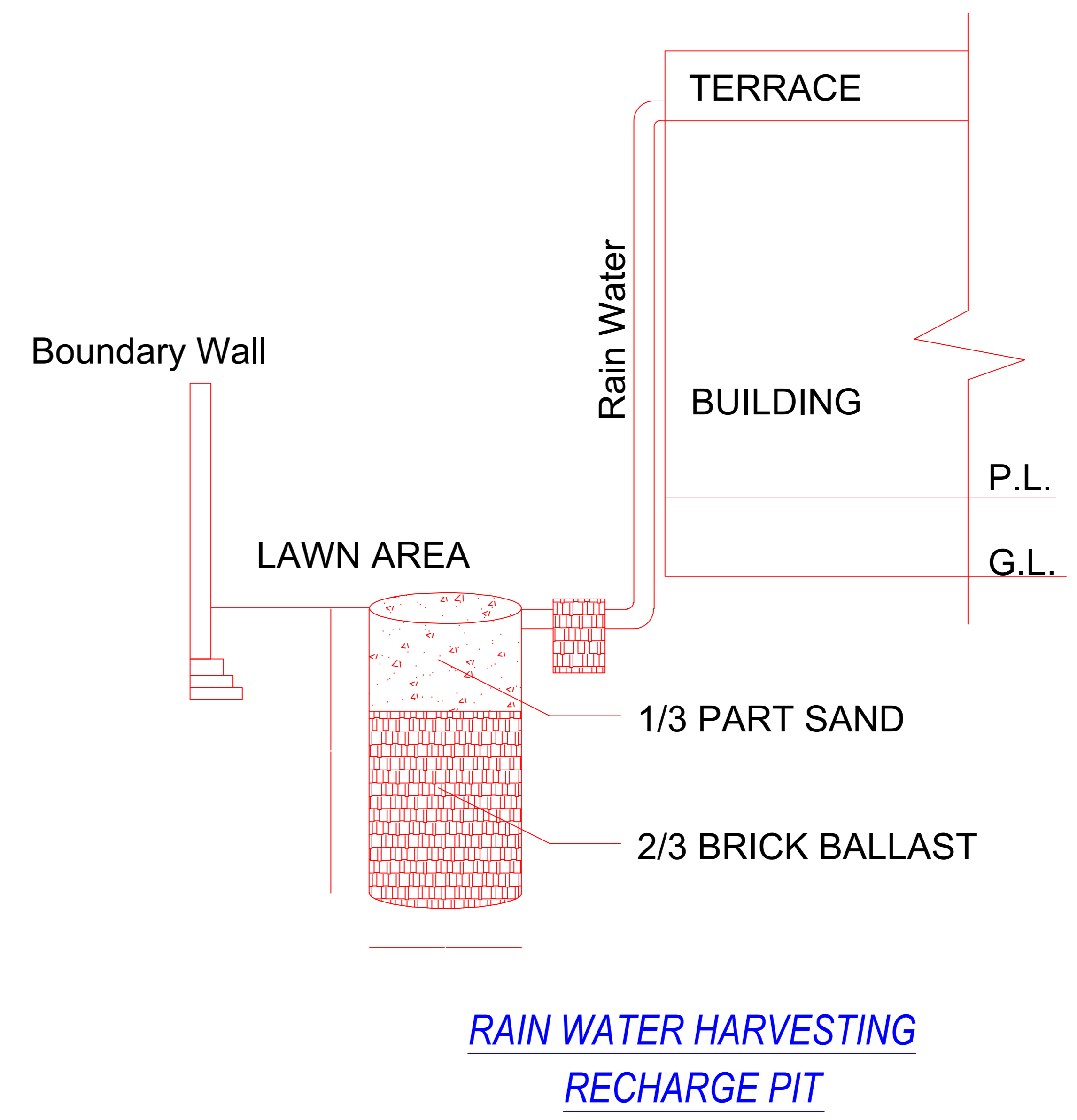

OWNER'S NAME AND SIGNATURE RAPID BUILDTECH PRIVATE LIMITED. kunal.rish@garstbuildtech.com, 9711312848	
ARCHITECT'S NAME AND SIGNATURE Ankit Agarwal CA/2016/79064	JRE ENGINEER
Meerut Development Authority	
Building Plan Application Number MDA/LD/22-23/0902	
Sanctioned On 29 Apr 2024	
Valid Till 26 May 2029	
Approved By Abhishek Pandey (Vice Chairman)	
Examined By Suresh Kumar Gupta (Junior engineer) Manoj Kumar Tiwari (Assistant Engineer) Vijay Kumar Singh (Town Planner) Vijay Kumar Singh (Chief Town Planner)	
Anand Kumar Singh (Secretary)	
Abhishek Pandey (Vice Chairman)	

Note: - 1) This drawing is prepared as per the current prevailing Building Bye Laws.
2) If Map sanctioned is used for purpose anything other than stated in application will lead to rejection of Map.

Total Plot Area: -	97286.03	Total FAR Area: -	0.00
Total Coverage Area: -	0.00	Total BUA Area: -	0.00

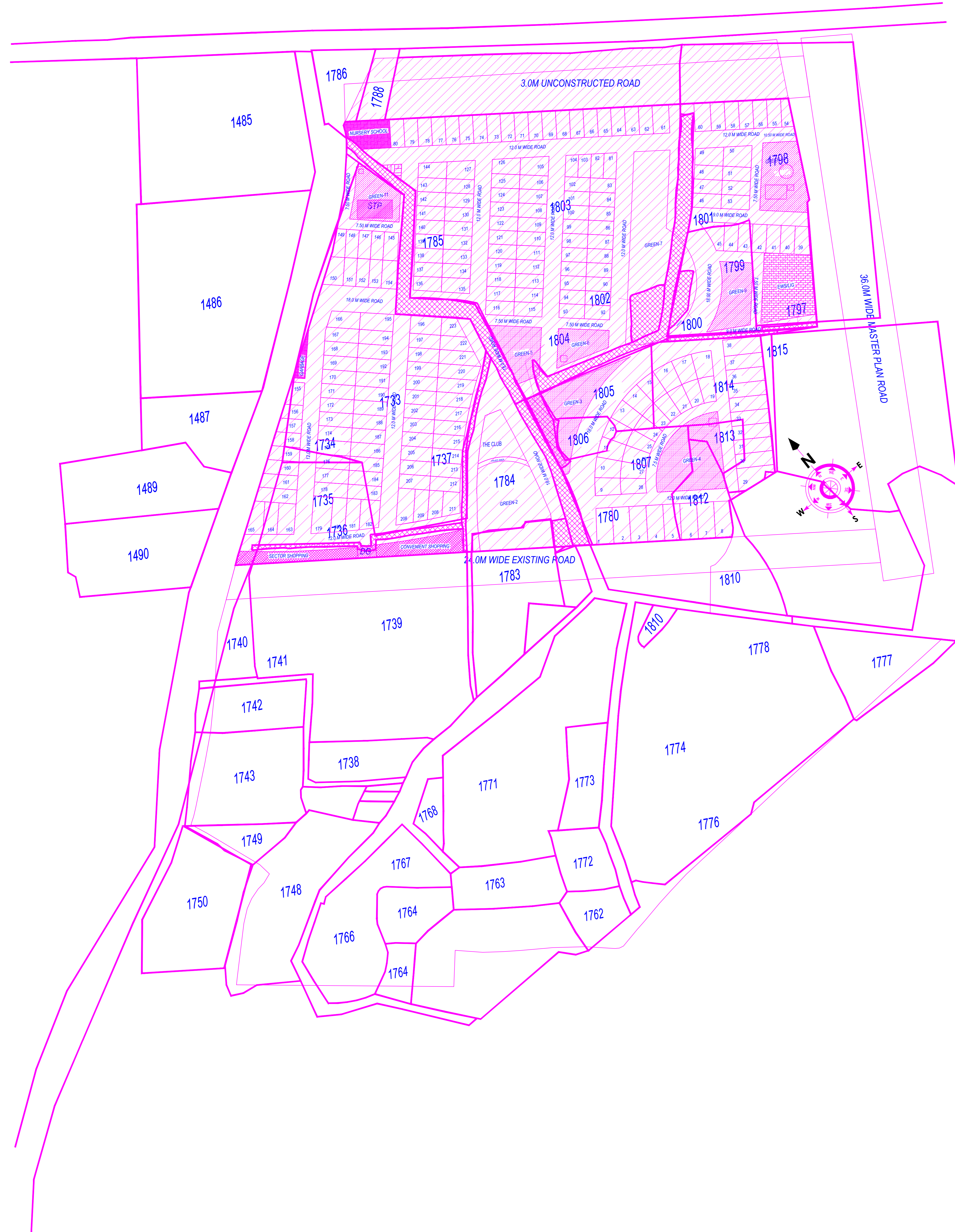

KHASRA NO. AS PER OWNERSHIP

KHASRA NO.	AREA IN HECTARES
1733	2.095
1734	0.051
1784	0.506
1806	0.114
1803/1	0.442
1805	0.304
1807	0.797
1813	0.101
1798	1.062
1799	0.443
1803/2	3.4520
1812	0.215
1814	0.649
1735	0.41780
TOTAL	10.6488

GOVERNMENT LAND DETAIL

क्र. स.	खाता संख्या	खसरा संख्या	क्षेत्रफल हे० म०	खातेदार का नाम	भूमि की श्रेणी
1	00929	1736	0.0440	चकमार्ग (प्रबंधन नगर निगम मेरठ)	श्रेणी-6-2/आकर्षिक भूमि - खल, सड़के, रेसवे भवन और ऐसी दूसरी भूमिमा जो आकर्षिक उपयोग के काम में लायी जाती है
2		1797	0.0570		
3		1737	0.0310		
4	00924	1780	0.0380	नाली (प्रबंधन नगर निगम मेरठ)	6-1/आकर्षिक भूमि - जलमग्न भूमि
5		1785	0.1900		
6		1801	0.1010		
7	00921	1800	0.0380	कूप पक्का (प्रबंधन नगर निगम मेरठ)	6-1/आकर्षिक भूमि - जलमग्न भूमि
8	00919	1802	0.0740	बंजर (प्रबंधन नगर निगम मेरठ)	श्रेणी-5-3-ड/अन्य कृषि योग्य बंजर भूमि
9		1804	0.0630		
		कुल योग	0.6360		

LEGEND

BOUNDARY	LAND USE
	KOOP PAKKA
	CHAK MARG
	NALI
	BANJAR AREA

AREA CHART

<p>AREAS PROVIDED : AREA FOR EWS/LIG = 1654.38 SQ.MT. GREEN PARK AREA = 1477.20 SQ.MT.= 15.18 % BLACK ROAD = 34831.96 SQ.MT. (35.80%) CLUB = 753.17 SQ.MT. SECTOR SHOPPING = 686.87 SQ.MT. CONVENIENT SHOPPING = 725.03 SQ.MT. NURSERY = 581.15 SQ.MT. GARBAGE AREA = 236.94 SQ.MT. AREA UNDER RESIDENTIAL PLOTS=48480.23 SQ.MT. TOTAL SALEABLE AREA= RES. PLOTS+SEC. SHOPPING+CONV. SHOPPING =48480.23+686.87+725.03=49892.13 SQ.MT. TOTAL SALEABLE AREA = 51.28 % MORTGAGE AREA = 10022.28 SQ.MT. (20.08 %)</p>	<p>TOTAL PLOT AREA = 10.6488 HECTARE (AS/DOCUMENT) OR 106488.0 SQ.MT. TOTAL PLOT AREA (AS/SITE) = 105909.96 SQ.MT. GOVT. LAND (AS/DOCUMENT) = 6360 SQ.MT. GOVT. LAND (AS/SITE) = 8620.38 SQ.MT. NET PLOT AREA = 105909.96 - 8620.38 = 97289.58 SQ.M. AREAS REQUIRED : GREEN PARK AREA 15% = 14593.43 SQ.MT. BLACK ROAD AREA 25% = 26477.49 SQ.MT. MORTGAGE AREA 20% = 49892.13*20% = 9978.426 SQ.MT.</p> <p>TOTAL NO. OF PLOTS = 223 EWS REQUIRED = 223*10%= 22.3 NOS. LIG REQUIRED = 223*10% = 22.3 NOS. AREA FOR EWS = 22.3*36 SQ.MT. = 780.5 SQM AREA FOR LIG = 22.3*41 SQ.MT. = 914.3 SQ.MT. TOTAL AREA FOR EWS & LIG = 1694.8 SQ.MT. F.A.R. FOR EWS/LIG = 2.0 PLOT REQUIRED FOR EWS/LIG = 1694.8/2=847.4 SQ.MT. AREA LEFT FOR EWS & LIG = 1654.38 SQ.MT.</p>
---	--

Note: - 1) This drawing is prepared as per the current prevailing Building Bye Laws.
 2) If Map sanctioned is used for purpose anything other than stated in application will lead to rejection of Map.

OWNER'S NAME AND SIGNATURE	
RAPID BUILDTECH PRIVATE LIMITED. kunal.rish@rapidbuildtech.com, 9711312848	
ARCHITECT'S NAME AND SIGNATURE	JRE ENGINEER
Ankit Agarwal CA2016/79064	
Meerut Development Authority	
Building Plan Application Number MDA/LD/22-23/0902	
Sanctioned On 29 Apr 2024	
Valid Till 26 May 2029	
Approved By Abhishek Pandey (Vice Chairman)	
Examined By Suresh Kumar Gupta (Junior engineer)	
Manoj Kumar Tiwari (Assistant Engineer)	
Vijay Kumar Singh (Town Planner)	
Vijay Kumar Singh (Chief Town Planner)	
Anand Kumar Singh (Secretary)	
Abhishek Pandey (Vice Chairman)	

Total Plot Area: -	97286.03	Total FAR Area: -	0.00
Total Coverage Area: -	0.00	Total BUA Area: -	0.00

MORTGAGE PLOTS

PLOT NO.S : 39, 40, 41, 42, 43, 44, 45, 46, 47, 48, 49, 50, 51, 52, 53, 54, 55, 56, 57, 58, 59, 149, 150, 151, 152, 153, 154, 155, 156, 157, 158, 159, 160, 161, 162, 163, 164, 165, + SECTOR SHOPPING + CONVENIENT SHOPPING AREAS

PLOT NO.	PLOT AREA (SQ.MT)	PLOT NO.	PLOT AREA (SQ.MT)
39	212.84	145	203.98
40	200.00	146	180.00
41	200.00	147	180.00
42	200.00	148	180.00
43	200.00	149	163.04
44	200.00	150	244.95
45	219.85	151	180.00
46	200.00	152	180.00
47	200.00	153	180.00
48	200.00	154	211.96
49	249.89	155	178.77
50	289.68	156	142.36
51	200.00	157	165.92
52	200.00	158	189.30
53	200.00	159	212.46
54	140.76	160	235.55
55	200.00	161	258.65
56	200.00	162	281.75
57	200.00	163	263.37
58	200.00	164	227.68
59	200.00	165	237.56
CONVENIENT SHOPPING	725.02	SECTOR SHOPPING	686.87

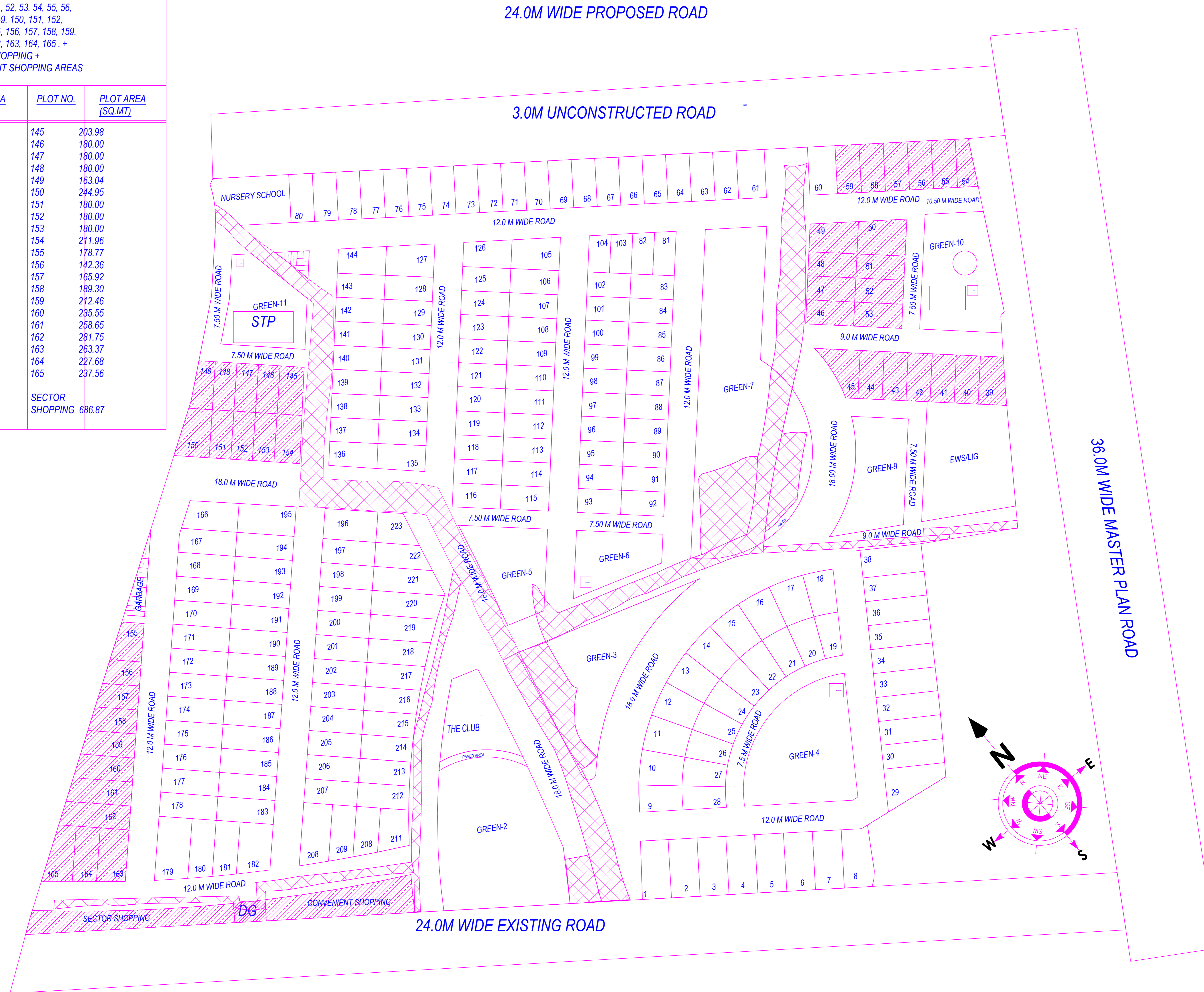

Note: - 1) This drawing is prepared as per the current prevailing Building Bye Laws.
2) If Map sanctioned is used for purpose anything other than stated in application will lead to rejection of Map.

Total Plot Area: -	97286.03	Total FAR Area: -	0.00
Total Coverage Area: -	0.00	Total BUA Area: -	0.00

OWNER'S NAME AND SIGNATURE
RAPID BUILDTECH PRIVATE LIMITED.
kunal.rish@rapidbuildtech.com, 9711312848

ARCHITECT'S NAME AND SIGNATURE
Ankit Agarwal
CA2016/79064

JRE ENGINEER



Building Plan Application Number

MDA/LD/22-23/0902

Sanctioned On:

29 Apr 2024

Valid Till

26 May 2029

Approved By

Abhishek Pandey (Vice Chairman)

Examined By

Servesh Kumar Gupta (Junior engineer)

Manoj Kumar Tiwari (Assistant Engineer)

Vijay Kumar Singh (Town Planner)

Vijay Kumar Singh (Chief Town Planner)

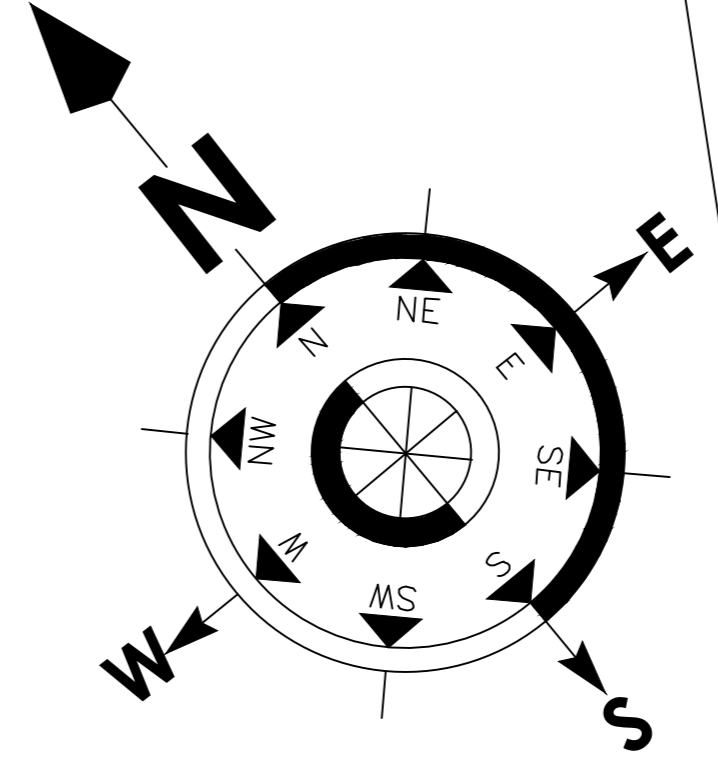
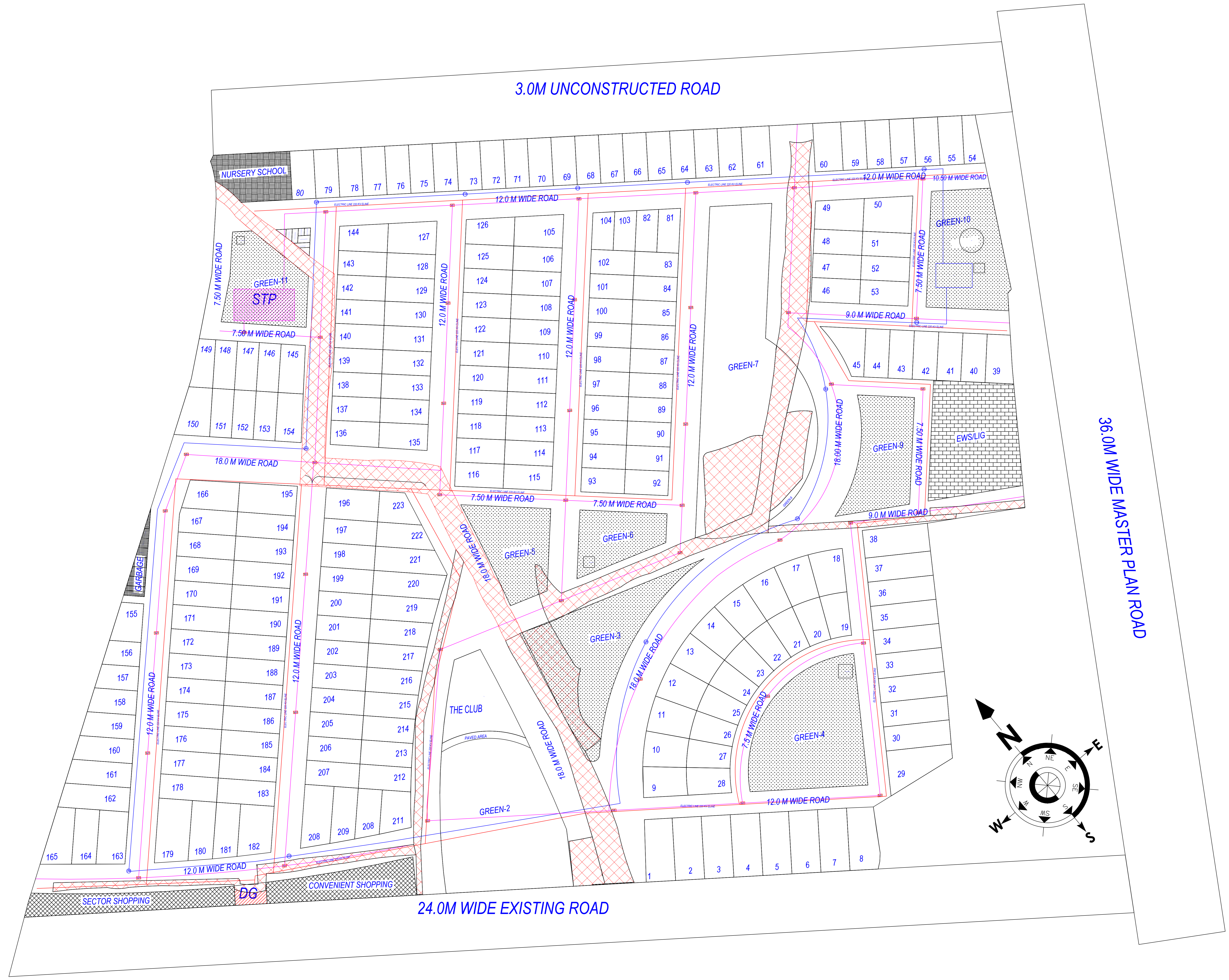

Anand Kumar Singh (Secretary)

Abhishek Pandey (Vice Chairman)



Note: - 1) This drawing is prepared as per the current prevailing Building Bye Laws.
 2) If Map sanctioned is used for purpose anything other than stated in application will lead to rejection of Map.

Total Plot Area: -	97286.03	Total FAR Area: -	0.00
Total Coverage Area: -	0.00	Total BUA Area: -	0.00



OWNER'S NAME AND SIGNATURE RAPID BUILDTECH PRIVATE LIMITED. kunal.rish@rapidbuildtech.com, 9711312848	
ARCHITECT'S NAME AND SIGNATURE Anil Agarwal CA2016/79064	JRE ENGINEER
Meerut Development Authority	
 	
Building Plan Application Number MDA/LD/22-23/0902	
Sanctioned On 29 Apr 2024	
Valid Till 26 May 2029	
Approved By Abhishek Pandey (Vice Chairman)	
Examined By Suresh Kumar Gupta (Junior engineer)	
Manoj Kumar Tiwari (Assistant Engineer)	
Vijay Kumar Singh (Town Planner)	
Vijay Kumar Singh (Chief Town Planner)	
Anand Kumar Singh (Secretary)	
Abhishek Pandey (Vice Chairman)	

24.0M WIDE PROPOSED ROAD

3.0M UNCONSTRUCTED ROAD

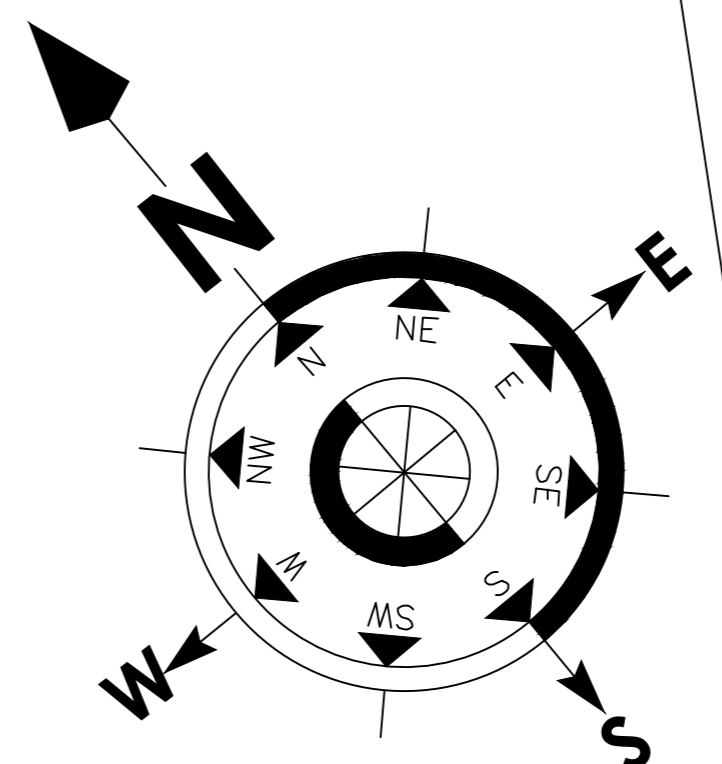
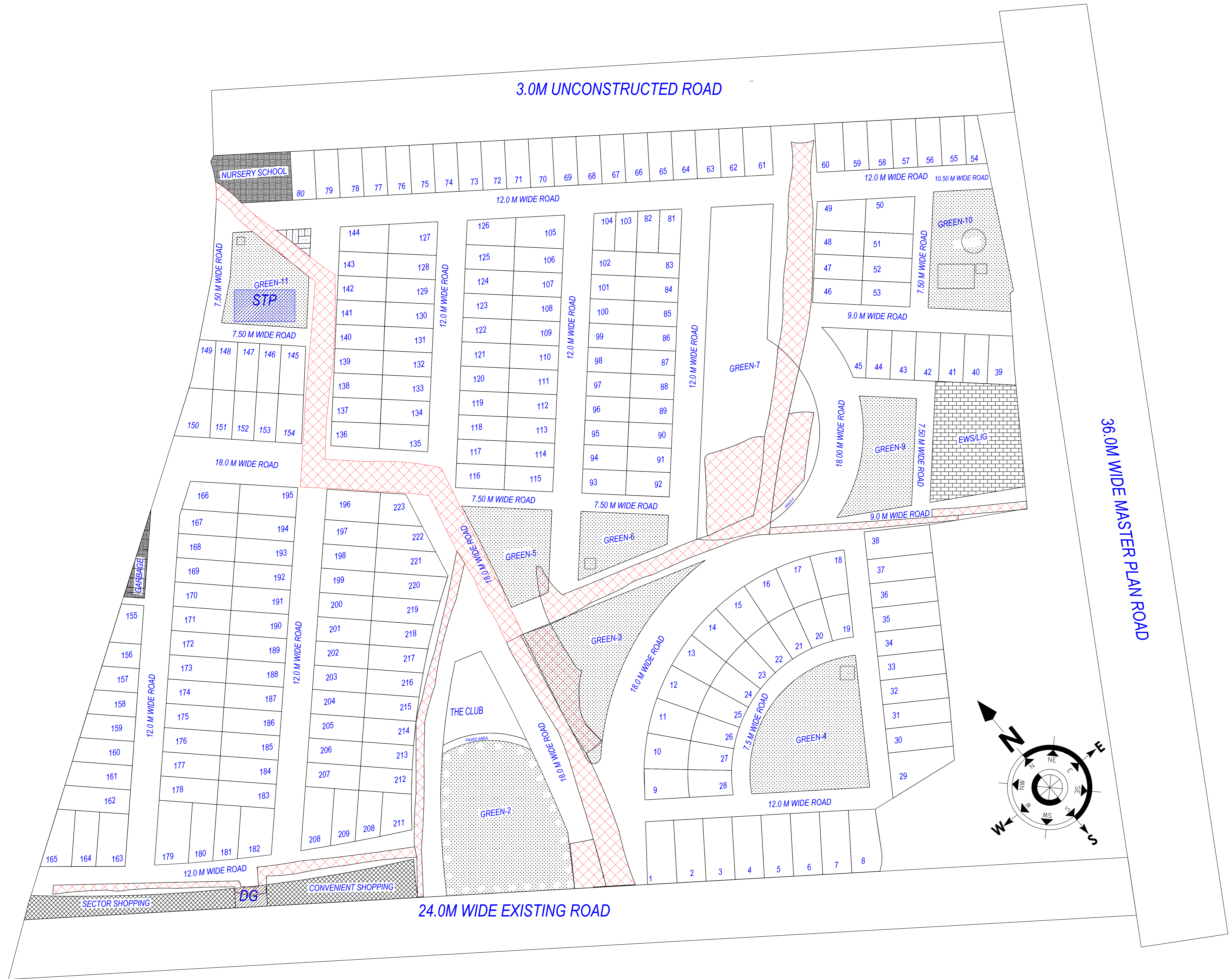
36.0M WIDE MASTER PLAN ROAD



OWNER'S NAME AND SIGNATURE RAPID BUILDTECH PRIVATE LIMITED. kunal.rish@globalsbuildtech.com, 9711312848	
ARCHITECT'S NAME AND SIGNATURE Ankit Agarwal CA/2016/79064	JRE ENGINEER
Meerut Development Authority	
 	
Building Plan Application Number MDA/LD/22-23/0902	
Sanctioned On 29 Apr 2024	
Valid Till 26 May 2029	
Approved By Abhishek Pandey (Vice Chairman)	
Examined By Suresh Kumar Gupta (Junior engineer) Manoj Kumar Tiwari (Assistant Engineer) Vijay Kumar Singh (Town Planner) Vijay Kumar Singh (Chief Town Planner) Anand Kumar Singh (Secretary)	
Abhishek Pandey (Vice Chairman)	

Note: - 1) This drawing is prepared as per the current prevailing Building Bye Laws.
2) If Map sanctioned is used for purpose anything other than stated in application will lead to rejection of Map.

Total Plot Area: -	97286.03	Total FAR Area: -	0.00
Total Coverage Area: -	0.00	Total BUA Area: -	0.00