

**LEENU SAHGAL** Digitally signed by LEENU SAHGAL Date: 2025.01.30 13:44:52 +05'30'

**OWNER SIGN**  
 Digitally signed by **Samyak Jain** Date: 2025.01.23 13:12:32 +05'30'

**ARCHITECT SIGN**  
 Digitally signed by **VISHAL SHARMA** Date: 2025.01.23 11:27:39 +05'30'

**CO-DEVELOPER SIGN**  
 Digitally signed by **Anubhav Jain** Date: 2025.01.23 11:50:35 +05'30'

**LAL SINGH** Digitally signed by LAL SINGH Date: 2025.01.24 19:29:51 +05'30'

**Amit Varma** Digitally signed by Amit Varma Date: 2025.01.24 10:12:21 +05'30'

**Sudheer Kumar** Digitally signed by Sudheer Kumar Date: 2025.01.27 15:38:39 +05'30'

- LEGENDS**
- F.A.R AREA
  - 15 % SERVICES AREA
  - NON F.A.R AREA
  - F.A.R AREA COMMUNITY CENTER
- NOTE - 13TH FLOOR IS OMITTED AND MARKED AS 12TH (A ) FLOOR

OWNER  
**M/S ASSOTECH INFRASTRUCTURE PVT. LTD.**

CO-DEVELOPER  
**M/S NORTHWIND ESTATES (P) LTD.**

SUBMISSION DRAWING

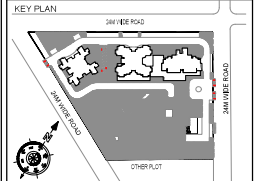

PROJECT  
 PROPOSED GROUP HOUSING FOR M/S ASSOTECH INFRASTRUCTURE PVT. LTD. AT PLOT NO - 07, ALISTOMA ESTATE IN SECTOR-PI, GREATER NOIDA, G.B. NAGAR, (U.P.)

DATE 26-11-2024	PROJECT INCH. BALRAJ SINGH	CHECKED BY BALRAJ SINGH
SCALE 1:100	DEALT BY DHEERAJ CHAND	APPROVED BY VISHAL SHARMA

DRAWING TITLE  
**SITE PLAN**

TERRACE LVL, PLAN

**ARCHITECTS**  
**Confluence**  
 NEW DELHI, INDIA  
 F-1, FIRST FLOOR, MIRA CORPORATE SUITES, BISHWAN NAGAR, NEW DELHI 110085  
 Ph: +91-11-26101884 confluence@confluence.com Member of IBCB  
 Pin: +91-11-42568769 www.confluence.com ISO - 9001:2000  
 architecture urban design hospitality

DRAWING NO. **S-03** REVISION