

NO. OF SHEETS	ISSUED TO	REMARKS

Greater Noida Industrial Dev. Authority
 APPROVED
 Date: 14/11/2014
 Valid up to Date: 14/11/2014

Gen. Manager
 (Plng. & Arch.)

Asstt. Arch.
 (Plng.)

NOTE :- WHEREVER DISTANCE BETWEEN ADJACENT BUILDING IS LESS THAN MINIMUM REQUIREMENT MENTIONED IN BUILDING REGULATION, BUILDINGS SHALL BE CONTIGUOUS.

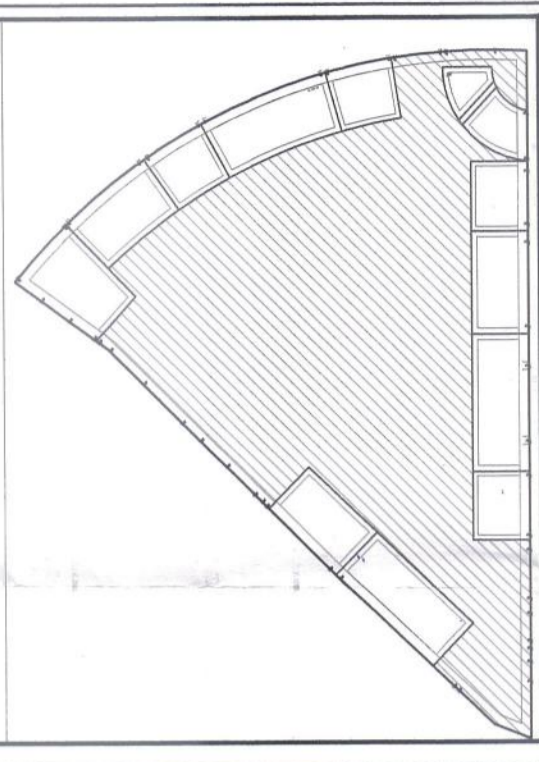

OWNER
 M/S EUPHORIA SPORTS CITY PVT. LTD.

SUBMISSION DRAWING

PROJECT
 REVISED LAYOUT PLAN OF SPORTS CITY AT SC-1 ADJOINING SECTOR TECHZONE-IV, GREATER NOIDA.

DATE
 SCALE
 NTS.

DRAWING TITLE
 LAYOUT PLAN

ARCHITECTS
 Ar. Rachit Sharma

DRAWING NO. 01
 REVISION

LEGEND :-

RECREATIONAL
RESIDENTIAL
COMMERCIAL

SC-01 AREA CALCULATION					
S.NO	PROPOSED LAND AREA FOR SC-01	RECREATIONAL	RESIDENTIAL	COMMERCIAL	TOTAL
1	PERMISSIBLE PROPOSED	288243	60840.36	2952	2952
2	PERMISSIBLE PROPOSED	306035.61	43048.39	2952	2952
GROUND COVERAGE CALCULATION					
2	PERMISSIBLE PROPOSED	69803.5	24924.4	2952	97680
3	PERMISSIBLE PROPOSED	62555.15	11996.70	2952	77503.85
TOTAL FAR CALCULATION					
3	PERMISSIBLE PROPOSED = (A)	136508.4	89146.9	11123	236778.50
4	PERMISSIBLE PROPOSED = (F)	130215.24	29558.31	5120.33	164893.88
TOTAL BASEMENT AREA					
4	PERMISSIBLE PROPOSED = (F)	50085.886	21456.21	739.94	50085.886
TOTAL					
4	PERMISSIBLE PROPOSED = (F)	27772.65	21456.21	739.94	49968.8

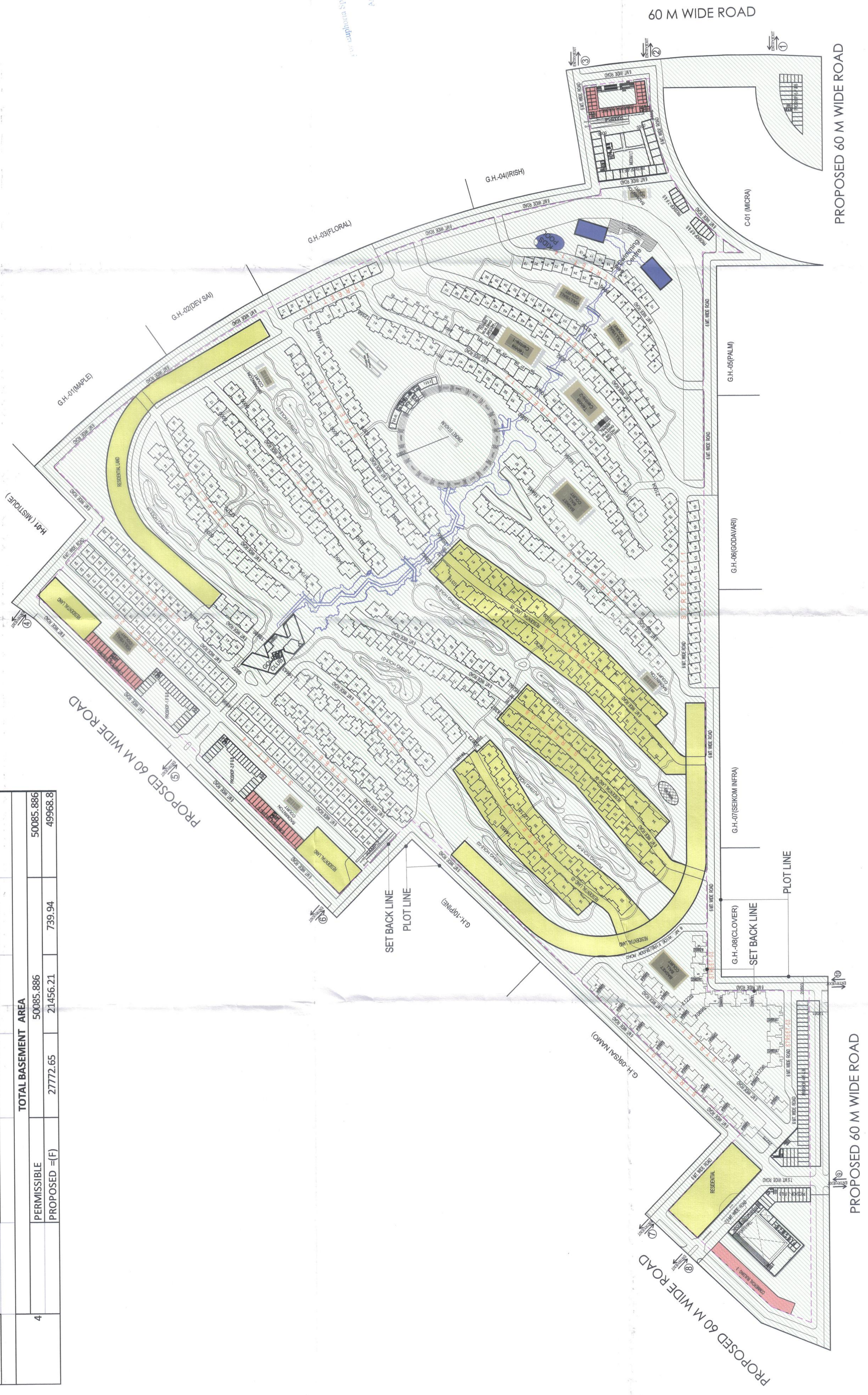

PROPOSED 60 M WIDE ROAD

PROPOSED 60 M WIDE ROAD

PROPOSED 80 M WIDE ROAD

PROPOSED 80 M WIDE ROAD

SET BACK LINE
 PLOT LINE

SET BACK LINE
 PLOT LINE

NORTH POINT