

AREA STATEMENT (CIRCULATION AREA)

S.NO.	SIZE	AREA(sq.mt.)
38	4.937x1.65	8.15
39	3.097x2.63	8.15
40	(1.568x0.919)/2	0.72
41	1.568x1.711	2.68
42	(0.866x1.476)/2	0.64
43	(0.329x0.56)/2	0.09
44	1.821x1.977	3.60
45	(0.718x1.222)/2	0.44
46	2.445x1.178	2.88
47	(1.82x3.102)/2	2.82
48	3.664x5.08	18.61
49	2.758x0.985	2.72
50	(1.02x1.738)/2	0.89
51	(2.758x0.752)/2	1.04
52	1.112x1.25	1.39
53	3.0x0.115	0.345
54	5.234x1.765	9.24
55	1.112x1.25	1.39
56	(2.758x0.752)/2	1.04
57	(1.02x1.738)/2	0.89
58	2.758x0.985	2.72
59	3.664x5.08	18.61
60	(1.82x3.102)/2	2.82
61	1.178x3.916	4.61
62	(0.718x1.222)/2	0.44
63	1.821x1.977	3.60
64	(0.329x0.56)/2	0.09
65	(0.866x1.476)/2	0.64
66	1.568x1.711	2.68
67	(1.568x0.919)/2	0.72
68	3.097x2.63	8.15
69	4.937x1.65	8.15
TOTAL		120.96

AREA STATEMENT (TYPICAL FLOOR AREA)

DESCRIPTION	AREA(sq.mt.)
TYPE-I (1no.)	39.33x1=39.33
TYPE-II (2no.)	47.98x2=95.96
TYPE-III (2no.)	47.98x2=95.96
TYPE-IV (2no.)	47.98x2=95.96
TYPE-V (1no.)	47.79x1=47.79
CIRCULATION AREA	120.92
TOTAL FLOOR AREA	495.74

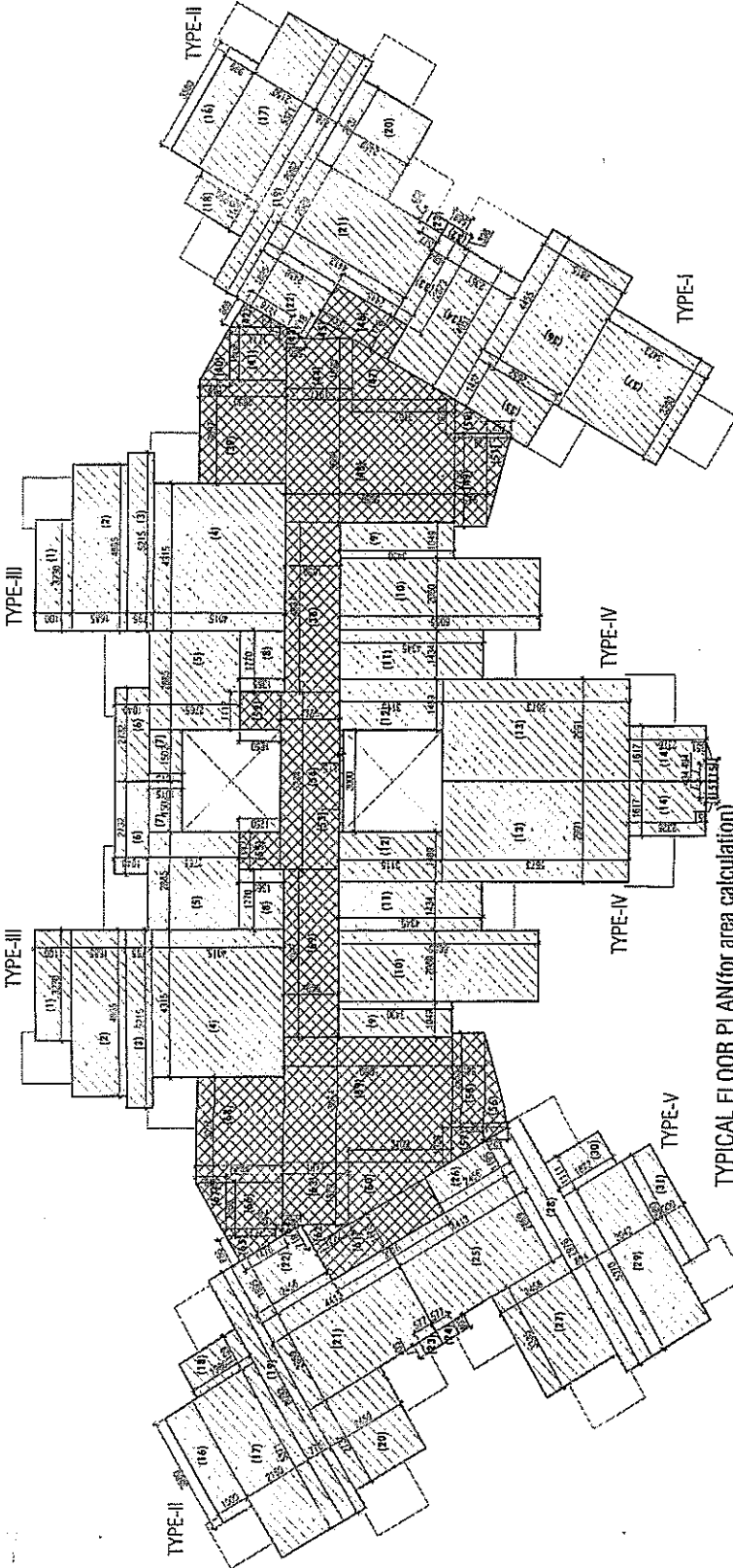

TYPICAL FLOOR PLAN (for area calculation)

AREA STATEMENT (TYPE-V)

S.NO.	SIZE	AREA(sq.mt.)
9	1.049x3.43	3.60
10	2.08x6.055	12.59
11	1.434x4.345	6.23
12	1.489x3.115	4.64
13	2.991x5.673	16.97
14	1.617x2.325	3.76
15	0.494x0.351	0.17
TOTAL		47.98

AREA STATEMENT (TYPE-III)

S.NO.	SIZE	AREA(sq.mt.)
1	1.1x3.23	3.553
2	4.865x1.685	8.20
3	5.215x0.795	4.15
4	4.315x4.015	17.32
5	2.885x2.765	7.98
6	2.732x1.04	2.84
7	1.5x1.015	1.52
8	1.77x1.365	2.42
TOTAL		47.98

AREA STATEMENT (TYPE-II)

S.NO.	SIZE	AREA(sq.mt.)
16	1.0x3.58	3.58
17	5.371x2.15	11.55
18	1.109x1.98	2.20
19	8.092x0.776	6.28
20	2.737x2.459	6.73
21	2.869x4.413	12.66
22	1.895x2.456	4.65
23	0.577x0.403	0.233
TOTAL		47.88

AREA STATEMENT (TYPE-I)

S.NO.	SIZE	AREA(sq.mt.)
32	0.398x0.568	0.23
33	0.484x2.873	1.39
34	4.051x2.361	9.56
35	1.427x2.652	3.78
36	4.455x2.815	12.54
37	3.393x3.473	11.77
TOTAL		39.33

DATED: 12.07.2017

AREA STATEMENT (TYPE-V)

S.NO.	SIZE	AREA(sq.mt.)
24	0.577x0.403	0.23
25	2.869x4.413	12.66
26	1.156x2.456	2.94
27	3.335x2.458	8.20
28	7.976x0.894	7.13
29	1.374x2.042	10.97
30	1.111x1.872	2.08
31	2.58x1.0	3.58
TOTAL		47.79

espaces
 Dr. Sanjay Kumar Gupta
 106 F- Floor, Corporate Chamber-1,
 Vignesh Khanna, Gauri Nagar,
 Lucknow-226001
 Ph.No. 4052564151, 4159
 email-espaces@espacesindia.com

ELDECO CITY LIMITED

DRG. NO.
 G.H.-06/Eldeco City/Submission/03

PROMOTER:
 ELDECO CITY LTD.

SCALE:
 1:100

**PROPOSED GROUP HOUSING
 ON PLOT NO. G.H.-06 AT ELDECO CITY,
 I.I.M. ROAD, LUCKNOW.**

1. The Engineer shall be responsible for the design of the structure and shall ensure that the design complies with the relevant codes and standards. The Engineer shall also be responsible for the preparation of the drawings and the issuance of the necessary permits. The Engineer shall not be responsible for the construction of the structure or for the safety of the structure during its use.

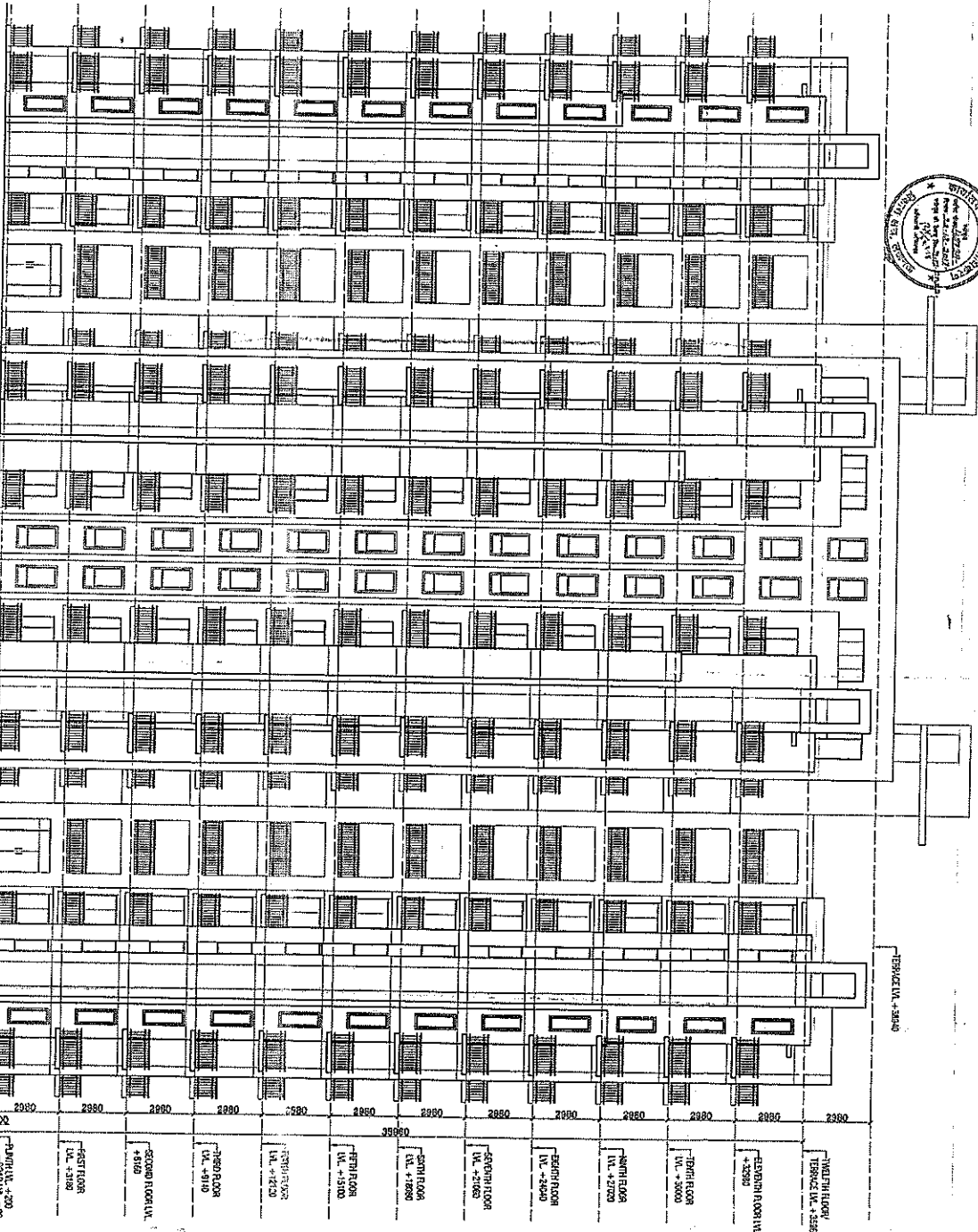

FRONT ELEVATION
(Scale 1:100)

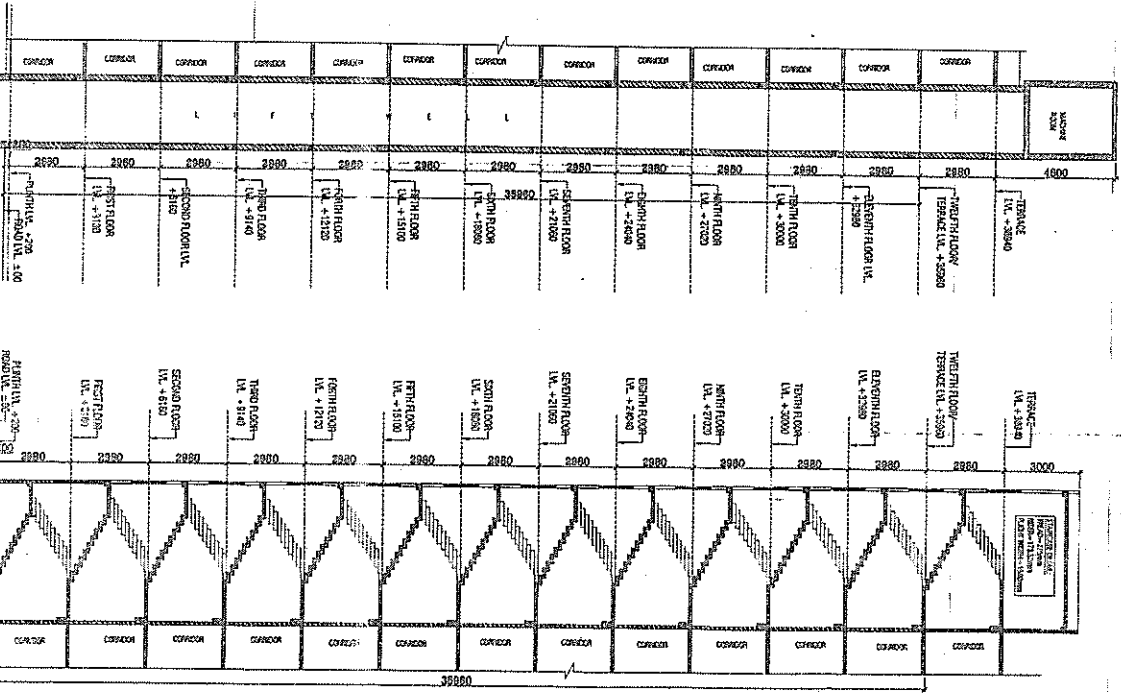

SECTION-1
(Scale 1:100)

SECTION-2
(Scale 1:100)

PROPOSED GROUP HOUSING
ON PLOT NO. G.H.-06 AT ELDECO CITY,
I.I.M.I. ROAD, LUCKNOW.

PROMOTER:
ELDECO CITY LTD.

DRG. NO.

G.H.-06/Eldeco City/Schubertshaw/02

SCALE:



At: Sangli Karmar Ganga
104 F, Floor, Crossak, Ganga Nagar,
Vadgaon, Pune-411004
Ph: 020-25611111, 25611112
www.spsarchitects.com, 25611111

DEVELOPER

