

NOTES

- THIS DEVELOPMENT HAS BEEN CONCEIVED, DESIGNED AND DRAWN ON THE BASIS OF THE FOLLOWING:
 - ALL USABLE OFFICE SPACES/RETAIL SPACES (LIKE SHOP AREAS, RESTROOMS, ETC.) SHALL BE PROVIDED WITH NATURAL VENTILATION THEREFORE PROVISION HAS BEEN MADE FOR NATURAL VENTILATION OF SPACES.
 - ALL TOILETS WILL BE MECHANICALLY PROVIDED (PROVISION OF FAN) AND VENTED OUT THROUGH A VENT SHAFT.
 - ALL SPACES (RETAIL SPACES, SERVICE AREAS, PARKING BASEMENT ETC) WILL BE ARTIFICIALLY LIT.
 - 100% STANDBY GENERATING CAPACITY WILL BE PROVIDED FOR THE ENTIRE BUILDING INCLUDING STANDBY GENERATION FOR ALL COMMON SERVICES, FIRE SERVICES, LIFTS ETC.
 - BASEMENT WILL BE MECHANICALLY (PROVISION OF HVAC) VENTILATED.
 - THIS BUILDING WILL BE SPRINKLED AS PER NBC, NORMS.
 - HANDICAP RAMP WITH RAILING PROVIDED.
 - ALL NON-TOWER SLABS ARE STRUCTURALLY DESIGNED AS PER FIRE TENDER LOAD.
 - THE PUBLIC HEALTH SERVICES I.E. WATER SUPPLY, SEWERAGE, STORM WATER DRAINAGE/RAIN WATER HARVESTING SCHEMES WILL BE PROVIDED AS PER PUBLIC HEALTH NORMS.
 - THE STRUCTURE OF THE BUILDING SHALL BE DESIGNED AND SUPPLIED BY A REGISTERED STRUCTURAL ENGINEER AND FULL COMPLIANCE WITH ALL APPLICABLE CODES SHALL BE MAINTAINED AT ALL TIMES.
 - THE OWNER SHALL BE PROVIDED WITH FIRE FIGHTING SYSTEM BEFORE OCCUPANCY OF THE BUILDING. A CERTIFICATE OF COMPLIANCE WITH ALL APPLICABLE CODES SHALL BE OBTAINED AT THE TIME OF SIGNING OFF THE DRAWINGS. THE FIRE FIGHTING SHALL BE COMPLETED AT THE TIME OF SIGNING OFF THE DRAWINGS.

GREEN AREA CALCULATIONS

GREEN AREA REQUIRED 25% OF OPEN AREA

OPEN AREA	=	PROT AREA	-	IMPOSED GROUND COVERAGE	
(A)	=	30602.00	-	4202.58	SOM
GREEN AREA PROVIDED	=	6367.44			SOM
GREEN AREA REQUIRED 25% OF (A)	=	1591.86			SOM
GREEN AREA PROVIDED	=	1725.61			SOM

TREE CALCULATIONS

TOTAL NO. OF TREES REQUIRED	OPEN AREA / 100	63.67
TOTAL NO. OF TREES PROVIDED	64	64

OTHERS FOOT

24MT SERVICE ROAD	
AREA=1000.00 SQ.M	

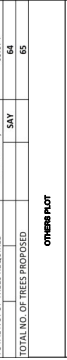

OWNER'S SIGN	ARCHITECT'S SIGN
--------------	------------------

OWNERS SIGN: KALPN GUPTA
 ARCHITECT'S SIGN: GIAN PRAKASH MATHUR

Digitally signed by KALPN GUPTA Date: 2025.09.27 16:05:28 +05'30'

Digitally signed by GIAN PRAKASH MATHUR Date: 2025.09.27 16:05:28 +05'30'

OWNER'S SIGN: PARTH BUILTECH PVT.LTD.
 ARCHITECT'S SIGN: NIRALA DIADEM

PROJECT: NIRALA DIADEM AT PLOT NO. C-6, SECTOR-10, GR. NOIDA WEST

SANCTION DRAWINGS: SITE PLAN

SCALE: 1:500 DRAWN: R-01

F.A.R. CALCULATIONS

TOTAL SITE AREA	10600.000	SQM
PERMISSIBLE F.A.R.	40	%
PROPOSED GROUND COVERAGE	39.93	%
PROPOSED F.A.R.	4.00	%
PERMISSIBLE SERVICE F.A.R.	4.00	%
PROPOSED SERVICE F.A.R.	15.00	%

AREA CALCULATIONS

FLOORS	FAR	15% SERVICE AREA	NON FAR	BUILT UP AREA
BASEMENT 02	0	327.141	7939.10	8266.246
BASEMENT 01	0	635.463	7923.96	8459.422
LOWER GROUND FLOOR	4400.822	307.854	795.88	5513.354
FIRST FLOOR (INCLUDING WATER ROOM @ 9 SQM)	4005.016	204.305	0.00	4209.321
SECOND FLOOR	3786.205	211.893	47.78	3426.874
THIRD FLOOR	3133.336	285.793	42.30	3460.426
FOURTH FLOOR (REFUGE FLOOR)	2327.771	211.439	36.82	2626.025
FIFTH FLOOR (SERVICE)	0.000	132.264	0.00	132.264
SIXTH FLOOR	0.000	409.076	1714.04	2123.117
SEVENTH FLOOR (REFUGE FLOOR)	1439.646	157.838	30.90	1628.386
EIGHTH FLOOR (REFUGE FLOOR)	1439.646	157.838	30.90	1628.386
NINTH FLOOR	1439.646	157.838	30.90	1628.386
TENTH FLOOR	1439.646	157.838	30.90	1628.386
ELEVENTH FLOOR (REFUGE FLOOR)	1439.646	157.838	30.90	1628.386
TWELFTH FLOOR (REFUGE FLOOR)	1439.646	157.838	30.90	1628.386
THIRTEENTH FLOOR (SERVICE)	1439.646	157.838	30.90	1628.386
FOURTEENTH FLOOR	1439.646	157.838	30.90	1628.386
FIFTEENTH FLOOR (REFUGE FLOOR)	1439.646	157.838	30.90	1628.386
SIXTEENTH FLOOR (REFUGE FLOOR)	1439.646	157.838	30.90	1628.386
SEVENTEENTH FLOOR	1439.646	157.838	30.90	1628.386
EIGHTEENTH FLOOR	1439.646	157.838	30.90	1628.386
NINETEENTH FLOOR	1439.646	157.838	30.90	1628.386
TWENTIETH FLOOR (REFUGE FLOOR)	1439.646	157.838	30.90	1628.386
TWENTY FIRST FLOOR	1439.646	157.838	30.90	1628.386
TWENTY SECOND FLOOR	1439.646	157.838	30.90	1628.386
MULTI MACHINE ROOM	0.000	195.801	0.00	195.801
WATER TANK	0.000	64.380	0.00	64.380
TOTAL FAR	42398.461	5988.820	20239.378	68926.059

PARKING CALCULATIONS

1. PLOT AREA	10600.00	SQM
2. PERMISSIBLE FAR	42400.00	SQM
3. PARKING REQUIRED @ 1 E.C/SQ SQM	888.0	ECS
PARKING PROVIDED		
1. GROUND FLOOR (SURFACE PARKING) @ 201 SQM	8	ECS
2. LOWER GROUND (MECHANICAL PARKING) @ 18 SQM	28	ECS
3. BASEMENT-1 (MECHANICAL PARKING) @ 18 SQM	396	ECS
4. BASEMENT-2 (MECHANICAL PARKING) @ 18 SQM	417	ECS
TOTAL PROPOSED PARKING	849	ECS

Digitally signed by Leenu Sahgal Date: 2025.09.27 12:26:40 +05'30'

Digitally signed by Minaksh Inarang Date: 2025.09.27 17:50:52 +05'30'

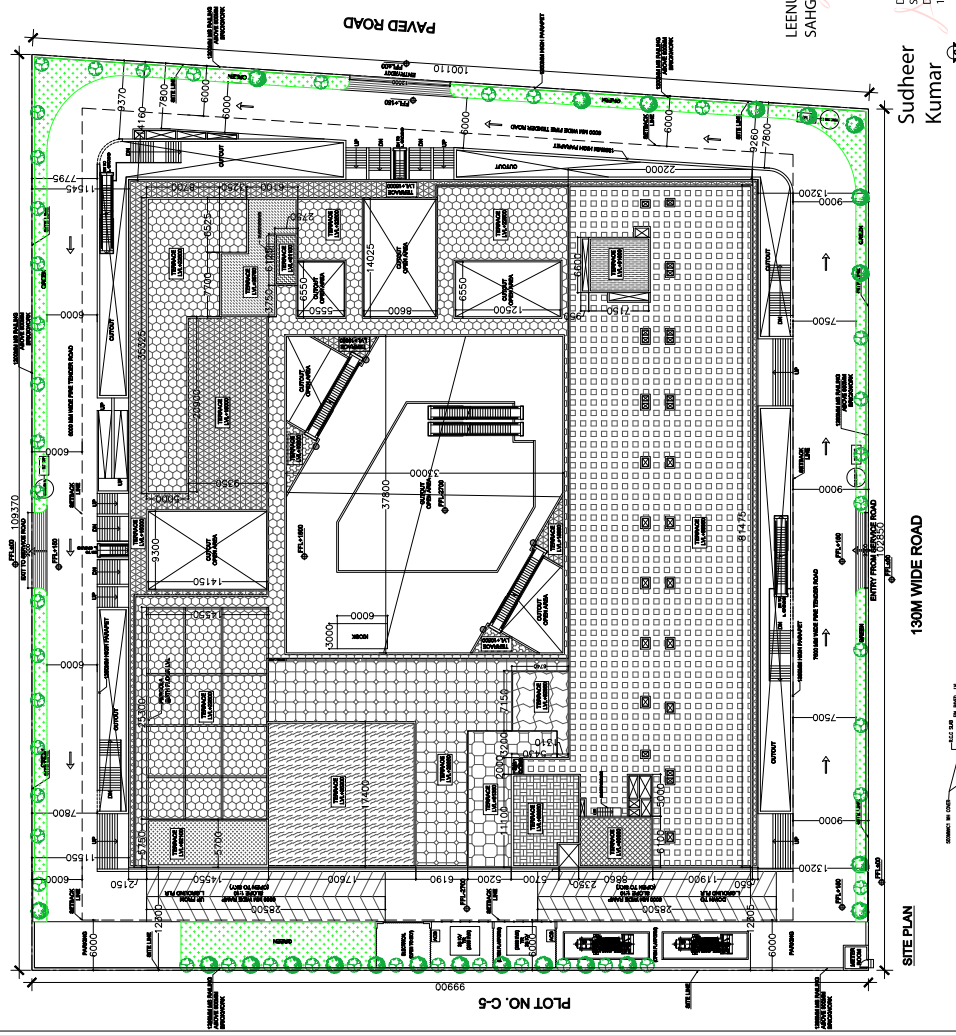

Digitally signed by Sudheer Kumar Date: 2025.09.27 13:32:25 +05'30'

Digitally signed by Leenu Sahgal Date: 2025.09.27 12:26:40 +05'30'



NOTE: ALL PARAPETS ARE 1350MM HIGH



BASEMENT 02 FLOOR PLAN

BASEMENT-2 AREA CALCULATION					
TOTAL MECHANICAL PARKING AREA - BASEMENT AREA		SERVICE AREA			
S.NO.	Dimension (M)	NOS.	AREA (SQ.M)		
A1	87.850	X	91.225	1	8014.116
A2	87.850	X	5.740	0.5	252.130
BASEMENT AREA (A)			8266.246		
RAMP AREA (B)		TOTAL NON F.A.R. AREA (B)			
B1	8.925	X	7.350	1	65.231
B2	AS/POLYLINE	X	24.780	1	24.280
B3	9.225	X	9.225	0.5	42.550
B4	AS/POLYLINE	X	1.930	1	1.930
B5	0.575	X	1.875	1	1.078
B6	9.800	X	4.140	1	40.572
TOTAL NON F.A.R. AREA (B)			175.64		

NON F.A.R. AREA (C)		SERVICE AREA (D)		TOTAL NON F.A.R. AREA (C)		TOTAL SERVICE AREA (D)	
N1	5.350	X	7.300	1	39.055		
N2	5.155	X	4.990	1	25.723		
N3	6.400	X	7.350	1	45.570		
N4	6.100	X	2.950	1	17.995		
N5	6.100	X	6.010	1	36.661		
N6	7.800	X	2.800	1	45.240		
N7	7.800	X	2.800	1	45.240		
N8	2.150	X	3.050	1	6.558		
TOTAL NON F.A.R. AREA (C)			259.92				
AS/POLYLINE		X	17.436	1	17.436		
S2	11.700	X	18.950	1	221.715		
S3	3.100	X	5.800	1	17.980		
S4	10.900	X	2.150	1	23.435		
S5	4.800	X	2.950	1	14.150		
S6	1.600	X	1.000	1	1.600		
S7	1.300	X	1.200	1	1.560		
S8	6.900	X	3.550	1	24.495		
S9	3.550	X	0.800	1	3.160		
S10	1.000	X	1.600	1	1.600		
TOTAL SERVICE AREA (D)			327.141				
TOTAL MECHANICAL PARKING AREA - (A+B+C)			7983.541				
MECHANICAL PARKING CAN BE PROVIDED @ 18 SCM			417				
TOTAL MECHANICAL PARKING IN BASEMENT-2			4169				
			347				



SP2-H CAR PARKING SYSTEM

Digitally signed by **Sudheer Kumar**
Date: 2025.10.03
13:34:03 +05'30'

Digitally signed by **Amit Varma**
Date: 2025.09.27
19:23:39 +05'30'

Digitally signed by **MINAKSHI NARANG**
Date: 2025.09.30
17:32:36 +05'30'

Digitally signed by **KALPN A GUPTA**
Date: 2025.09.27
16:36:39 +05'30'

Digitally signed by **GIAN PRAKASH MATHUR**
Date: 2025.09.27
16:06:19 +05'30'

CLIENT: **PARTH BUILTECH PVT.LTD.**

PROJECT: **NIRALA DIADEM AT PLOT NO. C-6, SECTOR-10, GR. NOIDA WEST**

TITLE: **BASEMENT-2 PLAN**

ARCHITECT'S SIGN

OWNER'S SIGN

DATE: 2025.10.03

SCALE: 1:200

DRAWING NO: B-02

Sanctioned by: **LEENU SAHGAL**
Date: 2025.10.14
12:06:55 +05'30'

Sanctioned by: **GIAN PRAKASH MATHUR**
Date: 2025.10.03
16:06:19 +05'30'

Sanctioned by: **MINAKSHI NARANG**
Date: 2025.09.30
17:32:36 +05'30'

Sanctioned by: **KALPN A GUPTA**
Date: 2025.09.27
16:36:39 +05'30'

Sanctioned by: **Sudheer Kumar**
Date: 2025.10.03
13:34:03 +05'30'

Sanctioned by: **Amit Varma**
Date: 2025.09.27
19:23:39 +05'30'

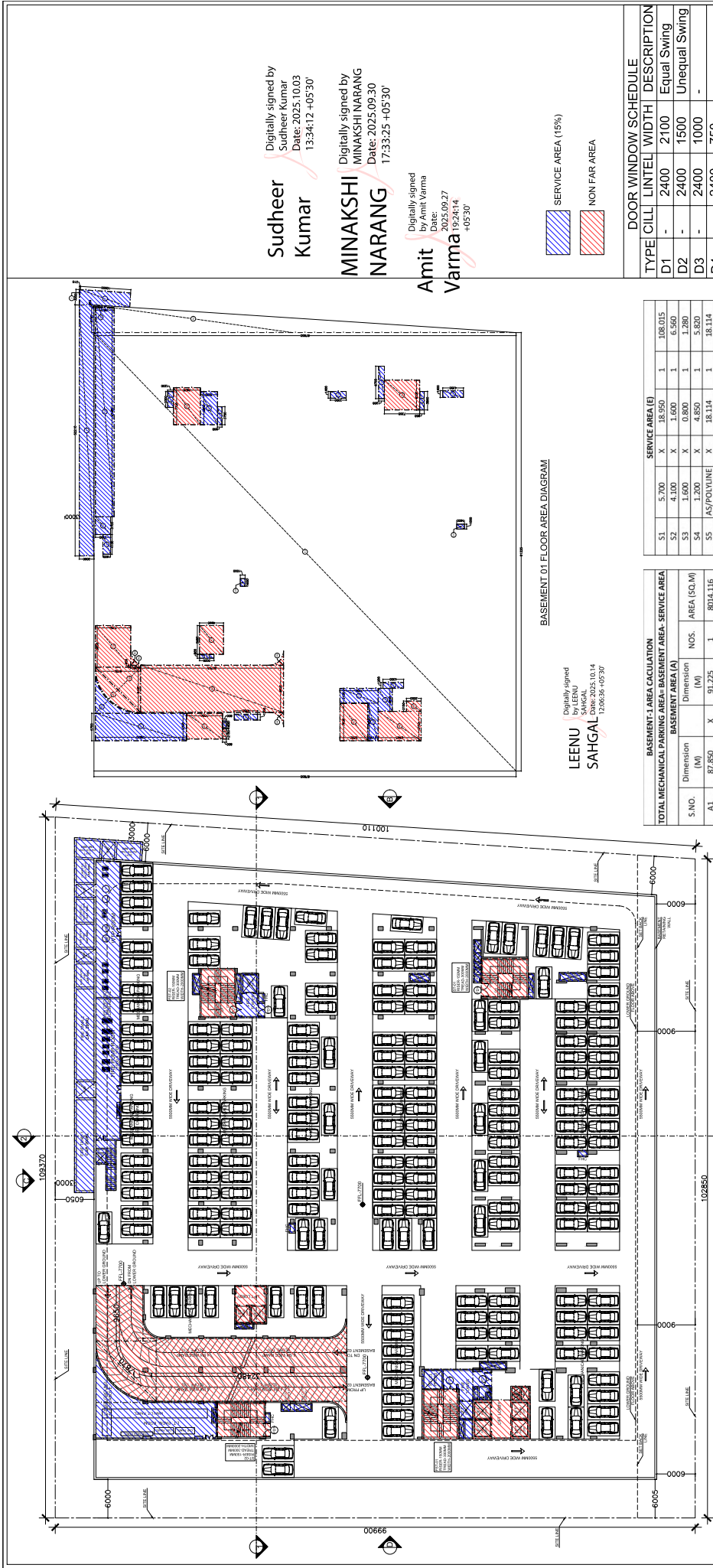

BASEMENT-1 AREA CALCULATION

TOTAL MECHANICAL PARKING AREA- BASEMENT AREA		BASEMENT AREA (A)		AREA (SQ. M)	
S.NO.	Dimension (M)	Dimension (M)	NOS.	Area (SQ. M)	
A1	87.850 X 91.225	91.225	1	8014.116	
A2	87.850 X 57.740	57.740	0.5	252.130	
1	52.210 X 3.050	3.050	1	159.241	
2	10.200 X 3.200	3.200	1	33.600	
3	3.200 X 0.210	0.210	0.5	0.336	
BASEMENT AREA (A)				8459.422	

TOTAL NON F.A.R. AREA (C)		NON F.A.R. AREA (D)	
S.NO.	Dimension (M)	Dimension (M)	NOS.
R1	8.650 X 7.350	7.350	1
R2	AS/POLYLINE	25.210	1
R3	9.400 X 9.400	9.400	0.5
R4	AS/POLYLINE	1.930	3
R5	0.400 X 2.050	2.050	1
R6	9.800 X 29.795	29.795	1
TOTAL NON F.A.R. AREA (C)		491.18	

TOTAL MECHANICAL PARKING AREA- SERVICE AREA		SERVICE AREA (E)		
S.NO.	Dimension (M)	Dimension (M)	NOS.	
S1	5.700 X 18.950	18.950	1	
S2	4.100 X 1.600	1.600	1	
S3	1.600 X 0.800	0.800	1	
S4	1.200 X 4.850	4.850	1	
S5	AS/POLYLINE	18.114	1	
S6	3.700 X 3.150	3.150	1	
S7	43.485 X 3.900	3.900	1	
S8	3.900 X 0.255	0.255	0.5	
S9	0.800 X 3.005	3.005	1	
S10	1.600 X 1.000	1.000	1	
S11	3.300 X 2.200	2.200	1	
S12	7.800 X 3.550	3.550	1	
S13	6.900 X 0.950	0.950	1	
S14	3.750 X 2.700	2.700	1	
S15	3.100 X 7.000	7.000	1	
S16	1.200 X 5.160	5.160	1	
S17	1.000 X 1.600	1.600	1	
S18	1.400 X 3.200	3.200	1	
S19	6.750 X 1.200	1.200	1	
S20	3.850 X 0.950	0.950	1	
S21	1.400 X 4.300	4.300	1	
S22	10.500 X 3.200	3.200	1	
S23	3.200 X 0.210	0.210	0.5	
TOTAL SERVICE AREA (E)				635.463

BASEMENT-1 AREA CALCULATION

TOTAL MECHANICAL PARKING AREA- BASEMENT AREA		BASEMENT AREA (A)		AREA (SQ. M)	
S.NO.	Dimension (M)	Dimension (M)	NOS.	Area (SQ. M)	
A1	87.850 X 91.225	91.225	1	8014.116	
A2	87.850 X 57.740	57.740	0.5	252.130	
1	52.210 X 3.050	3.050	1	159.241	
2	10.200 X 3.200	3.200	1	33.600	
3	3.200 X 0.210	0.210	0.5	0.336	
BASEMENT AREA (A)				8459.422	

TOTAL NON F.A.R. AREA (C)		NON F.A.R. AREA (D)	
S.NO.	Dimension (M)	Dimension (M)	NOS.
R1	8.650 X 7.350	7.350	1
R2	AS/POLYLINE	25.210	1
R3	9.400 X 9.400	9.400	0.5
R4	AS/POLYLINE	1.930	3
R5	0.400 X 2.050	2.050	1
R6	9.800 X 29.795	29.795	1
TOTAL NON F.A.R. AREA (C)		491.18	

TOTAL MECHANICAL PARKING AREA- SERVICE AREA		SERVICE AREA (E)		
S.NO.	Dimension (M)	Dimension (M)	NOS.	
S1	5.700 X 18.950	18.950	1	
S2	4.100 X 1.600	1.600	1	
S3	1.600 X 0.800	0.800	1	
S4	1.200 X 4.850	4.850	1	
S5	AS/POLYLINE	18.114	1	
S6	3.700 X 3.150	3.150	1	
S7	43.485 X 3.900	3.900	1	
S8	3.900 X 0.255	0.255	0.5	
S9	0.800 X 3.005	3.005	1	
S10	1.600 X 1.000	1.000	1	
S11	3.300 X 2.200	2.200	1	
S12	7.800 X 3.550	3.550	1	
S13	6.900 X 0.950	0.950	1	
S14	3.750 X 2.700	2.700	1	
S15	3.100 X 7.000	7.000	1	
S16	1.200 X 5.160	5.160	1	
S17	1.000 X 1.600	1.600	1	
S18	1.400 X 3.200	3.200	1	
S19	6.750 X 1.200	1.200	1	
S20	3.850 X 0.950	0.950	1	
S21	1.400 X 4.300	4.300	1	
S22	10.500 X 3.200	3.200	1	
S23	3.200 X 0.210	0.210	0.5	
TOTAL SERVICE AREA (E)				635.463

BASEMENT-1 AREA CALCULATION

TOTAL MECHANICAL PARKING AREA- BASEMENT AREA		BASEMENT AREA (A)		AREA (SQ. M)	
S.NO.	Dimension (M)	Dimension (M)	NOS.	Area (SQ. M)	
A1	87.850 X 91.225	91.225	1	8014.116	
A2	87.850 X 57.740	57.740	0.5	252.130	
1	52.210 X 3.050	3.050	1	159.241	
2	10.200 X 3.200	3.200	1	33.600	
3	3.200 X 0.210	0.210	0.5	0.336	
BASEMENT AREA (A)				8459.422	

TOTAL NON F.A.R. AREA (C)		NON F.A.R. AREA (D)	
S.NO.	Dimension (M)	Dimension (M)	NOS.
R1	8.650 X 7.350	7.350	1
R2	AS/POLYLINE	25.210	1
R3	9.400 X 9.400	9.400	0.5
R4	AS/POLYLINE	1.930	3
R5	0.400 X 2.050	2.050	1
R6	9.800 X 29.795	29.795	1
TOTAL NON F.A.R. AREA (C)		491.18	

TOTAL MECHANICAL PARKING AREA- SERVICE AREA		SERVICE AREA (E)		
S.NO.	Dimension (M)	Dimension (M)	NOS.	
S1	5.700 X 18.950	18.950	1	
S2	4.100 X 1.600	1.600	1	
S3	1.600 X 0.800	0.800	1	
S4	1.200 X 4.850	4.850	1	
S5	AS/POLYLINE	18.114	1	
S6	3.700 X 3.150	3.150	1	
S7	43.485 X 3.900	3.900	1	
S8	3.900 X 0.255	0.255	0.5	
S9	0.800 X 3.005	3.005	1	
S10	1.600 X 1.000	1.000	1	
S11	3.300 X 2.200	2.200	1	
S12	7.800 X 3.550	3.550	1	
S13	6.900 X 0.950	0.950	1	
S14	3.750 X 2.700	2.700	1	
S15	3.100 X 7.000	7.000	1	
S16	1.200 X 5.160	5.160	1	
S17	1.000 X 1.600	1.600	1	
S18	1.400 X 3.200	3.200	1	
S19	6.750 X 1.200	1.200	1	
S20	3.850 X 0.950	0.950	1	
S21	1.400 X 4.300	4.300	1	
S22	10.500 X 3.200	3.200	1	
S23	3.200 X 0.210	0.210	0.5	
TOTAL SERVICE AREA (E)				635.463

BASEMENT-1 AREA CALCULATION

TOTAL MECHANICAL PARKING AREA- BASEMENT AREA		BASEMENT AREA (A)		AREA (SQ. M)	
S.NO.	Dimension (M)	Dimension (M)	NOS.	Area (SQ. M)	
A1	87.850 X 91.225	91.225	1	8014.116	
A2	87.850 X 57.740	57.740	0.5	252.130	
1	52.210 X 3.050	3.050	1	159.241	
2	10.200 X 3.200	3.200	1	33.600	
3	3.200 X 0.210	0.210	0.5	0.336	
BASEMENT AREA (A)				8459.422	

TOTAL NON F.A.R. AREA (C)		NON F.A.R. AREA (D)	
S.NO.	Dimension (M)	Dimension (M)	NOS.
R1	8.650 X 7.350	7.350	1
R2	AS/POLYLINE	25.210	1
R3	9.400 X 9.400	9.400	0.5
R4	AS/POLYLINE	1.930	3
R5	0.400 X 2.050	2.050	1
R6	9.800 X 29.795	29.795	1
TOTAL NON F.A.R. AREA (C)		491.18	

TOTAL MECHANICAL PARKING AREA- SERVICE AREA		SERVICE AREA (E)		
S.NO.	Dimension (M)	Dimension (M)	NOS.	
S1	5.700 X 18.950	18.950	1	
S2	4.100 X 1.600	1.600	1	
S3	1.600 X 0.800	0.800	1	
S4	1.200 X 4.850	4.850	1	
S5	AS/POLYLINE	18.114	1	
S6	3.700 X 3.150	3.150	1	
S7	43.485 X 3.900	3.900	1	
S8	3.900 X 0.255	0.255	0.5	
S9	0.800 X 3.005	3.005	1	
S10	1.600 X 1.000	1.000	1	
S11	3.300 X 2.200	2.200	1	
S12	7.800 X 3.550	3.550	1	
S13	6.900 X 0.950	0.950	1	
S14	3.750 X 2.700	2.700	1	
S15	3.100 X 7.000	7.000	1	
S16	1.200 X 5.160	5.160	1	
S17	1.000 X 1.600	1.600	1	
S18	1.400 X 3.200	3.200	1	
S19	6.750 X 1.200	1.200	1	
S20	3.850 X 0.950	0.950	1	
S21	1.400 X 4.300	4.300	1	
S22	10.500 X 3.200	3.200	1	
S23	3.200 X 0.210	0.210	0.5	
TOTAL SERVICE AREA (E)				635.463

BASEMENT-1 AREA CALCULATION

TOTAL MECHANICAL PARKING AREA- BASEMENT AREA		BASEMENT AREA (A)		AREA (SQ. M)	
S.NO.	Dimension (M)	Dimension (M)	NOS.	Area (SQ. M)	
A1	87.850 X 91.225	91.225	1	8014.116	
A2	87.850 X 57.740	57.740	0.5	252.130	
1	52.210 X 3.050	3.050	1	159.241	
2	10.200 X 3.200	3.200	1	33.600	
3	3.200 X 0.210	0.210	0.5	0.336	
BASEMENT AREA (A)				8459.422	

TOTAL NON F.A.R. AREA (C)		NON F.A.R. AREA (D)	
S.NO.	Dimension (M)	Dimension (M)	NOS.
R1	8.650 X 7.350	7.350	1
R2	AS/POLYLINE	25.210	1
R3	9.400 X 9.400	9.400	0.5
R4	AS/POLYLINE	1.930	3
R5	0.400 X 2.050	2.050	1
R6	9.800 X 29.795	29.795	1
TOTAL NON F.A.R. AREA (C)		491.18	

TOTAL MECHANICAL PARKING AREA- SERVICE AREA		SERVICE AREA (E)		
S.NO.	Dimension (M)	Dimension (M)	NOS.	
S1	5.700 X 18.950	18.950	1	
S2	4.100 X 1.600	1.600	1	
S3	1.600 X 0.800	0.800	1	
S4	1.200 X 4.850	4.850	1	
S5	AS/POLYLINE	18.114	1	
S6	3.700 X 3.150	3.150	1	
S7	43.485 X 3.900	3.900	1	
S8	3.900 X 0.255	0.255	0.5	
S9	0.800 X 3.005	3.005	1	
S10	1.600 X 1.000	1.000	1	
S11	3.300 X 2.200	2.200	1	
S12	7.800 X 3.550	3.550	1	
S13	6.900 X 0.950	0.950	1	
S14	3.750 X 2.700	2.700	1	
S15	3.100 X 7.000	7.000	1	
S16	1.200 X 5.160	5.160	1	
S17	1.000 X 1.600	1.600	1	
S18	1.400 X 3.200	3.200	1	
S19	6.750 X 1.200	1.200	1	
S20	3.850 X 0.950	0.950	1	
S21	1.400 X 4.300	4.300	1	
S22	10.500 X 3.200	3.200	1	
S23	3.200 X 0.210	0.210	0.5	
TOTAL SERVICE AREA (E)				635.463

BASEMENT-1 PLAN

SP2-H CAR PARKING SYSTEM

SP2-H CAR PARKING SYSTEM

3800mm x 1800mm

5000mm x 2000mm

200mm

200mm

Digitally signed by
Sudheer Kumar
Date: 2025.10.03
13:34:12 +05'30'

Digitally signed by
MINAKSHI NARANG
Date: 2025.09.30
17:33:25 +05'30'

Digitally signed by
Amit Varma
Date: 2025.09.27
19:24:14 +05'30'

Digitally signed by
LEENU SAHGAL
Date: 2025.10.14
12:06:36 +05'30'

Digitally signed by
KALPN GUPTA
Date: 2025.09.27
06:52:06 +05'30'

Digitally signed by
GIAN PRAKASH MATHUR
Date: 2025.09.27
16:06:46 +05'30'

OWNER'S SIGN