

ALL TOWERS FAR AND GROUND COVERAGE CALCULATION															FAR AREA	NON FAR AREA	ANCILLARY AREA	BUILT UP AREA	CUTOUTS AREA	F.A.R. AT GROUND FLOOR	GROUND COVERAGE	NO. OF FLATS	NO. OF PERSONS @ 3.5/FLAT	HENTY AND MACHINE ROOM
TOWERS	AREA	NO. OF FLATS	AREA	NO. OF FLATS	AREA	NO. OF FLATS	AREA	NO. OF FLATS	AREA	NO. OF FLATS	AREA	NO. OF FLATS	AREA	NO. OF FLATS										
TOWER A1	101.571	101	101.571	101	101.571	101	101.571	101	101.571	101	101.571	101	101.571	101	1295.179	2817.431	146.388	13958.878	491.835	915.371	1104.546	60	210	112.383
TOWER A2	101.571	101	101.571	101	101.571	101	101.571	101	101.571	101	101.571	101	101.571	101	1295.179	2817.431	146.388	13958.878	491.835	915.371	1104.546	60	210	112.383
TOWER A3	101.571	101	101.571	101	101.571	101	101.571	101	101.571	101	101.571	101	101.571	101	1295.179	2817.431	146.388	13958.878	491.835	915.371	1104.546	60	210	112.383
TOWER A4	101.571	101	101.571	101	101.571	101	101.571	101	101.571	101	101.571	101	101.571	101	1295.179	2817.431	146.388	13958.878	491.835	915.371	1104.546	60	210	112.383
TOWER A5	101.571	101	101.571	101	101.571	101	101.571	101	101.571	101	101.571	101	101.571	101	1295.179	2817.431	146.388	13958.878	491.835	915.371	1104.546	60	210	112.383
TOWER B1	101.571	101	101.571	101	101.571	101	101.571	101	101.571	101	101.571	101	101.571	101	1295.179	2817.431	146.388	13958.878	491.835	915.371	1104.546	60	210	112.383
TOWER B2	101.571	101	101.571	101	101.571	101	101.571	101	101.571	101	101.571	101	101.571	101	1295.179	2817.431	146.388	13958.878	491.835	915.371	1104.546	60	210	112.383
TOWER B3	101.571	101	101.571	101	101.571	101	101.571	101	101.571	101	101.571	101	101.571	101	1295.179	2817.431	146.388	13958.878	491.835	915.371	1104.546	60	210	112.383
TOWER B4	101.571	101	101.571	101	101.571	101	101.571	101	101.571	101	101.571	101	101.571	101	1295.179	2817.431	146.388	13958.878	491.835	915.371	1104.546	60	210	112.383
TOWER B5	101.571	101	101.571	101	101.571	101	101.571	101	101.571	101	101.571	101	101.571	101	1295.179	2817.431	146.388	13958.878	491.835	915.371	1104.546	60	210	112.383
TOWER C1	101.571	101	101.571	101	101.571	101	101.571	101	101.571	101	101.571	101	101.571	101	1295.179	2817.431	146.388	13958.878	491.835	915.371	1104.546	60	210	112.383
TOWER C2	101.571	101	101.571	101	101.571	101	101.571	101	101.571	101	101.571	101	101.571	101	1295.179	2817.431	146.388	13958.878	491.835	915.371	1104.546	60	210	112.383
TOWER C3	101.571	101	101.571	101	101.571	101	101.571	101	101.571	101	101.571	101	101.571	101	1295.179	2817.431	146.388	13958.878	491.835	915.371	1104.546	60	210	112.383
TOWER C4	101.571	101	101.571	101	101.571	101	101.571	101	101.571	101	101.571	101	101.571	101	1295.179	2817.431	146.388	13958.878	491.835	915.371	1104.546	60	210	112.383
TOWER C5	101.571	101	101.571	101	101.571	101	101.571	101	101.571	101	101.571	101	101.571	101	1295.179	2817.431	146.388	13958.878	491.835	915.371	1104.546	60	210	112.383
TOWER D1	101.571	101	101.571	101	101.571	101	101.571	101	101.571	101	101.571	101	101.571	101	1295.179	2817.431	146.388	13958.878	491.835	915.371	1104.546	60	210	112.383
TOWER D2	101.571	101	101.571	101	101.571	101	101.571	101	101.571	101	101.571	101	101.571	101	1295.179	2817.431	146.388	13958.878	491.835	915.371	1104.546	60	210	112.383
TOWER D3	101.571	101	101.571	101	101.571	101	101.571	101	101.571	101	101.571	101	101.571	101	1295.179	2817.431	146.388	13958.878	491.835	915.371	1104.546	60	210	112.383
TOWER D4	101.571	101	101.571	101	101.571	101	101.571	101	101.571	101	101.571	101	101.571	101	1295.179	2817.431	146.388	13958.878	491.835	915.371	1104.546	60	210	112.383
TOWER D5	101.571	101	101.571	101	101.571	101	101.571	101	101.571	101	101.571	101	101.571	101	1295.179	2817.431	146.388	13958.878	491.835	915.371	1104.546	60	210	112.383
TOTAL	1295.179	1295	1295.179	1295	1295.179	1295	1295.179	1295	1295.179	1295	1295.179	1295	1295.179	1295	212090.76	39574.829	4028.146	330343.900	16735.504	12611.034	14328.890	7158.099	3911.906	

F.A.R./BUILT UP/ANCILLARY AREA CALCULATION					PROVIDED LANDSCAPE-GREEN AREA CALCULATION				
TOWER	F.A.R. Area	Built Up Area	Ancillary Area	Total	G	I	RECTANGLE	L x B	111.881
TOWER A1	1295.18	13958.88	146.39	14462.35	1	1	1	1	1
TOWER A2	1295.18	13958.88	146.39	14462.35	1	1	1	1	1
TOWER A3	1295.18	13958.88	146.39	14462.35	1	1	1	1	1
TOWER A4	1295.18	13958.88	146.39	14462.35	1	1	1	1	1
TOWER A5	1295.18	13958.88	146.39	14462.35	1	1	1	1	1
TOTAL	64975.89	79794.49	731.44	14462.35					
TOWER B1	950.18	1174.71	218.88	2143.77	1	1	1	1	1
TOWER B2	950.18	1174.71	218.88	2143.77	1	1	1	1	1
TOWER B3	950.18	1174.71	218.88	2143.77	1	1	1	1	1
TOTAL	28500.54	35144.12	656.64	2143.77					
TOWER C1	17137.84	20388.13	293.14	2143.77	1	1	1	1	1
TOWER C2	17137.84	20388.13	293.14	2143.77	1	1	1	1	1
TOWER C3	17137.84	20388.13	293.14	2143.77	1	1	1	1	1
TOTAL	51413.52	61164.38	879.41	2143.77					
TOWER D1	10496.12	12879.11	384.13	12879.11	1	1	1	1	1
TOWER D2	10496.12	12879.11	384.13	12879.11	1	1	1	1	1
TOTAL	20992.24	25758.22	768.26	12879.11					
TOWER E1	13580.91	16146.23	225.46	16146.23	1	1	1	1	1
TOWER E2	13580.91	16146.23	225.46	16146.23	1	1	1	1	1
TOTAL	27161.82	32292.46	450.92	16146.23					
COMMUNITY BLDG.	5460.88	5460.88		5460.88					
BASEMENT	75074.30			75074.30					
GRAND TOTAL	212090.76	330662.91	4039.17						

BOTANICAL NAME	COMMON NAME	PHYTOGENICITY
BAUHINIA BLACKBURN	BAUHINIA	DECIDUOUS
PHOENIX DACTYLIFERA	DATE PALM	EVERGREEN
FICUS BENJAMINA	BENJAMINA	EVERGREEN
TOTAL TREES	400 NOS.	

OPEN AREA PARKING CALCULATION				
TYPE	QUANTITY	SHAPE	FORMULA	DETAIL
A	2	RECTANGLE	L x B	17.500
B	1	RECTANGLE	L x B	11.500
C	1	RECTANGLE	L x B	15.142
D	1	RECTANGLE	L x B	4.159
E	2	TRIANGLE	1/2 bh	5.385
F	1	RECTANGLE	L x B	4.724
G	1	RECTANGLE	L x B	12.500
H	1	RECTANGLE	L x B	10.654
I	1	RECTANGLE	L x B	11.500
J	1	RECTANGLE	L x B	11.500
K	1	RECTANGLE	L x B	15.000
L	1	RECTANGLE	L x B	8.594
M	1	RECTANGLE	L x B	10.000
N	2	RECTANGLE	L x B	12.500
P	1	RECTANGLE	L x B	11.500
Q	6	RECTANGLE	L x B	11.500
R	1	RECTANGLE	L x B	11.500
TOTAL OPEN PARKING AREA				3675.42

FAR CALCULATION				
TOTAL PLOT AREA	86808.98	SQM		
TOTAL PLOT AREA (in hectare)	8.68	HA		
TOTAL PLOT AREA (in acre)	21.45	ACR		
PERMISSIBLE REQUIRED	40.00			
PROPOSED	34723.59			
TOTAL FAR AREA	217022.45	SQM		
DENSITY (Units per hectare)	200.00	NOS.		
NO. OF UNITS	1736.18	NOS.		
TOTAL GREEN AREA	0.00	SQM		
GREEN AREA (10% AT VIRGIN SOIL)	10.00	SQM		
GREEN AREA (10% AT VIRGIN SOIL)	5880.82	SQM		
WATER BODY (5% OF TOTAL GREEN AREA)	434.04	SQM		
NO. OF TREES (50 PER HECTARE)	434.04	NOS.		
NO. OF PARKING	2045.22	NOS.		
BASEMENT PARKING AREA	6871.81	SQM		
ANCILLARY AREA 5% OF THE FAR AREA	10851.12	SQM		

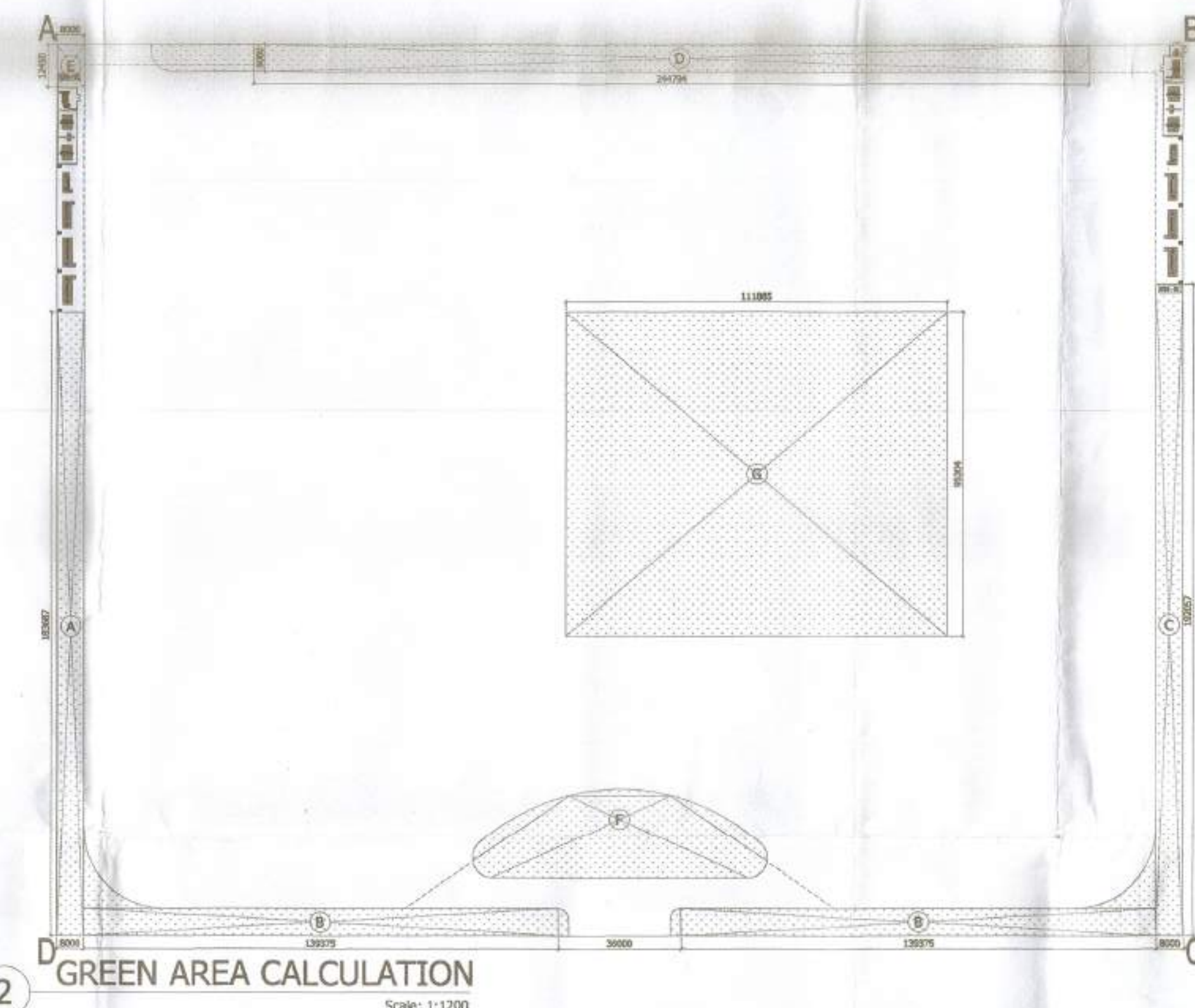

GREEN AREA CALCULATION				
TYPE	QUANTITY	SHAPE	FORMULA	DETAIL
A	1	RECTANGLE	L x B	183.887
B	2	RECTANGLE	L x B	179.176
C	1	RECTANGLE	L x B	102.887
D	1	RECTANGLE	L x B	238.471
E	1	RECTANGLE	L x B	12.450
GREEN AREA ON VIRGIN SOIL				8806.20

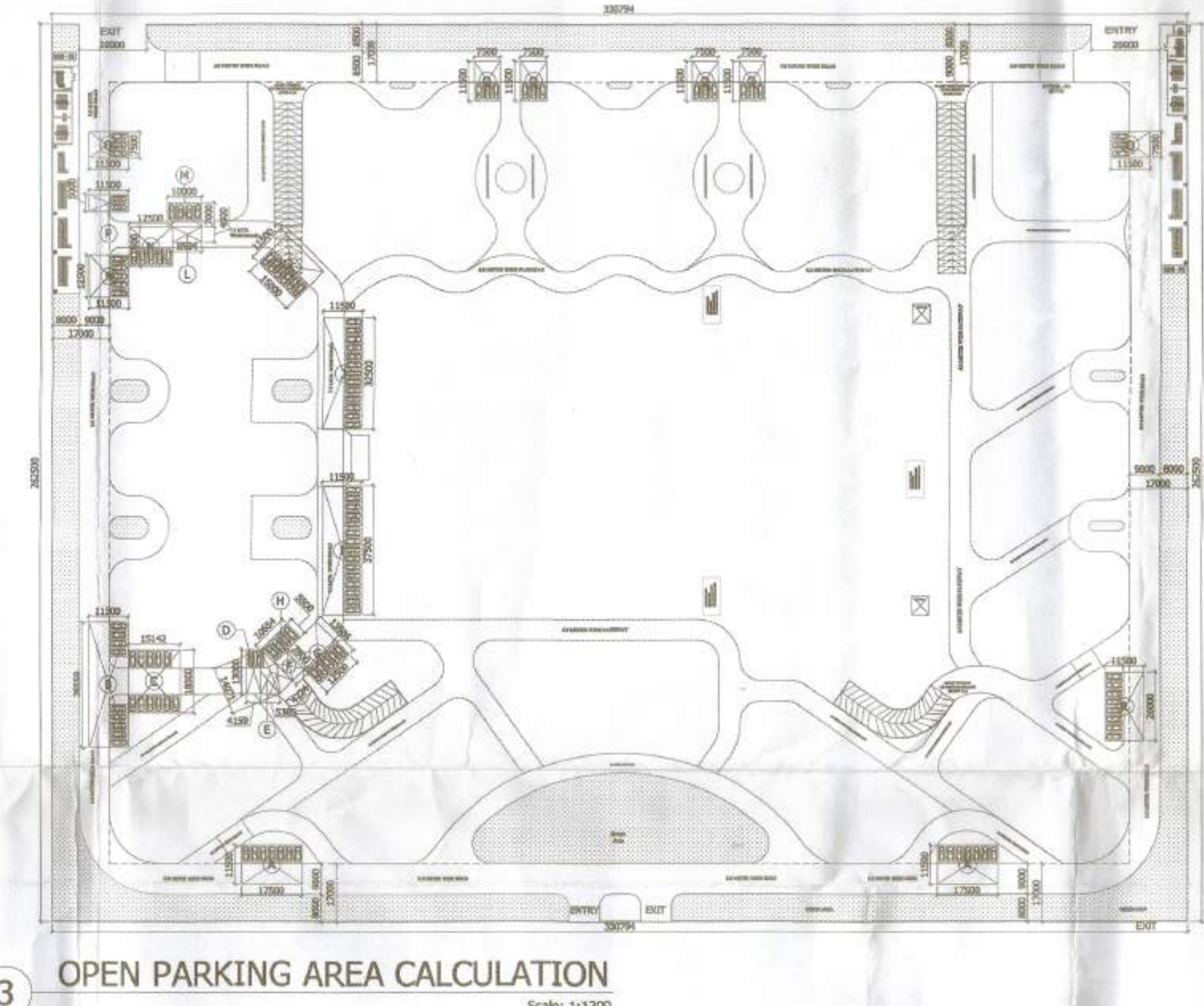

PROJECT:  
PROPOSED GROUP HOUSING-1  
SITUATED AT POCKET-6  
SECTOR-C AT  
SUSHANT GOLF CITY,  
HI-TECH TOWNSHIP  
LUCKNOW.

- NOTES:
1. BUILDING IS DESIGNED (STRUCTURES) AS PER RELEVANT I.S. CODES FOR EARTH QUAKE RESISTANCE.
  2. MECHANICAL VENTILATION SYSTEM PROVIDED IN BASEMENT AS PER N.B.C.

OWNER'S SIGNATURE: \_\_\_\_\_

ARCHITECT'S SIGNATURE: \_\_\_\_\_

Ar. Devendra Pr. Singh  
CA/2012/57857

SUBMISSION DRAWING

NOTES:

1. BUILDING IS DESIGNED (STRUCTURES) AS PER RELEVANT I.S. CODES FOR EARTH QUAKE RESISTANCE.
2. MECHANICAL VENTILATION SYSTEM PROVIDED IN BASEMENT AS PER N.B.C.

PRINCIPLE ARCHITECT

di  
DESIGN FORUM INTERNATIONAL  
K-47, KAILASH COLONY NEW DELHI-48  
PHONE: 011-45556600 FAX: 45556601

CONSULTANTS:  
STRUCTURE - NNC DESIGN International  
MEP - Consummate Engineering Services  
Pvt. Ltd.

OWNER'S SIGNATURE: \_\_\_\_\_

ARCHITECT'S SIGNATURE: \_\_\_\_\_

Ar. Devendra Pr. Singh  
CA/2012/57857

SITE PLAN, AREA AND  
PARKING CALCULATIONS

SCALE 1:500

DATE 12-03-2018

DWG. NO. SP - S1



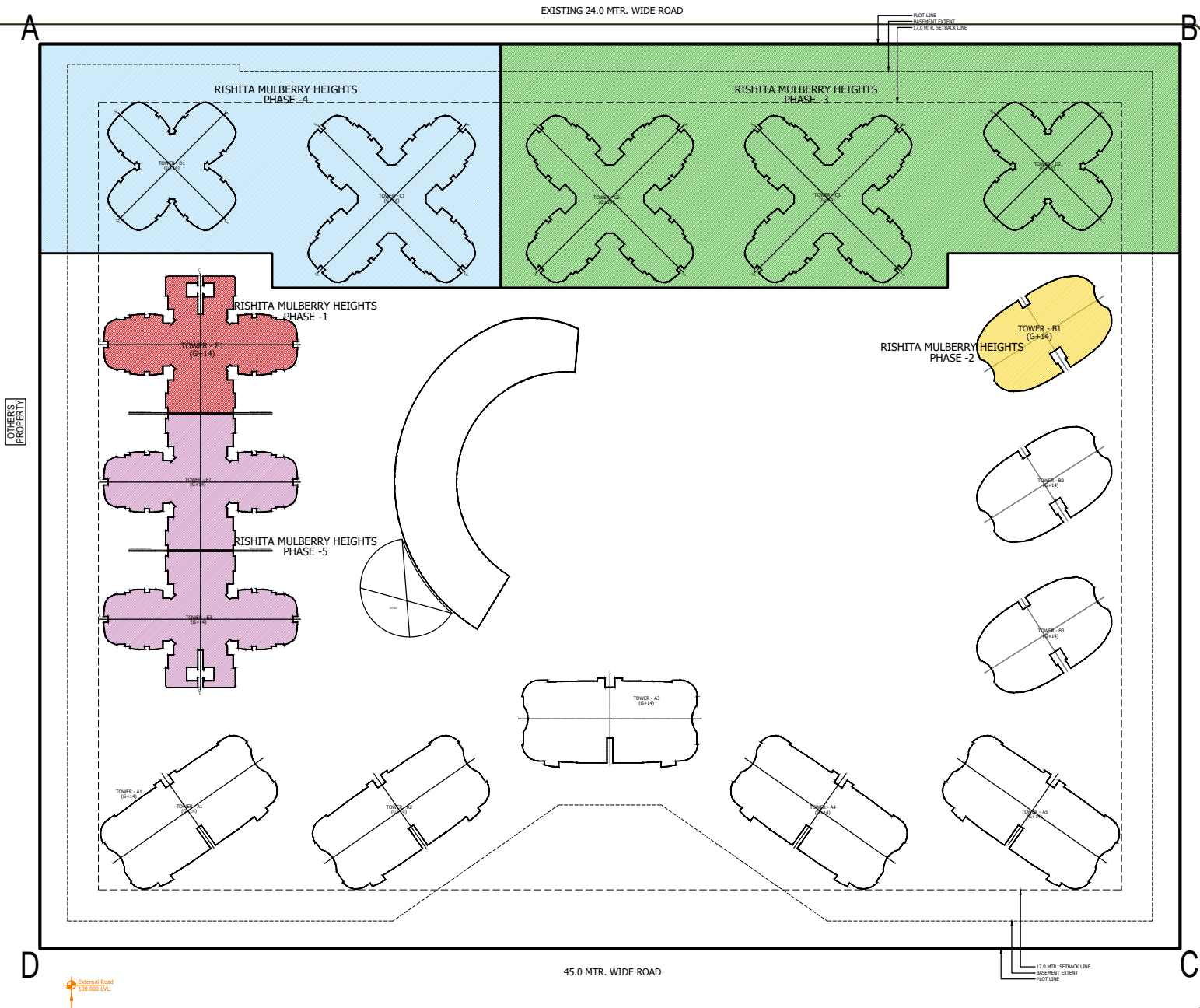

### RISHITA MULBERRY HEIGHTS

HATCH	REMARKS	RERA REG. NO.
	RISHITA MULBERRY HEIGHTS PHASE -1	UPRERAPRJ357829
	RISHITA MULBERRY HEIGHTS PHASE -2	UPRERAPRJ323529
	RISHITA MULBERRY HEIGHTS PHASE -3	UPRERAPRJ308470
	RISHITA MULBERRY HEIGHTS PHASE -4	UPRERAPRJ192087
	RISHITA MULBERRY HEIGHTS PHASE -5	TO BE REGISTER