

--- LINE OF BASEMENT 7.5M WIDE
 --- LINE OF SETBACK

Greater Noida Industrial Development Authority
 REVALUATION
 Visit Letter No. 6982 dated 08/10/2018
 Valid Upto Date: Two years

APPROVED
 Use of Plot (Eng. & Arch.)
 Drawing Checked & Verified By
 Gen. Manager (Prog. & Insp.)

FLOORS	TOWER- HIGH RISE				COMMERCIAL CUM ONE BED ROOM APARTMENT	COMMUNITY CENTER	TOTAL GROUND COV. ALL BLOCK	F.A.R.	NON F.A.R.
	TOWER-A		TOWER-B						
	UNITS	AREA	UNITS	AREA	UNITS	AREA			
G.F. TOTAL BLOCK (GROUND COVERAGE AREA)		1443.142		1032.288		652.684	232.180	3360.294	
NO. OF SIMILAR BLOCKS	2		2		1		1		
GROUND COVERAGE AREA		721.571		516.144		652.684	232.180		
UPPER BASEMENT AREA									13035.029
LOWER BASEMENT AREA									13035.029
GROUND FLOOR	6	657.647	6	474.146		591.971	232.180		
1ST FLOOR	6	657.647	6	474.146	16	550.806			
2ND FLOOR	6	657.647	6	474.146	16	550.806			
3RD FLOOR	6	657.647	6	474.146	16	550.806			
4TH FLOOR	6	657.647	6	474.146	16	550.806			
5TH FLOOR	6	657.647	6	474.146	16	550.806			
6TH FLOOR	6	657.647	6	474.146	16	550.806			
7TH FLOOR	6	657.647	6	474.146	16	550.806			
8TH FLOOR	6	657.647	6	474.146	16	550.806			
9TH FLOOR	6	657.647	6	474.146	16	550.806			
10TH FLOOR	6	657.647	6	474.146	16	550.806			
11TH FLOOR	6	657.647	6	474.146	16	550.806			
12TH FLOOR	6	657.647	6	474.146	16	550.806			
13TH FLOOR	6	657.647	6	474.146	16	550.806			
14TH FLOOR	6	657.647	6	474.146	16	550.806			
15TH FLOOR	6	657.647	6	474.146	16	550.806			
16TH FLOOR	6	657.647	6	474.146	14	514.021			38.575
17TH FLOOR	6	657.647	3	237.809					
TOTAL COVERED AREA OF ONE BLOCK		11,837.646		8,298.291		9,368.082	232.180		
NO. OF SIMILAR BLOCKS	2		2		1		1		
TOTAL COVERED F.A.R. AREA OF BLOCK		23,875.292		16,596.582		9,368.082	232.180	49,872.136	26,108.633
FIRE ESCAPE STAIR CASE		13.770		13.770		14.580			
WARDROBE		16.524		8.864		12.960			
LIFT LOBBY		13.619		13.194		24.61			
SHAFTS		20.011		8.170		17.28			
TOTAL NO. OF UNIT ONE TOWER	108		105		264				
NO. OF SIMILAR TOWER	2		2		1				
TOTAL NO. OF UNITS	216		210		264			680	

AREA CHART

S.NO	PARTICULARS	F.A.R. %	SQ. MTR.
1	TOTAL PLOT AREA		18154.00
2	PERMISSIBLE F.A.R.	@ 2.75	49923.50
3	F.A.R. ACHIEVED (as per table) FOR HOUSING	@ 2.74	49872.136
4	PERMISSIBLE GROUND COVERAGE	@ 35%	6353.80
5	ACHIEVED GROUND COVERAGE	@ 20.35%	3693.273
6	PERMISSIBLE COMMERCIAL AREA 1% OF ACHIEVED F.A.R.		499.234
7	ACHIEVED COMMERCIAL AREA		466.650
8	TOTAL BASEMENT AREA		28533.832
9	PERMISSIBLE DENSITY = 1650 person per 10000 sq. m. 1650 PPH ± 5% = 2995.41 (-5%) TO 3145 (+5%) BETWEEN 2095 TO 3145		688
10	PERMISSIBLE UNITS (ASSUMING 4.5 NO.S. PERSONS PER UNIT) FOR 3145 No.S UNITS = 688		688
11	UNITS PROVIDED		680
12	PERSON = 680 X 4.5 = 3060, (1686 P.P.H)		
13	PARKING REQUIRED = 1 ECS / 80 SQ.M. PER COVERED AREA FOR HOUSING = 49923.409 / 80 = 624.043 SAY = 624 E.C.S.		899
14	PARKING PROVIDED		899
15	LANDSCAPING AREA REQUIRED TOTAL PLOT AREA - GROUND COVERAGE / 2 = 18154.00 - 3678.665 / 2 = 14475.335 / 2 = 7237.667 SQ.M.		9648.727
16	LANDSCAPING AREA PROPOSED		9648.727
17	NO. OF TREE REQUIRED (TOTAL AREA - GROUND COVERAGE) / 100 = 18154.00 - 3678.665 / 100 = 14475.335 / 100 = 144.753 NOS.		144 NOS
18	NO. OF TREE PROPOSED		144 NOS
19	NO. OF TREE PROPOSED EVERGREEN TREE		72 NOS
20	TOTAL BASEMENT AREA FOR PARKING		26070.058

TOTAL GROUND COVERAGE:-
 AREA FOR TOWERS = 3390.294
 AREA FOR ES = 296.871
 AREA FOR VISITOR TOILET & SECURITY = 30.00
 TOTAL AREA = 3693.273

ADDITIONAL 15 % OF FAR AREA
 AREA FOR ELECTRIC SUBSTATION = 206.871
 AREA FOR STP = 400.150
 AREA FOR TANKS & PUMP ROOM = 710.500
 AREA FOR VISITOR TOILETS = 38.622
 AREA FOR WATCHMEN & SECURITY SHELTER = 30.00
 LIFT SHAFT & 10 SQ. M. OF LIFT LOBBY = 1226.911
 FIRE ESCAPE STAIRCASE = 968.760
 AREA FOR MUNITY & MACHINE ROOM = 202.004
 AREA OF WARDROBES = 794.352
 AREA OF FEATURE WALL = 70.401
 TOTAL AREA = 4738.298

TOTAL ELECTRICAL LOAD = 3419.67 KW

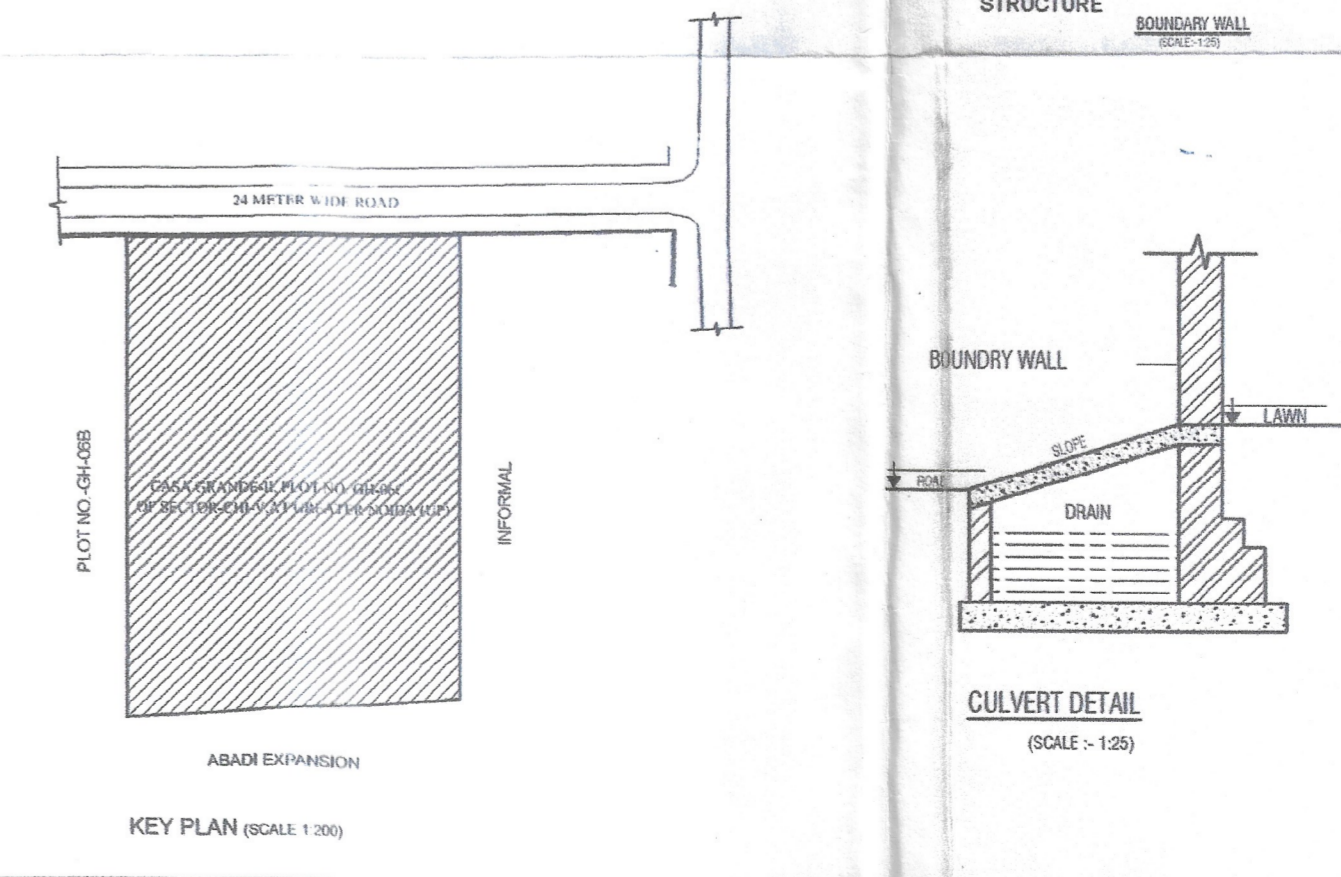

OWNERS SEAL

ARCHITECT'S SEAL

PROJECT: CASA GRANDIF-III, PLOT NO. - 64-06C, OF SECTOR CH-V, AT GREATER NOIDA (UP)

OWNER: EARTHCON CONSTRUCTION PVT. LTD. J-26A, SECTOR-18 NOIDA (UP)

ARCHITECT: modarchindia

SCALE: 1:100
 DATE: 10.11.2012
 DEALT BY: AGAD
 CHECKED BY: HRESH 05/5/01

