

9

TOTAL NOS. OF BLOCKS = 30  
TOTAL NOS. OF HOUSES = 1440  
(GROUND + 3 STORIED)

CARPET AREA OF ONE UNIT = 22.67 SQ.M.  
COVERED AREA OF ONE UNIT = 27.37 SQ.M.

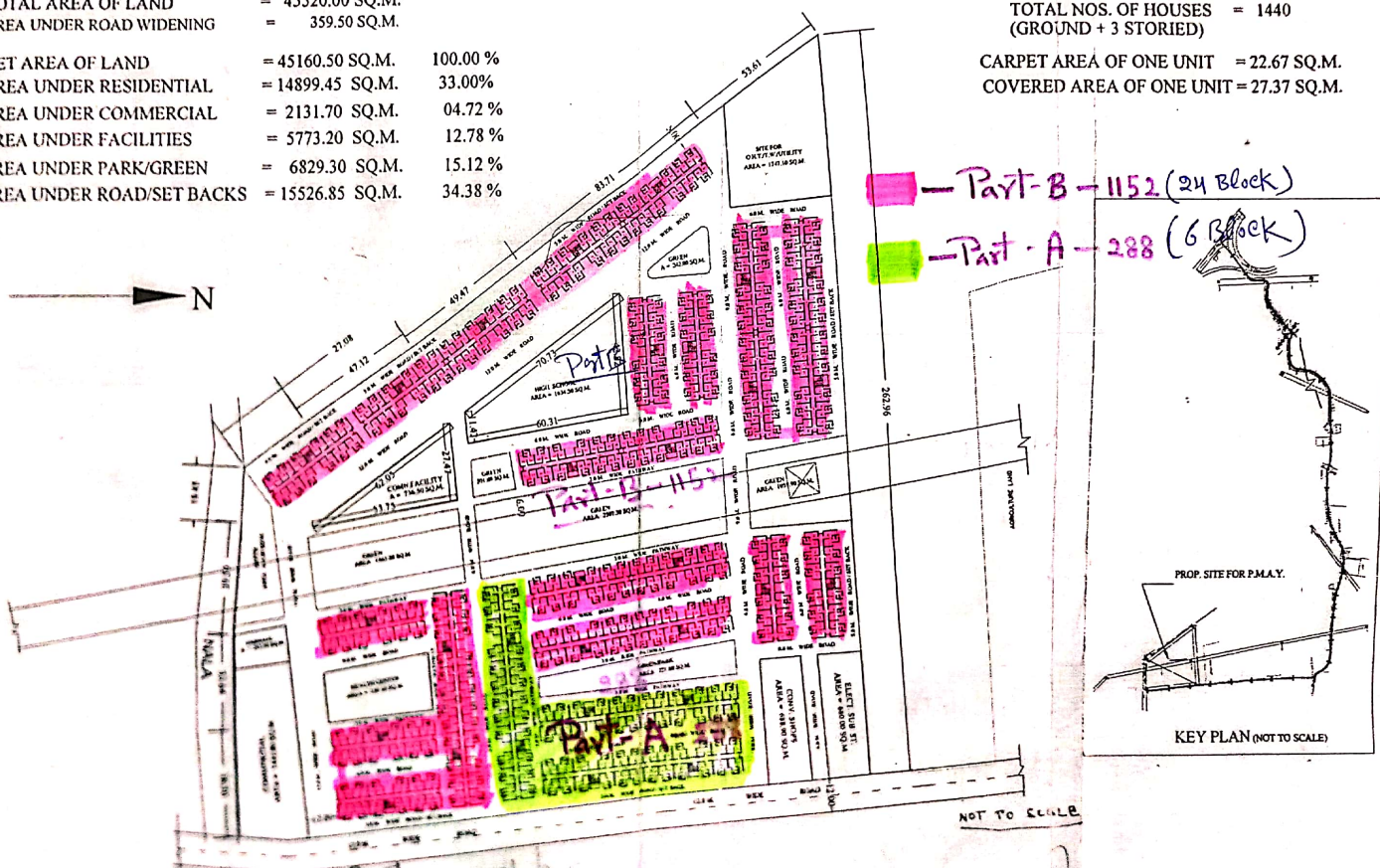

KEY PLAN (NOT TO SCALE)

NOT TO SCALE

SECRETARY

**VICE CHAIRMAN**