

ADJOINING PLOT

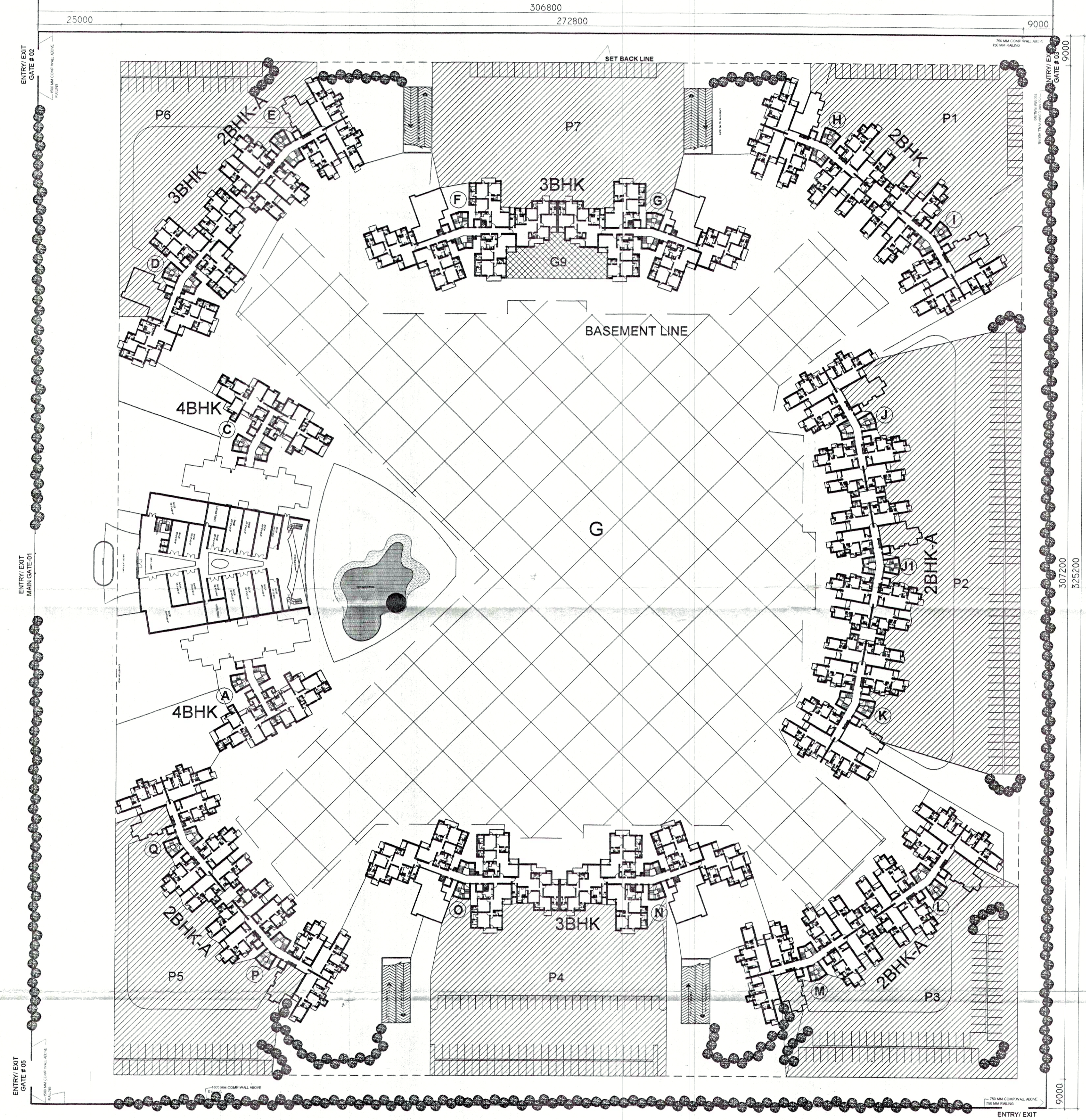

45.00 M WIDE ROAD
TOTAL NO OF CARS IN OPEN = 1000 Nos

REMARKS

AREA CHART

Building Plan upto 30.0m Height, IS Approved
 TOTAL PLOT AREA = 306.8 X 325.2 = 99771.36 Sqm
 PERMISSIBLE F.A.R = 275% = 274371.24 Sqm.
 PERMISSIBLE GROUND COVERAGE = 30% = 29931.408 Sqm.

GREEN AREA
 G = 25800.0 Sqm

PARKING AREA

P1 = 2536.69 Sqm
 P2 = 2597.24 Sqm
 P3 = 3195.59 Sqm
 P4 = 3460.61 Sqm
 P5 = 2705.84 Sqm
 P6 = 2486.64 Sqm
 P7 = 3017.39 Sqm

TOTAL = 2536.69 + 2597.24 + 3195.59 + 3460.61 + 2705.84 + 2486.64 + 3017.39 = 20000.0 Sqm

PROJECT

Proposed Group Housing Building on Plot No.- 2, SEC - 137 noida FOR

TITLE
 SUBMISSION DRAWING (SITE PLAN)

SCALE	1:100 & 1:200	DATE	04-02-10
JOB NO.	1064	DRG.NO.	01
ARCHITECTS SIGN		OWNERS SIGN	

ASHOK KUMAR
 CA 296730493
 D-178, SECTOR-18
 NOIDA-201301

LOGIX INFRASTRUCTURE PVT. LTD.
 Director

CONSULTANT
R.N.Gupta & Associates
 Consulting Engineers, Architects & Valuers
 E-1, Sector-55, Noida
 Phones - (+120) 2582224, 2582773
 Fax - (+120) 4321556
 email - info@rngcorp.com