

LAYOUT PLAN OF PRADHAN MANTRI AWAS YOJNA AT PRATAP VIHAR SECTOR XI, G. M. P. GHAZIABAD.

TOTAL AREA OF LAND	= 32671.00 SQ.M.	100.00 %
AREA UNDER RESIDENTIAL	= 17752.00 SQ.M.	54.34 %
AREA UNDER COMMERCIAL	= 1288.00 SQ.M.	03.94 %
AREA UNDER FACILITIES	= 2424.00 SQ.M.	07.42 %
AREA UNDER PARK/GREEN	= 4963.00 SQ.M.	15.19 %
AREA UNDER ROAD	= 6244.00 SQ.M.	19.11 %

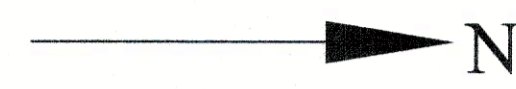

PROPOSED - 480 (G+3) PMAY EWS HOUSES

TOTAL NOS. OF BLOCKS = 25
 TOTAL NOS. OF HOUSES = 1200
 (GROUND + 3 STORIED)

CARPET AREA OF ONE UNIT = 22.67 SQ.M.
 COVERED AREA OF ONE UNIT = 27.37 SQ.M.

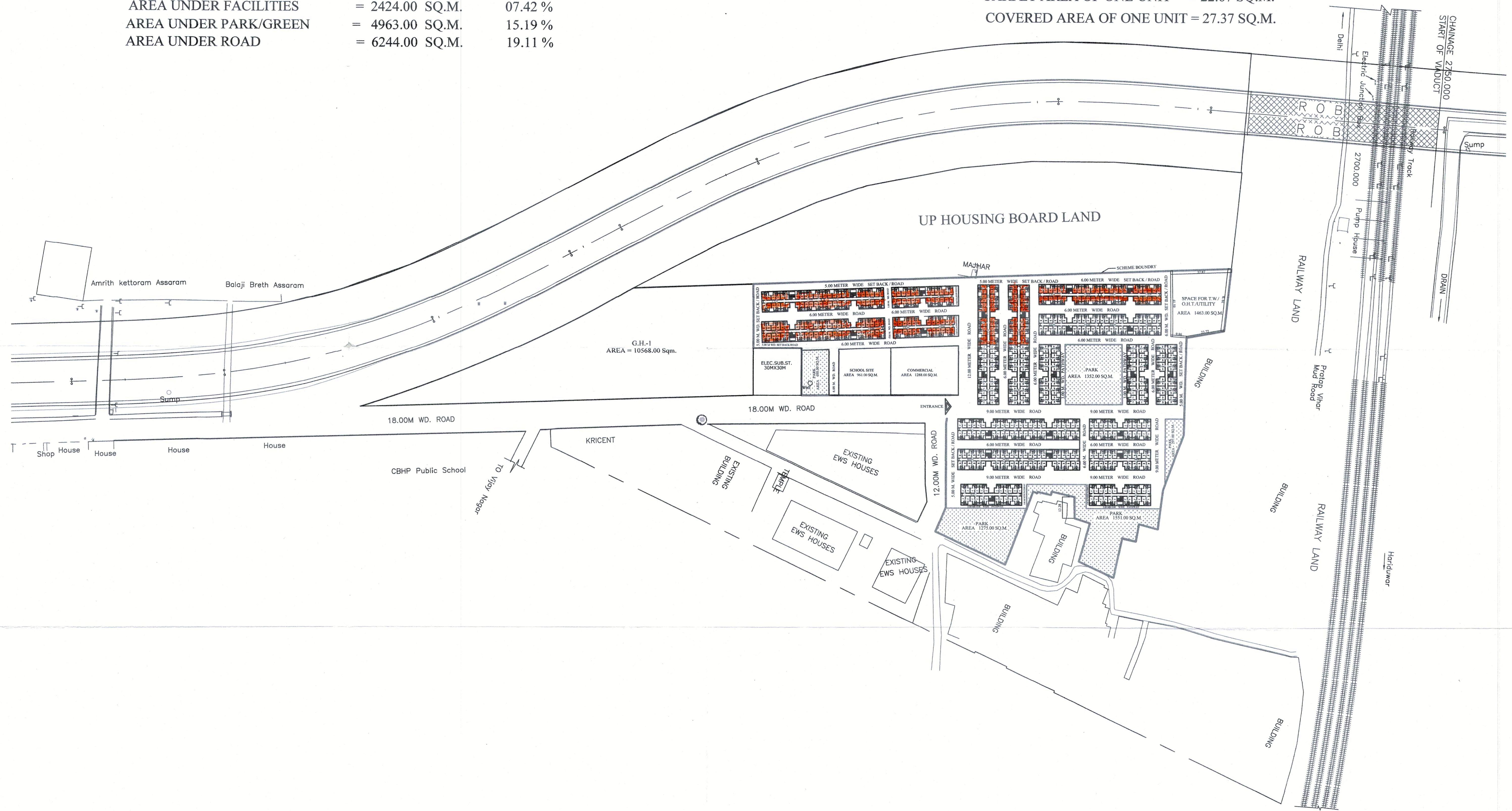

D/MAN *[Signature]* AMIN *[Signature]* J.E. *[Signature]* A.E. *[Signature]* E.E. *[Signature]* OSD. / TEH.-L.A. *[Signature]* T.P.-(R) *[Signature]* T.P.-(K) *[Signature]* C.A.T.P. *[Signature]* SECRATRY *[Signature]* VICE CHAIRMAN *[Signature]*