



S.NO.	TYPE	DESCRIPTION
1.	- - - - -	EXTENT OF LAND OF IRRIGATION PANCHAM
2.	- - - - -	CENTER LINE OF CANAL

**DENSITY CALCULATION :**

S.NO.	UNIT TYPE	NO OF PLOTS	PERSONE
1.	2 DU	64	640

**PLOT AREA CALCULATION -**

S.NO.	PLOT NOS.	SIZE	NUMBER	AREA / UNIT (sq.m.)	TOTAL AREA (sq.m.)
1.	T1	8.510 X 13.25	1	112.76	112.76
2.	T2 - T54	7.01 X 13.25	53	92.88	4922.64
3.	T55	BY FORMULA	1	178.95	178.95
4.	T56	BY FORMULA	1	117.10	117.10
5.	T57	BY FORMULA	1	112.82	112.82
6.	T58	BY FORMULA	1	108.55	108.55
7.	T59	BY FORMULA	1	104.59	104.59
8.	T60	BY FORMULA	1	120.84	120.84
9.	T61	BY FORMULA	1	109.29	109.29
10.	T62	BY FORMULA	1	113.184	113.184
11.	T63	BY FORMULA	1	116.90	116.90
12.	T64	BY FORMULA	1	120.82	120.82
NET TOTAL				64	6238.44

**GREEN AREA CALCULATION :**

S.NO.	DESCRIPTION	AREA (SQM)
1.	GREEN-1	822.26
2.	GREEN-2	210.89
3.	GREEN-3	201.25
4.	GREEN-4	219.86
TOTAL		1454.26

**AREA DETAIL :**

DESCRIPTION	AREA D	%
Building Plan Application No. MAP 20190601455904343	12400.923 sqm	100%
TOTAL AREA OF LAND	12400.923 Sqm (2.99 Acres)	100%
LAND LEFT FOR CANAL	2526.64 Sqm	20.37%
AREA OF LAND AVAILABLE	9874.28 Sqm (2.36 Acres)	79.63%
TOTAL AREA UNDER PLOTS	6238.44 Sqm	65.09%
AREA UNDER GREEN	1454.26 Sqm	15.17%
AREA UNDER ROADS / DUMPING YARD	1528.97 Sqm	15.95%
TOTAL		100%
PERCENTAGE OF L.I.G.UNITS -	7/64 = 10.93%	
PERCENTAGE OF E.WS.UNITS -	7/64 = 10.93%	
TOTAL PERCENTAGE -	14/64 = 21.87%	

WE ARE PROVIDING L.I.G. & E.W.S IN ADJACENT LAND AS SHOWN IN SITE PLAN

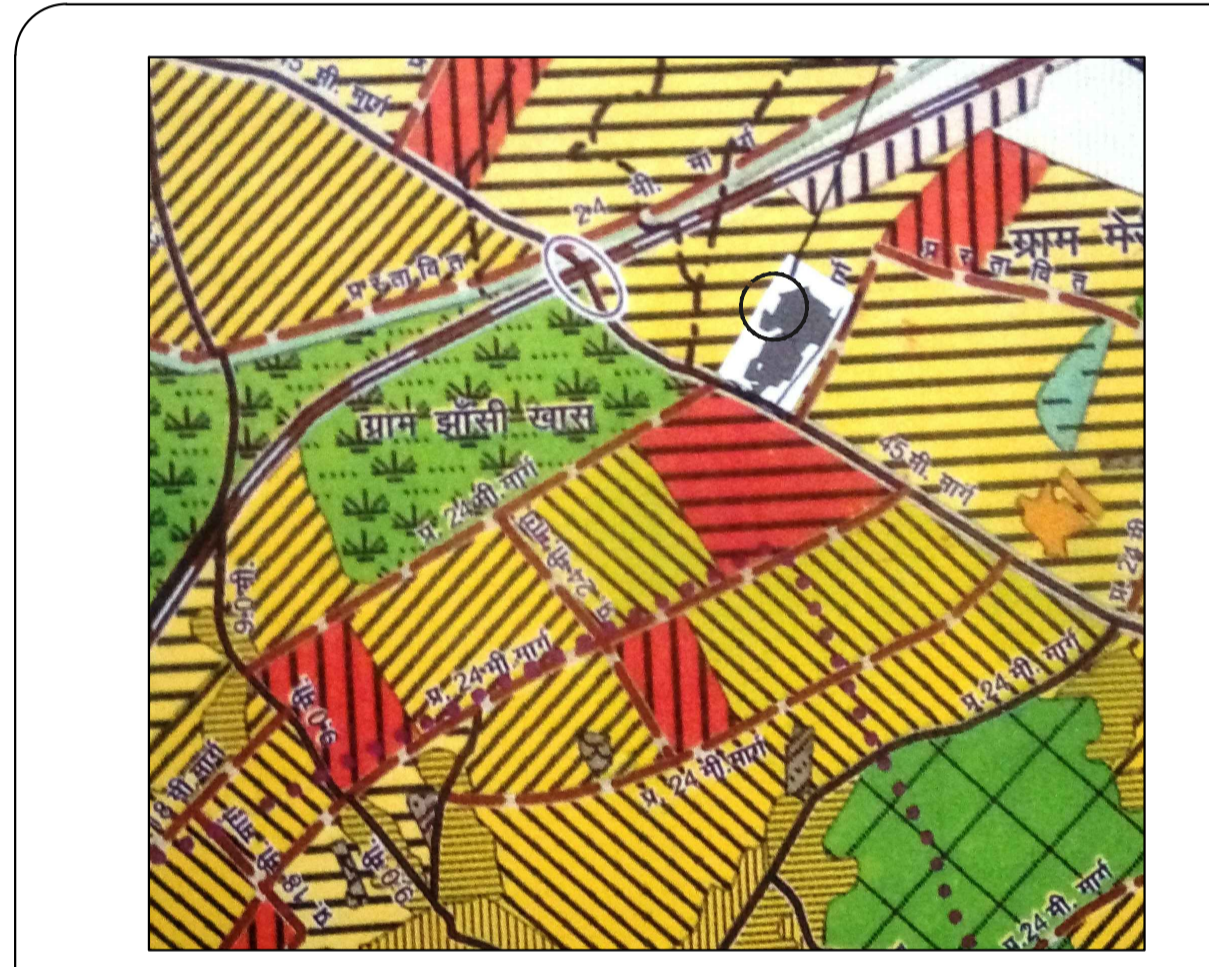
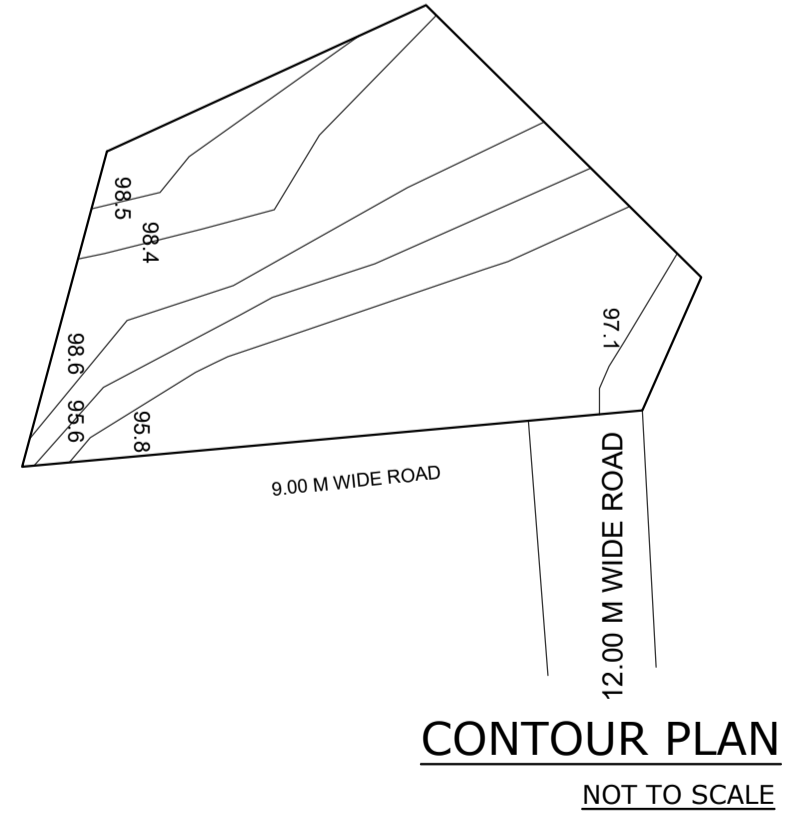
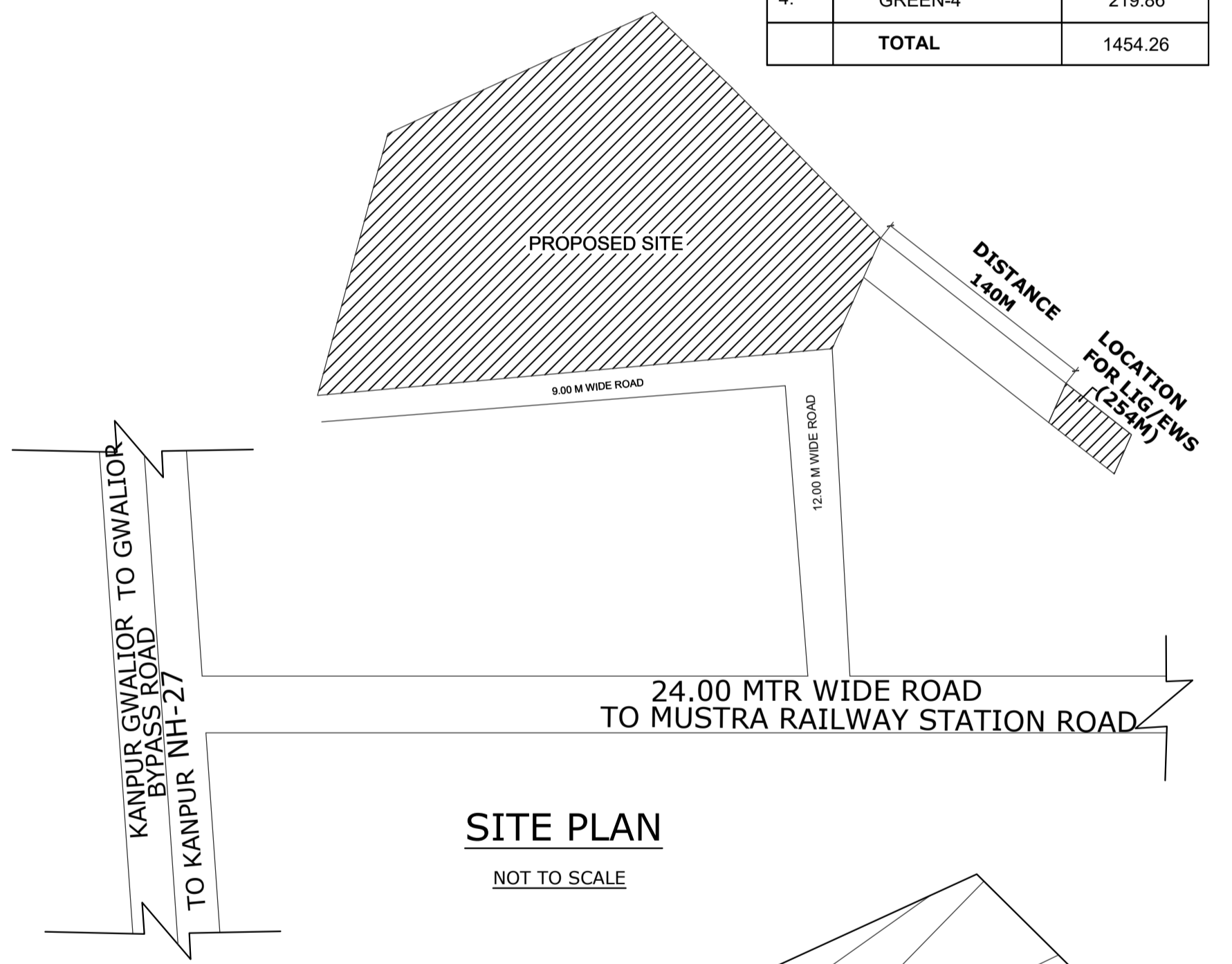
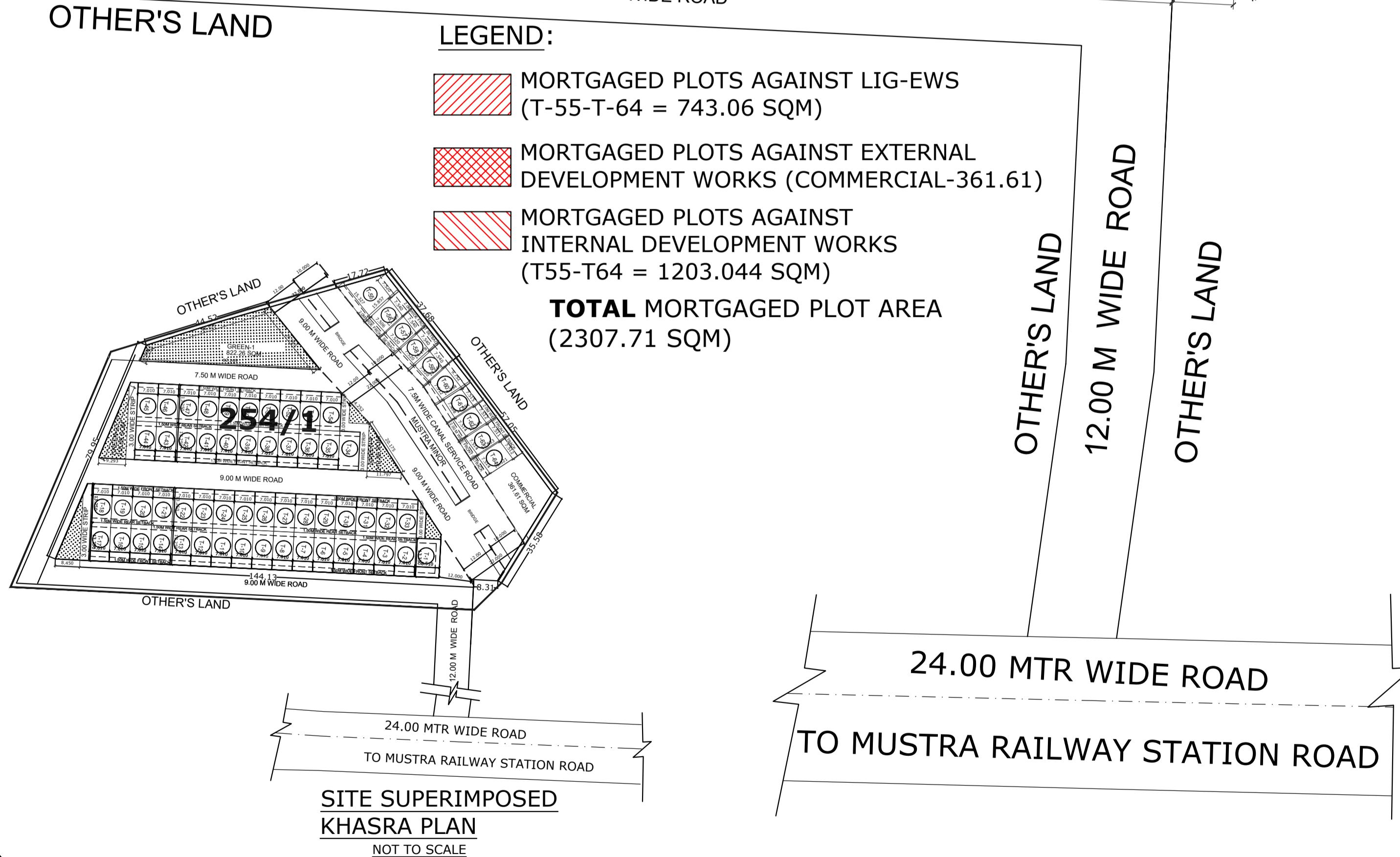
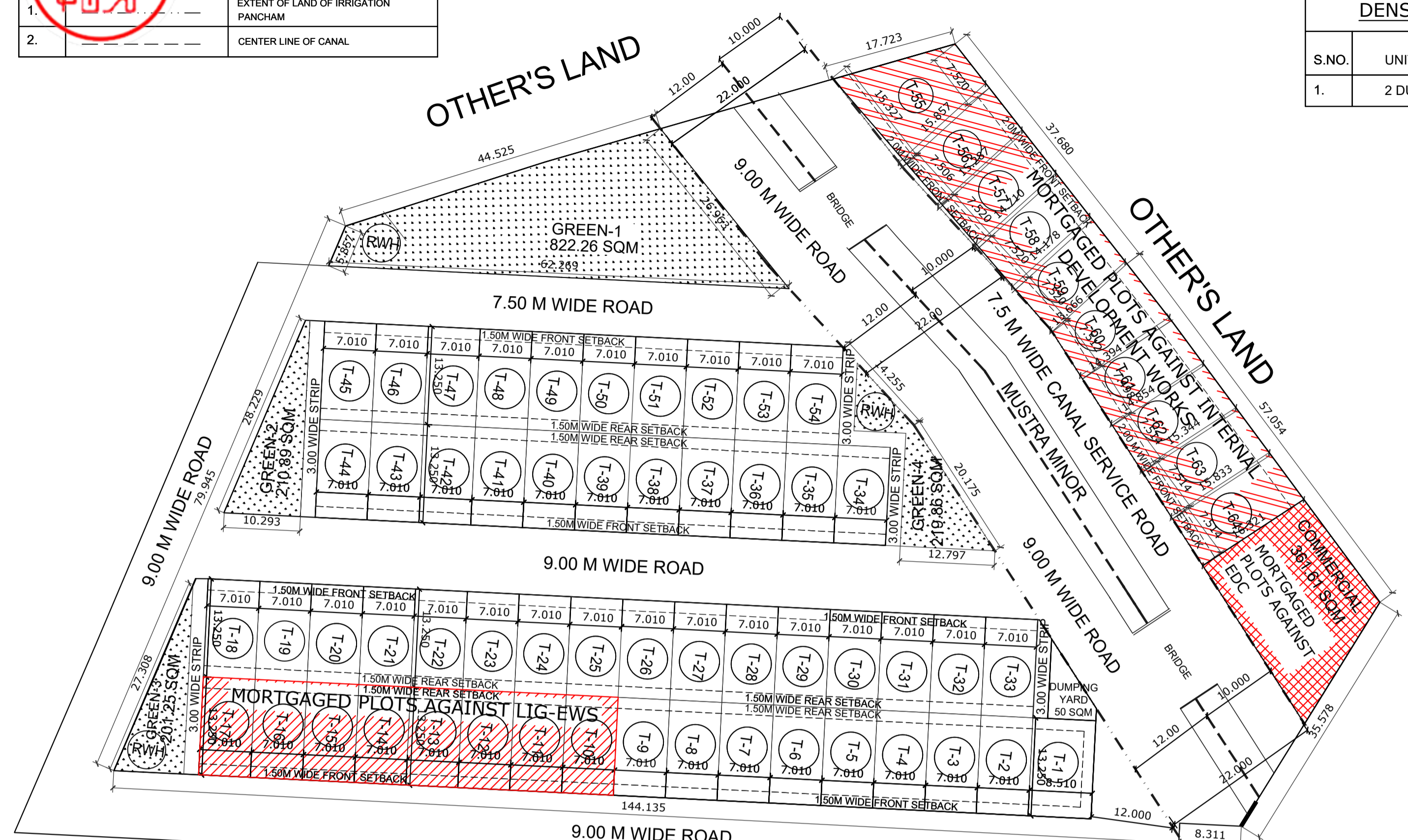

**SITE SUPERIMPOSED ON MASTER PLAN NOT TO SCALE**

**Owner Sign :**

**M/S SANFRAN BUILDWELL PVT. LTD.**

**Architect's Sign :**

**Project :**  
**PROPOSED LAYOUT PLAN OF RESIDENTIAL COLONY 'SANFRAN ASHOK CITY EXTENSION' LOCATED AT 254/1 MAUJA MARRY, NEAR MUSTRA RAILWAY STATION JHANSI (U.P.)**

**Owner :**  
**M/S SANFRAN BUILDWELL (P) LTD.**

**Title :** **SACE LAYOUT PLAN**

**Drawing Released For :**

- APPROVAL
- ADVANCE COPY
- SUBMISSION
- CONSTRUCTION

**Drg. No :** SD / SACE / 01 / R0

**Drawn By :** Manish Tiwari

**Date :** 05 June 2019

**Scale :** 1:500

**Design By :** Jayesh

**Checked By :** Priyanka

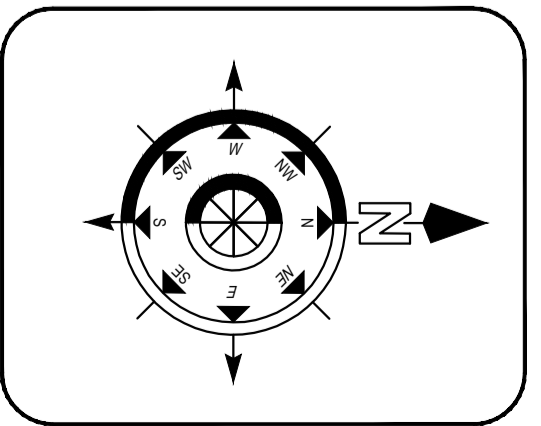

**Architects :**  
**SPACE CREATIONS ARCHITECTS PLANNERS ENGINEERS NEW DELHI BANGALORE**



LEGEND :				LEGEND :	
S.NO.	SYMBOL	NO. OF TREES	TREE NAME	SEWERAGE PIPE	
1.		33	CASSIA FISTULA	RECTANGULAR MANHOLE (600X450MM)	MH
2.		10	ALSTONIA SCHOLARIS	CIRCULAR MANHOLE (900MM DIA)	MH
3.		10	FICUS NITIDA	400,450,500 MM WIDE DRAIN	
4.		20	SARACA ASOCA	RAIN WATER HARVESTING	RWH
TOTAL NO OF TREES = 73				CATCH BASIN	
				COLD WATER SUPPLY RING MAIN	
				COLD WATER SUPPLY PIPE	
				GARDEN HYDRANT	
				GARDEN HYDRANT	GH
				AIR VALVE	AV
				SUBSTATION	
				FEEDER PILLAR	FP
				STREET LIGHT POLE (9.0M, PCC POLE) SINGLE LINE	P
				DOUBLE ARM POLE (9.0M, PCC POLE)	
				H.T. U/G CABLE	
				L.T. U/G CABLE	
				EARTH PIT	EP

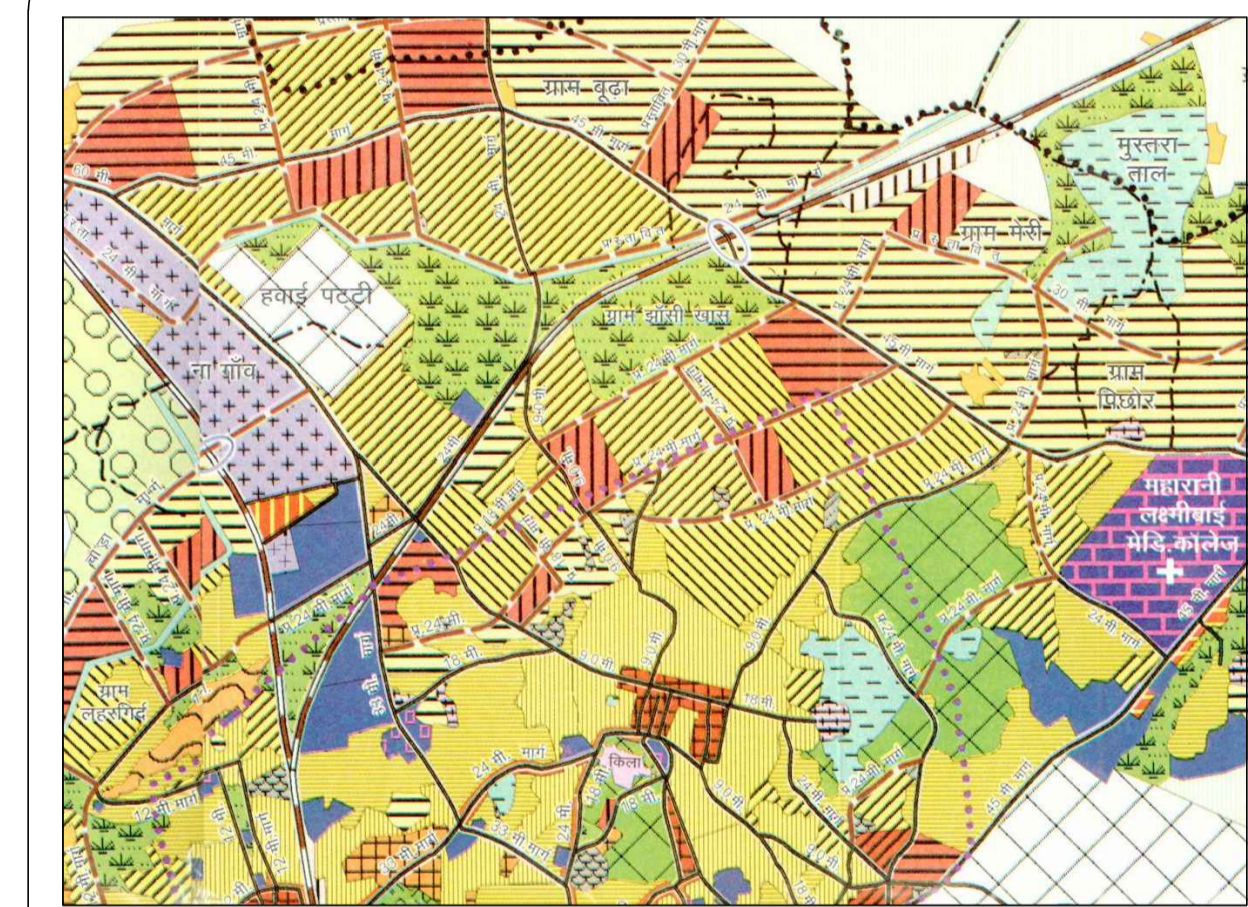

SITE SUPERIMPOSED ON MASTER PLAN

NOT TO SCALE

Owner Sign :

M/S SANFRAN BUILDWELL PVT. LTD.

Architect's Sign :

**Project :**  
**PROPOSED COMBINED SERVICES LAYOUT PLAN OF RESIDENTIAL COLONY 'SANFRAN ASHOK CITY EXTENSION' LOCATED AT 254/1 MAUJA MARRY, NEAR MUSTRA RAILWAY STATION JHANSI (U.P.)**

**Owner :**  
 M/S SANFRAN BUILDWELL (P) LTD.

**Title :** **COMBINED SERVICES LAYOUT PLAN**

**Drawing Released For :**

- APPROVAL
- ADVANCE COPY
- SUBMISSION
- CONSTRUCTION

**Drg. No :**  
 SD / SACE / R-00 / CSD-01

**Drawn By :**  
 Sumit

**Date :**  
 20 July 2019

**Scale :**  
 1:500

**Design By :**  
 Ganesh H

**Checked By :**  
 Priyanka

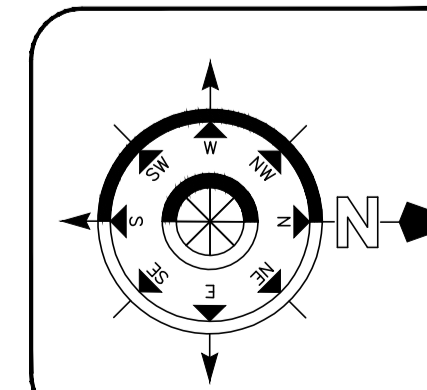

**Architects :**  
**SPACE CREATIONS**  
 ARCHITECTS PLANNERS ENGINEERS  
 NEW DELHI BANGALORE

जमाकर्ता प्रति

चालान नं०

# स्टेट बैंक ऑफ इंडिया

161, चन्द्रशेखर आज़ाद, पंचकुड़ियां, झाँसी

दिनांक 14/10/19

STATE BANK OF INDIA

झाँसी विकास प्राधिकरण झाँसी के खाते में जमा किया।

धनराशि शब्दों में  
सोलह लाख बहतर हजार दो सौ  
बत्तीस मात्र।

द्वारा राजनरिजा

Credited on  
15/10/19

रुपये

1672232

कोषाध्यक्ष

कैशियर

केश स्क्रोल क्रमांक

जमाकर्ता विवरण पीछे अंकित करें।

MAD 20190601155904343

मानांचेत्र स./भूखण्ड/भवन स.

जमाकर्ता द्वारा जिसके पक्ष में धनराशि जमा किया का विवरण

मे: लनद्वारा किलडकेल

श्री. श्री. लि. द्वारा-रजान किश

धनराशि	
रु.	पै.
1. प्रार्थना-पत्र शुल्क	
2. भवन निर्माण शुल्क	
3. विकास शुल्क 25%	1509367/-
4. मू० विमाजन	
5. पर्यवेक्षण शुल्क	106401/-
6. अम्बार शुल्क	
7. किश्तें	
8. दण्ड ब्याज	
8. अन्य लेव (लेख)	563921/-
निरीक्षण शुल्क	958331/-
योग	1672232/-

पुत्र श्री. लक्ष्मी मिडा

निवासी श्री. न. छे. म. सिटी कालेनी झाँसी

के पक्ष में धनराशि

झाँसी विकास प्राधिकरण

खाते में जमा किया।

रु० 1672232/-

जमाकर्ता के हस्ताक्षर