

LAYOUT PLAN

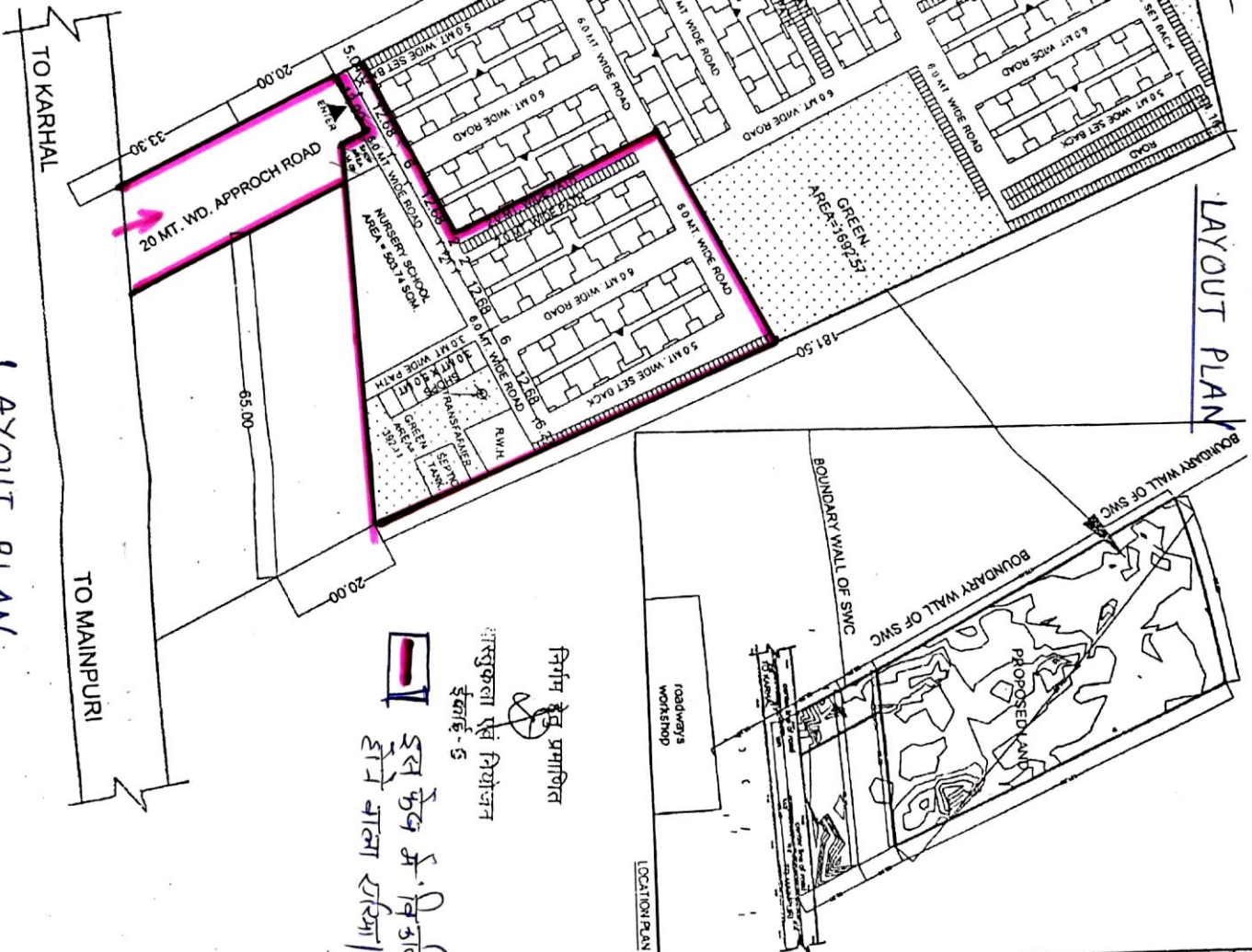

LAYOUT PLAN

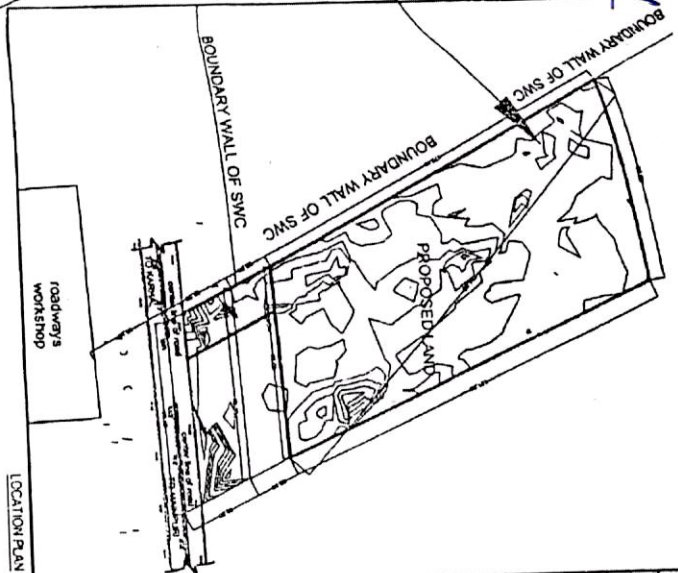
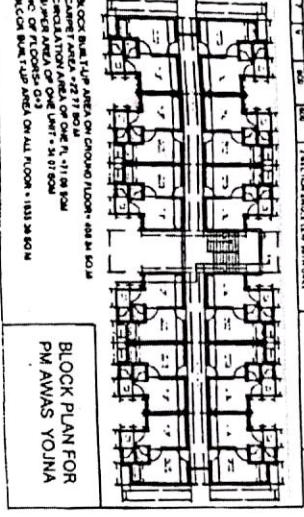

निर्माण क्षेत्र प्रमाणित
 सुरक्षा एवं नियोजन
 इकाई - 5
 सुरक्षा एवं नियोजन
 क्षेत्र योजना दर्शिका

NOTE:
 1. THE LAYOUT PLAN HAS BEEN PREPARED ON THE BASIS OF PROPOSITION/DEMAND RECEIVED BY EX-EN. THE LETTER NO. 1995 UPHDB/PM/CO-29/1712/2018 DATED 17.12.2018.
 2. THE LAYOUT PLAN HAS BEEN FINALIZED ON THE BASIS OF DESIGN RECEIVED BY EX-EN CO-29 VIDE HIS LETTER NO. 1995 UPHDB/PM/CO-29/1712/2018 DATED 17.12.2018.

1. TOTAL LOT AREA	15000.00 M ²
2. F. AREA EXPOSED	17998.96 M ² (1.2)
3. G. ROAD COY.	4497.24 M ² (29.98%)
4. TOTAL NO. OF FLOORS	G+3
5. TOTAL NO. OF UNITS (E.W.S)	528 NOS.
6. DENITY	352 UNITS/HECT.
7. TOTAL POPULATION	NO. OF UNITS X 5 PERSONS = 2640 PERSONS
PRO. SPACE FOR SCHOOL	528 X 5 = 2640 PERSONS = 503.74 M ²

REQUIREMENT OF CONVENIENT SHOPS
 FOR 40 PERSONS 01 SHOP @ 15.00 M²
 FOR 240 PERSONS 240 / 15 = 16 SAY 7 SHOPS
REQUIREMENT AREA
 PRO. SPACE FOR CONVENIENT SHOPS = 141.06 M²
 PRO. SPACE FOR KUDA CHAR = 134.44 M²
 PRO. SPACE FOR GREEN PARK = 3009.41 M² OR 20.06%
 PRO. SCOOTER PARKING = 540 NOS.

DRG. TITLE:
 PROPOSED FOR PMAY AT KARHAL ROAD, MAINPURI.

DATE	27.12.2018
DRAUGHTSMAN	KARNI KUMAR
ARCHITECT	MUKESH RUIHELA
ASSTT. ARCHITECT	AJEET KUMAR DUBEY
ARCHITECT/PLANNER	S.K. RAJANI
CHIEF ARCHITECT PLANNER	AJAY CHAUHAN
I.A.S.	AVAS ANIKT