



U.P.A.  
 KARNATAKA  
 GOVT. ENGINEERING COLLEGE  
 HOSUR  
 HO-57  
 HO-57  
 HO-57

DRG. NO. \_\_\_\_\_ SHEET NO. \_\_\_\_\_  
 DATE: \_\_\_\_\_

1. THIS PART SUBMITTING LAYOUT PLAN HAS BEEN  
 PREPARED ON THE BASIS OF INFORMATION  
 RECEIVED BY EXECUTIVE ENGINEER C.D.-2 WIDE WIS  
 LETTER NO. 1055/PA.352 DATED. 10.08.2015.  
 2. THIS PART SUBMITTING LAYOUT PLAN HAS BEEN  
 FINAISED ON THE BASIS OF REASONS RECEIVED  
 BY EXECUTIVE ENGINEER C.D.-2 WIDE WIS LETTER  
 NO. 1472/PA.354 DATED. 11.08.2015

REVISION NOTE:  
 1. THESE PLOTS CONVERTED INTO 18/40 TYPE  
 HOUSES. AS PER INFORMATION RECEIVED BY  
 E.E.C.D.-2 WIDE WIS LETTER NO. 857/PA.354  
 DATED: 06.05.2016 AND S.E. J. WIDE WIS LETTER  
 NO. 423/C.D.-2 DATED: 13.05.2016.  
 2. THIS REVISED PART LAYOUT PLAN HAS BEEN  
 REVISED ON THE BASIS OF FEASIBILITY  
 RECEIVED BY E.E.C.D.-2 WIDE WIS LETTER  
 NO. 1427/PA.2413 DT. 09.05.2016

THE PART REVISED PART LAYOUT PLAN FOR  
 21 NO. OF HOUSES

DESIGNED BY: OBERI YOLJHA, BARABANKI  
 DATE: 14.05.2016

SCALE: \_\_\_\_\_  
 CHECKED BY: \_\_\_\_\_  
 APPROVED BY: \_\_\_\_\_  
 PROJECT APPROVED BY: \_\_\_\_\_  
 APPROVED BY: \_\_\_\_\_

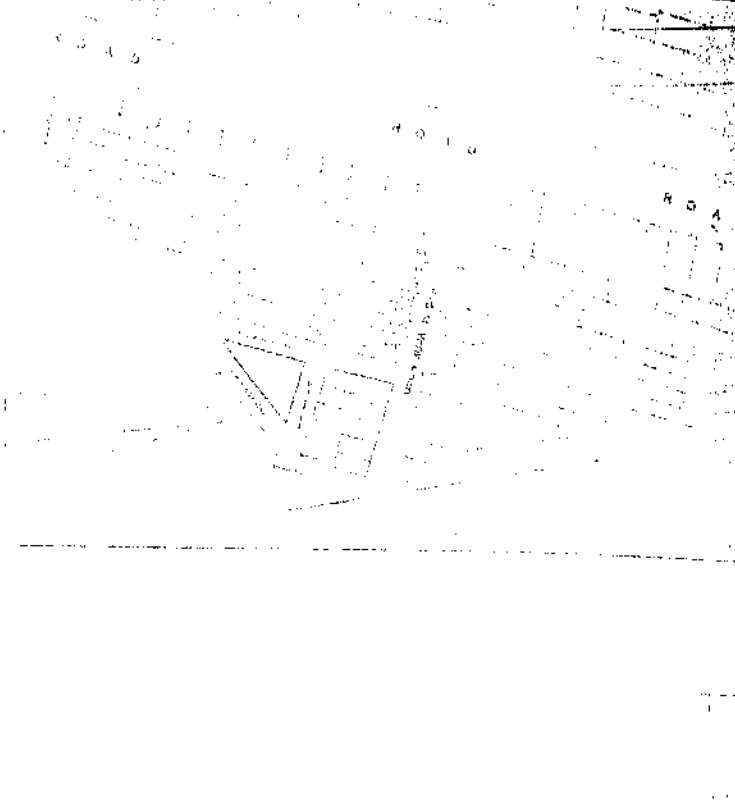
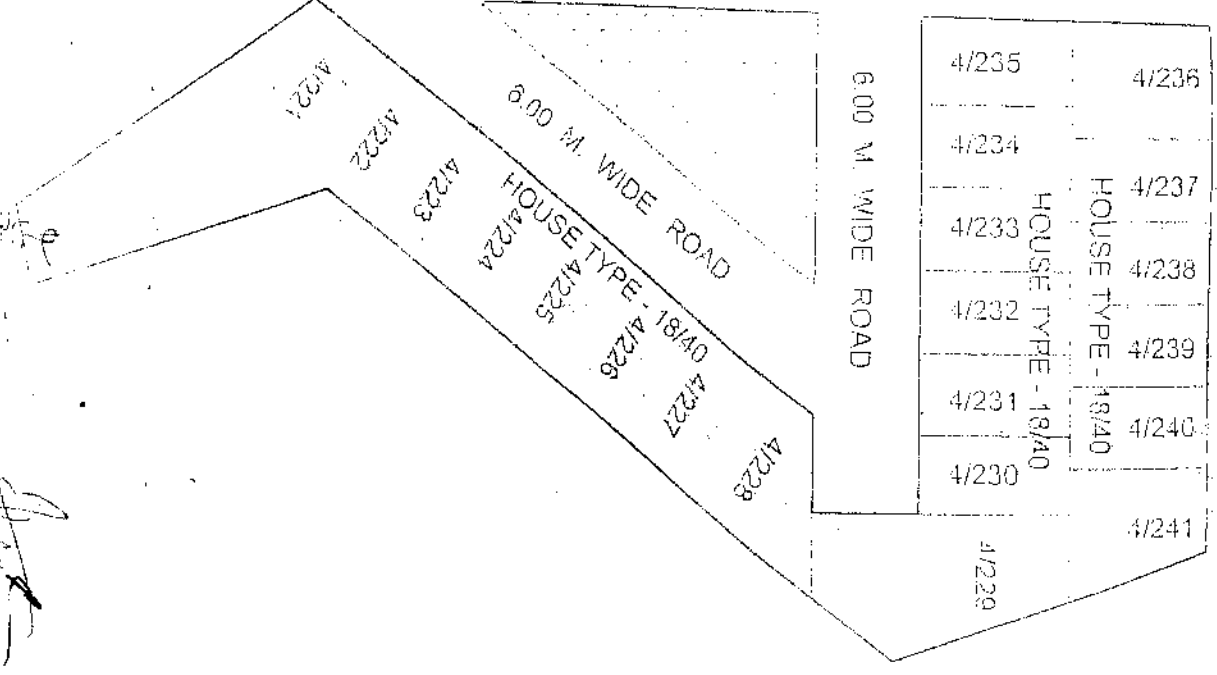

PREVIOUSLY SANCTIONED PART L.O.P.  
 BY H.C. DATED: 01.02.2006

21 NOS. 18/40 TYPE  
 WIS HOUSES  
 Index

