

CALCULATIONS OF AREAS UTILIZED IN RESIDENTIAL

SL. NO.	DESCRIPTION	AREA (sq.m.)	(acres)	%
FOR GROUND COVERAGE				
1	PERMISSIBLE GROUND COVERAGE (35%)	79,832.550	19.72	35
2	ACHIEVED GROUND COVERAGE FOR CLUSTER 1-A, AA & 1B	14,793.580	3.65	6.49
3	PROPOSED GROUND COVERAGE FOR CLUSTER 2	3,912.700	0.97	1.72
4	REMAINING PERMISSIBLE GROUND COVERAGE AREA TO BE UTILIZED	61,126.270	15.1	26.80
FOR FAR				
1	PERMISSIBLE FAR (484697.63) @ 2.5	4,84,697.630	119.74	2.50
2	ACHIEVED FAR FOR CLUSTER 1A, 1AA & 1B	59,241.570	14.63	0.31
3	PROPOSED FAR FOR CLUSTER 2	47,826.770	11.81	0.25
4	REMAINING PERMISSIBLE FAR AREA TO BE UTILIZED	3,77,629.290	93.300	1.948

CALCULATION OF REVISED LAYOUT PLAN FOR GROUP HOUSING AT VILLAGE MIRANPUR PINWAT, KANPUR ROAD, LUCKNOW

Sl. No.	Description	Residential (sq.m)	Mix Landuse (sq.m)	Total (sq.m)
1	Total Plot Area	148433.0	27340.0	320177.000
2	Plot area in Acres	63.372	12.723	76.095
3	Deductions			
3.1	Canal Land	9330.0		9330.0
3.2	UDA Land	11240.0		11240.0
4	Gross Plot area after deduction	238093.0	71744.0	299837.000
5	Gross Plot Area in Acres	56.85	17.72	74.570
6	Required Green Area 10% of Residential Plot Area	34213.95	7174.4	41388.350
7	Net Plot Area for FAR (After deducting Green Area)	193879.050	6459.6	200338.650
8	Permissible Ground Coverage 35%	79832.550	2318.4	82150.950
9	Permissible FAR @ 2.5 of Net Plot Area	484697.630	161424.000	646121.630
10	Incentive FAR against 644 FWS+644 LIG Units	37654.94		37654.94
11	Total Permissible FAR	542354.570	161424.000	703778.565

AREA SCHEDULE OF CLUSTER 2

AREA	NO. OF FLOORS	AREA (sq.m)	AREA (acres)	PERCENTAGE (%)
1	1	10000	2.47	0.48
2	2	20000	4.94	0.96
3	3	30000	7.41	1.44
4	4	40000	9.88	1.92
5	5	50000	12.35	2.39
6	6	60000	14.82	2.88
7	7	70000	17.29	3.37
8	8	80000	19.76	3.86
9	9	90000	22.23	4.35
10	10	100000	24.70	4.84
11	11	110000	27.17	5.33
12	12	120000	29.64	5.82
13	13	130000	32.11	6.31
14	14	140000	34.58	6.80
15	15	150000	37.05	7.29
16	16	160000	39.52	7.78
17	17	170000	41.99	8.27
18	18	180000	44.46	8.76
19	19	190000	46.93	9.25
20	20	200000	49.40	9.74
21	21	210000	51.87	10.23
22	22	220000	54.34	10.72
23	23	230000	56.81	11.21
24	24	240000	59.28	11.70
25	25	250000	61.75	12.19
26	26	260000	64.22	12.68
27	27	270000	66.69	13.17
28	28	280000	69.16	13.66
29	29	290000	71.63	14.15
30	30	300000	74.10	14.64
31	31	310000	76.57	15.13
32	32	320000	79.04	15.62
33	33	330000	81.51	16.11
34	34	340000	83.98	16.60
35	35	350000	86.45	17.09
36	36	360000	88.92	17.58
37	37	370000	91.39	18.07
38	38	380000	93.86	18.56
39	39	390000	96.33	19.05
40	40	400000	98.80	19.54
41	41	410000	101.27	20.03
42	42	420000	103.74	20.52
43	43	430000	106.21	21.01
44	44	440000	108.68	21.50
45	45	450000	111.15	21.99
46	46	460000	113.62	22.48
47	47	470000	116.09	22.97
48	48	480000	118.56	23.46
49	49	490000	121.03	23.95
50	50	500000	123.50	24.44
51	51	510000	125.97	24.93
52	52	520000	128.44	25.42
53	53	530000	130.91	25.91
54	54	540000	133.38	26.40
55	55	550000	135.85	26.89
56	56	560000	138.32	27.38
57	57	570000	140.79	27.87
58	58	580000	143.26	28.36
59	59	590000	145.73	28.85
60	60	600000	148.20	29.34
61	61	610000	150.67	29.83
62	62	620000	153.14	30.32
63	63	630000	155.61	30.81
64	64	640000	158.08	31.30
65	65	650000	160.55	31.79
66	66	660000	163.02	32.28
67	67	670000	165.49	32.77
68	68	680000	167.96	33.26
69	69	690000	170.43	33.75
70	70	700000	172.90	34.24
71	71	710000	175.37	34.73
72	72	720000	177.84	35.22
73	73	730000	180.31	35.71
74	74	740000	182.78	36.20
75	75	750000	185.25	36.69
76	76	760000	187.72	37.18
77	77	770000	190.19	37.67
78	78	780000	192.66	38.16
79	79	790000	195.13	38.65
80	80	800000	197.60	39.14
81	81	810000	200.07	39.63
82	82	820000	202.54	40.12
83	83	830000	205.01	40.61
84	84	840000	207.48	41.10
85	85	850000	209.95	41.59
86	86	860000	212.42	42.08
87	87	870000	214.89	42.57
88	88	880000	217.36	43.06
89	89	890000	219.83	43.55
90	90	900000	222.30	44.04
91	91	910000	224.77	44.53
92	92	920000	227.24	45.02
93	93	930000	229.71	45.51
94	94	940000	232.18	46.00
95	95	950000	234.65	46.49
96	96	960000	237.12	46.98
97	97	970000	239.59	47.47
98	98	980000	242.06	47.96
99	99	990000	244.53	48.45
100	100	1000000	247.00	48.94

Parking requirements Cluster 2

Areas in Sq.mt.

Total F.A.R. Area	47826.770
Parking Required @ 1.5cars/100sq.mt. covered area	717
Total Required Parking	717

Parking Provided Cluster 2

1	Basement	356
2	Surface	178
3	STILT	225
Total Parking provided	759	

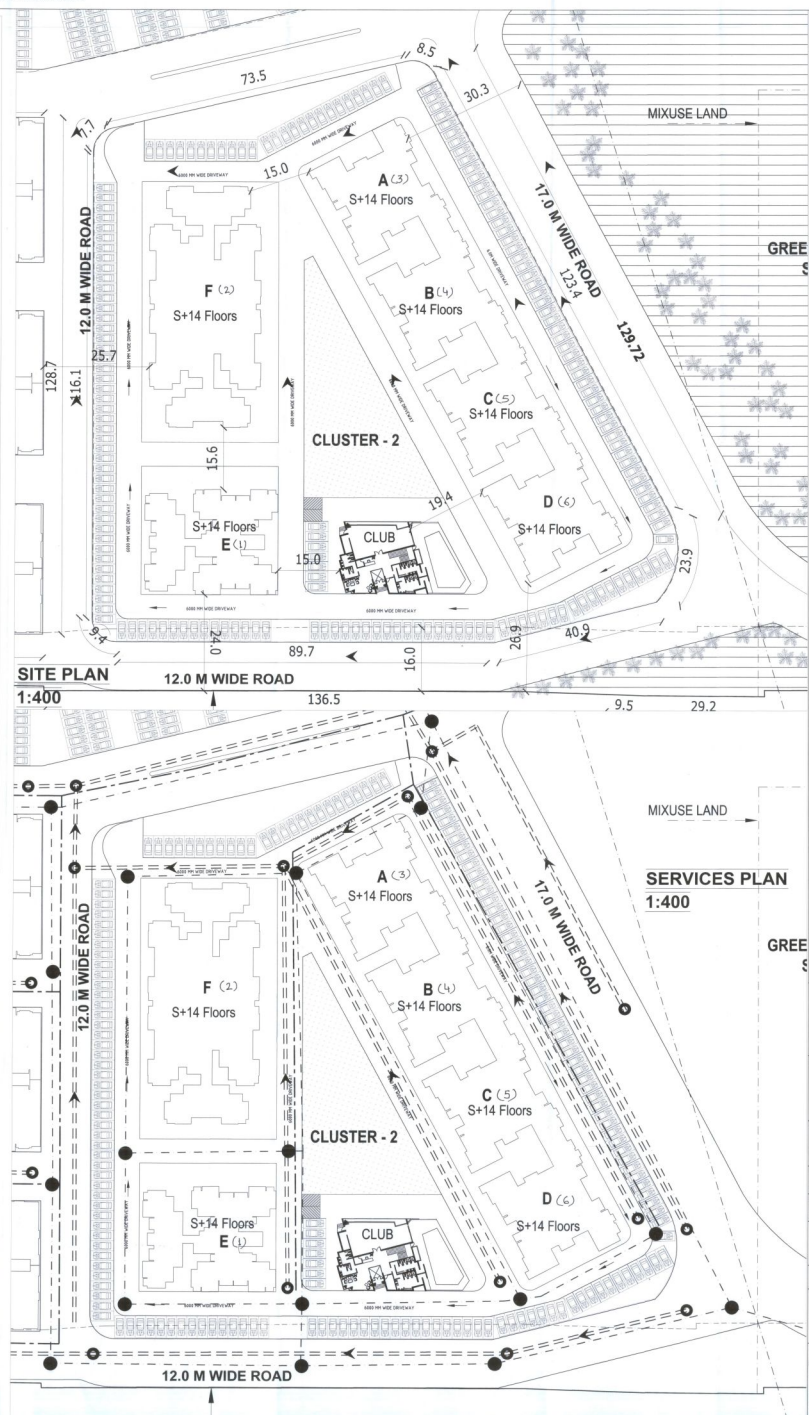

NOTES

PROJECT

Revised Layout Plan for Group Housing at Village-Miranpur Pinwat, Kanpur Road, Lucknow

On Kharsa No - 121P, 122P, 130, 131, 132, 133, 134, 135, 136, 137, 138, 139, 140, 141, 142, 143, 144, 145, 146, 147, 148, 149, 150, 151, 152, 153, 154, 156, 167, 178, 179P, 180, 181, 182, 183, 184, 185P, 185SA, 186, 187SA, 188SA, 187P, 188P, 189, 190, 191, 192, 193, 194, 195, 196, 197, 198, 199, 200, 201, 202, 203P, 203SA, 204, 205, 206P, 206SA, 207, 209, 210, 211, 212, 213, 214, 215, 216, 217, 218, 219, 220, 220T01, 221, 222, 223, 224, 225, 226, 227, 228, 229, 233SA, 236SA, 239, 240, 248P, 254P, 259P, 261, 262, 263, 264, 265, 266, 267, 268

at Village-Miranpur Pinwat Pargana-Bijnour, Tahsil & District-Lucknow

KEY PLAN

LEGEND

- RWH NETWORK
- WATER SUPPLY LINE
- SEWER LINE
- M.H.S MAN HOLE
- R.H.W.P. RAIN WATER HARVESTING PIT
- MAN HOLE

SUBMISSION DRAWING OF CLUSTER - 2 (GOLD FINCH STATE) ON KHARSA NO. 195,196P,194P,193P,192P,188,216P,217P

DESIGNED BY: **RAD** (RUPAKSHISHKE ARCHITECTS AND DESIGNERS)

DRAWING TITLE: **SITE PLAN (CLUSTER - 2)**

DEALT BY: **PAVINDRA** | CHECKED BY: **NORTH**

SCALE: **DATE** | DRAWING NUMBER: **NO. ARCH/RES/21/01/201**

DATE: **20/01/2021** | DATE: **20/01/2021**

Land Owner: **FOUR LEAF DEVELOPERS PRIVATE LIMITED**

Developed by: **M/S PANKAJ INFRA BUILD PVT.LTD., PLOT NO. 73, GROUND FLOOR, PATPARGANJA INDUSTRIAL AREA, NEW DELHI-110092**

ARCHITECT: **RUPAKSHISHKE ENTERPRISES PVT. LTD.**

Signature: **[Signature]**