

EARLIER APPROVED LAYOUT PLAN

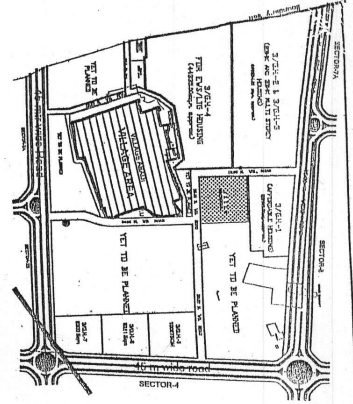

PROPOSED LAYOUT PLAN

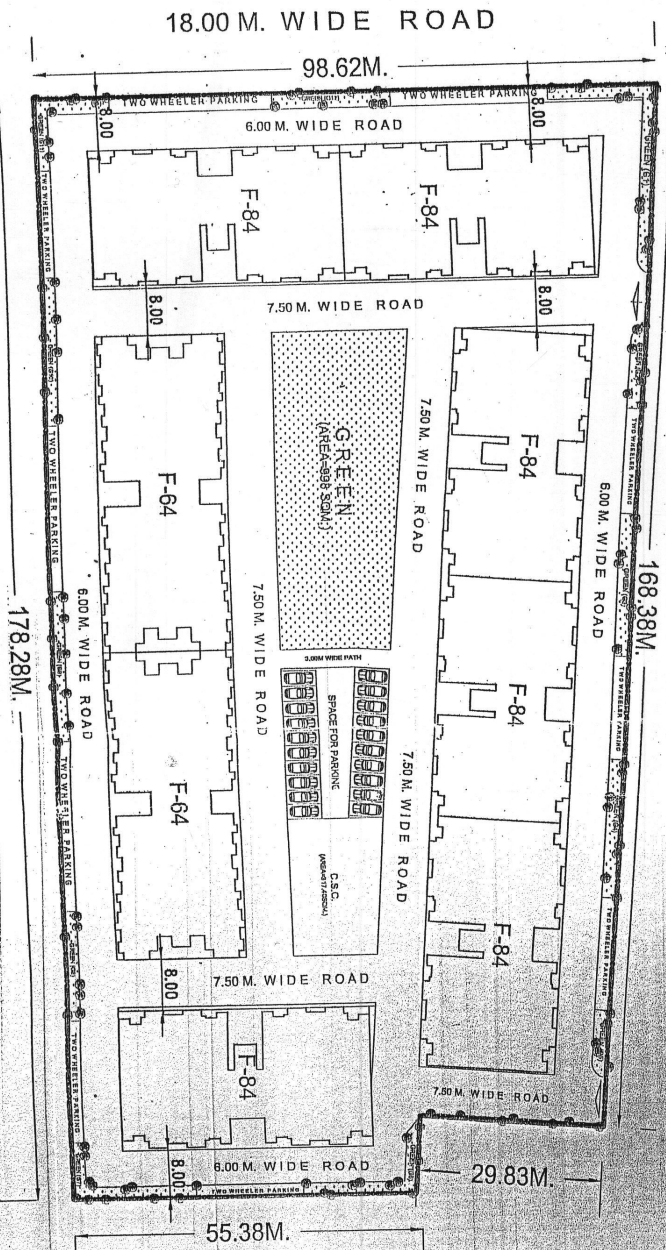
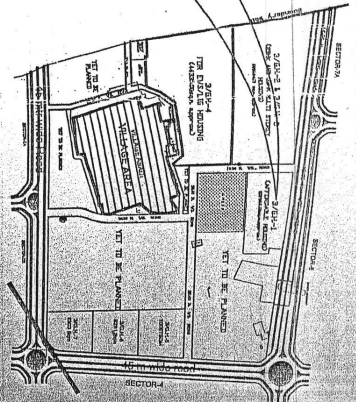

45.00 M. WIDE ROAD

168.38M.

29.83M.

55.38M.

18.00 M. WIDE ROAD

98.62M.

6.00 M. WIDE ROAD

7.50 M. WIDE ROAD

7.50 M. WIDE ROAD

7.50 M. WIDE ROAD

7.50 M. WIDE ROAD

7.50 M. WIDE ROAD

7.50 M. WIDE ROAD

SPACE FOR PARKING

C.S.C.

(WATER/SEWER)

GREEN

(AREA-988 SQ.M.)

F-84

F-84

F-64

F-84

F-84

F-84

F-64

F-84

<p>UPVP ARCHITECTURE AND PLANNING UNIT-3 NEELGIRI COMPLEX, INDRA NAGAR LUCKNOW</p>						
DRG. NO.						
FILE NO.						
<p>NOTE: THIS REVISD LAYOUT PLAN HAS BEEN A GAIN REVISD ON THE BASIS OF THE REVISION RECEIVED FROM THE (PUNDA) V.A. (CIRCLE) UNDER HIS LETTER NO. 1415 DATED 15/07/2014, 1453 DATED 23/07/2014 AND THE C.D. (V) UNDER HIS LETTER NO. 2900 DATED 11/07/2014 AND THIS REVISD LAYOUT PLAN HAS BEEN PREPARED ON THE BASIS OF THE REVISION RECEIVED FROM THE C.D. (V) UNDER HIS LETTER NO. 163/2014.</p>						
PARTICULAR	15856.00 SQ.M.					
LAND AREA						
RESIDENTIAL						
S.N. PARTICULAR	AREA (SQ.M.)	NO. OF UNITS	NO. OF FLOORS	TOTAL AREA (SQ.M.)	TOTAL FLOORS	
(A) F-84	2	12	S+7	188	77.022	154.84
(B) F-64	8	8	S+7	136	67.036	106.876
TOTAL	10	20		324	144.058	261.716
P.A.E. AGREED					2.45	
GREEN					10%	
DEPT. BY:	DATE:	DRG. NO.:				
VIKAS SINGH						
DIKSHAN (CIVIL)						
PROJECT:	AVADH VIHAR YOJNA					
	SULTANPUR ROAD, LUCKNOW.					
DRG. TITLE:	REVISD LAYOUT PLAN OF G.H.P. LOT NO. - 16 G.H. - 01 (AFFORDABLE HOUSING) (G+1 + 7 FLOORS)					
DATE:	05.09.2014					
SCALE:	N.T.S.					
A.D. ARYA	ASSTT. ARCH. PLANNER					
AJIT DUBEY	ARCHITECT PLANNER					
CHIEF ARCH. PLANNER	SHAHABUDDIN MOHAMMAD I.A.S.					
AVAS AYUKT						