

S.no.	Plot no.	Plot Area
1.	A11	149.92
2.	A12	205.15
3.	A13	182.57
4.	A14	148.10
5.	A15	148.33
6.	A16	148.57
7.	A17	161.11
8.	B1	190.65
Total		1334.40

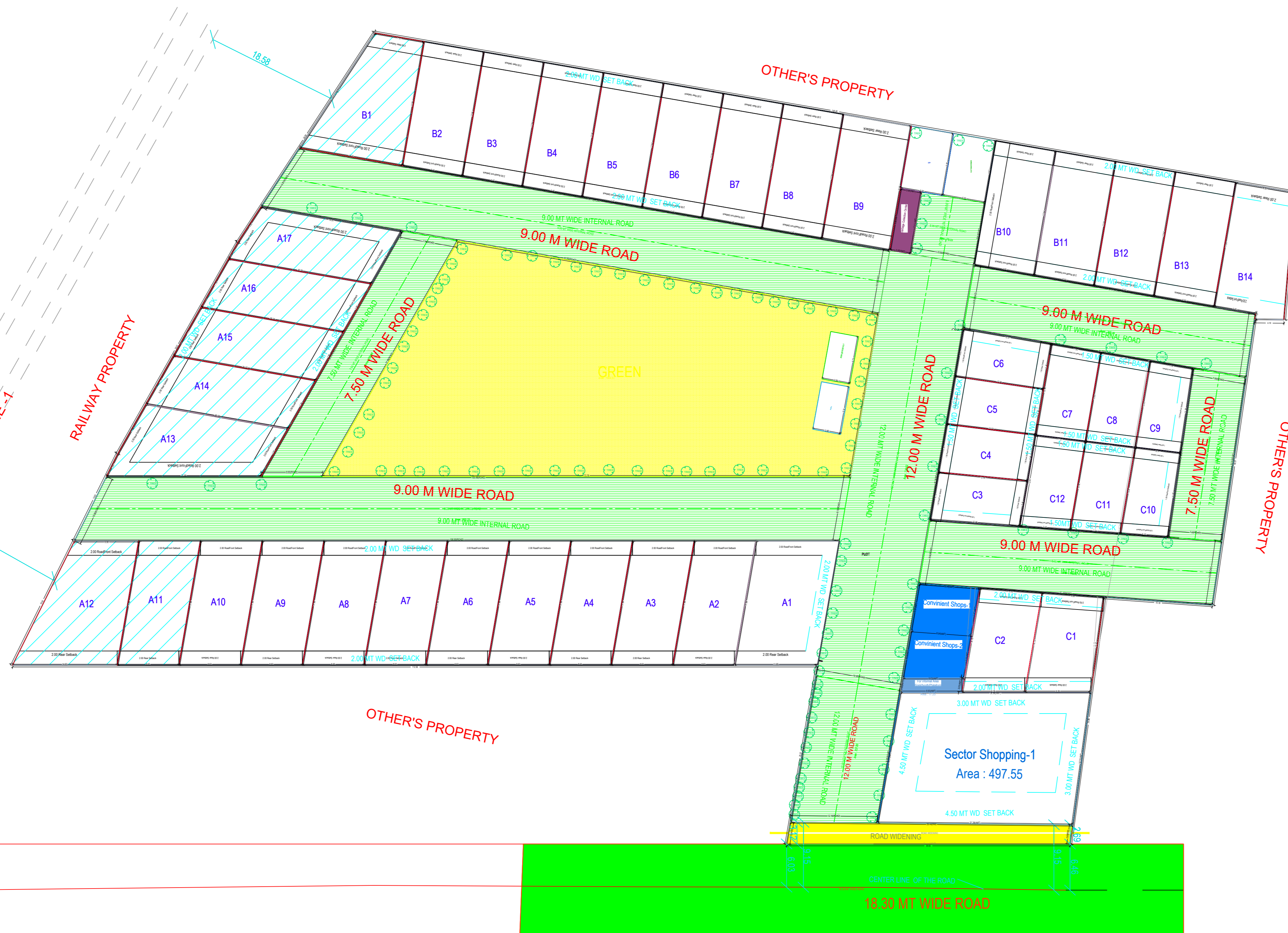

Name	Reqd	Minum Area	Prop	Minum Count	Prop
Convent Shops	10.00	110.89	-	2.00	-
Sector Shopping	50.00	497.55	-	1.00	-
For Informal Area	7.50	17.25	-	1.00	-
Garbage Collection Center	15.00	26.45	1.00	1.00	1.00

Area covered under	Proposed Area in sq. mt.	Percentage(%)
Plotted Area	3954.50	47.35
Road Area	3959.29	31.48
Garbage Collection Center	26.45	0.21
For Informal Area	17.25	0.14
Sector Shopping	497.55	3.96
Convent Shops	54.20	0.43
Convent Shops-2	56.89	0.45
Public Open Space	1904.82	15.14
Other Area	195.91	0.84
Total net layout	15276.86	100.00

Plot	Name	No. of Trees
Reqd	Prop	
F1/D1	Tree	111

Plot No.	Abutting	Plot Area	Frontage	Coverage	FSI Area						
Reqd	Perm	Prop	Reqd	Perm	Prop						
B2	INTERNAL ROAD	40.00	-	149.94	3.50	8.50	0.00	0.00	0.00	-	0.00
B1	INTERNAL ROAD	40.00	-	190.65	3.50	14.61	0.00	0.00	0.00	-	0.00
B9	INTERNAL ROAD	40.00	-	189.55	3.50	9.61	0.00	0.00	0.00	-	0.00
B8	INTERNAL ROAD	40.00	-	149.94	3.50	8.50	0.00	0.00	0.00	-	0.00
B7	INTERNAL ROAD	40.00	-	149.94	3.50	8.50	0.00	0.00	0.00	-	0.00
B6	INTERNAL ROAD	40.00	-	149.94	3.50	8.50	0.00	0.00	0.00	-	0.00
B5	INTERNAL ROAD	40.00	-	149.94	3.50	8.50	0.00	0.00	0.00	-	0.00
B4	INTERNAL ROAD	40.00	-	149.94	3.50	8.50	0.00	0.00	0.00	-	0.00
E3	INTERNAL ROAD	40.00	-	149.94	3.50	8.50	0.00	0.00	0.00	-	0.00
B14	INTERNAL ROAD	40.00	-	162.83	3.50	9.97	0.00	0.00	0.00	-	0.00
B13	INTERNAL ROAD	40.00	-	149.94	3.50	8.50	0.00	0.00	0.00	-	0.00
B12	INTERNAL ROAD	40.00	-	149.94	3.50	8.50	0.00	0.00	0.00	-	0.00
B11	INTERNAL ROAD	40.00	-	149.94	3.50	8.50	0.00	0.00	0.00	-	0.00
B10	INTERNAL ROAD	40.00	-	149.94	3.50	8.50	0.00	0.00	0.00	-	0.00
A2	INTERNAL ROAD	40.00	-	149.92	3.50	8.63	0.00	0.00	0.00	-	0.00
A3	INTERNAL ROAD	40.00	-	149.92	3.50	8.63	0.00	0.00	0.00	-	0.00
A4	INTERNAL ROAD	40.00	-	149.92	3.50	8.63	0.00	0.00	0.00	-	0.00
A5	INTERNAL ROAD	40.00	-	149.92	3.50	8.63	0.00	0.00	0.00	-	0.00
A6	INTERNAL ROAD	40.00	-	149.92	3.50	8.63	0.00	0.00	0.00	-	0.00
A7	INTERNAL ROAD	40.00	-	149.92	3.50	8.63	0.00	0.00	0.00	-	0.00
A8	INTERNAL ROAD	40.00	-	149.92	3.50	8.63	0.00	0.00	0.00	-	0.00
A9	INTERNAL ROAD	40.00	-	149.92	3.50	8.63	0.00	0.00	0.00	-	0.00
A10	INTERNAL ROAD	40.00	-	149.92	3.50	8.63	0.00	0.00	0.00	-	0.00
A11	INTERNAL ROAD	40.00	-	149.92	3.50	8.63	0.00	0.00	0.00	-	0.00
A12	INTERNAL ROAD	40.00	-	205.15	3.50	8.98	0.00	0.00	0.00	-	0.00
A1	INTERNAL ROAD	40.00	-	202.45	3.50	11.65	0.00	0.00	0.00	-	0.00
A17	INTERNAL ROAD	40.00	-	161.11	3.50	8.50	0.00	0.00	0.00	-	0.00
A16	INTERNAL ROAD	40.00	-	148.57	3.50	7.80	0.00	0.00	0.00	-	0.00
A15	INTERNAL ROAD	40.00	-	148.33	3.50	7.80	0.00	0.00	0.00	-	0.00
A14	INTERNAL ROAD	40.00	-	148.10	3.50	7.80	0.00	0.00	0.00	-	0.00
A13	INTERNAL ROAD	40.00	-	182.57	3.50	7.67	0.00	0.00	0.00	-	0.00
C6	INTERNAL ROAD	40.00	-	82.93	3.50	6.62	0.00	0.00	0.00	-	0.00
C5	INTERNAL ROAD	40.00	-	82.95	3.50	6.79	0.00	0.00	0.00	-	0.00
C10	INTERNAL ROAD	40.00	-	79.15	3.50	6.72	0.00	0.00	0.00	-	0.00
C11	INTERNAL ROAD	40.00	-	87.15	3.50	7.04	0.00	0.00	0.00	-	0.00
C12	INTERNAL ROAD	40.00	-	89.55	3.50	7.03	0.00	0.00	0.00	-	0.00
C3	INTERNAL ROAD	40.00	-	82.98	3.50	6.79	0.00	0.00	0.00	-	0.00
C4	INTERNAL ROAD	40.00	-	82.98	3.50	6.79	0.00	0.00	0.00	-	0.00
C9	INTERNAL ROAD	40.00	-	75.44	3.50	6.09	0.00	0.00	0.00	-	0.00
C8	INTERNAL ROAD	40.00	-	87.91	3.50	7.00	0.00	0.00	0.00	-	0.00
C7	INTERNAL ROAD	40.00	-	89.45	3.50	7.00	0.00	0.00	0.00	-	0.00
C1	INTERNAL ROAD	40.00	-	122.99	3.50	8.69	0.00	0.00	0.00	-	0.00
C2	INTERNAL ROAD	40.00	-	124.90	3.50	8.69	0.00	0.00	0.00	-	0.00

Plot Name	Use	Sub Use	Range	No.	Perm. Person/Plot	Perm. Person/Unit	Total Person/Plot	Total
B2	Residential	Row House		2	10		10	
B8	Residential	Row House		2	10		10	
B7	Residential	Row House		2	10		10	
B6	Residential	Row House		2	10		10	
B5	Residential	Row House		2	10		10	
B4	Residential	Row House		2	10		10	
B3	Residential	Row House		2	10		10	
B13	Residential	Row House		2	10		10	
B12	Residential	Row House		2	10		10	
B11	Residential	Row House		2	10		10	
B10	Residential	Row House		2	10		10	
A2	Residential	Row House		2	10		10	
A3	Residential	Row House		2	10		10	
A4	Residential	Row House		2	10		10	
A5	Residential	Row House		2	10		10	
A6	Residential	Row House		2	10		10	
A7	Residential	Row House		2	10		10	
A8	Residential	Row House	above 50 upto 100sqmt	36	5		360	
A10	Residential	Row House		2	10		10	
A11	Residential	Row House		2	10		10	
A16	Residential	Row House		2	10		10	
A15	Residential	Row House		2	10		10	
A14	Residential	Row House		2	10		10	
C6	Residential	Row House		2	10		10	
C5	Residential	Row House		2	10		10	
C10	Residential	Row House		2	10		10	
C11	Residential	Row House		2	10		10	
C12	Residential	Row House		2	10		10	
C3	Residential	Row House		2	10		10	
C4	Residential	Row House		2	10		10	
C9	Residential	Row House		2	10		10	
C8	Residential	Row House		2	10		10	
C1	Residential	Row House		2	10		10	
C2	Residential	Row House		2	10		10	
B1	Residential	Row House		4	20		40	
B9	Residential	Row House		4	20		40	
B14	Residential	Row House	above 300sqmt	7	5		140	
A12	Residential	Row House		4	20		40	
A1	Residential	Row House		4	20		40	
A17	Residential	Row House		4	20		40	
A13	Residential	Row House		4	20		40	
Grand Total								500

Plot No.	Reqd	Perm	Prop	Reqd	Perm	Prop
750/hec	-	189	100	-	944	500

Name	Prop. Area
GREEN	1904.82

Color	Description
Green	ABUTTING ROAD
Red	PROPOSED CONSTRUCTION
Yellow	COMMON PLOT
Blue	ROAD ALIGNMENT (ROAD WIDENING AREA)
Light Blue	FUTURE T.P SCHEME DEDUCTION AREA
Dark Blue	EXISTING (To be retained)
Light Green	EXISTING (To be demolished)

OWNER'S NAME AND SIGNATURE
 SHRI NIKHIL AGARWAL S/O SHRI JAGDEEP KUMAR AGARWAL,uddeepsur@gmail.com,971913003
 SHRI TUSHAR AGARWAL S/O SHRI SATJEEV KUMAR AGARWAL,uddeepsur@gmail.com,971913003

ARCHENG'S NAME AND SIGNATURE
 ALINA ASIF
 CA2017/83616

Moradabad Development Authority



Building Plan Application Number
 MBDA/LD/22-23/0203

Sanctioned On
 17 Jan 2023

Valid Till
 09 Feb 2028

Approved By
 Shailesh Kumar (Vice Chairman)

Examined By
 SATYAVEER SINGH (Junior engineer)
 sagar gupta (Assistant Engineer/ ATP)
 Kaushendra Kumar Gautam (Town Planner)
 sagar gupta (Assistant Engineer/ ATP)
 Kaushendra Kumar Gautam (Town Planner)

SITE PLAN

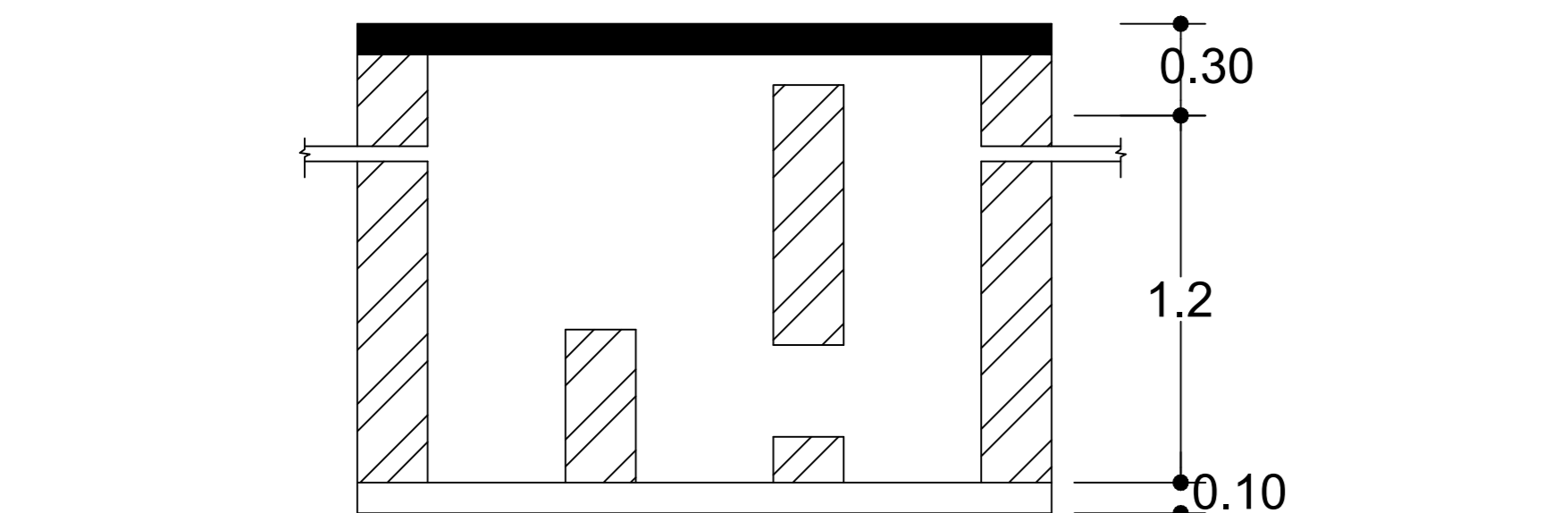

SEC. DESILTING CHAMBER

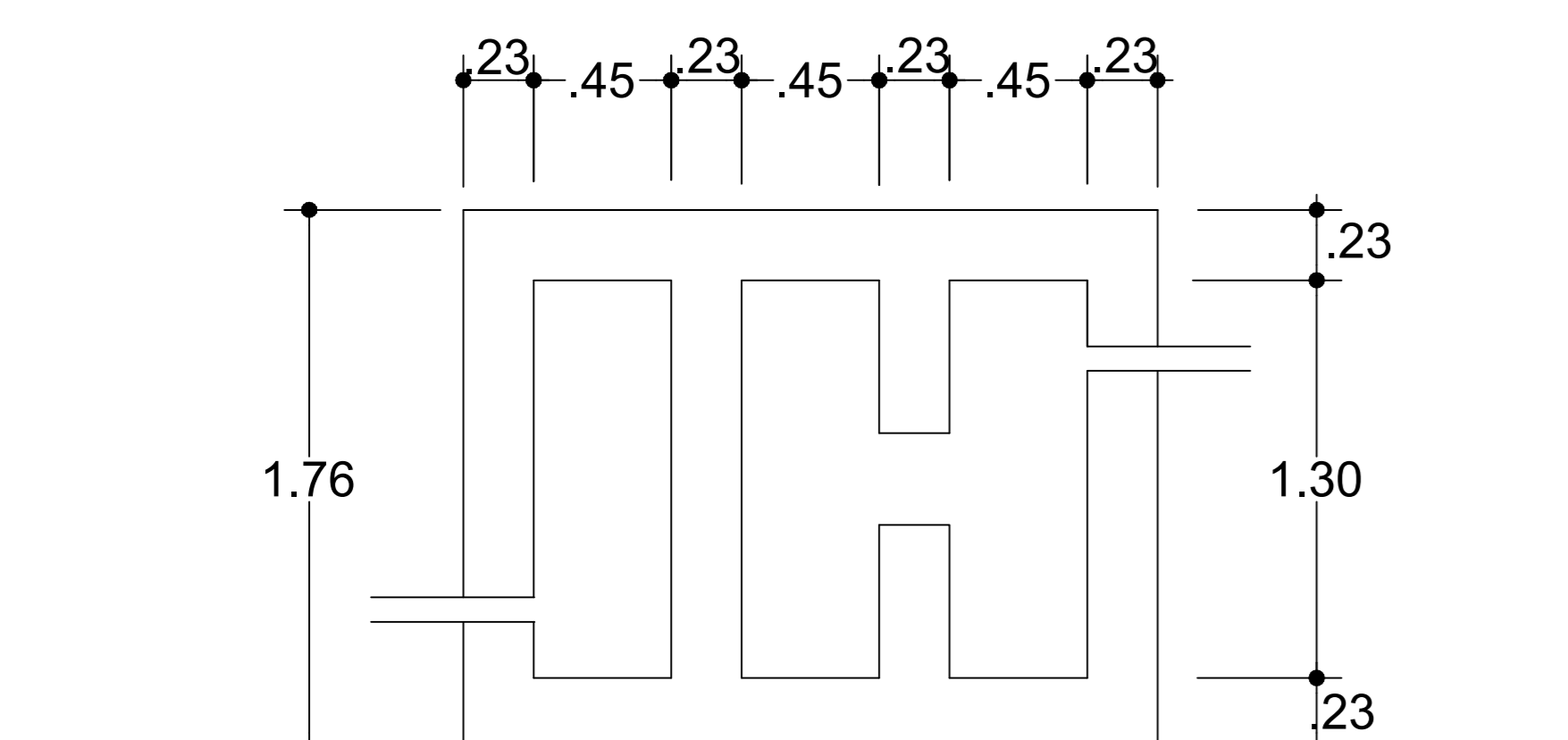

PLAN DESILTING CHAMBER

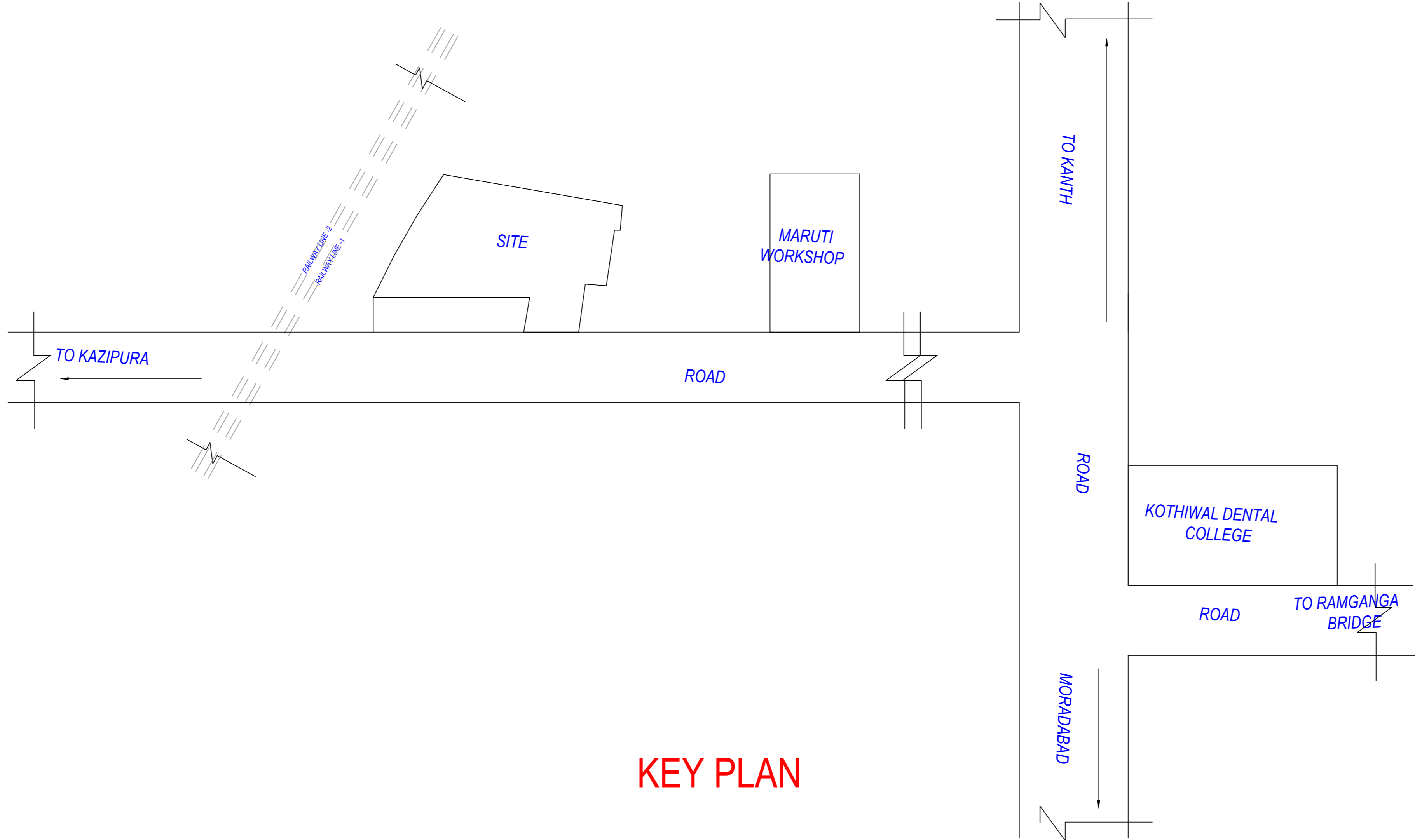

KEY PLAN

Note: - 1) This drawing is prepared as per the current prevailing Building Bye Laws.
 2) If Map sanctioned is used for purpose anything other than stated in application will lead to rejection of Map.

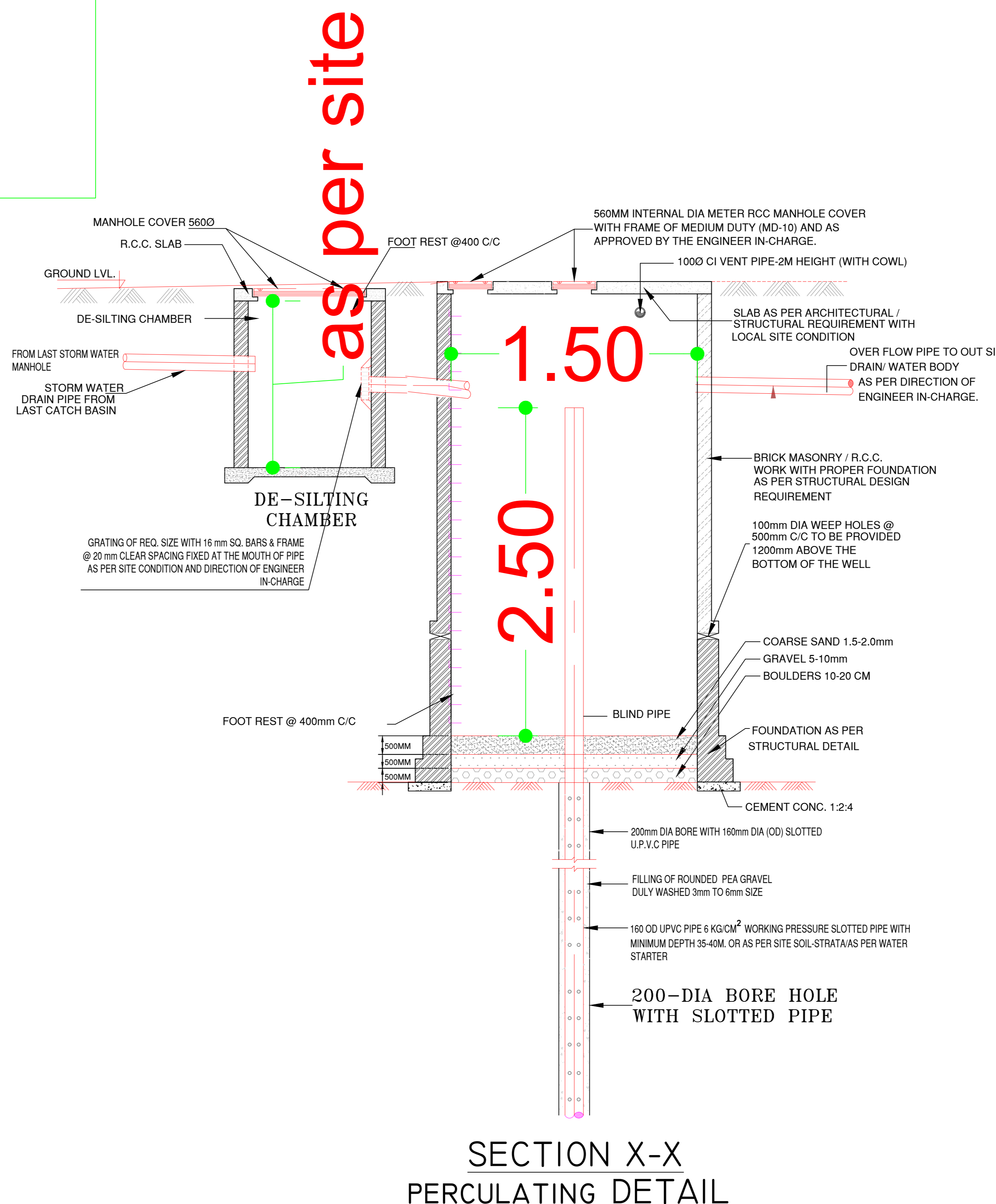
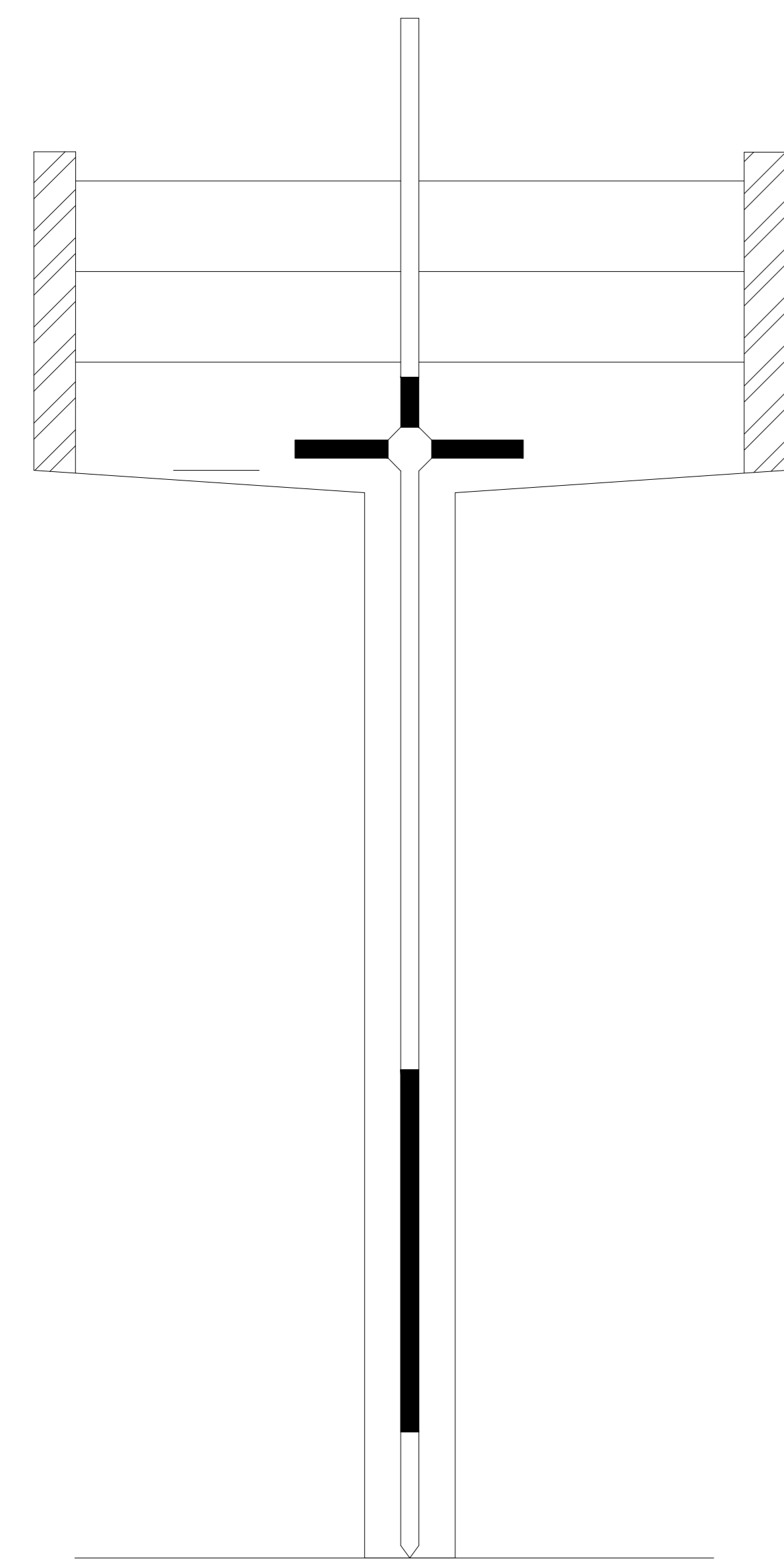
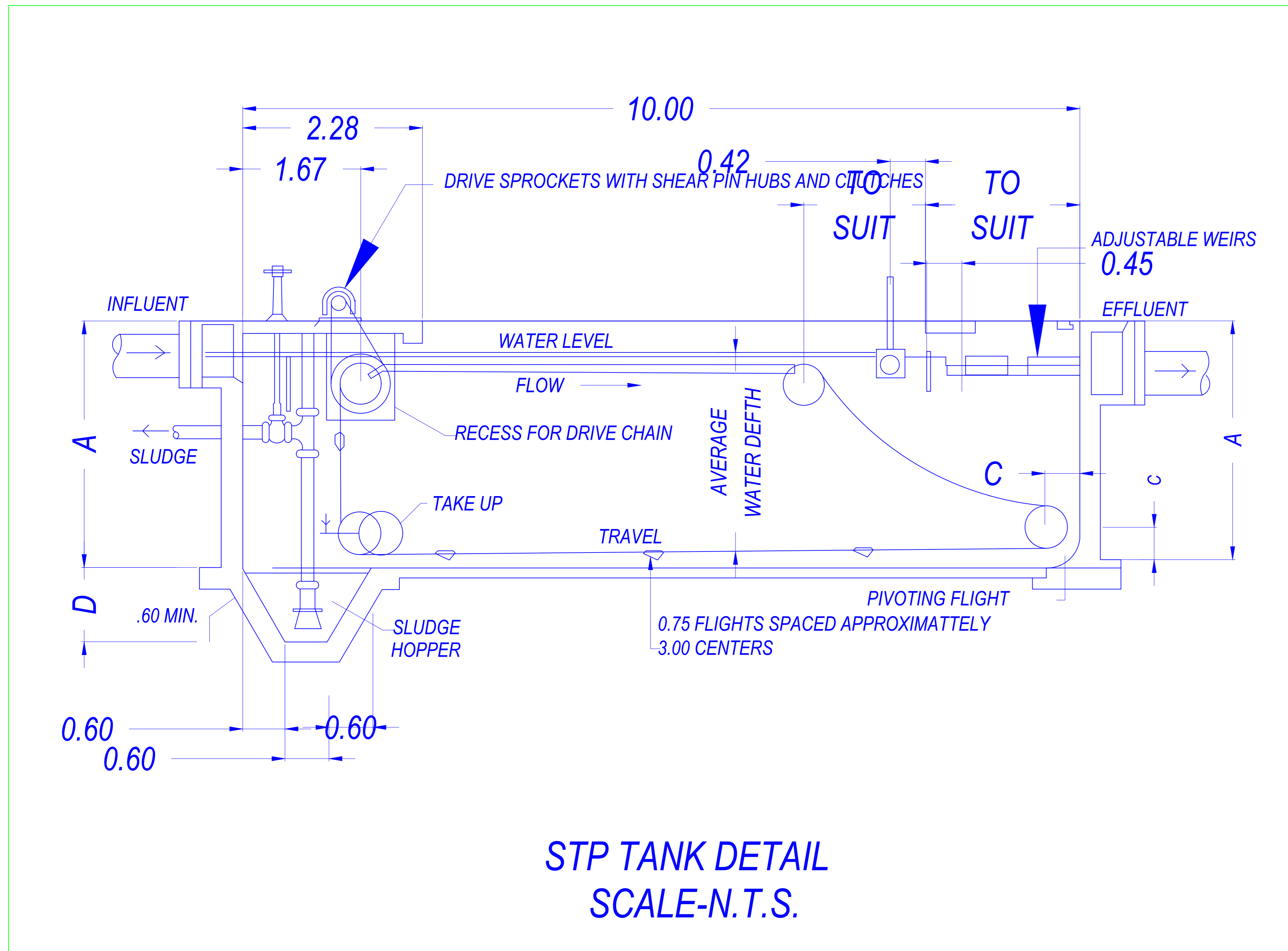

Plot No.	Pavk-Block	Abutting Road	Front		Side1		Side2		Rear		Coverage	FSI Area
			Reqd	Prop	Reqd	Prop	Reqd	Prop	Reqd	Prop		
B2		9.00 MT WIDE INTERNAL ROAD	2.00	-	-	-	-	-	-	-	0.00	0.00
B1		9.00 MT WIDE INTERNAL ROAD	2.00	-	-	-	-	-	-	-	0.00	0.00
B9		9.00 MT WIDE INTERNAL ROAD	2.00	-	-	-	-	-	-	-	0.00	0.00
B8		9.00 MT WIDE INTERNAL ROAD	2.00	-	-	-	-	-	-	-	0.00	0.00
B7		9.00 MT WIDE INTERNAL ROAD	2.00	-	-	-	-	-	-	-	0.00	0.00
B6		9.00 MT WIDE INTERNAL ROAD	2.00	-	-	-	-	-	-	-	0.00	0.00
B5		9.00 MT WIDE INTERNAL ROAD	2.00	-	-	-	-	-	-	-	0.00	0.00
B4		9.00 MT WIDE INTERNAL ROAD	2.00	-	-	-	-	-	-	-	0.00	0.00
B3		9.00 MT WIDE INTERNAL ROAD	2.00	-	-	-	-	-	-	-	0.00	0.00
B14		9.00 MT WIDE INTERNAL ROAD	2.00	-	-	-	-	-	-	-	0.00	0.00
B13		9.00 MT WIDE INTERNAL ROAD	2.00	-	-	-	-	-	-	-	0.00	0.00
B12		9.00 MT WIDE INTERNAL ROAD	2.00	-	-	-	-	-	-	-	0.00	0.00
B11		9.00 MT WIDE INTERNAL ROAD	2.00	-	-	-	-	-	-	-	0.00	0.00
B10		8.99 MT WIDE INTERNAL ROAD	2.00	-	-	-	-	-	-	-	0.00	0.00
B10		9.00 MT WIDE INTERNAL ROAD	2.00	-	-	-	-	-	-	-	0.00	0.00
A2		9.00 MT WIDE INTERNAL ROAD	2.00	-	-	-	-	-	-	-	0.00	0.00
A3		9.00 MT WIDE INTERNAL ROAD	2.00	-	-	-	-	-	-	-	0.00	0.00
A4		9.00 MT WIDE INTERNAL ROAD	2.00	-	-	-	-	-	-	-	0.00	0.00
A5		9.00 MT WIDE INTERNAL ROAD	2.00	-	-	-	-	-	-	-	0.00	0.00
A6		9.00 MT WIDE INTERNAL ROAD	2.00	-	-	-	-	-	-	-	0.00	0.00
A7		9.00 MT WIDE INTERNAL ROAD	2.00	-	-	-	-	-	-	-	0.00	0.00
A8		9.00 MT WIDE INTERNAL ROAD	2.00	-	-	-	-	-	-	-	0.00	0.00
A9		9.00 MT WIDE INTERNAL ROAD	2.00	-	-	-	-	-	-	-	0.00	0.00
A10		9.00 MT WIDE INTERNAL ROAD	2.00	-	-	-	-	-	-	-	0.00	0.00
A11		9.00 MT WIDE INTERNAL ROAD	2.00	-	-	-	-	-	-	-	0.00	0.00
A12		9.00 MT WIDE INTERNAL ROAD	2.00	-	-	-	-	-	-	-	0.00	0.00
A1		12.00 MT WIDE INTERNAL ROAD	2.00	-	-	-	-	-	-	-	0.00	0.00
A1		9.00 MT WIDE INTERNAL ROAD	2.00	-	-	-	-	-	-	-	0.00	0.00
A17		7.50 MT WIDE INTERNAL ROAD	2.00	-	-	-	-	-	-	-	0.00	0.00
A17		9.00 MT WIDE INTERNAL ROAD	2.00	-	-	-	-	-	-	-	0.00	0.00
A16		7.50 MT WIDE INTERNAL ROAD	2.00	-	-	-	-	-	-	-	0.00	0.00
A15		7.50 MT WIDE INTERNAL ROAD	2.00	-	-	-	-	-	-	-	0.00	0.00
A14		7.50 MT WIDE INTERNAL ROAD	2.00	-	-	-	-	-	-	-	0.00	0.00
A13		7.50 MT WIDE INTERNAL ROAD	2.00	-	-	-	-	-	-	-	0.00	0.00
A13		9.00 MT WIDE INTERNAL ROAD	2.00	-	-	-	-	-	-	-	0.00	0.00
C6		12.00 MT WIDE INTERNAL ROAD	1.50	-	-	-	-	-	-	-	0.00	0.00
C6		9.00 MT WIDE INTERNAL ROAD	1.50	-	-	-	-	-	-	-	0.00	0.00
C10		9.00 MT WIDE INTERNAL ROAD	1.50	-	-	-	-	-	-	-	0.00	0.00
C10		7.50 MT WIDE INTERNAL ROAD	1.50	-	-	-	-	-	-	-	0.00	0.00
C11		9.00 MT WIDE INTERNAL ROAD	1.50	-	-	-	-	-	-	-	0.00	0.00
C12		9.00 MT WIDE INTERNAL ROAD	1.50	-	-	-	-	-	-	-	0.00	0.00
C3		9.00 MT WIDE INTERNAL ROAD	1.50	-	-	-	-	-	-	-	0.00	0.00
C3		9.00 MT WIDE INTERNAL ROAD	1.50	-	-	-	-	-	-	-	0.00	0.00
C4		12.00 MT WIDE INTERNAL ROAD	1.50	-	-	-	-	-	-	-	0.00	0.00
C9		9.00 MT WIDE INTERNAL ROAD	1.50	-	-	-	-	-	-	-	0.00	0.00
C8		7.50 MT WIDE INTERNAL ROAD	1.50	-	-	-	-	-	-	-	0.00	0.00
C8		9.00 MT WIDE INTERNAL ROAD	1.50	-	-	-	-	-	-	-	0.00	0.00
C7		9.00 MT WIDE INTERNAL ROAD	1.50	-	-	-	-	-	-	-	0.00	0.00
C1		9.00 MT WIDE INTERNAL ROAD	1.50	-	-	-	-	-	-	-	0.00	0.00
C2		9.00 MT WIDE INTERNAL ROAD	1.50	-	-	-	-	-	-	-	0.00	0.00

OWNERS NAME AND SIGNATURE
 SHRI NIKHIL AGARWAL S/O SHRI JAGDEEP KUMAR AGARWAL, aludeepsur@gmail.com, 9719130303
 SHRI TUSHAR AGARWAL S/O SHRI SATJEEV KUMAR AGARWAL, aludeepsur@gmail.com, 9719130303

ARCHENG'S NAME AND SIGNATURE
 ALINA ASIF
 CA2017/83616

Moradabad Development Authority

Building Plan Application Number
 MBDALD22-230203
 Sanctioned On
 17 Jan 2023
 Valid Till
 09 Feb 2028
 Approved By
 Shailesh Kumar (Vice Chairman)
 Examined By
 SATYAVEER SINGH (Junior engineer)
 sagar gupta (Assistant Engineer/ ATP)
 Kaushendra Kumar Gautam (Town Planner)
 sagar gupta (Assistant Engineer/ ATP)
 Kaushendra Kumar Gautam (Town Planner)
 sagar gupta (Assistant Engineer/ ATP)

Note: - 1) This drawing is prepared as per the current prevailing Building Bye Laws.
 2) If Map sanctioned is used for purpose anything other than stated in application will lead to rejection of Map.

Total Plot Area: -	12576.86	Total FAR Area: -	0.00
Total Coverage Area: -	0.00	Total BUA Area: -	0.00

	ROADS
	DRAINAGE
	SEWAGE
	S.T.P.
	WATER SUPPLY
	PARK
	TUBE WELL
	1.50 MT WD FOOTPATH
	ELECTRIC POLE
	SUBSTATION / TRANSFORMER
	GARBAGE SPACE
	R.W.H.

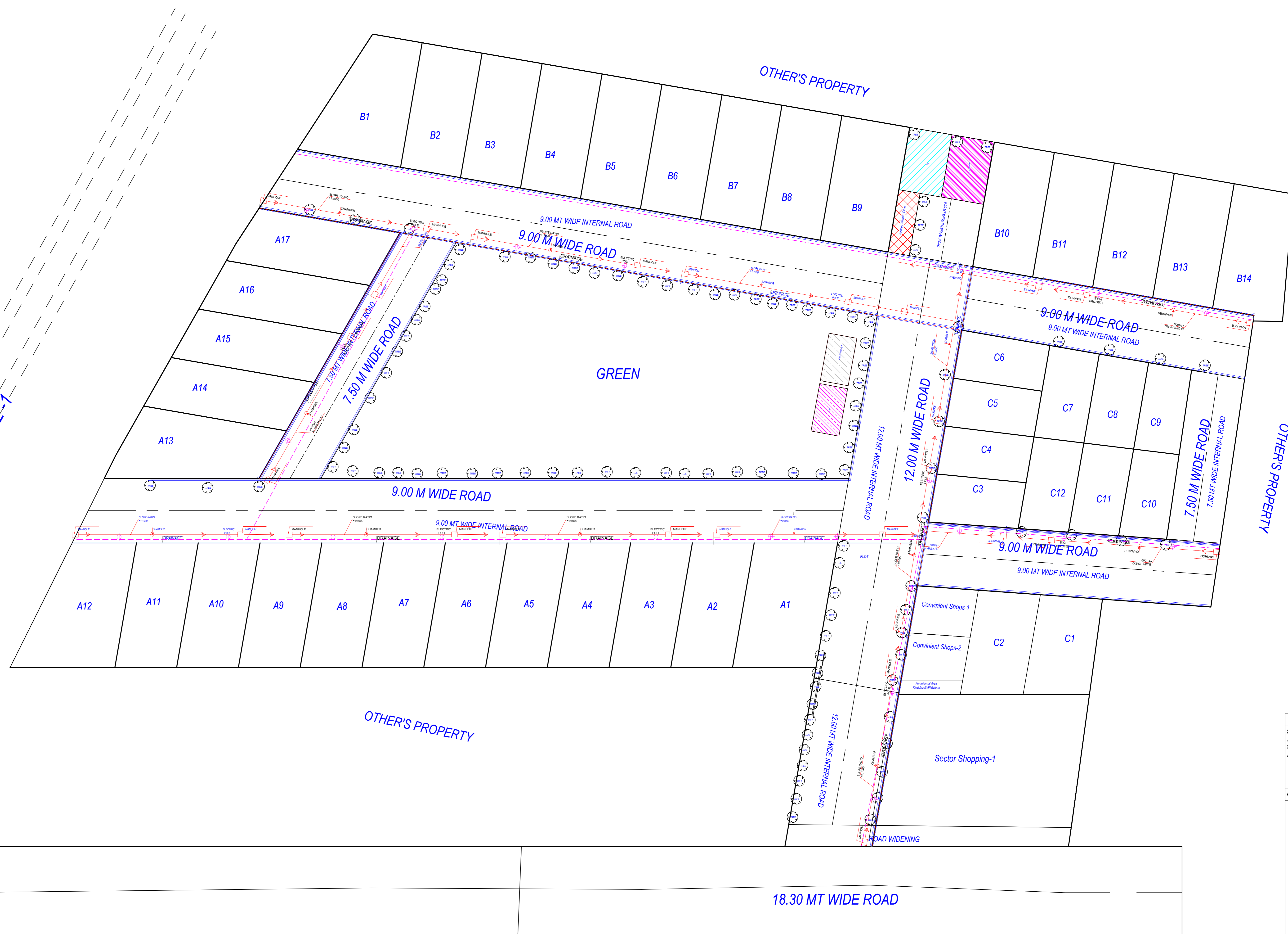

TO KAJIPURA

Service Plan

OWNER'S NAME AND SIGNATURE
 SHRI NIKHIL AGARWAL S/O SHRI JAGDEEP KUMAR AGARWAL, kuldheepsur@gmail.com, 9719130303
 SHRI TUSHAR AGARWAL S/O SHRI SATJEEV KUMAR AGARWAL, kuldheepsur@gmail.com, 9719130303

ARCHITECT'S NAME AND SIGNATURE
 ALINA ASIF
 CA2017/83616

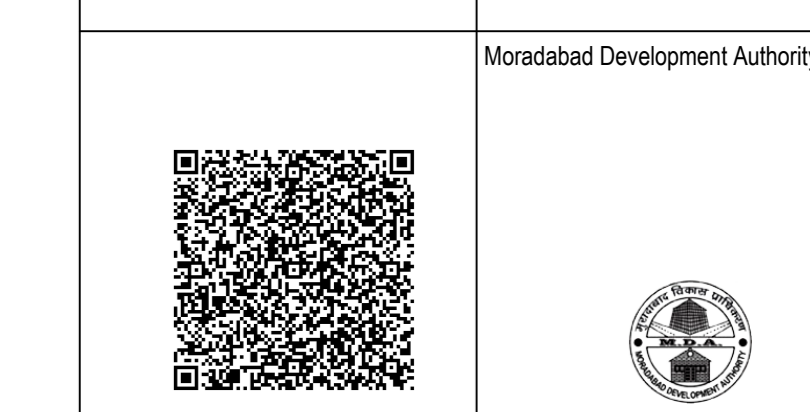

Building Plan Application Number
 MBDALD/22-23/0203

Sanctioned On
 17 Jan 2023

Valid Till
 09 Feb 2028

Approved By
 Shailesh Kumar (Vice Chairman)

Examined By
 SATYAVEER SINGH (Junior engineer)

sagar gupta (Assistant Engineer/ ATP)

Kaushendra Kumar Gautam (Town Planner)

sagar gupta (Assistant Engineer/ ATP)

Kaushendra Kumar Gautam (Town Planner)

Note: - 1) This drawing is prepared as per the current prevailing Building Bye Laws.
 2) If Map sanctioned is used for purpose anything other than stated in application will lead to rejection of Map.

Total Plot Area :-	12576.86	Total FAR Area :-	0.00
Total Coverage Area :-	0.00	Total BUA Area :-	0.00

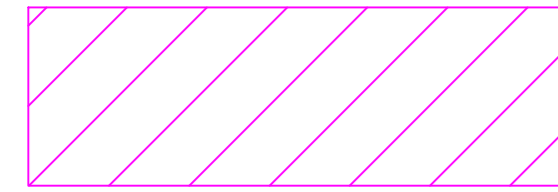

Mark 20 % area of saleable plots on layout plan to be mortgage against internal development works.

TO BE MORTGAGE PLOTS		
S.no.	Plot no.	Plot Area
1.	A11	149.92
2.	A12	205.15
3.	A13	182.57
4.	A14	148.10
5.	A15	148.33
6.	A16	148.57
7.	A17	161.11
8.	B1	190.65
Total		1334.40



TO KAJIPURA
 ← mortgage Plan

OWNER'S NAME AND SIGNATURE
 SHRI NIKHIL AGARWAL S/O SHRI JAGDEEP KUMAR AGARWAL, kuldhepur@gmail.com, 9719130303
 SHRI TUSHAR AGARWAL S/O SHRI SATJEEV KUMAR AGARWAL, kuldhepur@gmail.com, 9719130303

ARCHITECT'S NAME AND SIGNATURE
 ALINA ASIF
 CA2017/83616

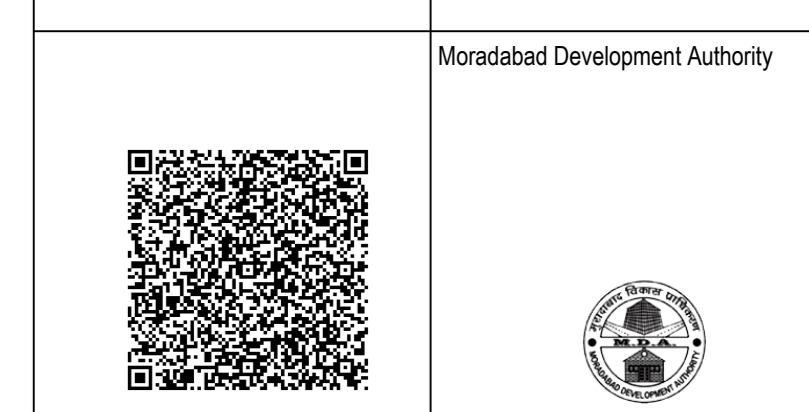

Building Plan Application Number
 MBDA/LD/22-23/0203
 Sanctioned On
 17 Jan 2023
 Valid Till
 09 Feb 2028

Approved By
 Shailesh Kumar (Vice Chairman)
 Examined By
 SATYAVEER SINGH (Junior engineer)
 sagar gupta (Assistant Engineer/ ATP)
 Kaushendra Kumar Gautam (Town Planner)
 sagar gupta (Assistant Engineer/ ATP)
 Kaushendra Kumar Gautam (Town Planner)

Note: - 1) This drawing is prepared as per the current prevailing Building Bye Laws.
 2) If Map sanctioned is used for purpose anything other than stated in application will lead to rejection of Map.

Total Plot Area: -	12576.86	Total FAR Area: -	0.00
Total Coverage Area: -	0.00	Total BUA Area: -	0.00

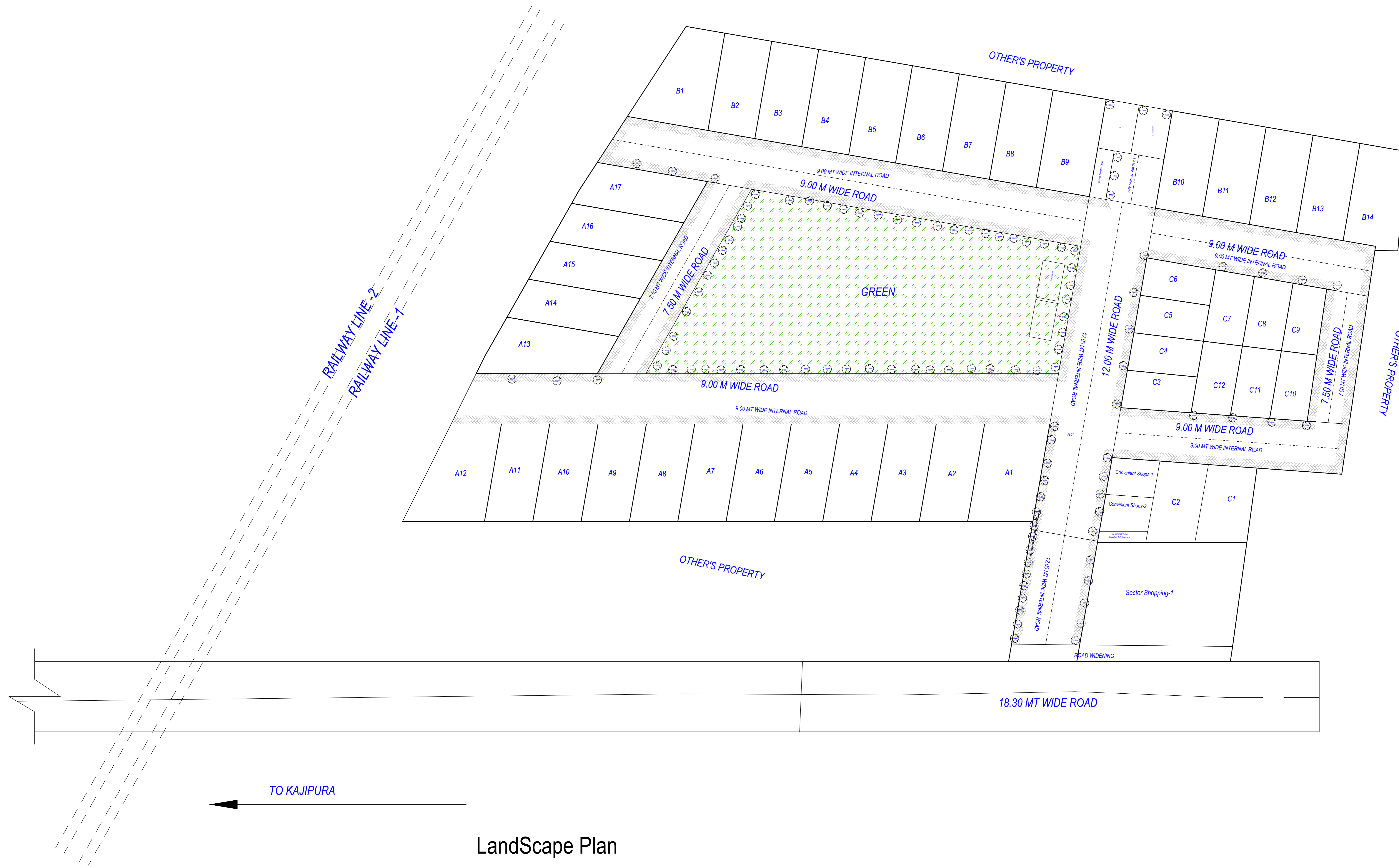

LandScape Plan

OWNER'S NAME AND SIGNATURE
 SHRI NIKHIL AGARWAL S/O SHRI JAGDEEP KUMAR AGARWAL, kuldheepsur@gmail.com, 9719130303
 SHRI TUSHAR AGARWAL S/O SHRI SATJEEV KUMAR AGARWAL, kuldheepsur@gmail.com, 9719130303

ARCHITECT'S NAME AND SIGNATURE
 ALINA ASIF
 CA2017/83616

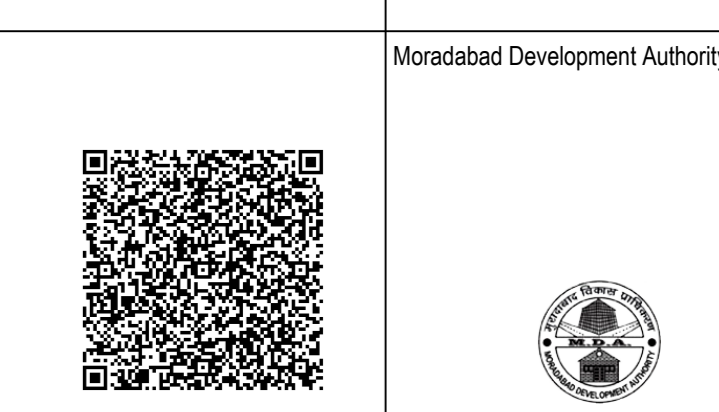

Building Plan Application Number
 MBD/ALD/22-23/0203

Sanctioned On
 17 Jan 2023

Valid Till
 09 Feb 2028

Approved By
 Shailesh Kumar (Vice Chairman)

Examined By
 SATYAVEER SINGH (Junior engineer)

sagar gupta (Assistant Engineer/ ATP)

Kaushendra Kumar Gautam (Town Planner)

sagar gupta (Assistant Engineer/ ATP)

Kaushendra Kumar Gautam (Town Planner)

sagar gupta (Assistant Engineer/ ATP)

Note: - 1) This drawing is prepared as per the current prevailing Building Bye Laws.
 2) If Map sanctioned is used for purpose anything other than stated in application will lead to rejection of Map.

Total Plot Area: -	12576.86	Total FAR Area: -	0.00
Total Coverage Area: -	0.00	Total BUA Area: -	0.00