

ARAZI NO. 416 52.85

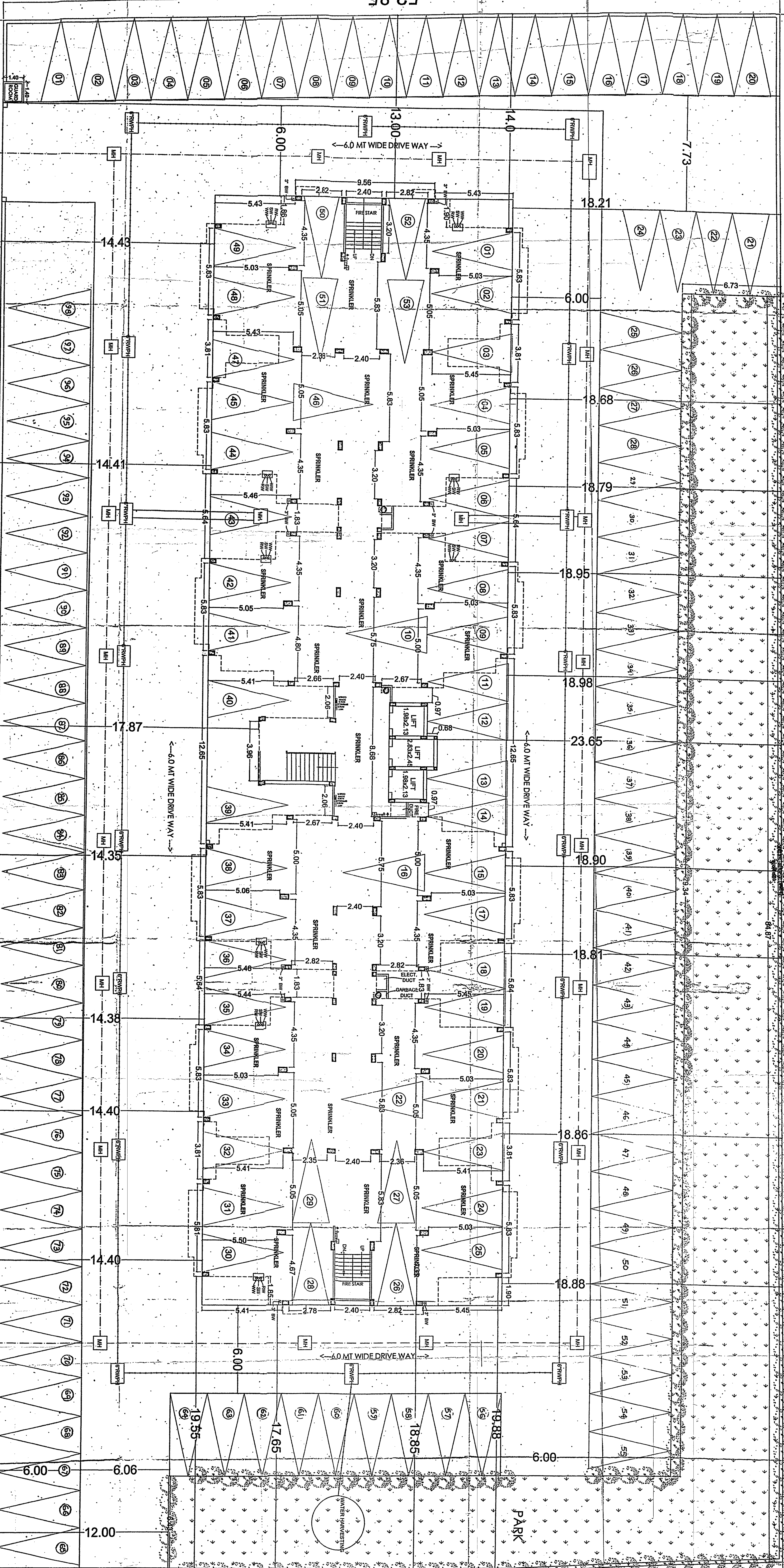

ARAZI NO. 434 103.90

Handwritten notes in Bengali and English, including dates and signatures.

**FIRE LEGEND**

NO	SYMBOL	DESCRIPTION
1	☐	FIRE EXTINGUISHER (CO2 4.5KG)
2	☐	FIRE EXTINGUISHER (CO2 8.5KG)
3	☐	MANUAL CALL POINT
4	☐	HOOPER
5	☐	FIRE HOSE CABINET
6	☐	WET RISER / SPRINKLER RISER

ARAZI NO. 422 35.30

1. THIS IS CERTIFY THAT THE PLAN IS PREPARED ACCORDING BUILDING BYE LAWS 2000 AND MASTER PLAN-2021

**AREA STATEMENT**

TOTAL PLOT AREA (AS PER DEED) = 5543.28 SQ.MTS.  
 PARK AREA (15%) = 831.49 SQ.MTS.  
 NET PLOT AREA = 4711.79 SQ.MTS.  
 HEIGHT OF BUILDING = 41.50 MTS.

F.A.R. @ 2.5 \* 0.41517 = 13954.36 SQ.MT.

**AREA NOT INCLUDED IN F.A.R.**

COVD. AREA ON STILT FLOOR (PARKING) = 1071.81 SQ.MT.  
 (NOT INCLUDING IN F.A.R.)  
 COVERED AREA ON MAINTN. MACHINE RM. = 62.86 SQ.MT.  
 COVERED AREA ON FIRE STAIR 2370/14 = 331.80 SQ.MT.

EXIST. COVD. AREA ON 1st FLOOR = 1071.81 SQ.MT.  
 EXIST. COVD. AREA ON 2nd FLOOR = 1071.81 SQ.MT.  
 EXIST. COVD. AREA ON 3rd FLOOR = 1071.81 SQ.MT.  
 EXIST. COVD. AREA ON 4th FLOOR = 1071.81 SQ.MT.  
 EXIST. COVD. AREA ON 5th FLOOR = 1071.81 SQ.MT.  
 EXIST. COVD. AREA ON 6th FLOOR = 1071.81 SQ.MT.  
 EXIST. COVD. AREA ON 7th FLOOR = 1071.81 SQ.MT.  
 EXIST. COVD. AREA ON 8th FLOOR = 1071.81 SQ.MT.  
 EXIST. COVD. AREA ON 9th FLOOR = 1071.81 SQ.MT.  
 EXIST. COVD. AREA ON 10th FLOOR = 1071.81 SQ.MT.  
 EXIST. COVD. AREA ON 11th FLOOR = 1071.81 SQ.MT.  
 EXIST. COVD. AREA ON 12th FLOOR = 1071.81 SQ.MT.  
 EXIST. COVD. AREA ON 13th FLOOR = 1071.81 SQ.MT.  
 EXIST. COVD. AREA ON 14th FLOOR = 1071.81 SQ.MT.  
 EXIST. COVD. AREA ON 15th FLOOR = 1071.81 SQ.MT.  
 EXIST. COVD. AREA ON 16th FLOOR = 1071.81 SQ.MT.  
 EXIST. COVD. AREA ON 17th FLOOR = 1071.81 SQ.MT.  
 EXIST. COVD. AREA ON 18th FLOOR = 1071.81 SQ.MT.  
 EXIST. COVD. AREA ON 19th FLOOR = 1071.81 SQ.MT.  
 EXIST. COVD. AREA ON 20th FLOOR = 1071.81 SQ.MT.

**TOTAL COVERED AREA** = 13954.36 SQ.MT.

**TOTAL OPEN AREA** = 833.65 (15.08%) SQ.MT.

**TOTAL UNIT** = 123 Nos.

**4 BHK UNIT Nos.** = 25 Nos.

**4 BHK UNIT AREA** = 131.12 SQ.MT.

**2 BHK UNIT AREA** = 82 Nos.

**2 BHK UNIT AREA** = 73.30 SQ.MT.

**TOTAL LT FLOOR AREA** = 1071.81 \* 2 (101.19 Ft.) = 2143.62 \* 4.5 = 92.55 NOS. = 33 Nos.

**COVERED PARKING** = 88 NOS.

**SPRINKLER PARKING** = 88 NOS.

**SPRINKLER PARKING AREA** = 131.12 SQ.MT.

**COVERED PARKING AREA** = 131.12 SQ.MT.

**SPRINKLER PARKING AREA** = 131.12 SQ.MT.

**TOTAL PARKING AREA** = 262.24 SQ.MT.

**CONTRACTOR:** S/O LATIF MOHAMMAD RAJAO ADARNAVA, K/O 3/10, VANDI PIRI KANPUR WAGAR, S/O 28/10, KANPUR WAGAR, KANPUR, U.P.

**EXISTING PROPOSED GROUP HOUSING AT ARAZI NO.416 (PART) SONBHUDI MOCHHAR, PARGANA - TEHSIL, KANPUR SADAK KANPUR VIJAYAR.**

**OWNER'S SIGN:** Subodhan Infrastructure Ltd. (Signature)

**ARCHITECT'S SIGN:** (Signature)

**SCALE:** ALL DIMENSIONS ARE IN METERS. SCALE: 1 : 100