

TOWARDS LUCKNOW

EXIST. ROAD WIDTH = 16.00 M.  
OPEN SPACE FOR ENT.  
T.B.M. AT THE CENTER OF ROAD = 100.000

TOWARDS FAIZABAD BYPASS

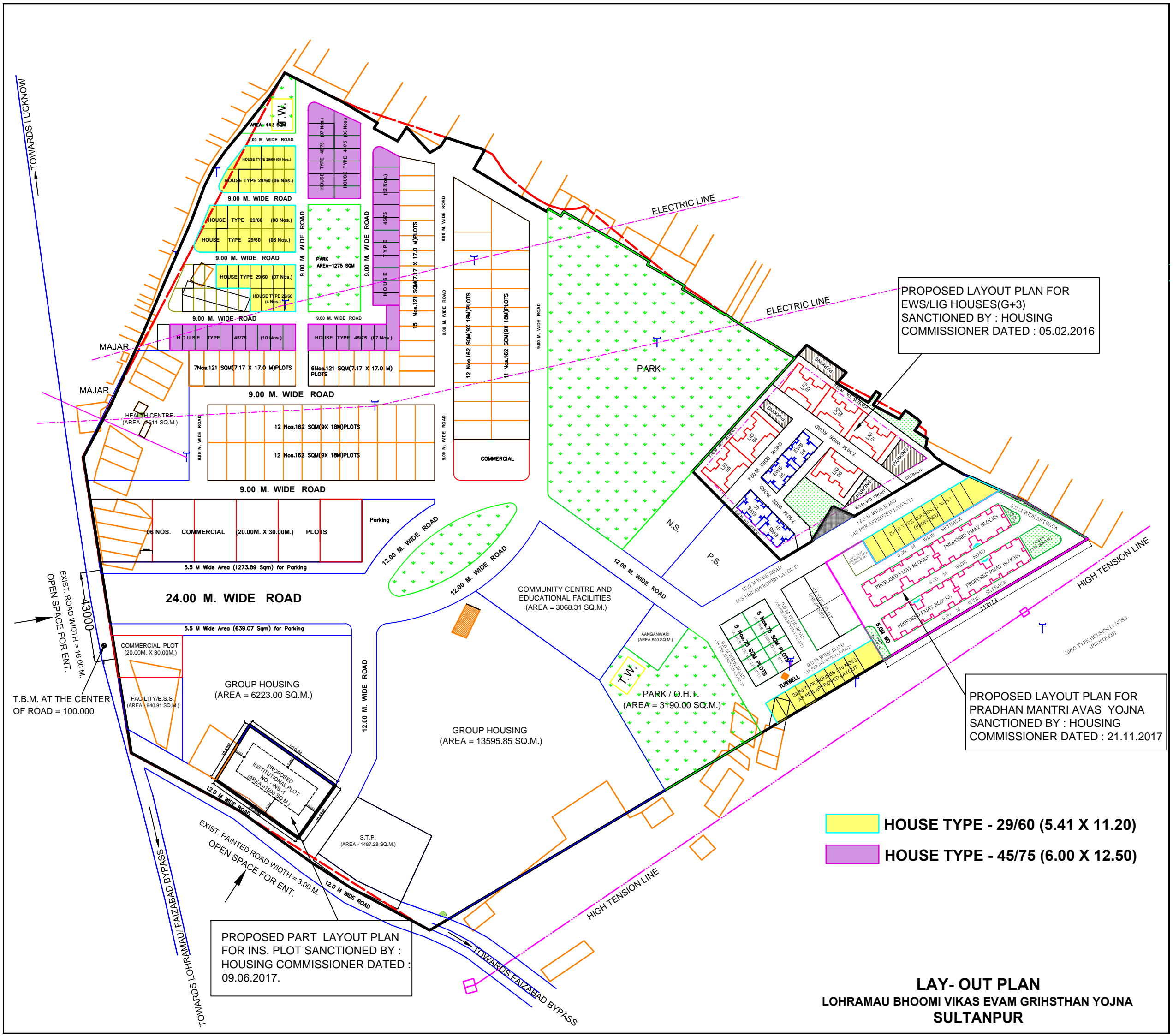

PROPOSED LAYOUT PLAN FOR  
EWS/LIG HOUSES(G+3)  
SANCTIONED BY : HOUSING  
COMMISSIONER DATED : 05.02.2016

PROPOSED LAYOUT PLAN FOR  
PRADHAN MANTRI AVAS YOJNA  
SANCTIONED BY : HOUSING  
COMMISSIONER DATED : 21.11.2017

PROPOSED PART LAYOUT PLAN  
FOR INS. PLOT SANCTIONED BY :  
HOUSING COMMISSIONER DATED :  
09.06.2017.

- HOUSE TYPE - 29/60 (5.41 X 11.20)
- HOUSE TYPE - 45/75 (6.00 X 12.50)

**LAY- OUT PLAN**  
**LOHRAMAU BHOOMI VIKAS EVAM GRIHSTHAN YOJNA**  
**SULTANPUR**