

AREA STATEMENT		VERSION NO.	VERSION DATE	
PROJECT DETAIL :		1.0/04	05/04/2024	
Authority:	Ayodhya Faizabad Development Authority	Plot Use:	Residential	
Authority Class:	Category D	Plot Sub-Use:	Plotted Res. development / Plotted Housing	
Authority/Grade:	Development Authority (DA)	Development Plan:	Master Plan	
Case/Track:	Regular	Land Use Zone:	Residential Use Zone	
Project Type:	Layout Development	Land Sub-Use Zone:	Residential Zone	
Nature of Development:	NEW	Layout Type:	NA	
Development Area:	Undeveloped Area			
Sub-Development Area:	Village Area			
Special Project:	NA			
Site Address:	District Ayodhya, Tehsil Sadar, Village Sarethi			
AREA DETAILS :	Sq.Mts.			
1. Area of Plot As per record				
Document Area	12512.87			
As per site condition	12511.45			
Area of Plot Considered	12468.45			
2. Deduction for				
(a) Proposed roads	43.01			
Road Widening Area	9.00			
(b) Key reservations	0.00			
Total (a + b)	43.01			
3. Net Area of plot (1 - 2) AREA OF PLOT	12468.45			
Road Widening Area	43.01			
Green and open space	1874.27			
Plot Area For Coverage	12468.45			
Plot Area For FAR	12468.45			
Perm. FAR Area (1.25)	15585.56			
Total Perm. FAR area (1.25)	15585.56			
Total Built up area permissible at:				
Permissible Coverage area (45.00 %)	5619.80			
Proposed Coverage Area (%)	0.00			
Total Prop. Coverage Area (%)	0.00			
Balance coverage area (45.00 %)	5619.80			
Proposed Area at:				
Total Area	Proposed Built up	Existing Built up	Proposed FAR	Existing FAR
	0.00	0.00	0.00	0.00
Total FAR Area:				
Total Built up Area:				
Proposed FAR consumed:				
4. Tenement Statement				
C. Tenement Proposed At:				

Color Notes

COLOR INDEX	
PLOT BOUNDARY	Black
ABUTTING ROAD	Red
PROPOSED CONSTRUCTION	Green
COMMON PLOT	Yellow
ROAD ALIGNMENT (ROAD WIDENING AREA)	Blue
FUTURE T.P. SCHEME DEDUCTION AREA	Orange
EXISTING (To be retained)	Light Blue
EXISTING (To be demolished)	Light Yellow

Number of EWS/LIG unit required

Sl. No.	Plot Type	Nos. of Plot	No. of unit in one plot	Total Number of units	Proposed LIG/ EWS Unit
1.	Single Dwelling Unit	51	1	51	-
Total:		51		51	
Number of EWS/LIG unit required (10% LIG)				6.00	0
Number of EWS/LIG unit required (10% EWS)				6.00	0
Total:		51		63	

Tenements Density Check

Net housing density	No. of Tenements		No. of Persons	
	Reqd.	Prop.	Reqd.	Prop.
750/Hec.	188	130	936	650

Green and open space Area

Name	Prop. Area
GREEN & OPENSAPCE	1874.27

Land use analysis/Area distribution (Table 2c)

Area covered under	Proposed Area in sq. mt.	Percentage(%)
Plotted Area	6315.51	50.65
Road Area	4069.61	32.64
Garbage Collection Center	15.00	0.12
Garbage Collection Center	15.01	0.12
For informal Area Kiosk/booth/Platform	25.10	0.20
Sector Shopping	99.14	0.80
Commitment Shops	49.89	0.40
Public Open Space	1874.27	15.03
Other Area	4.92	0.04
Total net layout	12468.45	100.00

Individual Amenity Check b)

Name	Reqd.	Minimum Area	Prop.	Minimum Count	Reqd.	Prop.
Commitment Shops	20.00	49.89	-	1.00	-	1.00
Sector Shopping	75.00	99.14	-	1.00	-	1.00
For informal Area Kiosk/booth/Platform	7.50	25.10	-	1.00	-	1.00
Garbage Collection Center	15.00	30.01	1.00	2.00	1.00	2.00

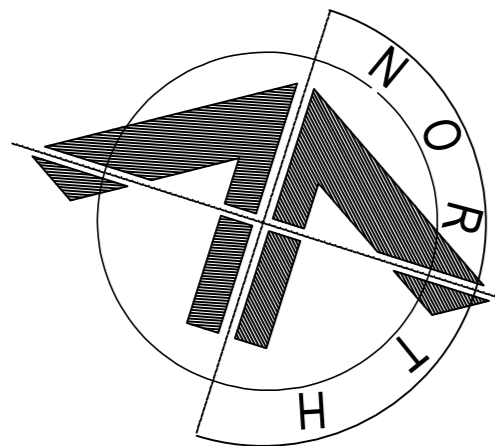
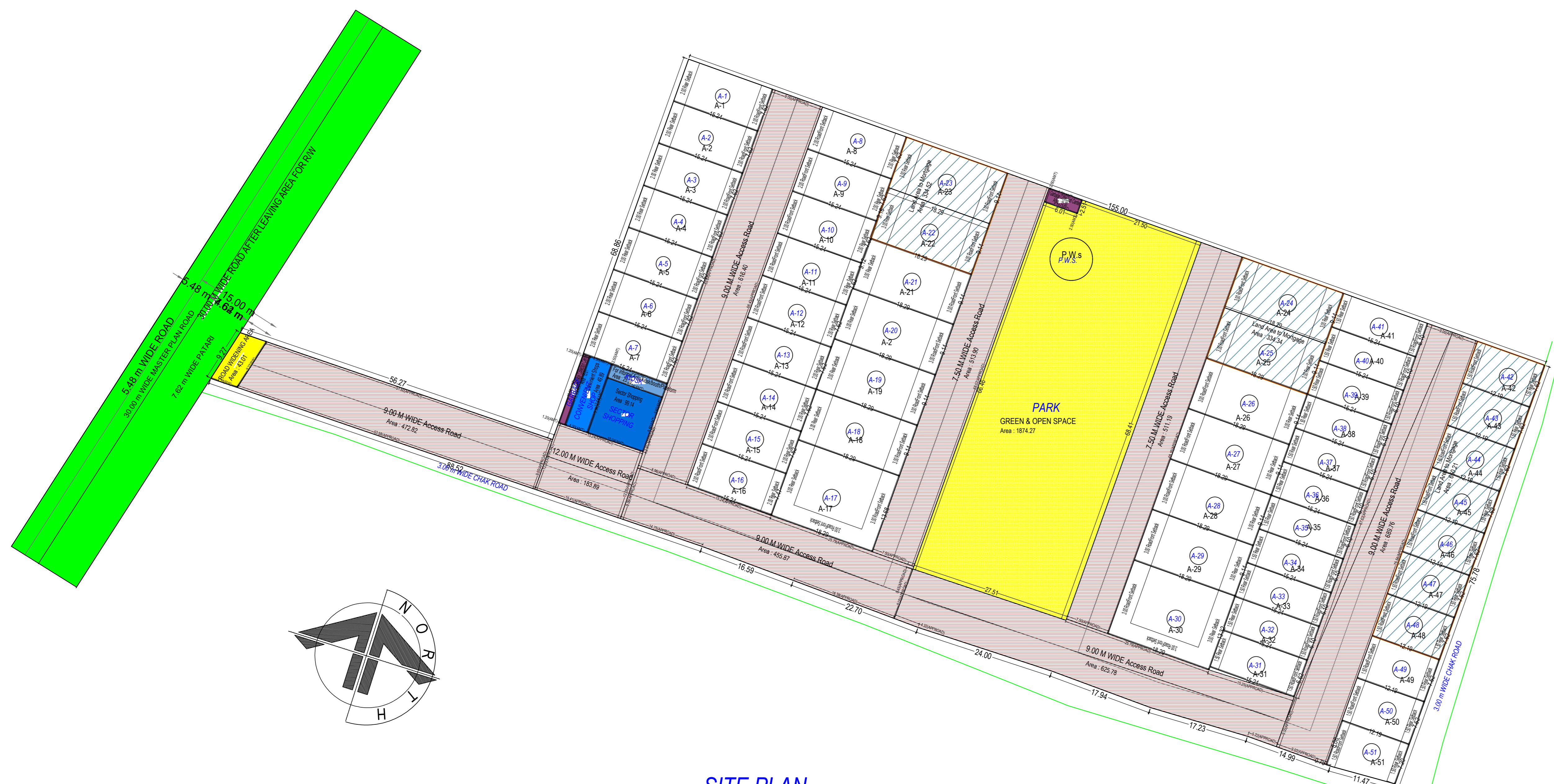

MORTGAGE PLOTS FOR INTERNAL DEVELOPMENT

SITE PLAN

PLOT AREA CHART :-

PLOT NO.	AREA
1072	406.36
1073	2776.51
1074	4410.00
1075	4920.00
557 TA	12512.87

MORTGAGE AREA :-

PLOT NO.	AREA
A-22	167.17
A-23	167.17
A-24	167.17
A-25	167.17
A-42	92.89
A-43	92.89
A-44	92.89
A-45	92.89
A-46	92.89
A-47	92.89
A-48	92.89
TOTAL	1318.91

LAYOUT PLAN (Scale - 1:400)

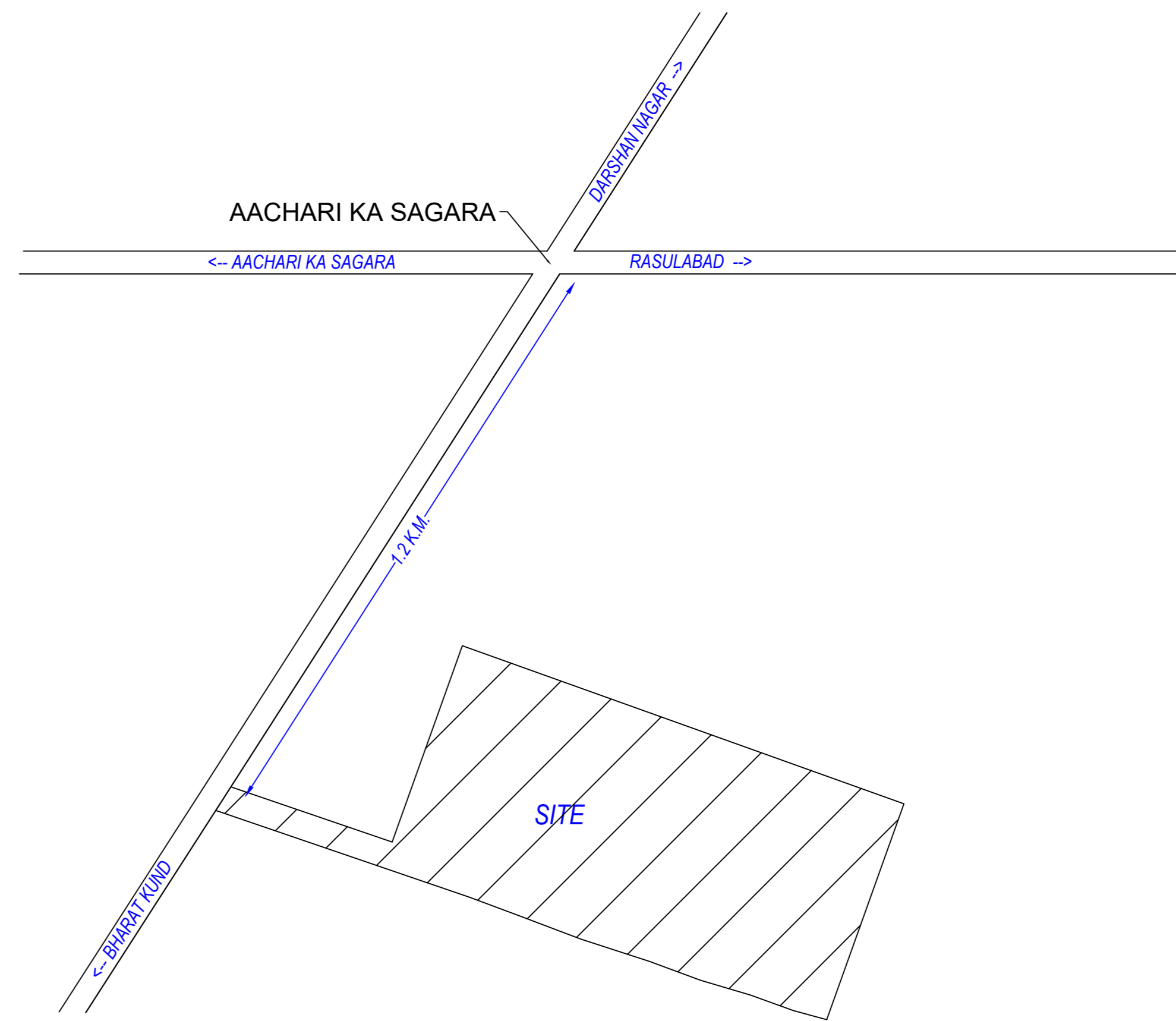

KEY PLAN

Proposed Population Calculation

Plot Name	Use	Sub-Use	Range	Nos.	Perm. Unit/Plot	Perm. Person/Unit	Total Person/Plot	Total
A-1	Residential	Row House		2	2		2	2
A-2	Residential	Row House		2	2		2	2
A-3	Residential	Row House		2	2		2	2
A-4	Residential	Row House		2	2		2	2
A-5	Residential	Row House		2	2		2	2
A-6	Residential	Row House		2	2		2	2
A-7	Residential	Row House		2	2		2	2
A-8	Residential	Row House		2	2		2	2
A-9	Residential	Row House		2	2		2	2
A-10	Residential	Row House		2	2		2	2
A-11	Residential	Row House		2	2		2	2
A-12	Residential	Row House		2	2		2	2
A-13	Residential	Row House		2	2		2	2
A-14	Residential	Row House		2	2		2	2
A-15	Residential	Row House		2	2		2	2
A-16	Residential	Row House		2	2		2	2
A-17	Residential	Row House		2	2		2	2
A-18	Residential	Row House		2	2		2	2
A-19	Residential	Row House		2	2		2	2
A-20	Residential	Row House		2	2		2	2
A-21	Residential	Row House		2	2		2	2
A-22	Residential	Row House		2	2		2	2
A-23	Residential	Row House		2	2		2	2
A-24	Residential	Row House		2	2		2	2
A-25	Residential	Row House		2	2		2	2
A-26	Residential	Row House		2	2		2	2
A-27	Residential	Row House		2	2		2	2
A-28	Residential	Row House		2	2		2	2
A-29	Residential	Row House		2	2		2	2
A-30	Residential	Row House		2	2		2	2
A-31	Residential	Row House		2	2		2	2
A-32	Residential	Row House		2	2		2	2
A-33	Residential	Row House		2	2		2	2
A-34	Residential	Row House		2	2		2	2
A-35	Residential	Row House		2	2		2	2
A-36	Residential	Row House		2	2		2	2
A-37	Residential	Row House		2	2		2	2
A-38	Residential	Row House		2	2		2	2
A-39	Residential	Row House		2	2		2	2
A-40	Residential	Row House		2	2		2	2
A-41	Residential	Row House		2	2		2	2
A-42	Residential	Row House		2	2		2	2
A-43	Residential	Row House		2	2		2	2
A-44	Residential	Row House		2	2		2	2
A-45	Residential	Row House		2	2		2	2
A-46	Residential	Row House		2	2		2	2
A-47	Residential	Row House		2	2		2	2
A-48	Residential	Row House		2	2		2	2
A-49	Residential	Row House		2	2		2	2
A-50	Residential	Row House		2	2		2	2
A-51	Residential	Row House		2	2		2	2
A-52	Residential	Row House		2	2		2	2
A-53	Residential	Row House		2	2		2	2
A-54	Residential	Row House		2	2		2	2
A-55	Residential	Row House		2	2		2	2
A-56	Residential	Row House		2	2		2	2
A-57	Residential	Row House		2	2		2	2
A-58	Residential	Row House		2	2		2	2
A-59	Residential	Row House		2	2		2	2
A-60	Residential	Row House		2	2		2	2
A-61	Residential	Row House		2	2		2	2
A-62	Residential	Row House		2	2		2	2
A-63	Residential	Row House		2	2		2	2
A-64	Residential	Row House		2	2		2	2
A-65	Residential	Row House		2	2		2	2
A-66	Residential	Row House		2	2		2	2
A-67	Residential	Row House		2	2		2	2
A-68	Residential	Row House		2	2		2	2
A-69	Residential	Row House		2	2		2	2
A-70	Residential	Row House		2	2		2	2
A-71	Residential	Row House		2	2		2	2
A-72	Residential	Row House		2	2		2	2
A-73	Residential	Row House		2	2		2	2
A-74	Residential	Row House		2	2		2	2
A-75	Residential	Row House		2	2		2	2
A-76	Residential	Row House		2	2		2	2
A-77	Residential	Row House		2	2		2	2
A-78	Residential	Row House		2	2		2	2
A-79	Residential	Row House		2	2		2	2
A-80	Residential	Row House		2	2		2	2
A-81	Residential	Row House		2	2		2	2
A-82	Residential	Row House		2	2		2	2
A-83	Residential	Row House		2	2		2	2
A-84	Residential	Row House		2	2		2	2
A-85	Residential	Row House		2	2		2	2
A-86	Residential	Row House		2	2		2	2
A-87	Residential	Row House		2	2		2	2
A-88	Residential	Row House		2	2		2	2
A-89	Residential	Row House		2	2		2	2
A-90	Residential	Row House		2	2		2	2
A-91	Residential	Row House		2	2		2	2
A-92	Residential	Row House		2	2		2	2
A-93	Residential	Row House		2	2		2	2
A-94	Residential	Row House		2	2		2	2
A-95	Residential	Row House		2	2		2	2
A-96	Residential	Row House		2	2		2	2
A-97	Residential	Row House		2	2		2	2
A-98	Residential	Row House		2	2		2	2
A-99	Residential	Row House		2	2		2	2
A-100	Residential	Row House		2	2		2	2
Grand Total:								650

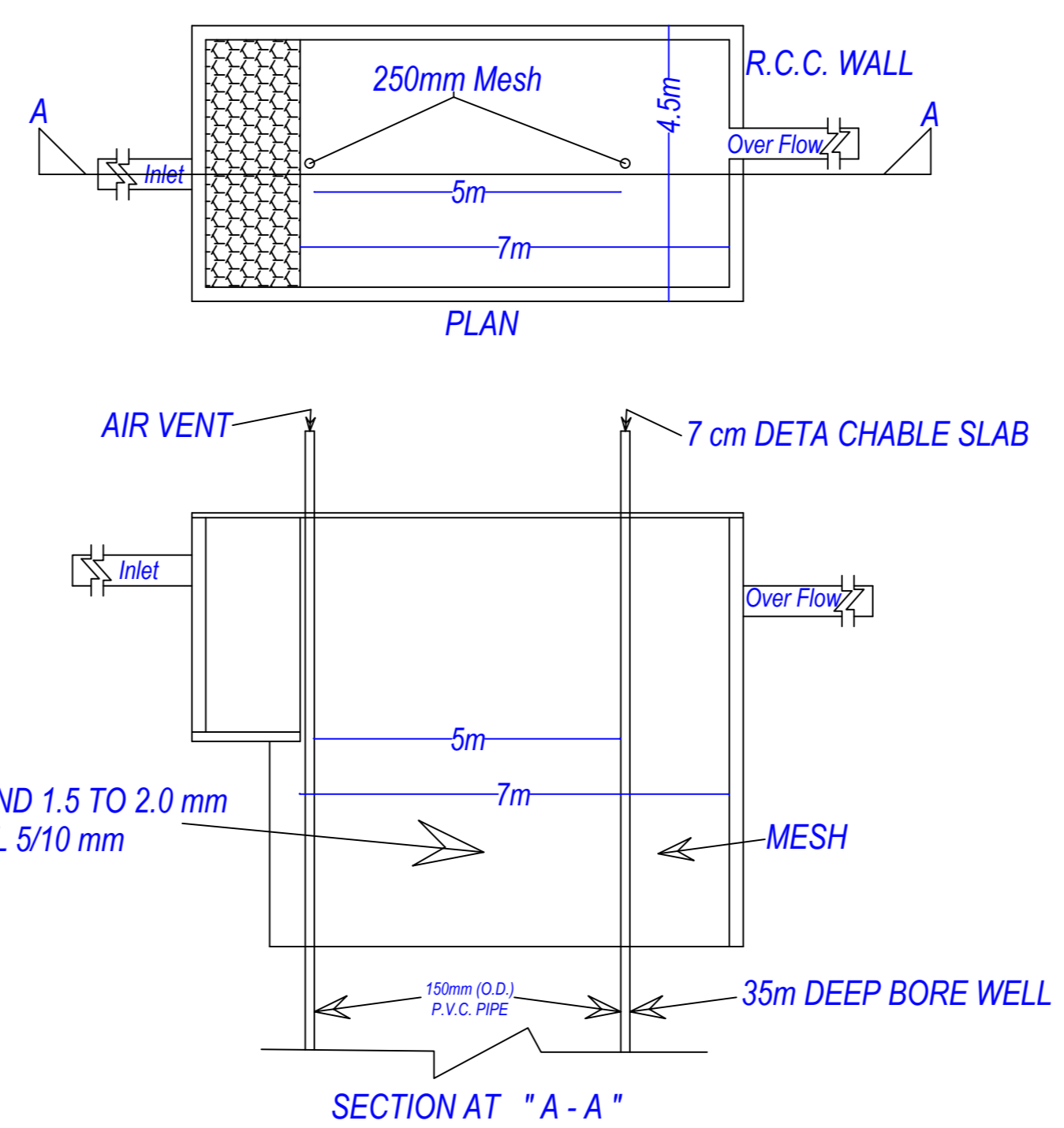

PERCOLATION WELL DETAIL (NOT TO SCALE)

Note: - 1) This drawing is prepared as per the current prevailing Building Bye Laws.
 2) If Map sanctioned is used for purpose anything other than stated in application will lead to rejection of Map.

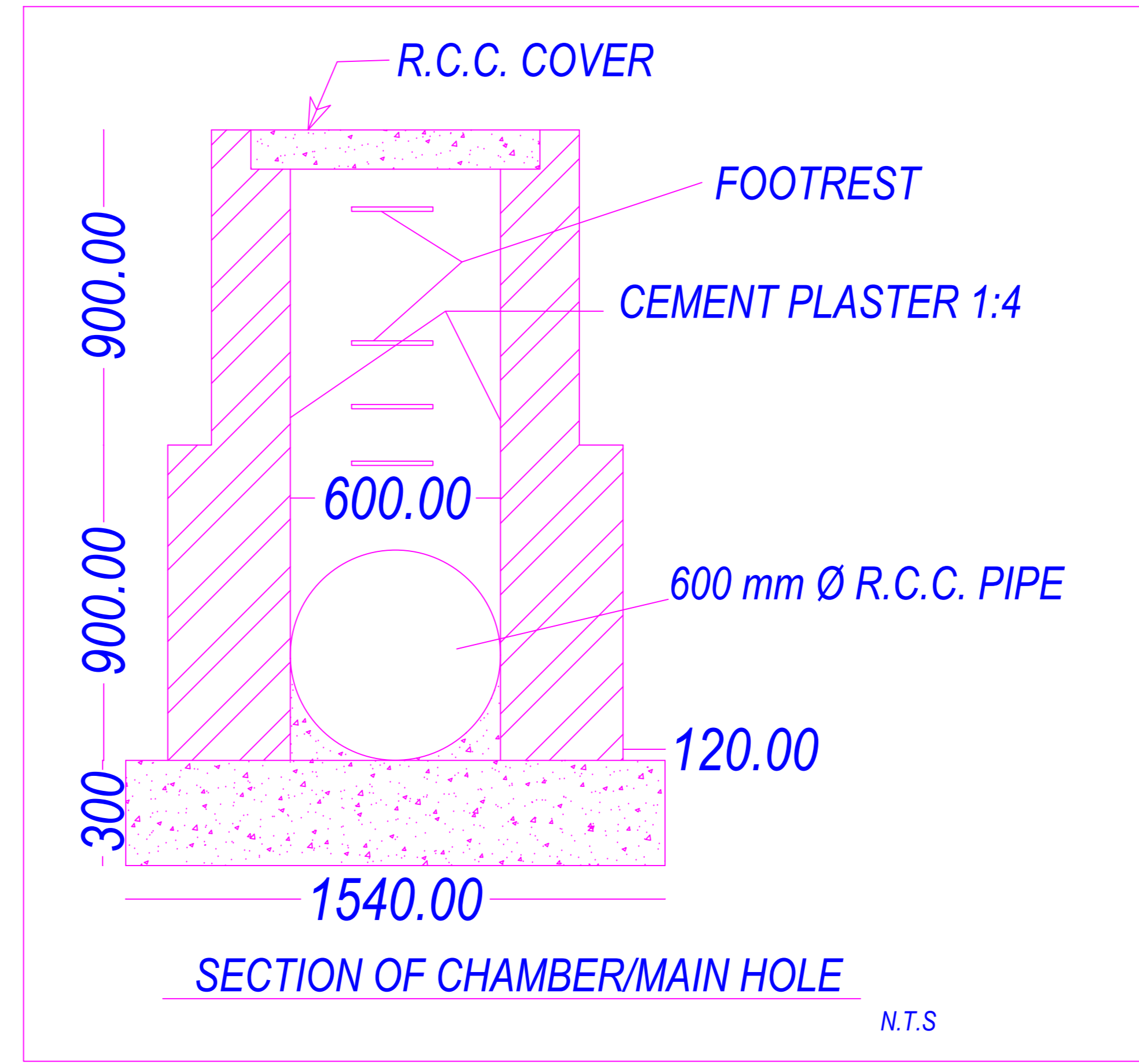
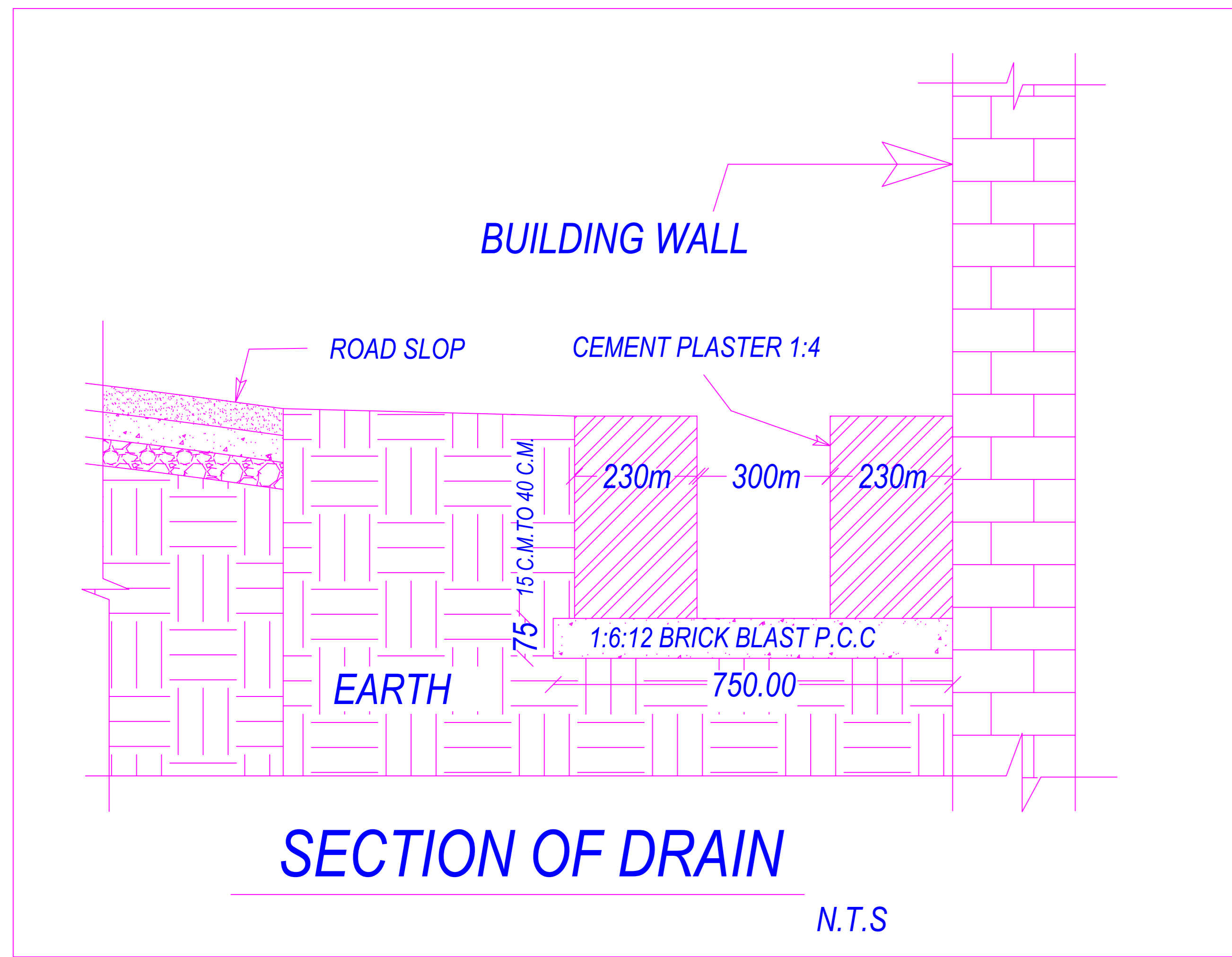

9.0M WIDE ROAD SECTION
SCALE :-1:75

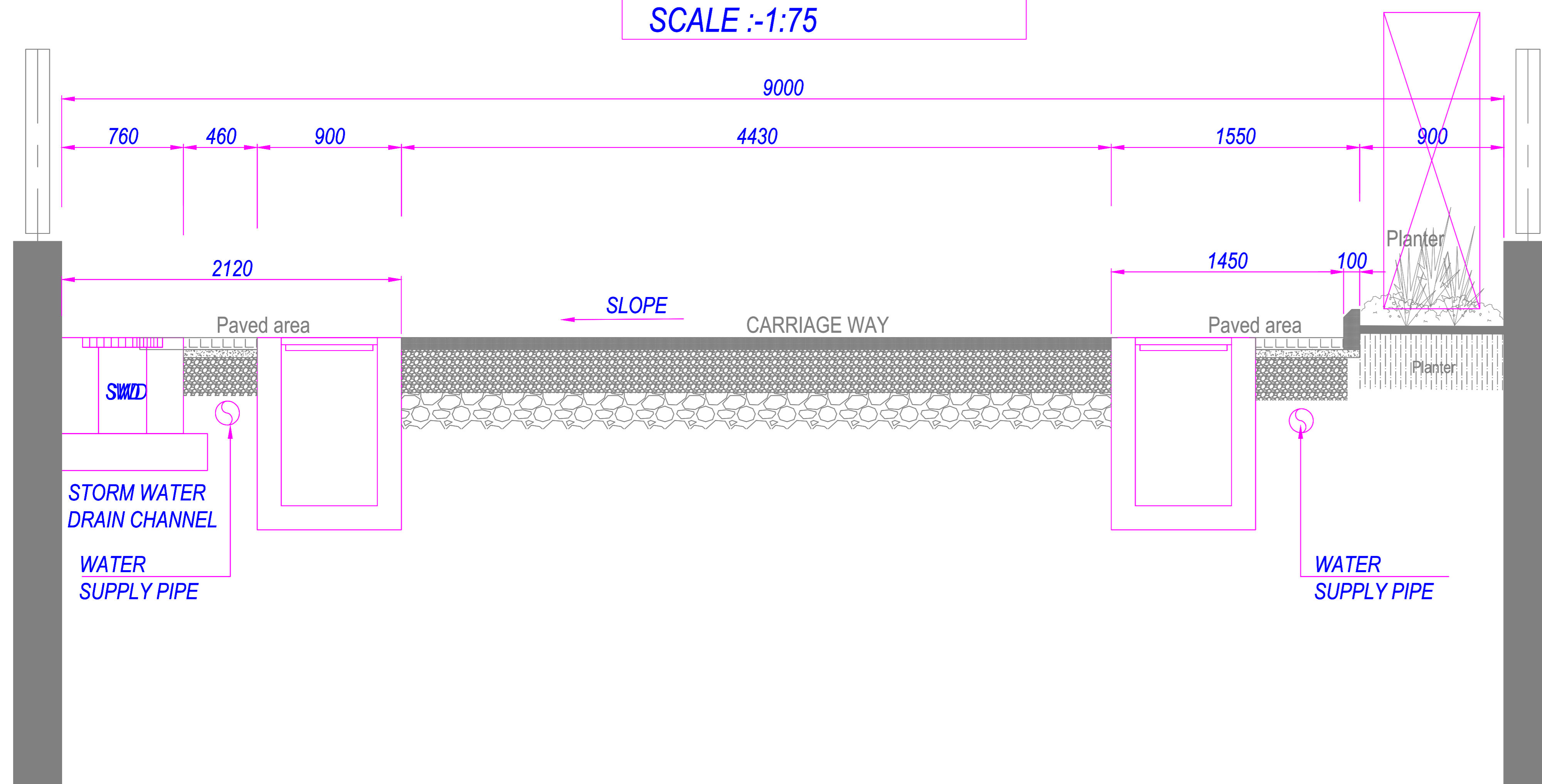

9M WIDE ROAD SECTION

SECTION OF ROAD

N.T.S

Individual Plot Area										Individual Plot Setback													
Plot No.	Abutting Road	Plot Area	Frontage	Coverage	FAR Area	Plot No.	Front	Side1	Side2	Rear	Coverage	FAR Area	Plot No.	Front	Side1	Side2	Rear	Coverage	FAR Area				
	Prop	Prop	Prop	Factor	Prop		Prop	Prop	Prop	Prop	Prop	Prop		Prop	Prop	Prop	Prop	Prop	Prop				
A-1	9.00 M WIDE Access Road	40.00	-	116.13	3.50	7.62	0.00	0.00	0.00	-	0.00	-	A-1	9.00 M WIDE Access Road	2.00	-	-	-	-	2.00	-	0.00	0.00
A-2	9.00 M WIDE Access Road	40.00	-	116.13	3.50	7.62	0.00	0.00	0.00	-	0.00	-	A-2	9.00 M WIDE Access Road	2.00	-	-	-	-	2.00	-	0.00	0.00
A-3	9.00 M WIDE Access Road	40.00	-	116.13	3.50	7.62	0.00	0.00	0.00	-	0.00	-	A-3	9.00 M WIDE Access Road	2.00	-	-	-	-	2.00	-	0.00	0.00
A-4	9.00 M WIDE Access Road	40.00	-	116.13	3.50	7.62	0.00	0.00	0.00	-	0.00	-	A-4	9.00 M WIDE Access Road	2.00	-	-	-	-	2.00	-	0.00	0.00
A-5	9.00 M WIDE Access Road	40.00	-	116.13	3.50	7.62	0.00	0.00	0.00	-	0.00	-	A-5	9.00 M WIDE Access Road	2.00	-	-	-	-	2.00	-	0.00	0.00
A-6	9.00 M WIDE Access Road	40.00	-	116.13	3.50	7.62	0.00	0.00	0.00	-	0.00	-	A-6	9.00 M WIDE Access Road	2.00	-	-	-	-	2.00	-	0.00	0.00
A-7	9.00 M WIDE Access Road	40.00	-	116.13	3.50	7.62	0.00	0.00	0.00	-	0.00	-	A-7	9.00 M WIDE Access Road	2.00	-	-	-	-	2.00	-	0.00	0.00
A-8	9.00 M WIDE Access Road	40.00	-	116.13	3.50	7.62	0.00	0.00	0.00	-	0.00	-	A-8	9.00 M WIDE Access Road	2.00	-	-	-	-	2.00	-	0.00	0.00
A-9	9.00 M WIDE Access Road	40.00	-	116.13	3.50	7.62	0.00	0.00	0.00	-	0.00	-	A-9	9.00 M WIDE Access Road	2.00	-	-	-	-	2.00	-	0.00	0.00
A-10	9.00 M WIDE Access Road	40.00	-	116.13	3.50	7.62	0.00	0.00	0.00	-	0.00	-	A-10	9.00 M WIDE Access Road	2.00	-	-	-	-	2.00	-	0.00	0.00
A-11	9.00 M WIDE Access Road	40.00	-	116.13	3.50	7.62	0.00	0.00	0.00	-	0.00	-	A-11	9.00 M WIDE Access Road	2.00	-	-	-	-	2.00	-	0.00	0.00
A-12	9.00 M WIDE Access Road	40.00	-	116.13	3.50	7.62	0.00	0.00	0.00	-	0.00	-	A-12	9.00 M WIDE Access Road	2.00	-	-	-	-	2.00	-	0.00	0.00
A-13	9.00 M WIDE Access Road	40.00	-	116.13	3.50	7.62	0.00	0.00	0.00	-	0.00	-	A-13	9.00 M WIDE Access Road	2.00	-	-	-	-	2.00	-	0.00	0.00
A-14	9.00 M WIDE Access Road	40.00	-	116.13	3.50	7.62	0.00	0.00	0.00	-	0.00	-	A-14	9.00 M WIDE Access Road	2.00	-	-	-	-	2.00	-	0.00	0.00
A-15	9.00 M WIDE Access Road	40.00	-	116.13	3.50	7.62	0.00	0.00	0.00	-	0.00	-	A-15	9.00 M WIDE Access Road	2.00	-	-	-	-	2.00	-	0.00	0.00
A-16	9.00 M WIDE Access Road	40.00	-	113.89	3.50	7.47	0.00	0.00	0.00	-	0.00	-	A-16	9.00 M WIDE Access Road	2.00	-	-	-	-	2.00	-	0.00	0.00
A-17	9.00 M WIDE Access Road	40.00	-	200.21	3.50	31.97	0.00	0.00	0.00	-	0.00	-	A-17	7.50 M WIDE Access Road	3.00	-	-	-	-	3.00	-	0.00	0.00
A-18	9.00 M WIDE Access Road	40.00	-	187.17	3.50	9.14	0.00	0.00	0.00	-	0.00	-	A-18	7.50 M WIDE Access Road	3.00	-	-	-	-	3.00	-	0.00	0.00
A-19	7.50 M WIDE Access Road	40.00	-	187.17	3.50	9.14	0.00	0.00	0.00	-	0.00	-	A-19	7.50 M WIDE Access Road	3.00	-	-	-	-	3.00	-	0.00	0.00
A-2	7.50 M WIDE Access Road	40.00	-	187.17	3.50	9.14	0.00	0.00	0.00	-	0.00	-	A-2	7.50 M WIDE Access Road	3.00	-	-	-	-	3.00	-	0.00	0.00
A-21	7.50 M WIDE Access Road	40.00	-	186.99	3.50	9.14	0.00	0.00	0.00	-	0.00	-	A-21	7.50 M WIDE Access Road	3.00	-	-	-	-	3.00	-	0.00	0.00
A-22	7.50 M WIDE Access Road	40.00	-	187.35	3.50	9.14	0.00	0.00	0.00	-	0.00	-	A-22	7.50 M WIDE Access Road	3.00	-	-	-	-	3.00	-	0.00	0.00
A-23	7.50 M WIDE Access Road	40.00	-	187.17	3.50	9.14	0.00	0.00	0.00	-	0.00	-	A-23	7.50 M WIDE Access Road	3.00	-	-	-	-	3.00	-	0.00	0.00
A-24	7.50 M WIDE Access Road	40.00	-	187.17	3.50	9.14	0.00	0.00	0.00	-	0.00	-	A-24	7.50 M WIDE Access Road	3.00	-	-	-	-	3.00	-	0.00	0.00
A-25	7.50 M WIDE Access Road	40.00	-	187.17	3.50	9.14	0.00	0.00	0.00	-	0.00	-	A-25	7.50 M WIDE Access Road	3.00	-	-	-	-	3.00	-	0.00	0.00
A-26	7.50 M WIDE Access Road	40.00	-	187.17	3.50	9.14	0.00	0.00	0.00	-	0.00	-	A-26	7.50 M WIDE Access Road	3.00	-	-	-	-	3.00	-	0.00	0.00
A-27	7.50 M WIDE Access Road	40.00	-	187.17	3.50	9.14	0.00	0.00	0.00	-	0.00	-	A-27	7.50 M WIDE Access Road	3.00	-	-	-	-	3.00	-	0.00	0.00
A-28	7.50 M WIDE Access Road	40.00	-	187.17	3.50	9.14	0.00	0.00	0.00	-	0.00	-	A-28	7.50 M WIDE Access Road	3.00	-	-	-	-	3.00	-	0.00	0.00
A-29	7.50 M WIDE Access Road	40.00	-	187.17	3.50	9.14	0.00	0.00	0.00	-	0.00	-	A-29	7.50 M WIDE Access Road	3.00	-	-	-	-	3.00	-	0.00	0.00
A-30	9.00 M WIDE Access Road	40.00	-	243.99	3.50	31.61	0.00	0.00	0.00	-	0.00	-	A-30	9.00 M WIDE Access Road	3.00	-	-	-	-	3.00	-	0.00	0.00
A-41	9.00 M WIDE Access Road	40.00	-	92.96	3.50	6.10	0.00	0.00	0.00	-	0.00	-	A-41	9.00 M WIDE Access Road	1.50	-	-	-	-	1.50	-	0.00	0.00
A-40	9.00 M WIDE Access Road	40.00	-	92.96	3.50	6.10	0.00	0.00	0.00	-	0.00	-	A-40	9.00 M WIDE Access Road	1.50	-	-	-	-	1.50	-	0.00	0.00
A-39	9.00 M WIDE Access Road	40.00	-	92.96	3.50	6.10	0.00	0.00	0.00	-	0.00	-	A-39	9.00 M WIDE Access Road	1.50	-	-	-	-	1.50	-	0.00	0.00
A-37	9.00 M WIDE Access Road	40.00	-	92.96	3.50	6.10	0.00	0.00	0.00	-	0.00	-	A-37	9.00 M WIDE Access Road	1.50	-	-	-	-	1.50	-	0.00	0.00
A-36	9.00 M WIDE Access Road	40.00	-	92.96	3.50	6.10	0.00	0.00	0.00	-	0.00	-	A-36	9.00 M WIDE Access Road	1.50	-	-	-	-	1.50	-	0.00	0.00
A-35	9.00 M WIDE Access Road	40.00	-	92.96	3.50	6.10	0.00	0.00	0.00	-	0.00	-	A-35	9.00 M WIDE Access Road	1.50	-	-	-	-	1.50	-	0.00	0.00
A-34	9.00 M WIDE Access Road	40.00	-	92.96	3.50	6.10	0.00	0.00	0.00	-	0.00	-	A-34	9.00 M WIDE Access Road	1.50	-	-	-	-	1.50	-	0.00	0.00
A-33	9.00 M WIDE Access Road	40.00	-	92.96	3.50	6.10	0.00	0.00	0.00	-	0.00	-	A-33	9.00 M WIDE Access Road	1.50	-	-	-	-	1.50	-	0.00	0.00
A-32	9.00 M WIDE Access Road	40.00	-	92.96	3.50	6.10	0.00	0.00	0.00	-	0.00	-	A-32	9.00 M WIDE Access Road	1.50	-	-	-	-	1.50	-	0.00	0.00
A-31	9.00 M WIDE Access Road	40.00	-	100.89	3.50	6.82	0.00	0.00	0.00	-	0.00	-	A-31	9.00 M WIDE Access Road	1.50	-	-	-	-	1.50	-	0.00	0.00
A-51	9.00 M WIDE Access Road	40.00	-	93.33	3.50	8.06	0.00	0.00	0.00	-	0.00	-	A-51	9.00 M WIDE Access Road	1.50	-	-	-	-	1.50	-	0.00	0.00
A-50	9.00 M WIDE Access Road	40.00	-	92.89	3.50	7.82	0.00	0.00	0.00	-	0.00	-	A-50	9.00 M WIDE Access Road	1.50	-	-	-	-	1.50	-	0.00	0.00
A-49	9.00 M WIDE Access Road	40.00	-	92.89	3.50	7.82	0.00	0.00	0.00	-	0.00	-	A-49	9.00 M WIDE Access Road	1.50	-	-	-	-	1.50	-	0.00	0.00
A-48	9.00 M WIDE Access Road	40.00	-	92.89	3.50	7.82	0.00	0.00	0.00	-	0.00	-	A-48	9.00 M WIDE Access Road	1.50	-	-	-	-	1.50	-	0.00	0.00
A-47	9.00 M WIDE Access Road	40.00	-	92.89	3.50	7.82	0.00	0.00	0.00	-	0.00	-	A-47	9.00 M WIDE Access Road	1.50	-	-	-	-	1.50	-	0.00	0.00
A-46	9.00 M WIDE Access Road	40.00	-	92.89	3.50	7.82	0.00	0.00	0.00	-	0.00	-	A-46	9.00 M WIDE Access Road	1.50	-	-	-	-	1.50	-	0.00	0.00
A-45	9.00 M WIDE Access Road	40.00	-	92.89	3.50	7.82	0.00	0.00	0.00	-	0.00	-	A-45	9.00 M WIDE Access Road	1.50	-	-	-	-	1.50	-	0.00	0.00
A-44	9.00 M WIDE Access Road	40.00	-	92.89	3.50	7.82	0.00	0.00	0.00	-	0.00	-	A-44	9.00 M WIDE Access Road	1.50	-	-	-	-	1.50	-	0.00	0.00
A-43	9.00 M WIDE Access Road	40.00	-	92.89	3.50	7.82	0.00	0.00	0.00	-	0.00	-	A-43	9.00 M WIDE Access Road	1.50	-	-	-	-	1.50	-	0.00	0.00
A-42	9.00 M WIDE Access Road	40.00	-	92.89	3.50	7.82	0.00	0.00	0.00	-	0.00	-	A-42	9.00 M WIDE Access Road	1.50	-	-	-	-	1.50	-	0.00	0.00

Total Plot Area :-	12468.45	Total FAR Area :-	0.00
Total Coverage Area :-	0.00	Total BUA Area :-	0.00

Note: - 1) This drawing is prepared as per the current prevailing Building Bye Laws.
 2) If Map sanctioned is used for purpose anything other than stated in application will lead to rejection of Map.

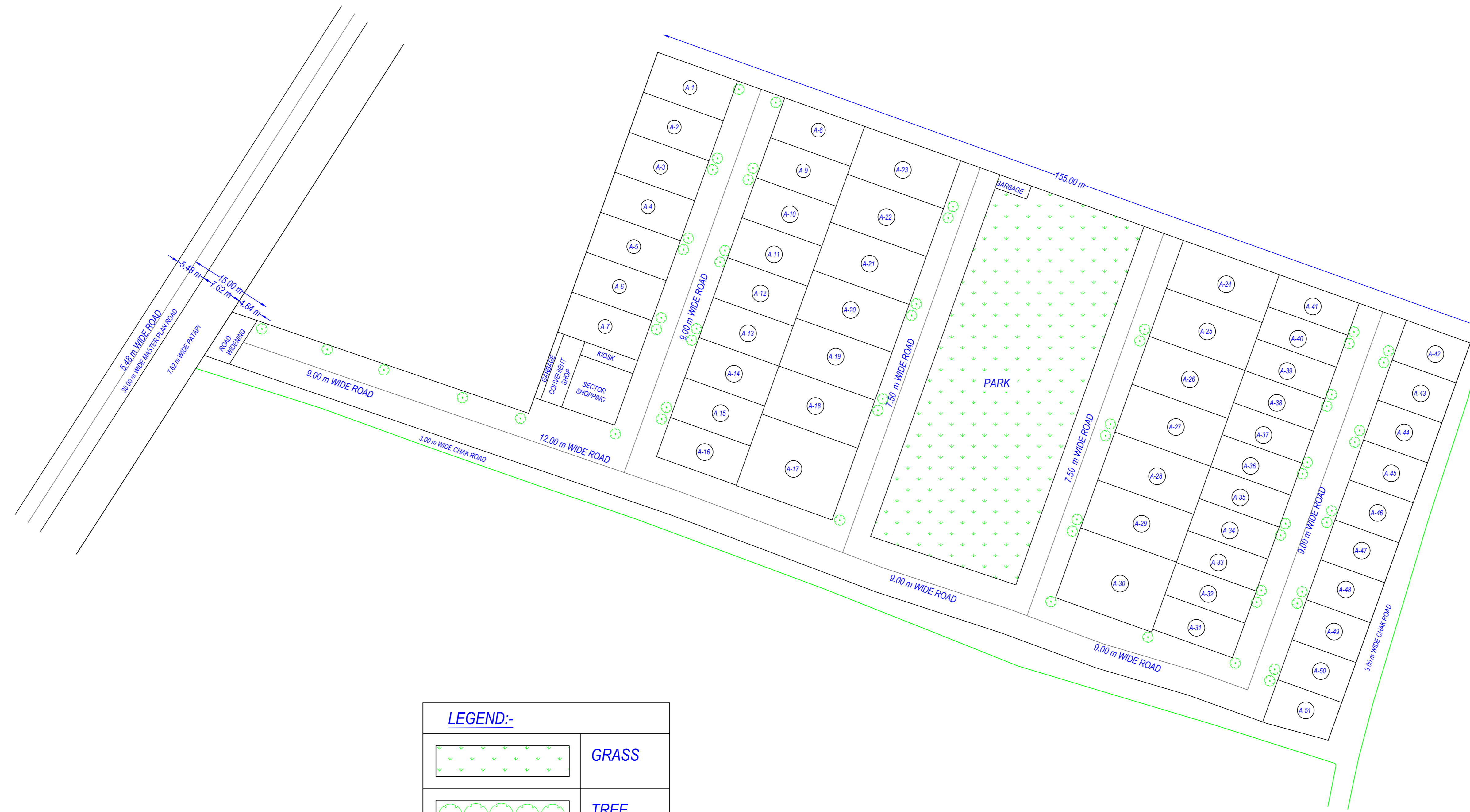

LEGEND:-

	GRASS
	TREE
	GARBAGE

LANDSCAPE PLAN

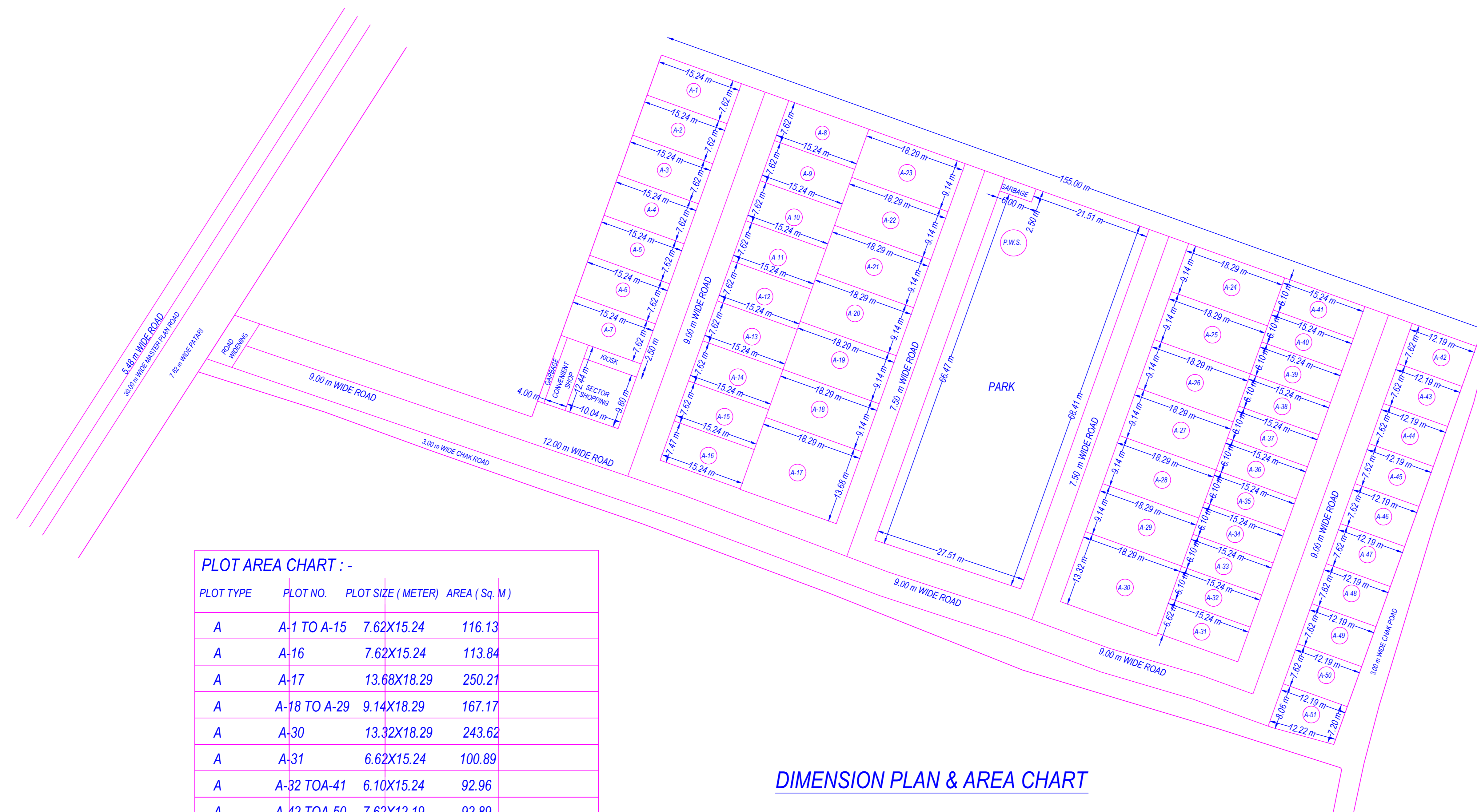

PLOT AREA CHART :-

PLOT TYPE	PLOT NO.	PLOT SIZE (METER)	AREA (Sq. M)
A	A-1 TO A-15	7.62X15.24	116.13
A	A-16	7.62X15.24	113.84
A	A-17	13.68X18.29	250.21
A	A-18 TO A-29	9.14X18.29	167.17
A	A-30	13.32X18.29	243.62
A	A-31	6.62X15.24	100.89
A	A-32 TO A-41	6.10X15.24	92.96
A	A-42 TO A-50	7.62X12.19	92.89
A	A-51	-	93.33

DIMENSION PLAN & AREA CHART

Note: - 1) This drawing is prepared as per the current prevailing Building Bye Laws.
 2) If Map sanctioned is used for purpose anything other than stated in application will lead to rejection of Map.

Total Plot Area :-	12468.45	Total FAR Area :-	0.00
Total Coverage Area :-	0.00	Total BUA Area :-	0.00

OWNER'S NAME AND SIGNATURE
 AERO VISTA CITY THROUGH SIVANTRAJ SERVICES INDIA PVT. LTD., vikram.jaiswal00@gmail.com, 9850400245

ARCHITECT'S NAME AND SIGNATURE
 VKRAM KUMAR JAISWAL
 AM158653231082018
 Signature Not Verified
 Ayodhya-Faizabad Development Authority

Building Plan Application Number
 AFDA/23-24/1071
 Sanctioned On
 02 Aug 2024
 Valid Till
 05 Aug 2029

Approved By
 Ashwini Kumar Pandey (Vice Chairman)

Examined By
 Surendra Singh Yadav (Junior engineer)
 Alok Kumar Singh (Executive engineer)
 Satyendra Singh (Secretary)
 Ashwini Kumar Pandey (Vice Chairman)

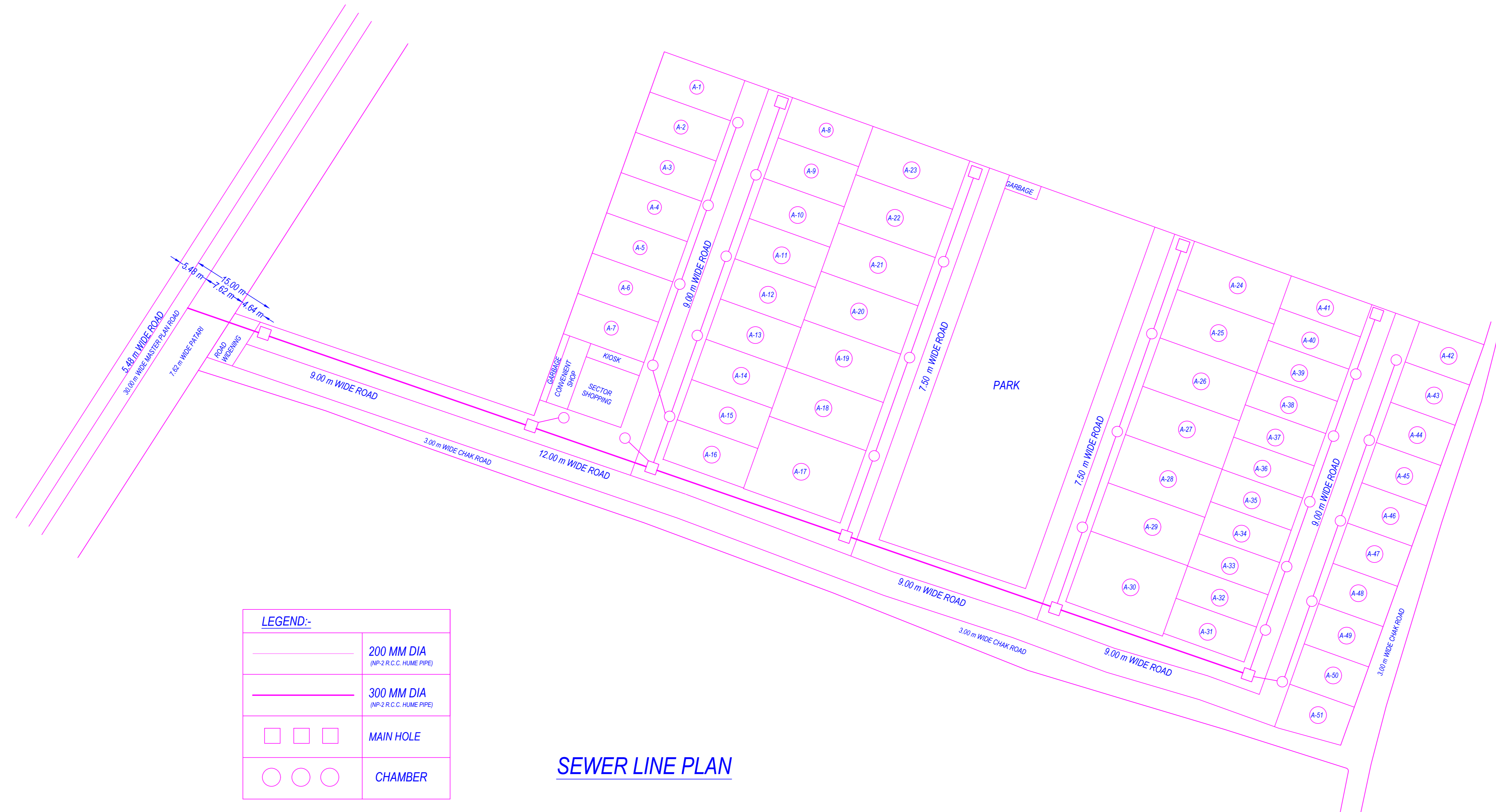

LEGEND:-

	200 MM DIA (W/S F.C.C. - R/WB PIPE)
	300 MM DIA (W/S F.C.C. - R/WB PIPE)
	MAIN HOLE
	CHAMBER

SEWER LINE PLAN

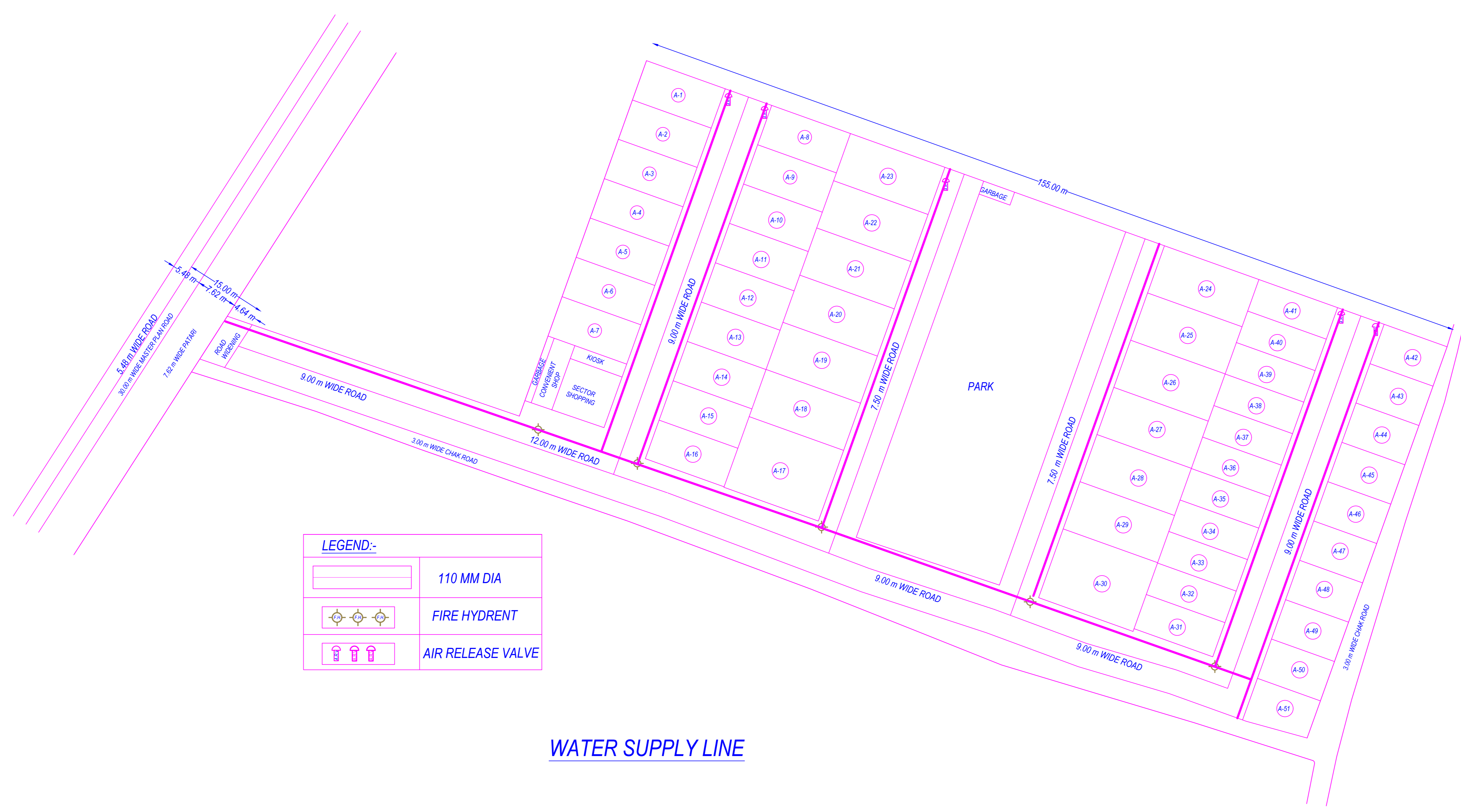

LEGEND:-

	110 MM DIA
	FIRE HYDRANT
	AIR RELEASE VALVE

WATER SUPPLY LINE

Note: - 1) This drawing is prepared as per the current prevailing Building Bye Laws.
2) If Map sanctioned is used for purpose anything other than stated in application will lead to rejection of Map.

Total Plot Area :-	12468.45	Total FAR Area :-	0.00
Total Coverage Area :-	0.00	Total BUA Area :-	0.00

OWNER'S NAME AND SIGNATURE *AERO VISTA CITY" THROUGH SIVANATRAJ SERVICES INDIA PVT. LTD., vikram.jaiswal@gmail.com, 9850400245	
ARCHENG'S NAME AND SIGNATURE VKRAM KUMAR JAISWAL AM158653231082018 Signature Not Verified	
	Ayodhya-Faizabad Development Authority
Building Plan Application Number AFDALD/23-24/1071 Sanctioned On 02 Aug 2024 Valid Till 05 Aug 2029	
Approved By Ashwini Kumar Pandey (Vice Chairman)	
Examined By Surendra Singh Yadav (Junior engineer) Alok Kumar Singh (Executive engineer) Satyendra Singh (Secretary) Ashwini Kumar Pandey (Vice Chairman)	

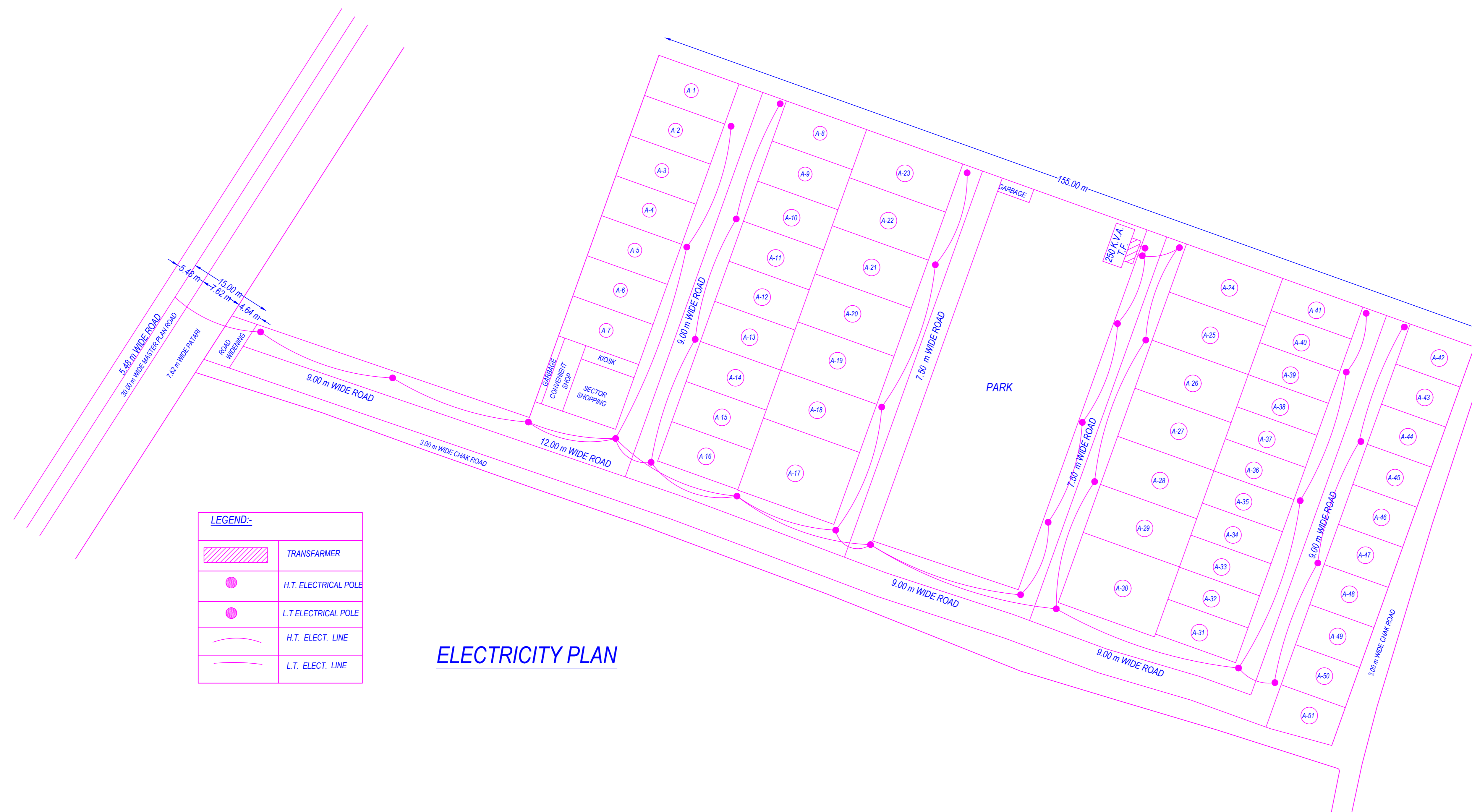
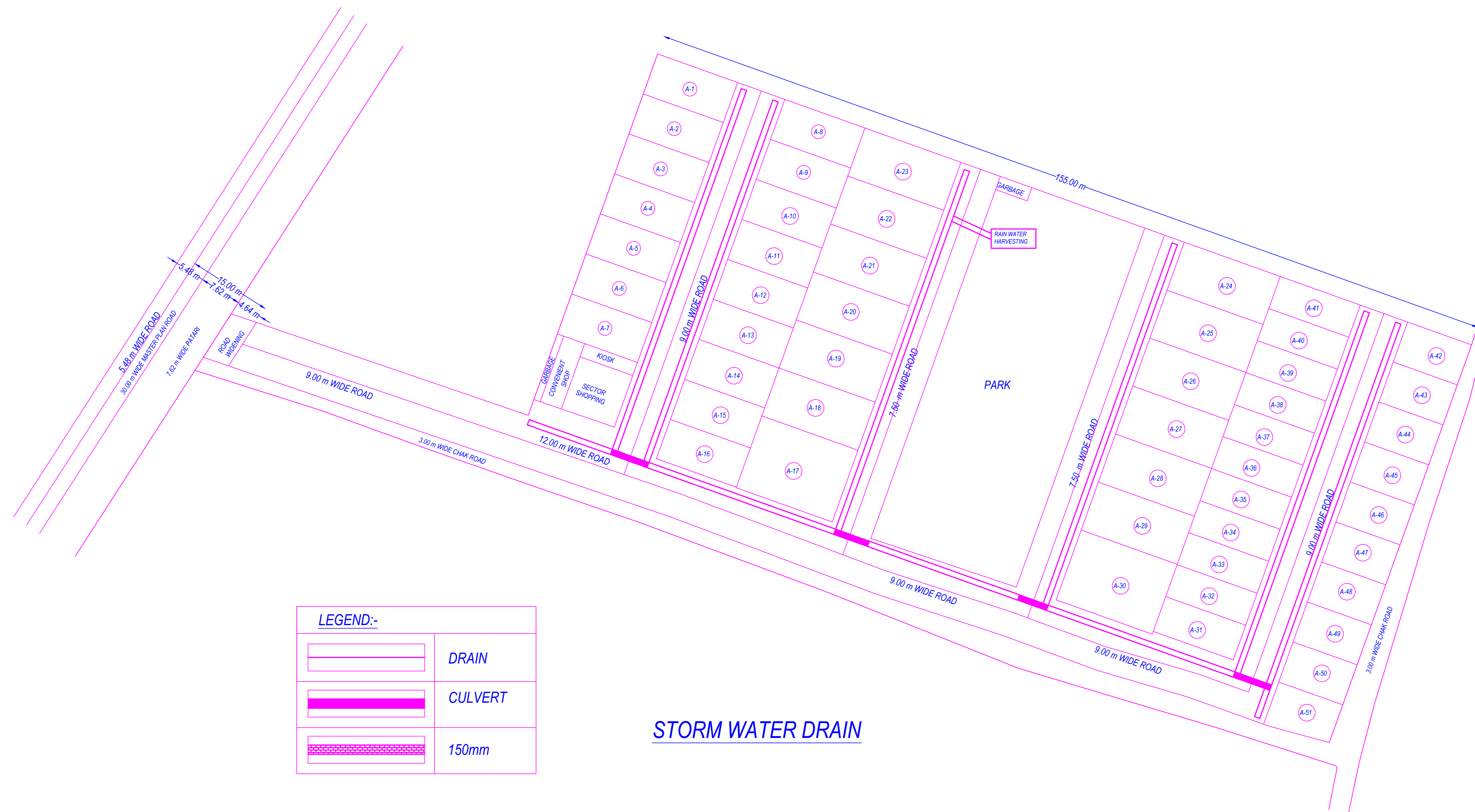

Note: - 1) This drawing is prepared as per the current prevailing Building Bye Laws.
 2) If Map sanctioned is used for purpose anything other than stated in application will lead to rejection of Map.

Total Plot Area: -	12468.45	Total FAR Area: -	0.00
Total Coverage Area: -	0.00	Total BUA Area: -	0.00

OWNER'S NAME AND SIGNATURE *AERO VISTA CITY" THROUGH SIVANATRAJ SERVICES INDIA PVT. LTD., vikram.jaiswal@gmail.com, 9850400245	
ARCHENG'S NAME AND SIGNATURE VKRAM KUMAR JAISWAL AM158653231082018	
Signature Not Verified	Ayodhya-Faizabad Development Authority
Building Plan Application Number AFDALD/23-24/1071	Sanctioned On 02 Aug 2024
Valid Till 05 Aug 2029	Approved By Ashwini Kumar Pandey (Vice Chairman)
Examined By Suresh Singh Yadav (Junior engineer)	Alok Kumar Singh (Executive engineer)
	Satyendra Singh (Secretary)
	Ashwini Kumar Pandey (Vice Chairman)