

PRODUCED BY AN AUTODESK EDUCATIONAL PRODUCT

PRODUCED BY AN AUTODESK EDUCATIONAL PRODUCT

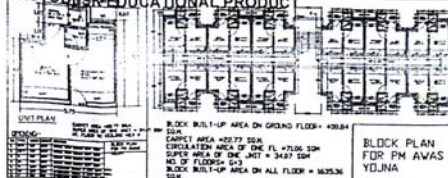

BLOCK PLAN FOR PM AVAS YD.JNA

**UPAVP**  
 ARCHITECTURAL AND PLANNING UNIT  
 4/1, PASTOR ROAD, LUCKNOW  
 U.P. PIN CODE - 226001  
 Email: upavp@rediffmail.com

LAYOUT PLAN FOR MIRANPUR PINVAT LUCKNOW

SHEET NO. 05/601/2

DRG NO. UP/06/ND/10/442/12/PINVAT/1/MAY/19/2018

**NOTE:-**  
 1. THIS LAYOUT PLAN HAS BEEN PREPARED ON THE BASIS OF INFORMATION RECEIVED FROM EX. EN. J.N.K.-12, VIDE HIS LETTER NO.-2326/TCO-6-3-62, DATED 28.08.2018  
 2. THIS LAYOUT PLAN HAS BEEN FINALISED ON THE BASIS OF FEASIBILITY RECEIVED FROM EX. EN. C.D.-12, VIDE HIS LETTER NO.-18/EE Campy, DATED 11.09.2018  
 3. प्रमाणपत्री अवकाश योजना के अर्जियत परिपत्र को विदे गरी किरियत खराब के बावित उक्त योजना मे भरनी का निर्णय विभाग सर्वे के अवसर पर कराया जाना हे।

**AREA STATEMENT:-**

TOTAL LAND AREA	: 21504.86 SQM (2.15HECT.)
COMMERCIAL AREA	: 327.20 SQ.MT.
SCHOOL	: 446.00 SQ.MT.
GREEN AREA	: 3215.23 Sqm. (15.0%)
PARKING	: 752NO (1504.00SQ.M.)
	: 2 Sqm. /FLAT AS PER NORMS
BLOCK AREA	: 408.84 Sqm.
GROUND COVERAGE	: 28%
F.A.R	: 1.12

**E.W.S. TYPE DESIGN**  
 UNIT CARPET AREA :- 22.77 SQ.MT.  
 SUPER AREA OF ONE FLAT :- 34.07 SQ.MT.

TOTAL LAND AREA :- 21504.86 SQ.MT.

**RESIDENTIAL:- TOTAL UNITS - 752**

PARTICULAR	NO. OF BLOCK	NO. OF UNIT IN EACH BLOCK	NO. OF FLOOR	TOTAL UNITS	UNIT AREA (SQ.MT.)	SUPER AREA OF UNIT (SQ.MT.)
E.W.S.	14	48	G + 3	752	22.77	34.07

ARCHITECTURE & PLANNING UNIT - 4  
 U.P. AVAS EVAM VIKAS PARISHAD LUCKNOW.

LAY-OUT PLAN OF PMAY  
 WILL - MIRANPUR PINVAT, SAROJNI NAGAR LUCKNOW.

DATE	: 12-09-2018
ANSHU	UP.AND.
ARCH. ASSTT.	
ALOK VERMA	UP.AND. ARCHITECT PLANNER
ASSTT. ARCHITECT PLANNER	
SANJEEV KASHYAP	UP.AND. ARCHITECT PLANNER
ARCHITECT PLANNER	
S. K. RAITANI	UP.AND. ARCHITECT PLANNER
CHIEF ARCHITECT PLANNER	
VIJAY CHAUDHARI	UP.AND. ARCHITECT PLANNER
AVAS ATYKT	

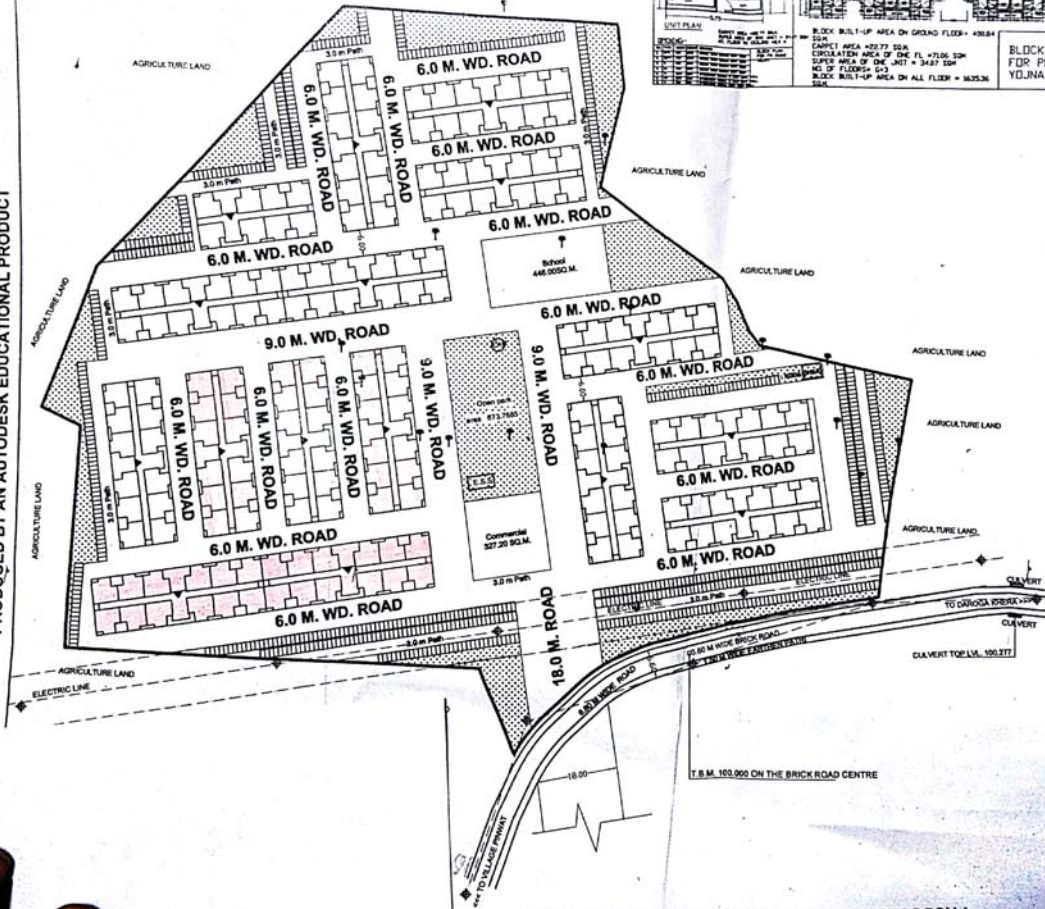

PRODUCED BY AN AUTODESK EDUCATIONAL PRODUCT

PRODUCED BY AN AUTODESK EDUCATIONAL PRODUCT