

AREA ANALYSIS

S.N.	ITEM	ACCEPTED	REMARKS
1.	PLOT AREA	12130.74 SQM	
2.	GR COVERAGE (01 BLOCK)	403.84 SQM	
3.	GR COVERAGE	4497.24 SQM	37.07 %
4.	F.A.R	1.48	
5.	UNITS IN 01 BLOCK		48 Nos
6.	NOS OF BLOCKS		11 (G-3)
7.	NO OF UNITS	528 NOS	
8.	PARKING	560 NOS	(32.0 sq mt./unit)
9.	POPULATION DENSITY	2178 PERSON / HECT	

LANDUSE ANALYSIS

TOTAL PROJECT AREA = 12130.74sqm

Landuse	Area in sqm.	%Age
Residential (ground coverage)	4497.24	37.08
Commercial	370.34	3.05
Park / OPEN	1228.89	10.13
Roads & Parking	6034.27	49.74
Total	12130.74	100.00

PLINTH AREA OF ONE UNIT = 28.15 SQM.
 CARPET AREA OF ONE UNIT = 22.77 SQ.M.
 CIRCULATION AREA OF ONE FL = 71.00 SQM
 SUPER AREA OF ONE UNIT = 34.07 SQM

NOTE:-

- THIS LAY OUT PLAN FOR THE HOUSES UNDER PRIME MINISTER AVAS YOUNA HAS BEEN PREPARED ON THE BASIS OF ORDER GIVEN BY CHIEF ENGINEER IN SAMIKSHA BAIKHAH HELD IN HEAD OFFICE DATED 20.01.2017 AND UNIT DRAWING & SAMPLE L.O.P. PROVIDED BY UPES, UTTAR PRADESH SHASAN VIDE HIS LETTER NO. : 185508-1-17-90VVIVD/H/2010 DATED 05.08.2017.
- THIS LAY OUT PLAN FOR THE HOUSES UNDER PRIME MINISTER AVAS YOUNA HAS BEEN FINALISED ON THE BASIS OF FEASIBILITY RECEIVED BY E.E.C.D.-02 VIDE HIS LETTER NO. : 20589PY-244 DATED: 14.08.2018.

PROPOSED LAYOUT PLAN OF HOUSES UNDER PRADHAN MANTRI AVAS YOUNA AT DISTT. - GONDA, UTTAR PRADESH

DATE : 20.08.2018
 SCALE : NORTH

VIKAS SINGH	
D/MAN.(CIVIL)	<i>[Signature]</i>
PRABHAVATI SURI	<i>[Signature]</i>
ASST. ARCH. PLANNER	<i>[Signature]</i>
ARVIND DEO ARYA	<i>[Signature]</i>
ARCHITECT PLANNER	<i>[Signature]</i>
A.K. SHUKLA	<i>[Signature]</i>
CHIEF ARCHITECT PLANNER	<i>[Signature]</i>
AJAY CHAUHAN	<i>[Signature]</i>
AVAS AYUKT	<i>[Signature]</i>

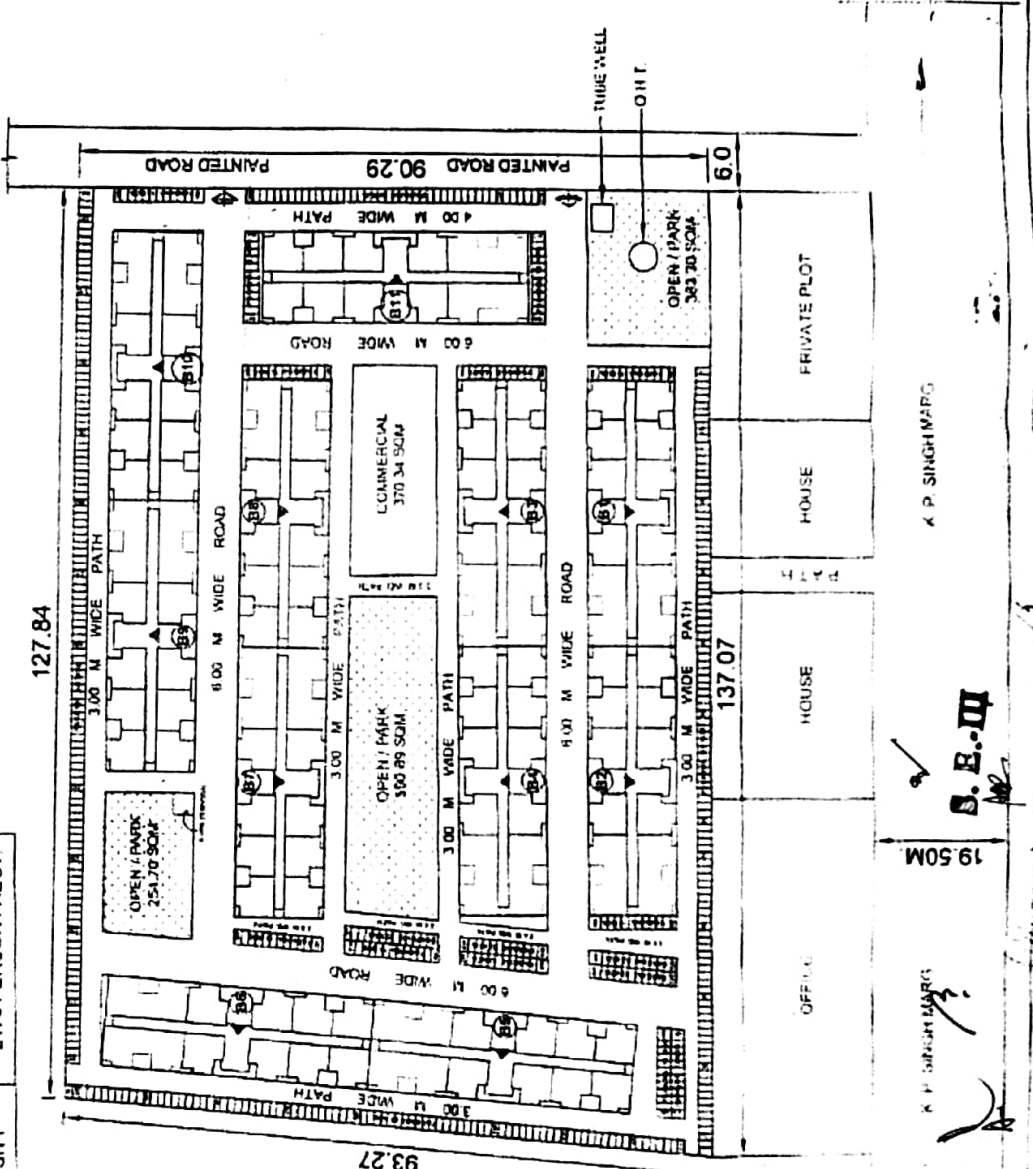

S.B.O.II

K.P. SINGH MARG

K.P. SINGH MARG

[Signature]

TO LUCKNOW - GONDA ROAD