

AREA STATEMENT		
S.NO	PARTICULARS	SQ.MT.
1.	TOTAL PLOT AREA	5,557.88
2.	PERMISSIBLE GROUND COVERAGE 50% OF = 5,557.88 X 50 / 100 = 2,778.94 sq.mt	2,778.94
3.	PROPOSED GROUND COVERAGE (44.78%)	2,489.31
4.	PROPOSED BASEMENT AREA	4,776.49
5.	PERMISSIBLE F.A.R AREA @1.75 5,557.88 x 1.75 = 9,726.29 sq.mt.	9,726.29
6.	PROPOSED F.A.R AREA (1.749)	9,723.64
a.	LOWER GROUND FLOOR	2,408.32
b.	GROUND FLOOR	2,428.78
c.	FIRST FLOOR	2,090.10
d.	SECOND FLOOR	2,084.80
e.	THIRD FLOOR	77.00
f.	FOURTH FLOOR	634.64
	TOTAL F.A.R. AREA	9,723.64

BUILT - UP AREA DETAIL (F.A.R. + NON F.A.R. AREA)		
1.	BASEMENT PLAN	4,776.49
2.	LOWER GROUND FLOOR	2,487.25
3.	GROUND FLOOR	2,489.31
4.	FIRST FLOOR	2,187.10
5.	SECOND FLOOR	2,178.86
6.	THIRD FLOOR	658.58
7.	FOURTH FLOOR	663.76
8.	TERRACE FLOOR	143.22
	TOTAL BUILT - UP AREA	15,584.57 sq.mt.

SITE PLAN



Note - : BUILDING WILL BE MECHANICALLY VENTILATED

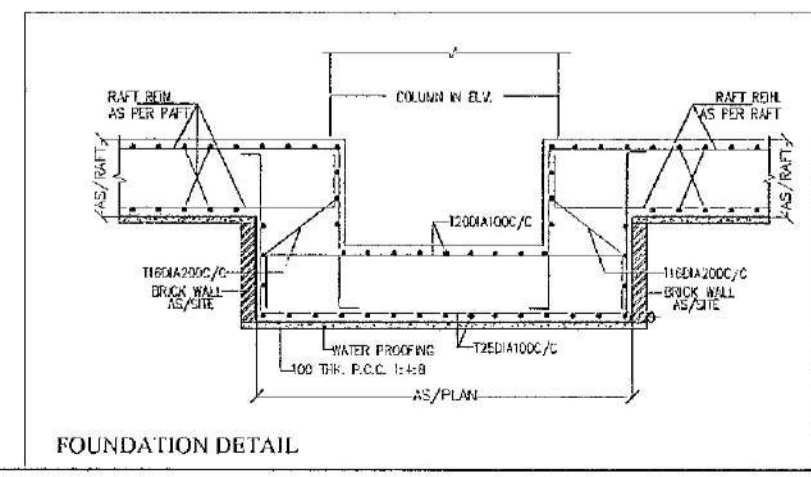
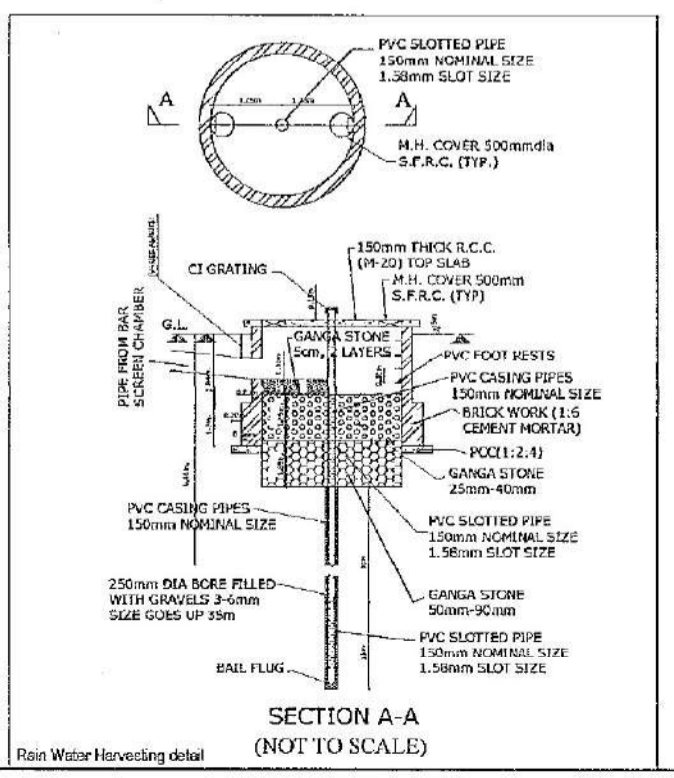

Prateek Realtors India Pvt. Ltd.
Authorized Signatory

REQUIRED PARKING DETAIL	
TOTAL COMMERCIAL F.A.R.	= 9723.64 sq.mt.
DEDUCT CINEMA AREA	= 704.85 sq.mt.
Net commercial f.a.r.	= 9723.64 - 704.85 = 9,018.79 sq.mt.
Commercial f.a.r. area parking required @1.25 e.c.s.	
per 100 sq.mt. f.a.r.	= 9,018.79 x 1.25 / 100 = 112.73 ---(a)
Total cinema seats is = 436 nos.	
Cinema parking required @10 seats for 1 E.C.S.	
	= 436 / 10 = 43.60 ---(b)
Total required parking (a + b) = 156.33 (say - 156 e.c.s.)	

PARKING PROVIDED DETAIL		
1	BASEMENT	161
	Normal parking (N01 TO 09) = 09no.	
	Mechanical parking (2 tier M1 to M76) 76 x 2 = 152 nos.	

PROJECT:
SUBMISSION DRAWINGS FOR THE PROPOSED PRATEEK GRAND CITY MALL AT PLOT NO. CP - 01 PART OF PLOT NO. - 4/BS-01 & BS/05 PRATEEK GRAND CITY, SIDDARTH VIHAR NH - 24, GHAZIABAD (U.P.)

OWNER:
M/s. - PRATEEK REALTORS INDIA PRIVATE LIMITED

DRAWING TITLE:
SITE PLAN WITH AREA DETAIL

ANUJ AGARWAL ARCHITECTS
Architects, engineers, landscape & interior designers
ANUJ AGARWAL ARCHITECTS
A-244 KAUSHAMBI GHAZIABAD (U.P.)
Ph: 91 120 6454198 - 6454192
e-mail: anuj_agarwal@anujarch.com

SCALE	DATE BY	DATE
DESIGN BY	CHECKED BY	DRG. No.
		SD-01

OWNER'S SIGN: *Anuj*
ARCHITECT'S SIGN: *Anuj Agarwal*

ANUJ AGARWAL RWA
Digitally signed by ANUJ AGARWAL
Date: 2025.12.01 18:40:55
+05'30'

Signature valid