



UPAVP
 ARCHITECTURAL AND PLANNING SECTION
 NEELGRI COMPLEX, INDIRA NAGAR
 LUCKNOW - 226016
 Email: upavp@sanchamel.in

DRG. NO. _____

FILE NO. _____

SHEET NO. _____

NOTES:
 1. THIS LAYOUT PLAN FOR GROUP HOUSING (EWS/LIG/TYPED FLA'S) HAS BEEN PREPARED AS PER RECOMMENDATION RECEIVED BY S.E. (CIRCLE-1) WIDE HIS LETTER NO.-117 DT: 09.09.2015.
 2. THE FEASIBILITY REPORT SENT TO E.E.C.D.-31 WIDE LETTER NO.-14 DATED: 09.11.2015.
 3. THIS LAYOUT PLAN HAS BEEN PREPARED AS PER FEASIBILITY RECEIVED BY E.E.C.D.-31 WIDE HIS LETTER NO.-1515 DT.-07.12.2015.
 4. THIS LAYOUT PLAN HAS BEEN FINALIZED ON THE BASIS OF FEASIBILITY RECEIVED BY E.E.C.D.-31 WIDE HIS LETTER NO.-1580/P-524/56 DATED: 17.12.2015.

PLOT AREA FOR EWS/LIG G.H. PLOT = 6113.00 SQ.M.
 GROUND COVERAGE = 27.54%
 F.A.R. = 0.32
 DENSITY ALLOWED @ 1000PPH = 611 PERSONS
 TOTAL UNIT ALLOWED (611/5) = 122.20 SAY 123

DETAIL OF PROPOSED PROPERTIES:

PARTICULAR		LAND AREA	
RESIDENTIAL		6113.00 SQ.M.	
S/N	PARTICULAR	AREA	PERCENTAGE
(A)	EWS	4	4
(B)	LIG	6	4
TOTAL		10	120

F.A.R. ACHIEVED = 1680.80 / 27.54% = 0.82%

DETAIL OF PARKING:

S.NO.	PROPERTIES	TOTAL NO. OF UNITS	PARKING REQUIRED	PARKING PROVIDED
1.	E.W.S.	48	48	48
2.	L.I.G.	72	72	72
TOTAL		120	120	120

PROPOSED LAY-OUT PLAN FOR EWS/LIG (G+2) HOUSES ON GROUP HOUSING PLOT AT LOHRAMAU YOUNA, SULTANPUR

DATE: 14-12-2015

SCALE: 1:500

VIKA: SINGH

DIMAN, (CIVIL)

PAD: M MOHAN

ASS. T. ARCH. PLANNER

HENIA AGARWAL

ARCHITECT PLANNER

CHIEF ARCHITECT PLANNER

SHA: TABUDDIN MOHAMMED

HOUSING COMMISSIONER

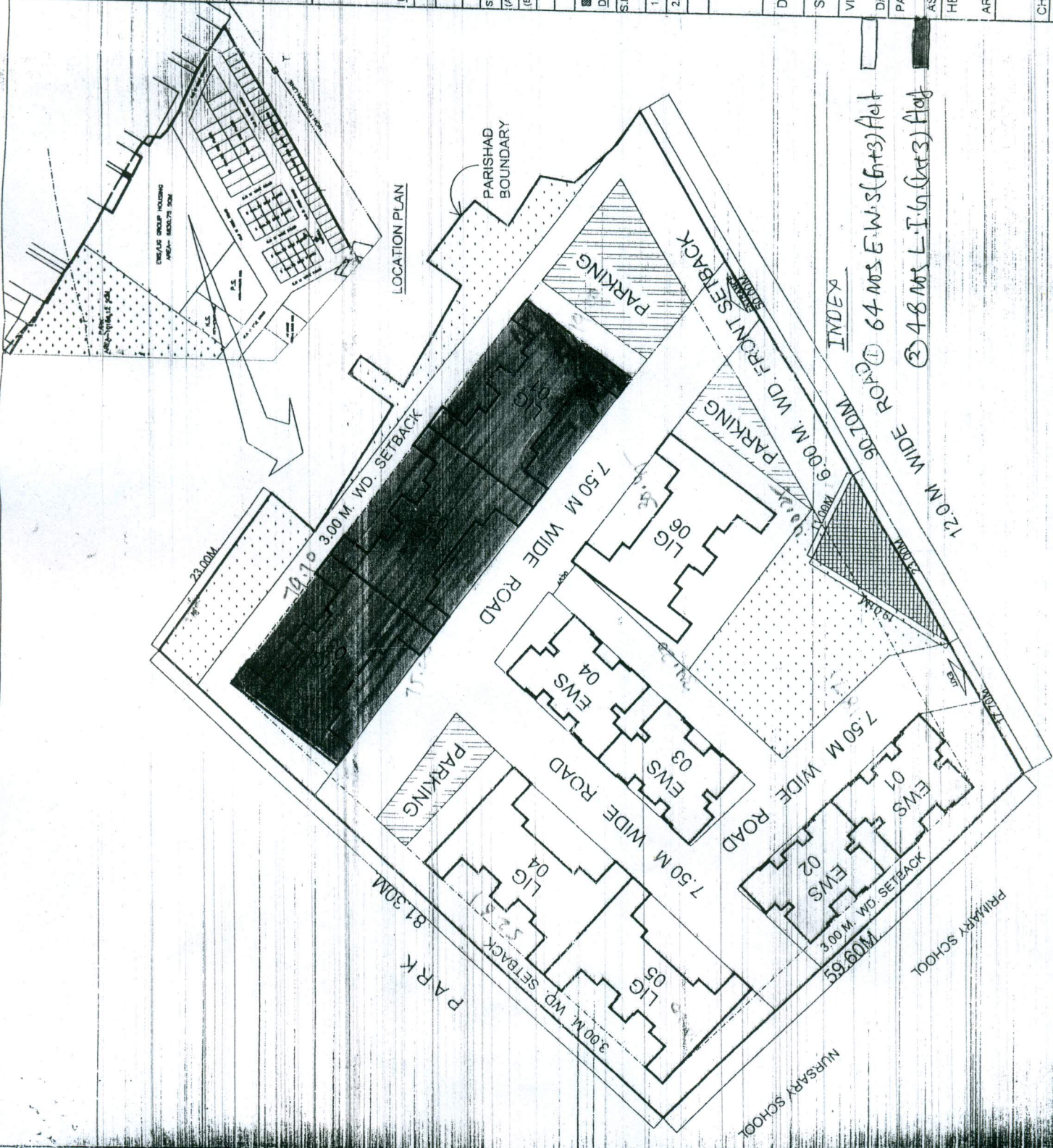

INDEX
 1. 64 NOS E.W.S (G+2) Flat
 2. 48 NOS L.I.G (G+2) Flat