

LEGEND

- OC OBTAINED
- UNDER CONSTRUCTION
- APPLIED FOR REVISION
- BOUNDARY WALL

L. SHIV KUMAR ACHARYA
TOWN PLANNER
B ARCH, MUDP
A/TP/2011-100

- S.No. Notes:
- This drawing is the property of Rientotech consultant and is not to be copied or reproduced in any form without the prior permission of the Architects.
 - All Dimensions are in Millimetres unless otherwise mentioned.
 - Drawing is to be read only and not to be scaled.
 - Any discrepancies in the drawing has to be immediately brought to the notice of the Architects.

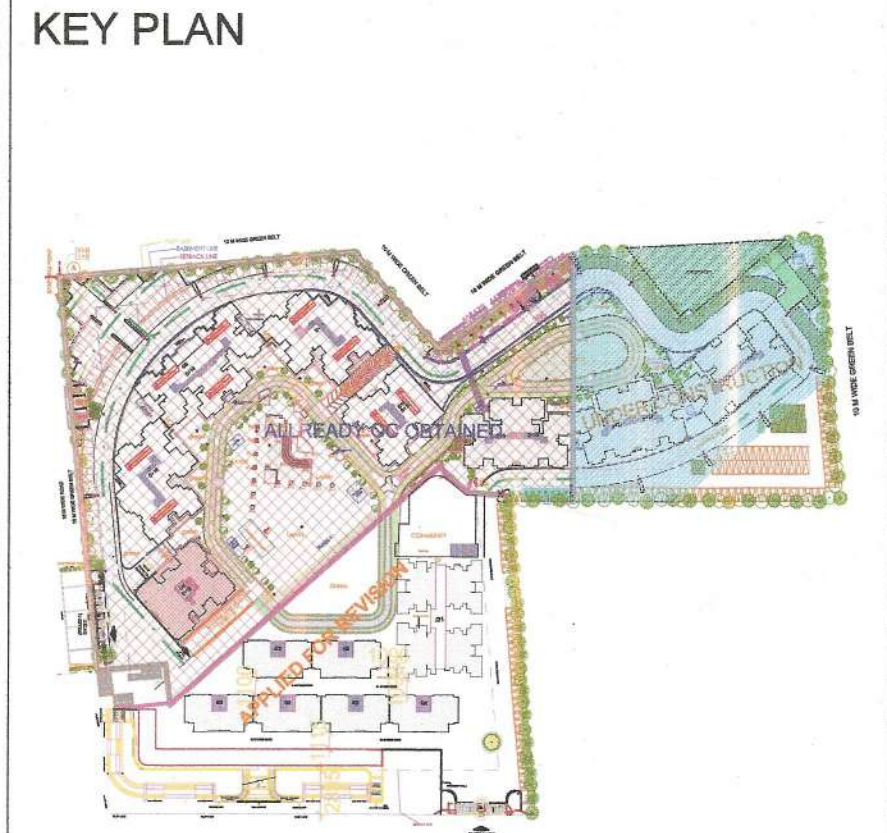

PROJECT :
REVISE SUBMISSION PLAN FOR
PHASE-2 RESIDENTIAL GROUP
HOUSING AT PLOT NO -GH-03, OF
SECTOR -02, GREATER NOIDA, U.P.

OWNER :
NIRALA PROJECTS PVT. LTD.

ARCHITECTS :
REINFO-TECH CONSULTANTS
G-56 (BASEMENT), PUSHKAR ENCLAVE, PASCHIM VIHAR, ND-63.
PH. :-011-011-42331562, 011-45796222- 25
email id :- arch_nkmittal@yahoo.com
Website :- www.reinfotech.net

Drawing :
REVISED SUBMISSION

Sheet Title :
SITE PLAN & AREA DETAIL

Scale: N.T.S

SEAL & SIGNATURE:
NIRALA PROJECTS PVT. LTD.
ARCHITECTS: M. MITAL
B. ANSARI
CA/2013/71404

AUTHORITY
Greater Noida Industrial Development Authority
Vide Letter No. P/2013/2005/604 dated 20/11/2020
Valid Upto Dated 30/11/2025

AREA DETAILS

1 TOTAL PLOT AREA	= 40852.500	Sq Mts
ENCROACHED AREA	= 0.000	Sq Mts
NET PLOT AREA	= 40852.500	Sq Mts
	= 4.085	HECTARE
PLOT AREA (OC OBTAINED)	= 16251.598	Sq Mts
BALANCE PROPOSED PLOT AREA	= 24600.902	Sq Mts
2 GROUND COVERAGE		
PERMISSIBLE GROUND COVERAGE @ 35% OF PLOT AREA	= 14298.375	Sq Mts
PROPOSED GROUND COVERAGE	= 2889.733	Sq Mts
GROUND COVERAGE (OC OBTAINED)	= 3869.768	Sq Mts
TOTAL GROUND COVERAGE (PROPOSED + OC OBTAINED + UNDER CONST.)	= 8577.588	%
	= 20.996	%
3 FAR		
PERMISSIBLE FAR @ 2.75 OF NET PLOT AREA	= 112344.375	Sq Mts
TOTAL PROPOSED FAR (G1, G2, G3 + COMMERCIAL) (A)	= 18379.996	Sq Mts
TOTAL UNDER CONSTRUCTION FAR (G11, G12, G14) (B)	= 28099.996	Sq Mts
TOTAL FAR..... (OC OBTAINED AREA) (C)	= 65927.418	Sq Mts
TOTAL PROPOSED FAR..... (D) = (A+B+C)	= 112334.261	Sq Mts
	= 2.750	
4 GREEN AREA		
REQUIRED GREEN @ 50% OF (PLOT AREA - GROUND COVERAGE)	= 16138.744	Sq Mts
PROPOSED GREEN	= 7872.730	Sq Mts
GREEN AREA (OC OBTAINED)	= 8548.863	Sq Mts
TOTAL GREEN AREA	= 16421.593	
No. OF TREES REQUIRED @ 1 TREE/100 SQMT OF (PLOT AREA - GR. COV.)	= 322.749	Nos
No. OF TREES PROVIDED (above 2.0 mtr. Height)	= 438	Nos
5 DUP'S		
TOTAL DUP'S	= 1292	NOS
TOTAL SERVANT ROOM	= 124	NOS
TOTAL DUP'S UNDER CONSTRUCTION	= 400	NOS
TOTAL DUP'S PROPOSED	= 160	NOS
TOTAL DUP'S (OC OBTAINED)	= 48	NOS
TOTAL SERVANT ROOM (OC OBTAINED)	= 732	NOS
TOTAL DUP'S (OC OBTAINED)	= 76	NOS
6 DENSITY		
PERMISSIBLE DENSITY @ 1650 PERSONS /HAECTARE	= 6740.663	Nos
POPULATION @ 4.5 PERSONS/ DU	= 5814	Nos
POPULATION OF SERVANT @ 2.25 PERSONS/ DU	= 279.00	Nos
NO. OF PERSONS PROPOSED = (5814+279)	= 6093.00	Nos
DENSITY PROPOSED	= 1491.463	PERSON/HAECTARE
7 SERVICE AREA (Additional 15% OF FAR)		
PERMISSIBLE SERVICE AREA @ 15% OF FAR	= 16851.65625	Sq Mts
PROPOSED AREA IN 15% FACILITY AREA FOR HOUSING + FIRE STAIR CASE AREA + LIFT LOBBY AREA + MUMTY AREA + MACHINE ROOM AREA + LIFT SHAFTS + SERVICES SHAFTS + CUPBOARD + GUARD ROOM + OVER HEAD TANK + DRIVER'S REST ROOM + STP (OC OBTAINED AREA)	= 10441.491	SQ.MT
PROPOSED AREA IN 15% FACILITY AREA FOR HOUSING + FIRE STAIR CASE AREA + LIFT LOBBY AREA + MUMTY AREA + MACHINE ROOM AREA + LIFT SHAFTS + SERVICES SHAFTS + CUPBOARD + GUARD ROOM + OVER HEAD TANK + DRIVER'S REST ROOM + STP (UNDER CONSTRUCTION AREA) (K)	= 3400.948	SQ.MT
PROPOSED AREA IN 15% FACILITY AREA FOR HOUSING + FIRE STAIR CASE AREA + LIFT LOBBY AREA + MUMTY AREA + MACHINE ROOM AREA + LIFT SHAFTS + SERVICES SHAFTS + CUPBOARD + GUARD ROOM + OVER HEAD TANK + DRIVER'S REST ROOM + STP (PROPOSED SERVICE AREA) (R)	= 2948.161	SQ.MT
TOTAL SERVICE AREA..... (E)	= 16790.600	Sq Mts
ACHIEVED FOR FACILITY - PERMISSIBLE FOR FACILITY (16851.656-16669.762)	= 61.056	SQ.MT
EXTRA AREA TO BE CALCULATED IN FAR	= Nil	SQ.MT
PERMISSIBLE COMMERCIAL @ 1% OF 2.75 FAR	= 1123.444	SQ.MT
TOTAL PROPOSED COMMERCIAL	= 1120.87	SQ.MT
TOTAL PROPOSED COMMUNITY	= 1279.278	SQ.MT

8 PARKING

RESIDENTIAL ECS REQUIRED @ 1 ECS PER 80 SQ.MT./ECS	= 1404.305	Nos
TOTAL ECS REQUIRED	= 1404.305	Nos
ECS PROVIDED	= 1300	Nos
9 BASEMENT AREA		
TOTAL BASEMENT AREA (OC OBTAINED + PROPOSED)	= 27234.613	Sq Mts
BASEMENT AREA (OC OBTAINED)	= 16521.062	Sq Mts
PROPOSED BASEMENT AREA (S)	= 5404.610	Sq Mts
PROPOSED BASEMENT AREA UNDER CONSTRUCTION (Z)	= 3817.967	Sq Mts
PROPOSED BASEMENT PARKING AREA	= 24288.469	Sq Mts
PERMISSIBLE ECS IN BASEMENT @ 1 ECS/ 30 Sq Mts	= 809.616	Nos
BASEMENT PARKING AREA (OC OBTAINED)	= 15407.427	Sq Mts
PERMISSIBLE ECS IN BASEMENT @ 1 ECS/ 30 Sq Mts (OC OBTAINED)	= 466.914	Nos
OC OBTAINED ECS	= 471	Nos
PROPOSED ECS	= 132	Nos
TOTAL ECS	= 603	Nos
11 PROPOSED STILT PARKING AREA (TOWER AREA) (Q)	= 1720.178	Sq Mts
STILT PARKING AREA (TOWER AREA) (OC OBTAINED)	= 3497.209	Sq Mts
STILT AREA (TOWER) UNDER CONSTRUCTION (Z)	= 1122.813	Sq Mts
TOTAL PROPOSED STILT PARKING AREA (TOWER AREA)	= 6470.954	Sq Mts
PERMISSIBLE ECS IN STILT (TOWER AREA) @ 1 ECS/ 30 Sq Mts	= 215.698	Nos
PROPOSED ECS IN STILT (TOWER AREA)	= 205	Nos
PROPOSED ECS IN STILT (TOWER AREA) (OC OBTAINED)	= 109	Nos
TOTAL ECS IN STILT (TOWER AREA) (PROPOSED + OC OBTAINED)	= 314	Nos
12 PROPOSED STILT PARKING AREA (NON - TOWER AREA) (T)	= 2180.731	Sq Mts
STILT PARKING AREA (NON - TOWER AREA) (OC OBTAINED)	= 7793.984	Sq Mts
TOTAL STILT UNDER CONSTRUCTION PARKING AREA (NON - TOWER AREA)	= 3435.836	Sq Mts
TOTAL PROPOSED STILT PARKING AREA (NON - TOWER AREA) (PROPOSED + OC OBTAINED)	= 13282.979	Sq Mts
PERMISSIBLE ECS IN STILT (NON - TOWER AREA) @ 1 ECS/ 30 Sq Mts	= 442.766	Nos
PROPOSED ECS IN STILT (NON - TOWER AREA)	= 71	Nos
ECS IN STILT (NON - TOWER AREA) (OC OBTAINED)	= 168	Nos
TOTAL ECS IN STILT (NON - TOWER AREA) (PROPOSED + OC OBTAINED)	= 239	Nos
TOTAL PROPOSED ECS IN STILT (BOTH TOWER & NON - TOWER)	= 350	Nos
13 PROPOSED SURFACE PARKING AREA	= 6765.690	Sq Mts
PERMISSIBLE ECS IN SURFACE @ 1 ECS / 20sq Mts	= 338.285	Nos
SURFACE PROPOSED ECS	= 350	Nos
14 TOTAL ECS PROVIDED	= 1506	Nos
STILT /PODIUM AREA		
COVERED AREA (UNDER CONSTRUCTION)		
TOTAL UNDER CONSTRUCTION AREA (FAR AREA + SERVICE AREA + BASEMENT AREA (V))	= 35318.911	Sq Mts
COVERED AREA		
16 TOTAL COVERED AREA (PROPOSED + UNDER CONSTRUCTION)	= 66032.587	Sq Mts
17 PROPOSED TOTAL COVERED AREA + FAR AREA + SERVICE AREA + BASEMENT AREA + PROPOSED STILT (TOWER AREA) PROPOSED STILT (NON-TOWER AREA)	= 30713.676	Sq Mts
PROPOSED TOTAL COVERED AREA (V)	= 30713.676	Sq Mts

DRAWING NO : RTC/NGS / SUB /PH-2/ 100-A

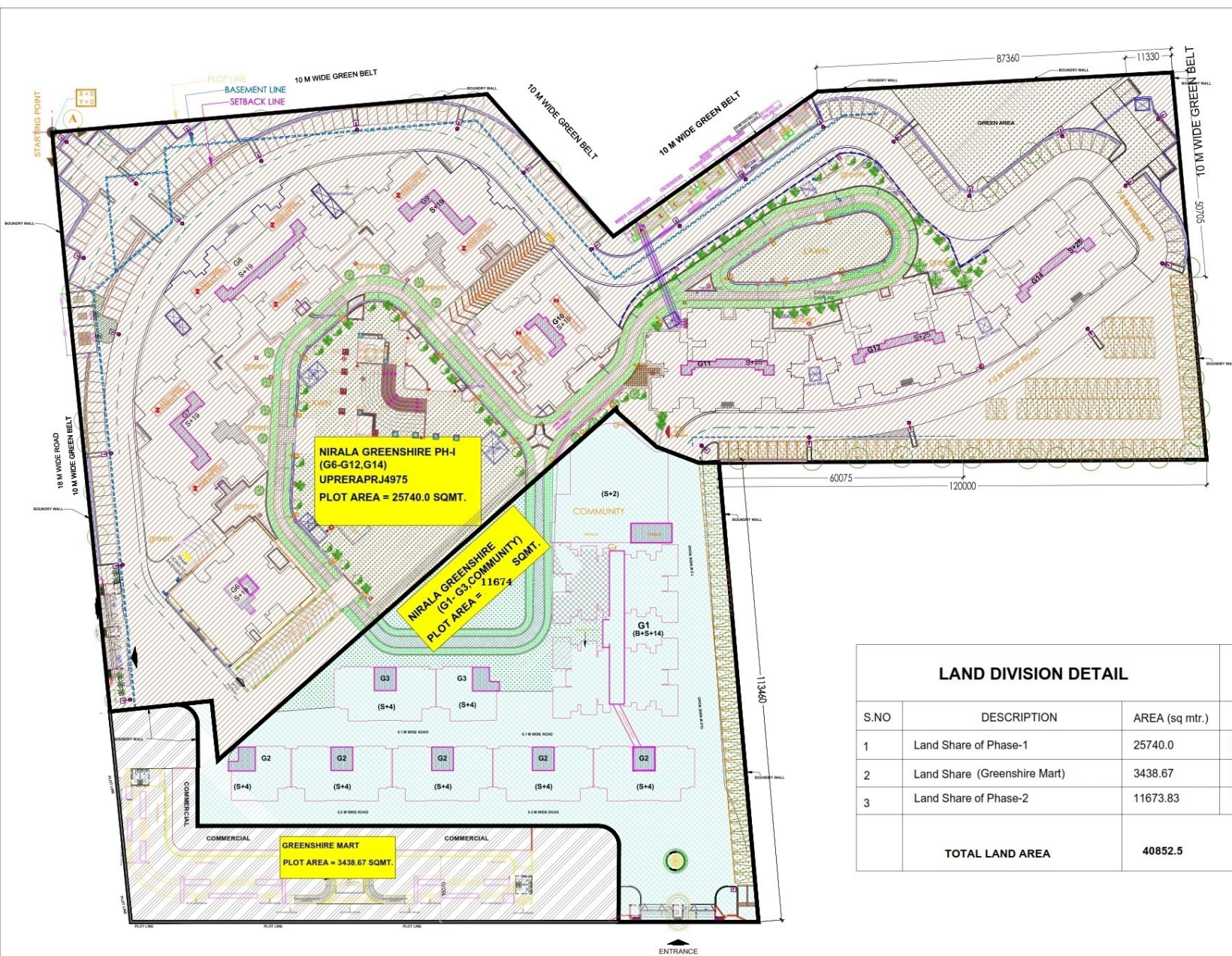

LAND DIVISION DETAIL			
S.NO	DESCRIPTION	AREA (sq mtr.)	
1	Land Share of Phase-1	25740.0	
2	Land Share (Greenshire Mart)	3438.67	
3	Land Share of Phase-2	11673.83	
TOTAL LAND AREA		40852.5	

- S.No. Notes:
1. This drawing is the property of Reinfotech consultant and is not to be copied or reproduced in any form without the prior permission of the Architects.
 2. All Dimensions are in Millimetres unless otherwise mentioned.
 3. Drawing is to be read only and not to be scaled.
 4. Any discrepancies in the drawing has to be immediately brought to the notice of the Architects.

KEY PLAN



PROJECT :
REVISE SUBMISSION PLAN FOR PHASE-2 RESIDENTIAL GROUP HOUSING AT PLOT NO -GH-03, OF SECTOR -02, GREATER NOIDA, U.P.

OWNER :
NIRALA PROJECTS PVT. LTD.

ARCHITECTS :

REINFO-TECH CONSULTANTS
 G-06 (BASEMENT), PUSHPAK ENCLAVE, PASCHEM VIHAR, ND-63
 PH. : 011- 011-42331862 ,011-45796222- 25
 email id :- arch_nkmittal@yahoo.com
 Website :- www.reinfotech.net

Drawing :
REVISED SUBMISSION

Sheet Title :
SITE PLAN & AREA DETAIL

Scale : **N.T.S**

SEAL & SIGNATURE :
 OWNER :
 ARCHITECTS :

AUTHORITY

DRAWING NO : **RTC/NGS / SUB /PH-2/ 100-A**

AREA DETAILS			
1	TOTAL PLOT AREA	= 40852.500	Sq Mts
	ENCROACHED AREA	= 0.000	Sq Mts
	NET PLOT AREA	= 40852.500	Sq Mts
	PLOT AREA (OC OBTAINED)	= 16251.598	HECTARE
	BALANCE PROPOSED PLOT AREA	= 24600.902	
2	GROUND COVERAGE		
	PERMISSIBLE GROUND COVERAGE @ 35% OF PLOT AREA	= 14298.375	Sq Mts
	PROPOSED GROUND COVERAGE	= 2889.733	Sq Mts
	GROUND COVERAGE (OC OBTAINED)	= 3869.768	
	TOTAL GROUND COVERAGE (PROPOSED + OC OBTAINED + UNDER CONST.)	= 8577.588	
	TOTAL GROUND COVERAGE (PROPOSED + OC OBTAINED + UNDER CONST.)	= 20.996	%
3	FAR		
	PERMISSIBLE FAR @ 2.75 OF NET PLOT AREA	= 112344.375	Sq Mts
	TOTAL PROPOSED FAR (G1, G2, G3 + COMMERCIAL) (A)	= 18388.118	Sq Mts
	TOTAL UNDER CONSTRUCTION FAR (G11, G12, G14) (B)	= 28099.996	Sq Mts
	TOTAL FAR (OC OBTAINED AREA) (C)	= 65927.418	Sq Mts
	TOTAL PROPOSED FAR (D) = (A+B+C)	= 112342.383	Sq Mts
	TOTAL PROPOSED FAR (D) = (A+B+C)	= 2.750	
4	GREEN AREA		
	REQUIRED GREEN @ 50% OF (PLOT AREA - GROUND COVERAGE)	= 16137.456	Sq Mts
	PROPOSED GREEN	= 7872.730	Sq Mts
	GREEN AREA (OC OBTAINED)	= 8548.863	
	TOTAL GREEN AREA	= 16421.593	
	No OF TREES REQUIRED @ 1TREE/100 SQMT OF (PLOT AREA - GR. COV.)	= 322.749	Nos
	No OF TREES PROVIDED (above 2.0 mtr. Height)	= 438	Nos
5	DUS		
	TOTAL DUS	= 1292	NO.5
	TOTAL SERVANT ROOM	= 124	NO.5
	TOTAL DUS UNDER CONSTRUCTION	= 400	NO.5
	TOTAL DUS PROPOSED	= 160	NO.5
	TOTAL SERVANT ROOM PROPOSED	= 48	NO.5
	TOTAL DUS (OC OBTAINED)	= 732	NO.5
	TOTAL SERVANT DUS (OC OBTAINED)	= 76	NO.5
6	DENSITY		
	PERMISSIBLE DENSITY @ 1650 PERSONS/HACTARE	= 6740.663	Nos
	POPULATION @ 4.5 PERSONS/ DU	= 5814	Nos
	POPULATION OF SERVANT @ 2.25 PERSONS/ DU	= 279.00	Nos
	NO. OF PERSONS PROPOSED = (5814+279)	= 6093.00	Nos
	DENSITY PROPOSED	= 1491.463	PERSON/HACTARE
7	SERVICE AREA (Additional 15% of FAR)		
	PERMISSIBLE SERVICE AREA @ 15% OF FAR	= 16851.65625	Sq Mts
	PROPOSED AREA IN 15% FACILITY AREA FOR HOUSING = FIRE STAIR CASE AREA + LIFT LOBBY AREA + MUMTY AREA + MACHINE ROOM AREA + LIFT SHAFTS + SERVICES SHAFTS + CUPBOARD + GUARD ROOM + OVER HEAD TANK + DRIVER'S REST ROOM + STP (OC OBTAINED AREA)	= 10441.491	
	PROPOSED AREA IN 15% FACILITY AREA FOR HOUSING = FIRE STAIR CASE AREA + LIFT LOBBY AREA + MUMTY AREA + MACHINE ROOM AREA + LIFT SHAFTS + SERVICES SHAFTS + CUPBOARD + GUARD ROOM + OVER HEAD TANK + DRIVER'S REST ROOM + STP (UNDER CONSTRUCTION AREA) (K)	= 3400.948	
	PROPOSED AREA IN 15% FACILITY AREA FOR HOUSING = FIRE STAIR CASE AREA + LIFT LOBBY AREA + MUMTY AREA + MACHINE ROOM AREA + LIFT SHAFTS + SERVICES SHAFTS + CUPBOARD + GUARD ROOM + OVER HEAD TANK + DRIVER'S REST ROOM + STP (PROPOSED SERVICE AREA) (R)	= 2935.486	SQ.MT
	TOTAL SERVICE AREA (E)	= 16777.925	Sq Mts
	ACHIEVED FOR FACILITY - PERMISSIBLE FOR FACILITY (16851.656-16669.762)	= 73.391	SQ.MT
	EXTRA AREA TO BE CALCULATED IN FAR	= NIL	SQ.MT
	PERMISSIBLE COMMERCIAL @ 1% OF 2.75 FAR	= 1123.444	SQ.MT
	TOTAL PROPOSED COMMERCIAL	= 1120.87	SQ.MT
	TOTAL PROPOSED COMMUNITY	= 1279.278	SQ.MT
8	PARKING		
	RESIDENTIAL ECS REQUIRED @ 1 ECS PER 80 SQ.MT./ECS	= 1404.305	Nos
	TOTAL ECS REQUIRED	= 1404.305	Nos
	ECS PROPOSED	= 1303	Nos
9	BASEMENT AREA		
	TOTAL BASEMENT AREA (OC OBTAINED + PROPOSED)	= 27234.613	Sq Mts
	BASEMENT AREA (OC OBTAINED)	= 16521.962	Sq Mts
	PROPOSED BASEMENT AREA (S)	= 5494.610	Sq Mts
	PROPOSED BASEMENT AREA UNDER CONSTRUCTION (Z)	= 3817.967	Sq Mts
10	PROPOSED BASEMENT PARKING AREA	= 24288.469	Sq Mts
	PERMISSIBLE ECS IN BASEMENT @ 1 ECS/ 30 Sq Mts	= 809.616	Nos
	BASEMENT PARKING AREA (OC OBTAINED)	= 13407.427	
	PERMISSIBLE ECS IN BASEMENT @ 1 ECS/ 30 Sq Mts (OC OBTAINED)	= 446.914	
	OC OBTAINED ECS	= 471	Nos
	PROPOSED ECS	= 132	Nos
	TOTAL ECS	= 603	Nos
11	PROPOSED STILT PARKING AREA (TOWER AREA) (Q)	= 1720.178	Sq Mts
	STILT PARKING AREA (TOWER AREA) (OC OBTAINED)	= 3497.309	Sq Mts
	STILT AREA (TOWER UNDER CONSTRUCTION) (Z)	= 1122.813	Sq Mts
	TOTAL PROPOSED STILT PARKING AREA (TOWER AREA)	= 6470.954	Sq Mts
	PERMISSIBLE ECS IN STILT (TOWER AREA) @ 1 ECS/ 30 Sq Mts	= 215.698	Nos
	PROPOSED ECS IN STILT (TOWER AREA)	= 205	Nos
	PROPOSED ECS IN STILT (TOWER AREA) (OC OBTAINED)	= 109	
	TOTAL ECS IN STILT (TOWER AREA) (PROPOSED + OC OBTAINED)	= 314	
12	PROPOSED STILT PARKING AREA (NON - TOWER AREA) (T)	= 2180.731	Sq Mts
	STILT PARKING AREA (NON - TOWER AREA) (OC OBTAINED)	= 7793.384	Sq Mts
	TOTAL STILT UNDER CONSTRUCTION PARKING AREA (NON - TOWER AREA)	= 3435.836	
	TOTAL PROPOSED STILT PARKING AREA (NON - TOWER AREA) (PROPOSED + OC OBTAINED)	= 13282.979	Sq Mts
	PERMISSIBLE ECS IN STILT (NON - TOWER AREA) @ 1 ECS/ 30 Sq Mts	= 442.766	Nos
	PROPOSED ECS IN STILT (NON - TOWER AREA)	= 71	Nos
	ECS IN STILT (NON - TOWER AREA) (OC OBTAINED)	= 168	
	TOTAL ECS IN STILT (NON - TOWER AREA) (PROPOSED + OC OBTAINED)	= 239	
	TOTAL PROPOSED ECS IN STILT (BOTH TOWER & NON - TOWER)	= 350	Nos
13	PROPOSED SURFACE PARKING AREA	= 6765.690	Sq Mts
	PERMISSIBLE ECS IN SURFACE @ 1 ECS / 20Sq Mts	= 338.285	Nos
	SURFACE PROPOSED ECS	= 350	Nos
	TOTAL ECS PROVIDED	= 1506	Nos
14	COVERED AREA (UNDER CONSTRUCTION)		
	TOTAL UNDER CONSTRUCTION AREA (FAR AREA + SERVICE AREA + BASEMENT AREA (W))	= 35318.911	Sq Mts
15	TOTAL COVERED AREA (PROPOSED + UNDER CONSTRUCTION)	= 66028.034	Sq Mts
16	PROPOSED TOTAL COVERED AREA = FAR AREA + SERVICE AREA + BASEMENT AREA + PROPOSED STILT (TOWER AREA) + PROPOSED STILT (NON-TOWER AREA)	= A+R+S+Q+T	Sq Mts
	PROPOSED TOTAL COVERED AREA (Y)	= 30709.123	Sq Mts

GROUND COVERAGE CALCULATION FOR TOWERS																	
TOWERS	TOWER -G1 (SQM)	TOWER -G2 (SQM)	TOWER -G3 (SQM)	TOWER -G6 (SQM)	TOWER -G7 (SQM)	TOWER -G8 (SQM)	TOWER -G9 (SQM)	TOWER -G10 (SQM)	TOWER -G11 (SQM)	TOWER -G12 (SQM)	TOWER -G14 (SQM)	COMMERCIAL (SQM)	COMMUNITY (SQM)	GUARD ROOM (SQM)			
				OC OBTAINED	OC OBTAINED	OC OBTAINED	OC OBTAINED	OC OBTAINED	OC OBTAINED	OC OBTAINED	OC OBTAINED						
GROUND COVERAGE	862.435	1213.800	407.894	500.484	684.603	771.039	684.603	530.999	668.040	657.852	657.852	502.383	405.604	30.000			
TOTAL GROUND COVERAGE														8577.588			
TOTAL GROUND COVERAGE																	
TOWERS	TOWER -G1 (SQM)	TOWER -G2 (SQM)	TOWER -G3 (SQM)	TOWER -G6 (SQM)	JOINING AREA (SQM)	TOWER -G7 (SQM)	JOINING AREA (SQM)	TOWER -G8 (SQM)	TOWER -G9 (SQM)	JOINING AREA (SQM)	TOWER -G10 (SQM)	JOINING AREA (SQM)	TOWER -G11 (SQM)	TOWER -G12 (SQM)	TOWER -G14 (SQM)	(SQM)	(SQM)
STILT/PODIUM	84.204	117.015	41.119	123.797		112.889		162.224	112.889		129.920		75.982	75.982	75.982	618.487	1730.490
1ST FLOOR	783.203	1133.758	381.269	411.072		641.892		616.060	641.892		462.705		560.632	560.632	560.632	502.383	7256.120
2nd FLOOR	783.203	1133.758	381.269	438.979	5.280	569.943	5.280	669.966	569.943	8.230	474.361	16.860	558.891	558.891	558.891		6723.735
3rd FLOOR	783.203	1133.758	381.269	421.942	5.280	569.943	5.280	669.966	569.943	8.230	458.723	16.860	558.891	558.891	558.891		6691.060
4th FLOOR	783.203	1133.758	381.269	421.942	5.280	569.943	5.280	669.966	569.943	8.230	458.723	16.860	558.891	558.891	558.891		6691.060
5th FLOOR	783.203			421.942		569.943		669.966	569.943		458.723		558.891	558.891	558.891		5140.393
6th FLOOR	783.203			421.942		569.943		669.966	569.943		458.723		558.891	558.891	558.891		5140.393
7th FLOOR	783.203			421.942		569.943		669.966	569.943		458.723		558.891	558.891	558.891		5140.393
8th FLOOR	783.203			421.942		569.943		669.966	569.943		458.723		558.891	558.891	558.891		5140.393
9th FLOOR	783.203			421.942		569.943		669.966	569.943		458.723		558.891	558.891	558.891		5140.393
10th FLOOR	783.203			421.942		569.943		669.966	569.943		458.723		558.891	558.891	558.891		5140.393
11th FLOOR	783.203			421.942		569.943		669.966	569.943		458.723		558.891	558.891	558.891		5140.393
12th FLOOR	783.203			421.942		569.943		669.966	569.943		458.723		558.891	558.891	558.891		5140.393
13th FLOOR	783.203			421.942		569.943		669.966	569.943		458.723		558.891	558.891	558.891		5140.393
14th FLOOR	783.203			421.942		569.943		669.966	569.943		458.723		558.891	558.891	558.891		5140.393
15th FLOOR				421.942		569.943		669.966	569.943		458.723		558.891	558.891	558.891		4357.190
16th FLOOR				421.942		569.943		669.966	569.943		458.723		558.891	558.891	558.891		4357.190
17th FLOOR				421.942		569.943		669.966	569.943		458.723		558.891	558.891	558.891		4357.190
18th FLOOR				421.942		569.943		669.966	569.943		458.723		558.891	558.891	558.891		4357.190
19th FLOOR				421.942		569.943		669.966	569.943		458.723		558.891	558.891	558.891		4357.190
20th FLOOR				421.942		569.943		669.966	569.943		458.723		558.891	558.891	558.891		4357.190
21st FLOOR													558.891	558.891	558.891		1676.673
22nd FLOOR													558.891	558.891	558.891		1676.673
23rd FLOOR													558.891	558.891	558.891		1676.673
24th FLOOR													558.891	558.891	558.891		1676.673
25th FLOOR													558.891	558.891	558.891		1676.673
TOTAL	11049.046	4652.047	1566.155	8146.862	15.840	11013.755	15.840	12657.672	11013.755	24.690	8865.277	50.580	14049.998	14049.998	14049.998	1120.870	0.000
TOTAL FAR																	
SERVICE AREA 15% (NON FAR) FOR TOWERS G1 TO G14																	
TOWERS	TOWER -G1 (SQM)	TOWER -G2 (SQM)	TOWER -G3 (SQM)	TOWER -G6 (SQM)	TOWER -G7 (SQM)	TOWER -G8 (SQM)	TOWER -G9 (SQM)	TOWER -G10 (SQM)	TOWER -G11 (SQM)	TOWER -G12 (SQM)	TOWER -G14 (SQM)	TOTAL (SQM)					
PLUMBING SHAFT	14.016	25.484	12.742	3.385	6.831	2.983	6.831	4.617	349.752	13.452	13.452	453.545					
SERVICE SHAFT	10.219	0.000	0.000	3.398	3.068	4.191	3.068	3.082	78.598	3.023	3.023	111.970					
METER ROOM	0.000	0.000	0.000	0	0.000	0.000	0.000	0.000	0.000	0.000	0.000	80.784					
MACHINE ROOM	30.973	19.975	9.988	66.579	50.303	48.752	50.303	36.817	45.326	45.326	45.326	449.668					
MUMTY	144.329	117.094	58.547	74.335	81.285	96.101	81.285	71.449	82.788	82.788	82.788	972.789					
OVERHEAD TANK	40.032	74.215	37.108	37.028	29.960	43.711	29.960	28.902	57.984	57.984	57.984	494.868					
FIRE STAIRCASE	264.989	0.000	379.320	378.876	336.600	378.600	378.600	326.376	432.353	432.353	432.353	3361.820					
LIFT LOBBY	234.887	96.865	24.160	303.860	284.660	307.380	284.660	242.460	340.600	340.587	340.587	2800.606					
CUPBOARD	78.156	49.920	24.960	134.834													