

site plan
(Scale - 1:1500)

AREA STATEMENT		
DESCRIPTION	AREA IN SQ. MT.	AREA %
TOTAL SITE AREA (BY SALE DEED)	= 62910.00	
AREA LEFT FOR OZONE BUILDERS FUTURE EXTENSION	= 971.82	
AREA LEFT FOR SANCTIONED MAP NO.-10/15(12-13)_PHASE-3	= 8577.13	
AREA LEFT FOR GREEN BELT / ROAD	= 5378.79	
AREA LEFT FOR CONFRA REALTECH PVT. LTD.	= 7100.00	
SITE AREA WITH EXISTING PLOTS AREA FOR REVISION & EXISTING ROAD AREA IN SANCTIONED MAP NO.-10/15(12-13)_PHASE-3 AND PROPOSED LAYOUT	= 40882.26	
EXISTING ROAD AREA PART OF SANCTIONED MAP NO.-10/15(12-13)_PHASE-3	= 885.64	
NET SITE AREA	= 39996.62	100.00 %
TOTAL AREA ACHIEVED IN PLOTTING	= 23271.55	58.18 %
SHOPS / COMMERCIAL	= 286.86	00.72 %
TOTAL GREEN AREA	= 6020.88	15.05 %
AREA UNDER ROAD	= 10417.33	26.05 %
EXISTING PLOTS AREA FOR REVISION PART OF SANCTIONED MAP NO.-10/15(12-13)_PHASE-3	= 2157.23	

Plot No.	Pavement	Abutting Road	Front		Side		Rear		Coverage	FAR
			Reqt	Prop	Reqt	Prop	Reqt	Prop		
1040	EXISTING	10.00 mt	2.00	-	-	-	2.00	-	0.00	0.00
1041	EXISTING	10.00 mt	2.00	-	-	-	2.00	-	0.00	0.00
1042	EXISTING	10.00 mt	2.00	-	-	-	2.00	-	0.00	0.00
1043	EXISTING	10.00 mt	2.00	-	-	-	2.00	-	0.00	0.00
1044	EXISTING	10.00 mt	2.00	-	-	-	2.00	-	0.00	0.00
1045	EXISTING	10.00 mt	2.00	-	-	-	2.00	-	0.00	0.00
1046	EXISTING	10.00 mt	2.00	-	-	-	2.00	-	0.00	0.00
1047	EXISTING	10.00 mt	2.00	-	-	-	2.00	-	0.00	0.00
1048	EXISTING	10.00 mt	2.00	-	-	-	2.00	-	0.00	0.00
1049	EXISTING	10.00 mt	2.00	-	-	-	2.00	-	0.00	0.00
1050	EXISTING	10.00 mt	2.00	-	-	-	2.00	-	0.00	0.00
1051	EXISTING	10.00 mt	2.00	-	-	-	2.00	-	0.00	0.00
1052	EXISTING	10.00 mt	2.00	-	-	-	2.00	-	0.00	0.00
1053	EXISTING	10.00 mt	2.00	-	-	-	2.00	-	0.00	0.00
1054	EXISTING	10.00 mt	2.00	-	-	-	2.00	-	0.00	0.00
1055	EXISTING	10.00 mt	2.00	-	-	-	2.00	-	0.00	0.00
1056	EXISTING	10.00 mt	2.00	-	-	-	2.00	-	0.00	0.00
1057	EXISTING	10.00 mt	2.00	-	-	-	2.00	-	0.00	0.00
1058	EXISTING	10.00 mt	2.00	-	-	-	2.00	-	0.00	0.00
1059	EXISTING	10.00 mt	2.00	-	-	-	2.00	-	0.00	0.00
1060	EXISTING	10.00 mt	2.00	-	-	-	2.00	-	0.00	0.00
1061	EXISTING	10.00 mt	2.00	-	-	-	2.00	-	0.00	0.00
1062	EXISTING	10.00 mt	2.00	-	-	-	2.00	-	0.00	0.00
1063	EXISTING	10.00 mt	2.00	-	-	-	2.00	-	0.00	0.00
1064	EXISTING	10.00 mt	2.00	-	-	-	2.00	-	0.00	0.00
1065	EXISTING	10.00 mt	2.00	-	-	-	2.00	-	0.00	0.00
1066	EXISTING	10.00 mt	2.00	-	-	-	2.00	-	0.00	0.00
1067	EXISTING	10.00 mt	2.00	-	-	-	2.00	-	0.00	0.00
1068	EXISTING	10.00 mt	2.00	-	-	-	2.00	-	0.00	0.00
1069	EXISTING	10.00 mt	2.00	-	-	-	2.00	-	0.00	0.00
1070	EXISTING	10.00 mt	2.00	-	-	-	2.00	-	0.00	0.00
1071	EXISTING	10.00 mt	2.00	-	-	-	2.00	-	0.00	0.00
1072	EXISTING	10.00 mt	2.00	-	-	-	2.00	-	0.00	0.00
1073	EXISTING	10.00 mt	2.00	-	-	-	2.00	-	0.00	0.00
1074	EXISTING	10.00 mt	2.00	-	-	-	2.00	-	0.00	0.00
1075	EXISTING	10.00 mt	2.00	-	-	-	2.00	-	0.00	0.00
1076	EXISTING	10.00 mt	2.00	-	-	-	2.00	-	0.00	0.00
1077	EXISTING	10.00 mt	2.00	-	-	-	2.00	-	0.00	0.00
1078	EXISTING	10.00 mt	2.00	-	-	-	2.00	-	0.00	0.00
1079	EXISTING	10.00 mt	2.00	-	-	-	2.00	-	0.00	0.00
1080	EXISTING	10.00 mt	2.00	-	-	-	2.00	-	0.00	0.00
1081	EXISTING	10.00 mt	2.00	-	-	-	2.00	-	0.00	0.00
1082	EXISTING	10.00 mt	2.00	-	-	-	2.00	-	0.00	0.00
1083	EXISTING	10.00 mt	2.00	-	-	-	2.00	-	0.00	0.00
1084	EXISTING	10.00 mt	2.00	-	-	-	2.00	-	0.00	0.00
1085	EXISTING	10.00 mt	2.00	-	-	-	2.00	-	0.00	0.00
1086	EXISTING	10.00 mt	2.00	-	-	-	2.00	-	0.00	0.00
1087	EXISTING	10.00 mt	2.00	-	-	-	2.00	-	0.00	0.00
1088	EXISTING	10.00 mt	2.00	-	-	-	2.00	-	0.00	0.00
1089	EXISTING	10.00 mt	2.00	-	-	-	2.00	-	0.00	0.00
1090	EXISTING	10.00 mt	2.00	-	-	-	2.00	-	0.00	0.00
1091	EXISTING	10.00 mt	2.00	-	-	-	2.00	-	0.00	0.00
1092	EXISTING	10.00 mt	2.00	-	-	-	2.00	-	0.00	0.00
1093	EXISTING	10.00 mt	2.00	-	-	-	2.00	-	0.00	0.00
1094	EXISTING	10.00 mt	2.00	-	-	-	2.00	-	0.00	0.00
1095	EXISTING	10.00 mt	2.00	-	-	-	2.00	-	0.00	0.00
1096	EXISTING	10.00 mt	2.00	-	-	-	2.00	-	0.00	0.00
1097	EXISTING	10.00 mt	2.00	-	-	-	2.00	-	0.00	0.00
1098	EXISTING	10.00 mt	2.00	-	-	-	2.00	-	0.00	0.00
1099	EXISTING	10.00 mt	2.00	-	-	-	2.00	-	0.00	0.00
1100	EXISTING	10.00 mt	2.00	-	-	-	2.00	-	0.00	0.00
1101	EXISTING	10.00 mt	2.00	-	-	-	2.00	-	0.00	0.00
1102	EXISTING	10.00 mt	2.00	-	-	-	2.00	-	0.00	0.00
1103	EXISTING	10.00 mt	2.00	-	-	-	2.00	-	0.00	0.00
1104	EXISTING	10.00 mt	2.00	-	-	-	2.00	-	0.00	0.00
1105	EXISTING	10.00 mt	2.00	-	-	-	2.00	-	0.00	0.00
1106	EXISTING	10.00 mt	2.00	-	-	-	2.00	-	0.00	0.00
1107	EXISTING	10.00 mt	2.00	-	-	-	2.00	-	0.00	0.00
1108	EXISTING	10.00 mt	2.00	-	-	-	2.00	-	0.00	0.00
1109	EXISTING	10.00 mt	2.00	-	-	-	2.00	-	0.00	0.00
1110	EXISTING	10.00 mt	2.00	-	-	-	2.00	-	0.00	0.00
1111	EXISTING	10.00 mt	2.00	-	-	-	2.00	-	0.00	0.00
1112	EXISTING	10.00 mt	2.00	-	-	-	2.00	-	0.00	0.00
1113	EXISTING	10.00 mt	2.00	-	-	-	2.00	-	0.00	0.00
1114	EXISTING	10.00 mt	2.00	-	-	-	2.00	-	0.00	0.00
1115	EXISTING	10.00 mt	2.00	-	-	-	2.00	-	0.00	0.00
1116	EXISTING	10.00 mt	2.00	-	-	-	2.00	-	0.00	0.00
1117	EXISTING	10.00 mt	2.00	-	-	-	2.00	-	0.00	0.00
1118	EXISTING	10.00 mt	2.00	-	-	-	2.00	-	0.00	0.00
1119	EXISTING	10.00 mt	2.00	-	-	-	2.00	-	0.00	0.00
1120	EXISTING	10.00 mt	2.00	-	-	-	2.00	-	0.00	0.00
1121	EXISTING	10.00 mt	2.00	-	-	-	2.00	-	0.00	0.00
1122	EXISTING	10.00 mt	2.00	-	-	-	2.00	-	0.00	0.00

Plot No.	Area	Front	Side	Rear	Coverage	FAR
1040	10.00 mt	2.00	-	-	2.00	0.00
1041	10.00 mt	2.00	-	-	2.00	0.00
1042	10.00 mt	2.00	-	-	2.00	0.00
1043	10.00 mt	2.00	-	-	2.00	0.00
1044	10.00 mt	2.00	-	-	2.00	0.00
1045	10.00 mt	2.00	-	-	2.00	0.00
1046	10.00 mt	2.00	-	-	2.00	0.00
1047	10.00 mt	2.00	-	-	2.00	0.00
1048	10.00 mt	2.00	-	-	2.00	0.00
1049	10.00 mt	2.00	-	-	2.00	0.00
1050	10.00 mt	2.00	-	-	2.00	0.00
1051	10.00 mt	2.00	-	-	2.00	0.00
1052	10.00 mt	2.00	-	-	2.00	0.00
1053	10.00 mt	2.00	-	-	2.00	0.00
1054	10.00 mt	2.00	-	-	2.00	0.00
1055	10.00 mt	2.00	-	-	2.00	0.00
1056	10.00 mt	2.00	-	-	2.00	0.00
1057	10.00 mt	2.00	-	-	2.00	0.00
1058	10.00 mt	2.00	-	-	2.00	0.00
1059	10.00 mt	2.00	-	-	2.00	0.00
1060	10.00 mt	2.00	-	-	2.00	0.00
1061	10.00 mt	2.00	-	-	2.00	0.00
1062	10.00 mt	2.00	-	-	2.00	0.00
1063	10.00 mt	2.00	-	-	2.00	0.00
1064	10.00 mt	2.00	-	-	2.00	0.00
1065	10.00 mt	2.00	-	-	2.00	0.00
1066	10.00 mt	2.00	-	-	2.00	0.00
1067	10.00 mt	2.00	-	-	2.00	0.00
1068	10.00 mt	2.00	-	-	2.00	0.00
1069	10.00 mt	2.00	-	-	2.00	0.00
1070	10.00 mt	2.00	-	-	2.00	0.00
1071	10.00 mt	2.00	-	-	2.00	0.00
1072	10.00 mt	2.00	-	-	2.00	0.00
1073	10.00 mt	2.00	-	-	2.00	0.00
1074	10.00 mt	2.00	-	-	2.00	0.00
1075	10.00 mt	2.00	-	-	2.00	0.00
1076	10.00 mt	2.00	-	-	2.00	0.00
1077	10.00 mt	2.00	-	-	2.00	0.00
1078	10.00 mt	2.00	-	-	2.00	0.00
1079	10.00 mt	2.00	-	-	2.00	0.00
1080	10.00 mt	2.00	-	-	2.00	0.00
1081	10.00 mt	2.00	-	-	2.00	0.00
1082	10.00 mt	2.00	-	-	2.00	0.00
1083	10.00 mt	2.00	-	-	2.00	0.00
1084	10.00 mt	2.00	-	-	2.00	0.00
1085	10.00 mt	2.00	-	-	2.00	0.00
1086	10.00 mt	2.00	-	-	2.00	0.00
1087	10.00 mt	2.00	-	-	2.00	0.00
1088	10.00 mt	2.00	-	-	2.00	0.00
1089	10.00 mt	2.00	-	-	2.00	0.00
1090	10.00 mt	2.00	-	-	2.00	0.00
1091	10.00 mt	2.00	-	-	2.00	0.00
1092	10.00 mt	2.00	-	-	2.00	0.00
1093	10.00 mt	2.00	-	-	2.00	0.00
1094	10.00 mt	2.00	-	-	2.00	0.00
1095	10.00 mt	2.00	-	-	2.00	0.00
1096	10.00 mt	2.00	-	-	2.00	0.00
1097						

PLOT NO.	PLOT SIZE		PLOT AREA	NO. OF PLOT	PROPOSED AREA FOR REVISION ALREADY EXISTING IN MAP NO.-10/15(12-13)_PHASE-3	PLOT AREA IN PROPOSED LAYOUT PLAN, PHASE-6	NO OF UNITS	
	W	L						
D-276	8.13	16.72	135.93	1	107.39	28.54		
D-277	8.13	16.72	135.93	1	64.37	71.56	2.00	
D-278	8.13	16.72	135.93	1	44.46	91.47	2.00	
D-279	8.13	16.72	135.93	1	25.05	110.89	2.00	
D-280	8.13	16.72	135.93	1	6.06	129.87	2.00	
D-282	8.13	16.72	135.93	1	49.22	86.72	2.00	
D-298	6.00	16.72	100.32	1	54.47	45.85	2.00	
D-308	6.00	16.72	100.32	1	14.60	85.72	2.00	
D-309	6.00	16.72	100.32	1	44.87	55.45	2.00	
D-310	6.00	16.72	100.32	1	75.13	25.19		
D-311	6.00	16.72	100.32	1	97.76	2.56		
D-323	6.00	16.72	100.32	1	95.11	5.21		
D-324	7.50	16.72	125.40	1	90.01	35.39		
D-325	7.50	16.72	125.40	1	56.56	68.84	2.00	
D-326	7.50	16.72	125.40	1	23.11	102.29	2.00	
D-327	7.50	16.72	125.40	1	0.61	124.79	2.00	
D-340	7.50	16.72	125.40	1	5.57	119.83	2.00	
D-341	7.50	16.72	125.40	1	104.84	20.56		
D-353	6.00	16.72	100.32	1	94.87	5.45		
D-354	7.50	16.72	125.40	1	20.79	104.61	2.00	
D-376	6.00	16.72	100.32	1	0.98	99.34	2.00	
D-377	6.00	16.72	100.32	1	17.18	83.14	2.00	
D-378	6.00	16.72	100.32	1	38.59	61.73	2.00	
D-380	10.45	14.16	147.97	1	90.52	57.46		
D-381	8.54	15.67	133.82	1	74.95	58.87		
D-382	8.54	15.67	133.82	1	72.38	61.44		
D-383	8.54	15.67	133.82	1	120.12	13.70		
D-412	8.54	15.67	133.82	1	129.61	4.21		
D-412A	8.54	15.67	133.82	1	6.47	127.36	2.00	
D-423	8.54	15.67	133.82	1	3.93	129.89	2.00	
D-424	8.54	15.67	133.82	1	28.68	105.15	2.00	
D-425	8.54	15.67	133.82	1	56.47	77.35	2.00	
D-426	8.54	15.67	133.82	1	84.27	49.56		
D-427	8.54	15.67	133.82	1	112.06	21.76		
D-428	8.54	15.67	133.82	1	132.71	1.11		
D-431	8.54	15.67	133.82	1	72.49	61.33	2.00	
D-432	8.54	15.67	133.82	1	33.83	99.99	2.00	
D-433	8.54	15.67	133.82	1	7.15	126.67	2.00	
				4718.08	38	2157.23	2560.85	44.00

NOTE:- EWS & LIG BUILDINGS FOR UNITS-32 (PLOTS NO. _D-276,D-310,D-311,D323,D-324,D-341,D-353,D-380,D-381,D382,D-383,D-412,D-426,D-427,D-428 & D-431) HAVE BEEN ALREADY CONSTRUCTED IN MAP NO.-10/15(12-13)_PHASE-3

AREA DETAILS

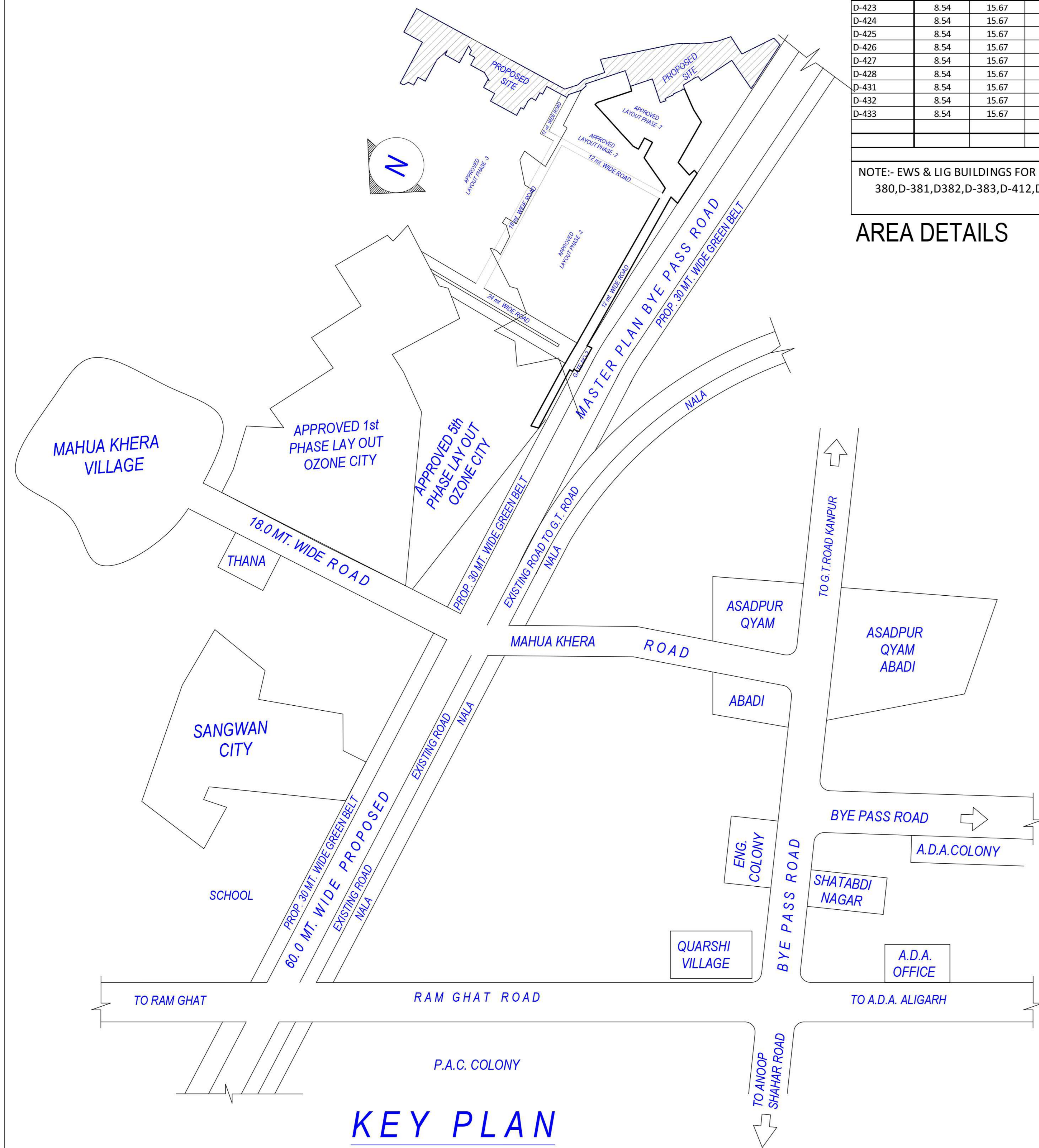

KEY PLAN

Note: - 1) This drawing is prepared as per the current prevailing Building Bye Laws.
 2) If Map sanctioned is used for purpose anything other than stated in application will lead to rejection of Map.

PLOT NO.	Plot Area	Frontage	Coverage	FSI Area	Individual Plot Area				
					Plot Area	Frontage			
D423	9.00 mt	40.00	133.82	3.50	4.00	0.00	0.00	0.00	0.00
D424	9.00 mt	40.00	133.82	3.50	4.00	0.00	0.00	0.00	0.00
D425	9.00 mt	40.00	133.82	3.50	4.00	0.00	0.00	0.00	0.00
D426	9.00 mt	40.00	133.82	3.50	4.00	0.00	0.00	0.00	0.00
D427	9.00 mt	40.00	133.82	3.50	4.00	0.00	0.00	0.00	0.00
D428	9.00 mt	40.00	133.82	3.50	4.00	0.00	0.00	0.00	0.00
D429	9.00 mt	40.00	133.82	3.50	4.00	0.00	0.00	0.00	0.00
D430	9.00 mt	40.00	133.82	3.50	4.00	0.00	0.00	0.00	0.00
D431	9.00 mt	40.00	133.82	3.50	4.00	0.00	0.00	0.00	0.00
D432	9.00 mt	40.00	133.82	3.50	4.00	0.00	0.00	0.00	0.00
D433	9.00 mt	40.00	133.82	3.50	4.00	0.00	0.00	0.00	0.00
D434	9.00 mt	40.00	133.82	3.50	4.00	0.00	0.00	0.00	0.00
D435	9.00 mt	40.00	133.82	3.50	4.00	0.00	0.00	0.00	0.00
D436	9.00 mt	40.00	133.82	3.50	4.00	0.00	0.00	0.00	0.00
D437	9.00 mt	40.00	133.82	3.50	4.00	0.00	0.00	0.00	0.00
D438	9.00 mt	40.00	133.82	3.50	4.00	0.00	0.00	0.00	0.00
D439	9.00 mt	40.00	133.82	3.50	4.00	0.00	0.00	0.00	0.00
D440	9.00 mt	40.00	133.82	3.50	4.00	0.00	0.00	0.00	0.00
D441	9.00 mt	40.00	133.82	3.50	4.00	0.00	0.00	0.00	0.00
D442	9.00 mt	40.00	133.82	3.50	4.00	0.00	0.00	0.00	0.00
D443	9.00 mt	40.00	133.82	3.50	4.00	0.00	0.00	0.00	0.00
D444	9.00 mt	40.00	133.82	3.50	4.00	0.00	0.00	0.00	0.00
D445	9.00 mt	40.00	133.82	3.50	4.00	0.00	0.00	0.00	0.00
D446	9.00 mt	40.00	133.82	3.50	4.00	0.00	0.00	0.00	0.00
D447	9.00 mt	40.00	133.82	3.50	4.00	0.00	0.00	0.00	0.00
D448	9.00 mt	40.00	133.82	3.50	4.00	0.00	0.00	0.00	0.00
D449	9.00 mt	40.00	133.82	3.50	4.00	0.00	0.00	0.00	0.00
D450	9.00 mt	40.00	133.82	3.50	4.00	0.00	0.00	0.00	0.00
D451	9.00 mt	40.00	133.82	3.50	4.00	0.00	0.00	0.00	0.00
D452	9.00 mt	40.00	133.82	3.50	4.00	0.00	0.00	0.00	0.00
D453	9.00 mt	40.00	133.82	3.50	4.00	0.00	0.00	0.00	0.00
D454	9.00 mt	40.00	133.82	3.50	4.00	0.00	0.00	0.00	0.00
D455	9.00 mt	40.00	133.82	3.50	4.00	0.00	0.00	0.00	0.00
D456	9.00 mt	40.00	133.82	3.50	4.00	0.00	0.00	0.00	0.00
D457	9.00 mt	40.00	133.82	3.50	4.00	0.00	0.00	0.00	0.00
D458	9.00 mt	40.00	133.82	3.50	4.00	0.00	0.00	0.00	0.00
D459	9.00 mt	40.00	133.82	3.50	4.00	0.00	0.00	0.00	0.00
D460	9.00 mt	40.00	133.82	3.50	4.00	0.00	0.00	0.00	0.00
D461	9.00 mt	40.00	133.82	3.50	4.00	0.00	0.00	0.00	0.00
D462	9.00 mt	40.00	133.82	3.50	4.00	0.00	0.00	0.00	0.00
D463	9.00 mt	40.00	133.82	3.50	4.00	0.00	0.00	0.00	0.00
D464	9.00 mt	40.00	133.82	3.50	4.00	0.00	0.00	0.00	0.00
D465	9.00 mt	40.00	133.82	3.50	4.00	0.00	0.00	0.00	0.00
D466	9.00 mt	40.00	133.82	3.50	4.00	0.00	0.00	0.00	0.00
D467	9.00 mt	40.00	133.82	3.50	4.00	0.00	0.00	0.00	0.00
D468	9.00 mt	40.00	133.82	3.50	4.00	0.00	0.00	0.00	0.00
D469	9.00 mt	40.00	133.82	3.50	4.00	0.00	0.00	0.00	0.00
D470	9.00 mt	40.00	133.82	3.50	4.00	0.00	0.00	0.00	0.00
D471	9.00 mt	40.00	133.82	3.50	4.00	0.00	0.00	0.00	0.00
D472	9.00 mt	40.00	133.82	3.50	4.00	0.00	0.00	0.00	0.00
D473	9.00 mt	40.00	133.82	3.50	4.00	0.00	0.00	0.00	0.00
D474	9.00 mt	40.00	133.82	3.50	4.00	0.00	0.00	0.00	0.00
D475	9.00 mt	40.00	133.82	3.50	4.00	0.00	0.00	0.00	0.00
D476	9.00 mt	40.00	133.82	3.50	4.00	0.00	0.00	0.00	0.00
D477	9.00 mt	40.00	133.82	3.50	4.00	0.00	0.00	0.00	0.00
D478	9.00 mt	40.00	133.82	3.50	4.00	0.00	0.00	0.00	0.00
D479	9.00 mt	40.00	133.82	3.50	4.00	0.00	0.00	0.00	0.00
D480	9.00 mt	40.00	133.82	3.50	4.00	0.00	0.00	0.00	0.00
D481	9.00 mt	40.00	133.82	3.50	4.00	0.00	0.00	0.00	0.00
D482	9.00 mt	40.00	133.82	3.50	4.00	0.00	0.00	0.00	0.00
D483	9.00 mt	40.00	133.82	3.50	4.00	0.00	0.00	0.00	0.00
D484	9.00 mt	40.00	133.82	3.50	4.00	0.00	0.00	0.00	0.00
D485	9.00 mt	40.00	133.82	3.50	4.00	0.00	0.00	0.00	0.00
D486	9.00 mt	40.00	133.82	3.50	4.00	0.00	0.00	0.00	0.00
D487	9.00 mt	40.00	133.82	3.50	4.00	0.00	0.00	0.00	0.00
D488	9.00 mt	40.00	133.82	3.50	4.00	0.00	0.00	0.00	0.00
D489	9.00 mt	40.00	133.82	3.50	4.00	0.00	0.00	0.00	0.00
D490	9.00 mt	40.00	133.82	3.50	4.00	0.00	0.00	0.00	0.00
D491	9.00 mt	40.00	133.82	3.50	4.00	0.00	0.00	0.00	0.00
D492	9.00 mt	40.00	133.82	3.50	4.00	0.00	0.00	0.00	0.00
D493	9.00 mt	40.00	133.82	3.50	4.00	0.00	0.00	0.00	0.00
D494	9.00 mt	40.00	133.82	3.50	4.00	0.00	0.00	0.00	0.00
D495	9.00 mt	40.00	133.82	3.50	4.00	0.00	0.00	0.00	0.00
D496	9.00 mt	40.00	133.82	3.50	4.00	0.00	0.00	0.00	0.00
D497	9.00 mt	40.00	133.82	3.50	4.00	0.00	0.00	0.00	0.00
D498	9.00 mt	40.00	133.82	3.50	4.00	0.00	0.00	0.00	0.00
D499	9.00 mt	40.00	133.82	3.50	4.00	0.00	0.00	0.00	0.00
D500	9.00 mt	40.00	133.82	3.50	4.00	0.00	0.00	0.00	0.00
D501	9.00 mt	40.00	133.82	3.50	4.00	0.00	0.00	0.00	0.00
D502	9.00 mt	40.00	133.82	3.50	4.00	0.00	0.00	0.00	0.00
D503	9.00 mt	40.00	133.82	3.50	4.00	0.00	0.00	0.00	0.00
D504	9.00 mt	40.00	133.82	3.50	4.00	0.00	0.00	0.00	0.00
D505	9.00 mt	40.00	133.82	3.50	4.00	0.00	0.00	0.00	0.00
D506	9.00 mt	40.00	133.82	3.50	4.00	0.00	0.00	0.00	0.00
D507	9.00 mt	40.00	133.82	3.50					



LEGEND	
ELECTRIC LINE / POLE	
RAIN WATER HARVESTING	
TUWELL / O.H. TANK S.PUMP	
WATER LINE	
NALI / DRAIN	

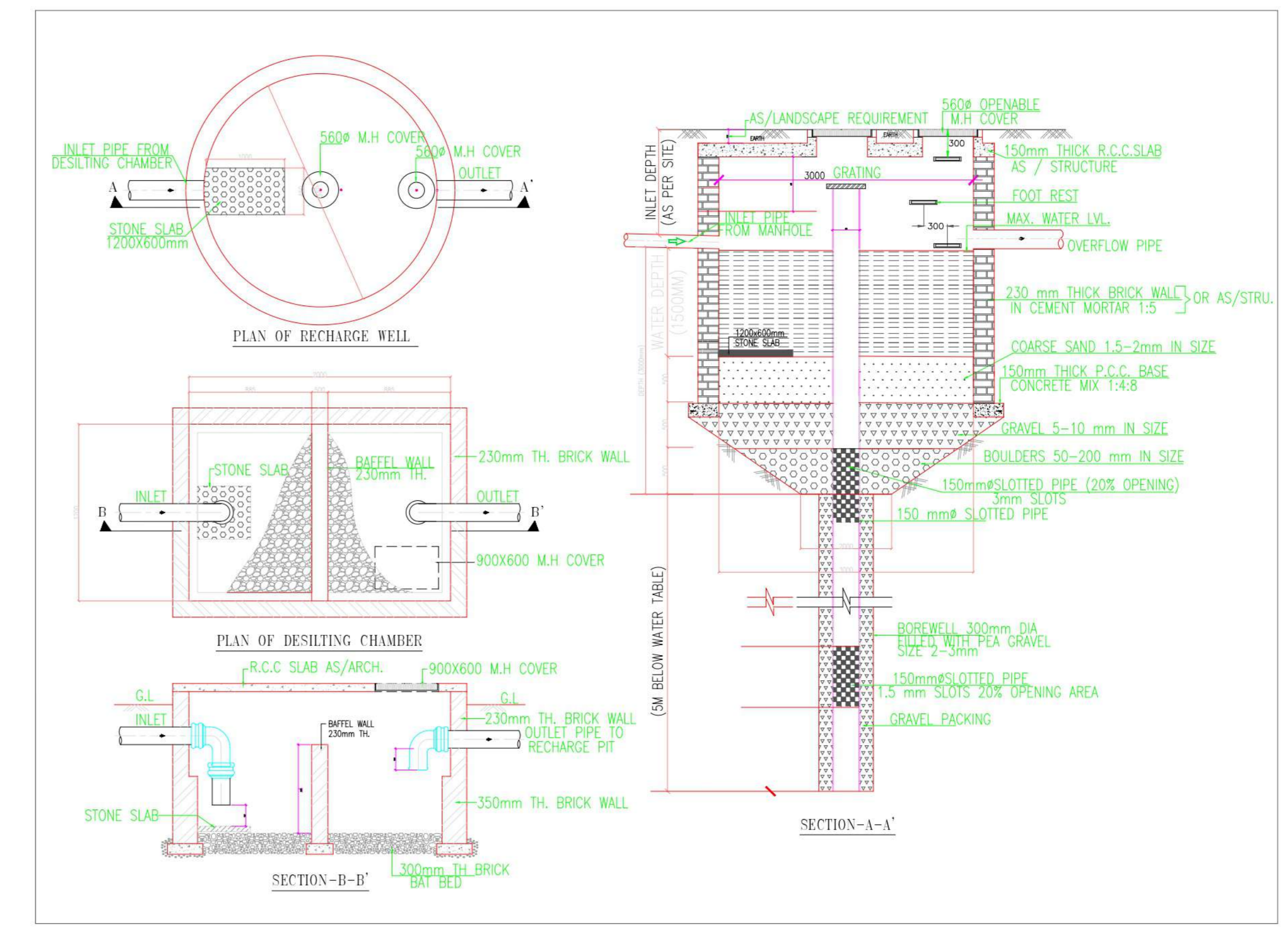

OWNER'S NAME AND SIGNATURE
 OZONE INFRAHEIGHT PRIVATE LIMITED, civil@ozonebuilders.com, 9238323265

ARCHITECT'S NAME AND SIGNATURE
 MANISH KUMAR SRIVASTAV, ARCHITECT

CAZ020119044
 100% COMPLETE
 11/05/2023
 Date: 11/05/2023
 10:08:53
 Designation: Architect

Aligarh Development Authority

Building Plan Application Number
 AGDA/LD23-24/0048

Sandtioned On
 01 Jul 2023

Valid Till
 12 Jul 2028

Approved By
 Anil Vats (Vice Chairman)

Examined By
 Anil Kumar Singh (Junior engineer)

ANJUM B (Secretary/ Executive Engineer)

Anil Vats (Vice Chairman)

Note: - 1) This drawing is prepared as per the current prevailing Building Bye Laws.
 2) If Map sanctioned is used for purpose anything other than stated in application will lead to rejection of Map.
 ISO_A0_(841.00_x_1189.00_MM)

Total Plot Area :-	39996.61	Total FAR Area :-	0.00
Total Coverage Area :-	0.00	Total BUA Area :-	0.00

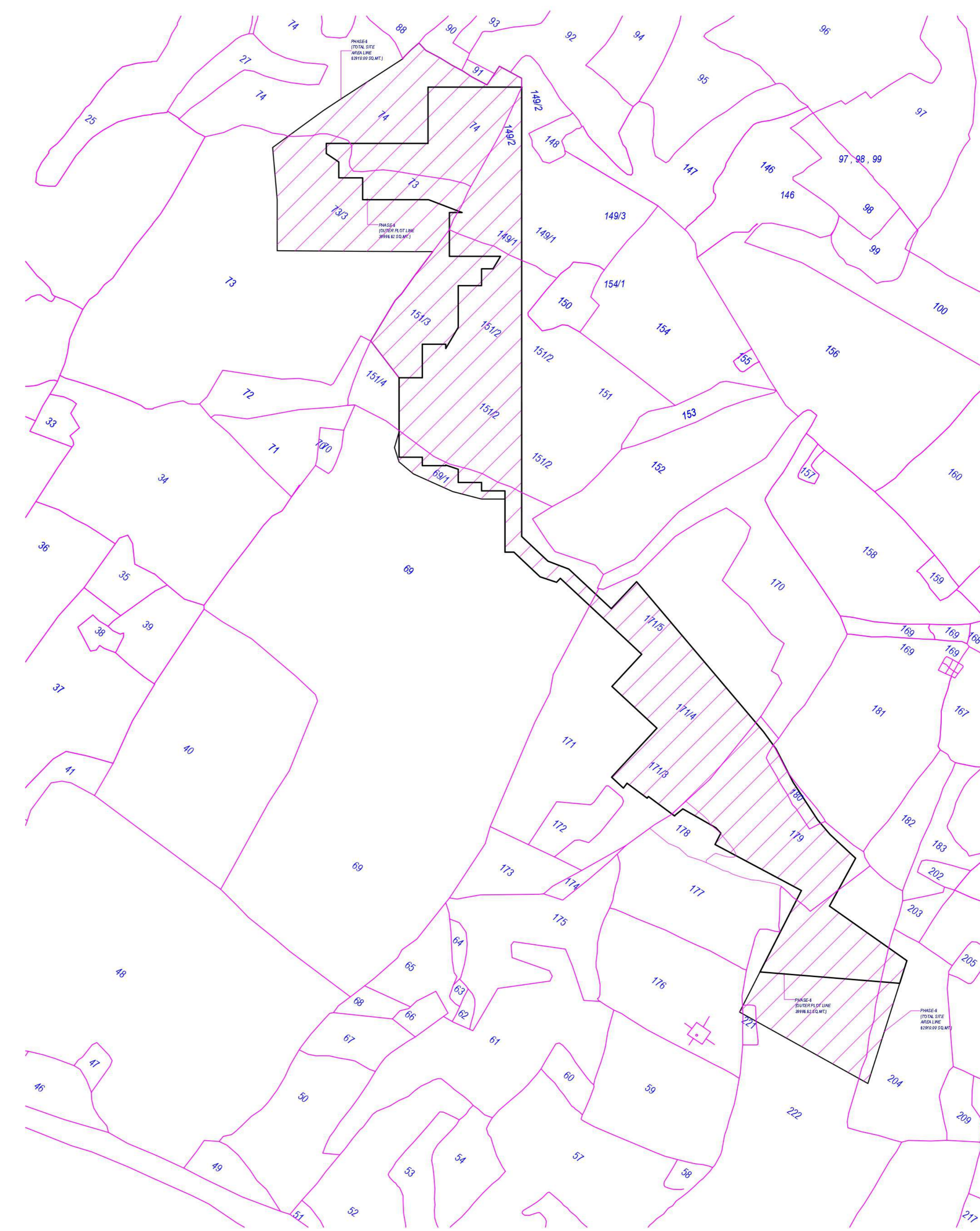
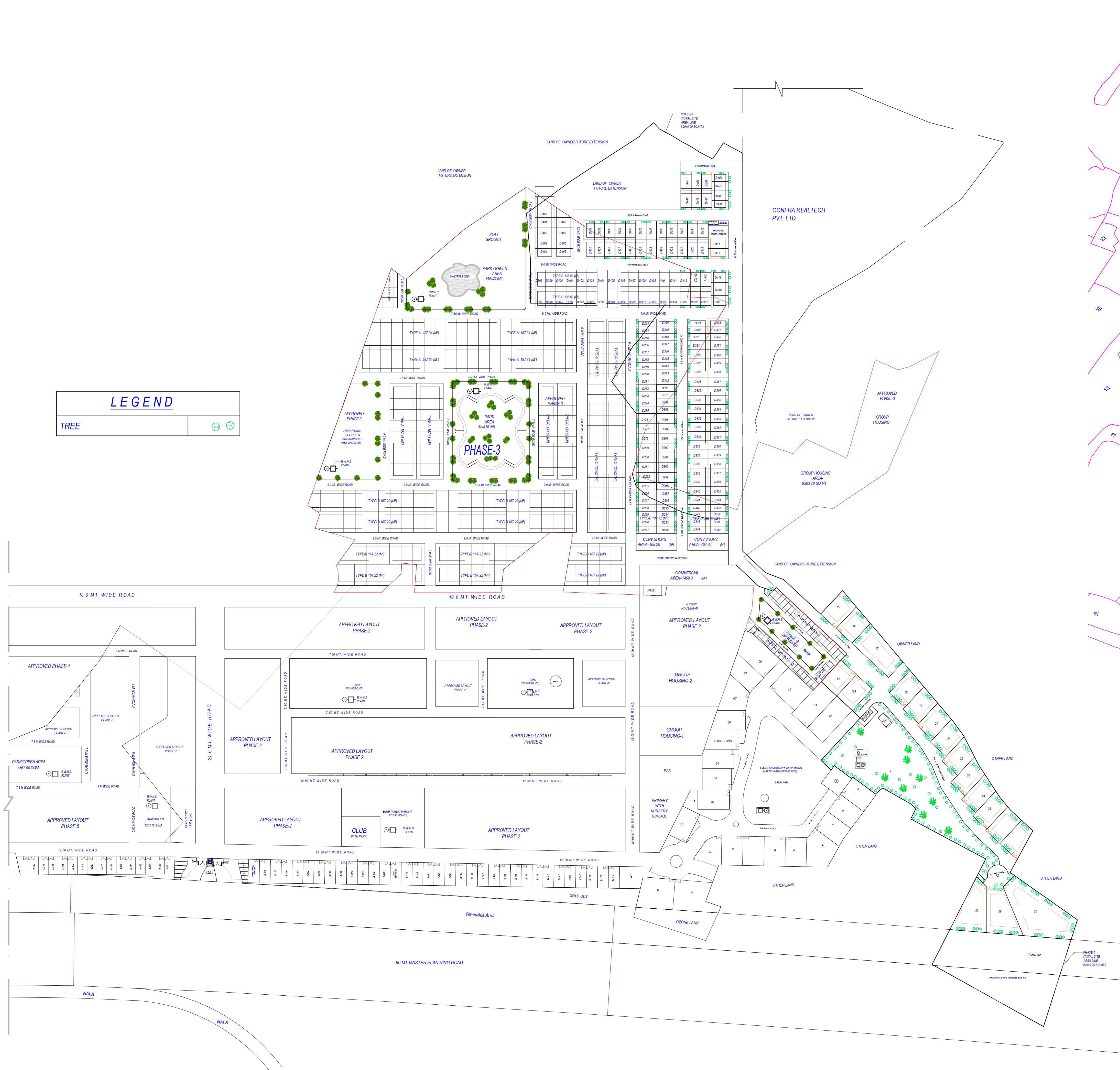

PART SAJARA PLAN OF VILLAGE YAQUT PUR, SHUING MASTER PLAN, (SCALE - NOT TO SCALE)

OWNER'S NAME AND SIGNATURE
 OZONE INFRAHEIGHT PRIVATE LIMITED, civil@ozonebuilders.com, 923632285

ARCHITECT'S NAME AND SIGNATURE
 MANISH KUMAR SRIVASTAV
 CAZ020119044
 12/05/2019
 10/05/2023
 11/05/2023
 12/05/2023
 13/05/2023
 14/05/2023
 15/05/2023
 16/05/2023
 17/05/2023
 18/05/2023
 19/05/2023
 20/05/2023
 21/05/2023
 22/05/2023
 23/05/2023
 24/05/2023
 25/05/2023
 26/05/2023
 27/05/2023
 28/05/2023
 29/05/2023
 30/05/2023
 31/05/2023
 01/06/2023
 02/06/2023
 03/06/2023
 04/06/2023
 05/06/2023
 06/06/2023
 07/06/2023
 08/06/2023
 09/06/2023
 10/06/2023
 11/06/2023
 12/06/2023
 13/06/2023
 14/06/2023
 15/06/2023
 16/06/2023
 17/06/2023
 18/06/2023
 19/06/2023
 20/06/2023
 21/06/2023
 22/06/2023
 23/06/2023
 24/06/2023
 25/06/2023
 26/06/2023
 27/06/2023
 28/06/2023
 29/06/2023
 30/06/2023
 01/07/2023
 02/07/2023
 03/07/2023
 04/07/2023
 05/07/2023
 06/07/2023
 07/07/2023
 08/07/2023
 09/07/2023
 10/07/2023
 11/07/2023
 12/07/2023
 13/07/2023
 14/07/2023
 15/07/2023
 16/07/2023
 17/07/2023
 18/07/2023
 19/07/2023
 20/07/2023
 21/07/2023
 22/07/2023
 23/07/2023
 24/07/2023
 25/07/2023
 26/07/2023
 27/07/2023
 28/07/2023
 29/07/2023
 30/07/2023
 31/07/2023
 01/08/2023
 02/08/2023
 03/08/2023
 04/08/2023
 05/08/2023
 06/08/2023
 07/08/2023
 08/08/2023
 09/08/2023
 10/08/2023
 11/08/2023
 12/08/2023
 13/08/2023
 14/08/2023
 15/08/2023
 16/08/2023
 17/08/2023
 18/08/2023
 19/08/2023
 20/08/2023
 21/08/2023
 22/08/2023
 23/08/2023
 24/08/2023
 25/08/2023
 26/08/2023
 27/08/2023
 28/08/2023
 29/08/2023
 30/08/2023
 31/08/2023
 01/09/2023
 02/09/2023
 03/09/2023
 04/09/2023
 05/09/2023
 06/09/2023
 07/09/2023
 08/09/2023
 09/09/2023
 10/09/2023
 11/09/2023
 12/09/2023
 13/09/2023
 14/09/2023
 15/09/2023
 16/09/2023
 17/09/2023
 18/09/2023
 19/09/2023
 20/09/2023
 21/09/2023
 22/09/2023
 23/09/2023
 24/09/2023
 25/09/2023
 26/09/2023
 27/09/2023
 28/09/2023
 29/09/2023
 30/09/2023
 01/10/2023
 02/10/2023
 03/10/2023
 04/10/2023
 05/10/2023
 06/10/2023
 07/10/2023
 08/10/2023
 09/10/2023
 10/10/2023
 11/10/2023
 12/10/2023
 13/10/2023
 14/10/2023
 15/10/2023
 16/10/2023
 17/10/2023
 18/10/2023
 19/10/2023
 20/10/2023
 21/10/2023
 22/10/2023
 23/10/2023
 24/10/2023
 25/10/2023
 26/10/2023
 27/10/2023
 28/10/2023
 29/10/2023
 30/10/2023
 31/10/2023
 01/11/2023
 02/11/2023
 03/11/2023
 04/11/2023
 05/11/2023
 06/11/2023
 07/11/2023
 08/11/2023
 09/11/2023
 10/11/2023
 11/11/2023
 12/11/2023
 13/11/2023
 14/11/2023
 15/11/2023
 16/11/2023
 17/11/2023
 18/11/2023
 19/11/2023
 20/11/2023
 21/11/2023
 22/11/2023
 23/11/2023
 24/11/2023
 25/11/2023
 26/11/2023
 27/11/2023
 28/11/2023
 29/11/2023
 30/11/2023
 01/12/2023
 02/12/2023
 03/12/2023
 04/12/2023
 05/12/2023
 06/12/2023
 07/12/2023
 08/12/2023
 09/12/2023
 10/12/2023
 11/12/2023
 12/12/2023
 13/12/2023
 14/12/2023
 15/12/2023
 16/12/2023
 17/12/2023
 18/12/2023
 19/12/2023
 20/12/2023
 21/12/2023
 22/12/2023
 23/12/2023
 24/12/2023
 25/12/2023
 26/12/2023
 27/12/2023
 28/12/2023
 29/12/2023
 30/12/2023
 31/12/2023

Building Plan Application Number
 AGDA/LD23-24/0048
 Sanctioned On
 01 Jul 2023
 Valid Till
 12 Jul 2028
 Approved By
 Anil Vats (Vice Chairman)
 Examined By
 Anil Kumar Singh (Junior engineer)
 ANJUM B (Secretary/ Executive Engineer)
 Anil Vats (Vice Chairman)

Note: - 1) This drawing is prepared as per the current prevailing Building Bye Laws.
 2) If Map sanctioned is used for purpose anything other than stated in application will lead to rejection of Map.

Total Plot Area: -	39996.61	Total FAR Area: -	0.00
Total Coverage Area: -	0.00	Total BUA Area: -	0.00