

AREA STATEMENT

PLOT AREA = 6012.84 SQMT.
 PERMISSIBLE F.A.R. (2.50) = 15032.10 SQMT.
 ALLOWED GROUND COVERAGE = 2104.49 SQMT.
 IN PERCENTAGE = 35 %
 COVD. AREA ON STILT FLOOR = 1491.62 SQMT.
 (STILT PARKING) IN PERCENTAGE = 24.80 %
 OPEN AREA ON GROUND FLOOR = 4521.22 SQMT.
 IN PERCENTAGE = 75.20 %
 COVD. AREA ON 1st. FL. = 1472.50 SQMT.
 COVD. AREA ON 2nd. FL. = 1472.50 SQMT.
 COVD. AREA ON 3rd. FL. = 1472.50 SQMT.
 COVD. AREA ON 4th. FL. = 1472.50 SQMT.
 COVD. AREA ON 5th. FL. = 1472.50 SQMT.
 COVD. AREA ON 6th. FL. = 1472.50 SQMT.
 COVD. AREA ON 7th. FL. = 1472.50 SQMT.
 COVD. AREA ON 8th. FL. = 1472.50 SQMT.
 COVD. AREA ON 9th. FL. = 1472.50 SQMT.
 COVD. AREA ON 10th. FL. = 1472.50 SQMT.
 LEFT AREA ON ONE FLOOR = 19.12 SQ.M
 MUMTY REGULAR STAIRS (02 NOS) = 85.20 SQMT.
 MUMTY FIRE ESCAPE (04 NOS) = 85.20 SQMT.
 TOTAL COVD. AREA UNDER F.A.R. = 14864.32 SQ.M
 PROPOSED F.A.R. = 2.472
 COVERED AREA UNDER NON F.A.R. AREAS
 COVD. AREA ON 1st BASEMENT = 2629.41 SQMT.
 COVD. AREA ON 2nd BASEMENT = 2629.41 SQMT.
 COVD. AREA ON G. F. (STILT) = 1491.62 SQMT.
 FIRE ESCAPE (STAIRCASE 01) = 213.00 SQMT.
 ALL FLOORS INCL. (21.30X10) = 213.00 SQMT.
 FIRE ESCAPE (STAIRCASE 02) = 213.00 SQMT.
 ALL FLOORS INCL. (21.30X10) = 213.00 SQMT.
 FIRE ESCAPE (STAIRCASE 03) = 213.00 SQMT.
 ALL FLOORS INCL. (21.30X10) = 213.00 SQMT.
 FIRE ESCAPE (STAIRCASE 04) = 213.00 SQMT.
 ALL FLOORS INCL. (21.30X10) = 213.00 SQMT.
 TOTAL COVD. AREA UNDER NON F.A.R. = 7699.36 SQ.M
 (TOTAL F.A.R. + NON F.A.R. AREAS) = 14864.32 SQ.M. + 7699.36 SQ.M = 22563.68 SQMT.
PARKING DETAIL:-
 PARKING REQUIRED (14864.32/65=228.68) = 229 ECS
 TWO WHEELER PARKING AREA ON 1st BASEMENT = 42 ECS
 TWO WHEELER PARKING AREA ON 2nd BASEMENT = 31 ECS
 TWO WHEELER PARKING AREA ON 3rd BASEMENT = 42 ECS
 TWO WHEELER PARKING AREA ON 4th BASEMENT = 31 ECS
 TWO WHEELER PARKING AREA ON 5th BASEMENT = 42 ECS
 TWO WHEELER PARKING AREA ON 6th BASEMENT = 31 ECS
 TWO WHEELER PARKING AREA ON 7th BASEMENT = 42 ECS
 TWO WHEELER PARKING AREA ON 8th BASEMENT = 31 ECS
 TWO WHEELER PARKING AREA ON 9th BASEMENT = 42 ECS
 TWO WHEELER PARKING AREA ON 10th BASEMENT = 31 ECS
 NOS OF CAR PROVIDED ON OPEN GROUND = 45 ECS
 TOTAL CAR PARKING PROVIDED = 243 ECS
 TREE DETAIL:-
 TOTAL TREE REQUIRED @ 1 ON EVERY 100 SQMT. = 61
 TOTAL TREE ACHIEVED @ 1 ON EVERY 100 SQMT. = 70
 PARK/GREEN AREA = 956.47 SQMT.
 BUILDING HEIGHT (INCLUDING MUMTY) = 34.975 M
 PERIMETER = 311.579 M
 ELECTRICAL LOAD = 500 KW
AS PER GOVT. POLICY:-
 TOTAL FLATS = 180
 E.W.S. REQUIRED (10%) = 18
 FLATS PROVIDED = 18
 L.I.G. REQUIRED (0%) = 18
 FLATS PROVIDED = 18
 E.W.S. (AREA-29.75 SQMT.) L.I.G.-(AREA-44.75 SQMT.)
 1st F. = 02 6th F. = 02
 2nd F. = 02 7th F. = 02
 3rd F. = 02 8th F. = 02
 4th F. = 02 9th F. = 02
 5th F. = 02 10th F. = 02
 TOTAL = 18
 L.I.G.-2-(AREA-58.00SQMT.) -10th F. = 06/TOTAL L.I.G. = 18

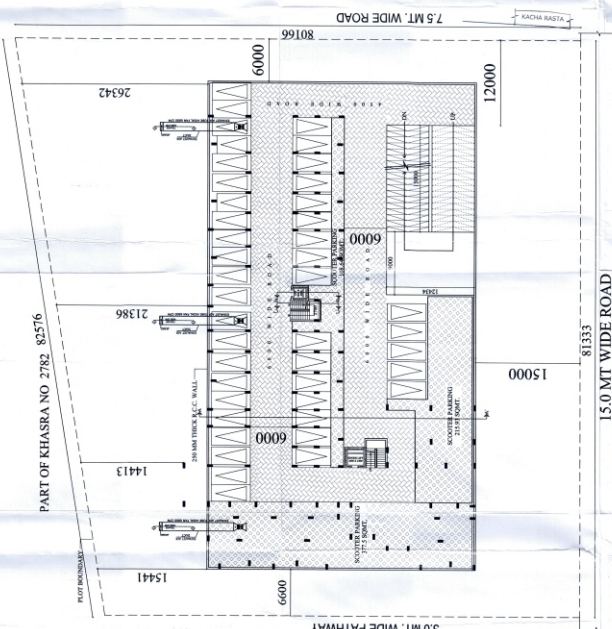

GROUND [STILT] FLOOR PLAN
 SCALE 1:200

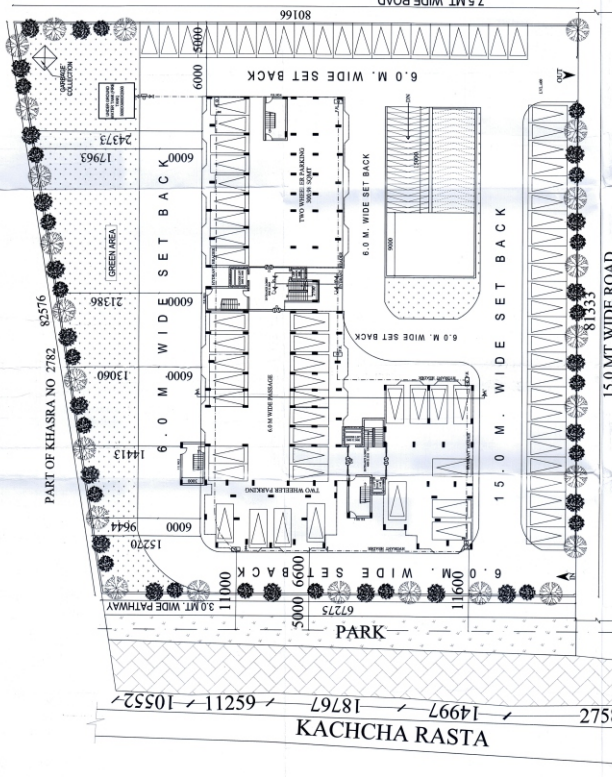

1st & 2nd BASEMENT FLOOR
 PLAN SCALE 1:200

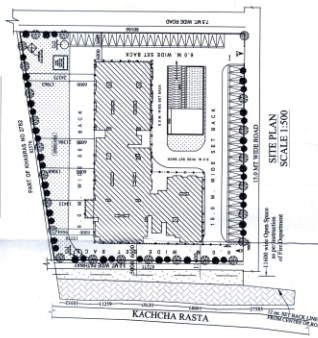

PART PORTION OF LAYOUT PLAN
 PLAN OF KALP CITY



PART PORTION OF LAYOUT PLAN
 PLAN OF KALP CITY

PROJECT : PROPOSED GROUP HOUSING FOR G.S.R. BUILDERS & DEVELOPERS PVT. LIMITED ON PROJECT KALP CITY, AT VILLAGE - BIJNOUR, PARGANA - BIJNOUR, TEHSIL & DISTT. - LUCKNOW.

DRG. TITLE : SUBMISSION DRAWING

SCALE : AS SHOWN SHEET NO. : (1/2)

DATE : 10/05/2016

DRAWN BY : TALHA

LEGEND FOR FIRE FIGHTING:
 FIRE EXTINGUISHER
 MANUALLY OPERATED ELECTRIC FIRE ALARM SYSTEM
 FHC FIRE HOSE CABINET
 DOWN COMER
 FIRE HYDRANT
 HYDRANT HEADER
 SLICICE VALVE

OWNER'S SIGN: AR. SUNIL SRIVASTAVA

ARCHITECT'S SIGN: SAHARA SHOPPING CENTRE

CONSULTANTS : SAHARA SHOPPING CENTRE
 414A & 425B 4TH FLOOR
 SAHARA SHOPPING CENTRE
 FAZLAD ROAD,LUCKNOW-226016
 TEL & FAX - 0522-2317746,4009712
 Website : www.saharashopping.com

NOTE:-
 AS PER GOVERNMENT NORMS:
 1. TWO E.W.S. HAVE BEEN PROVIDED ON EACH FLOOR EXCEPT TENTH FLOOR, TOTALING TO EIGHTEEN E.W.S.
 2. ONE L.I.G. HAS BEEN PROVIDED ON EACH FLOOR EXCEPT TENTH FLOOR, WHEREAS NINE L.I.G.S HAVE BEEN PROVIDED ON TENTH FLOOR, TOTALING TO EIGHTEEN L.I.G.