

CAMPUS LIGHTING WORK AT HIMALAYAN ENCLAVE, SECT-3 JAGRITI VIHAR YOJNA (EXIT) MEERUT

16

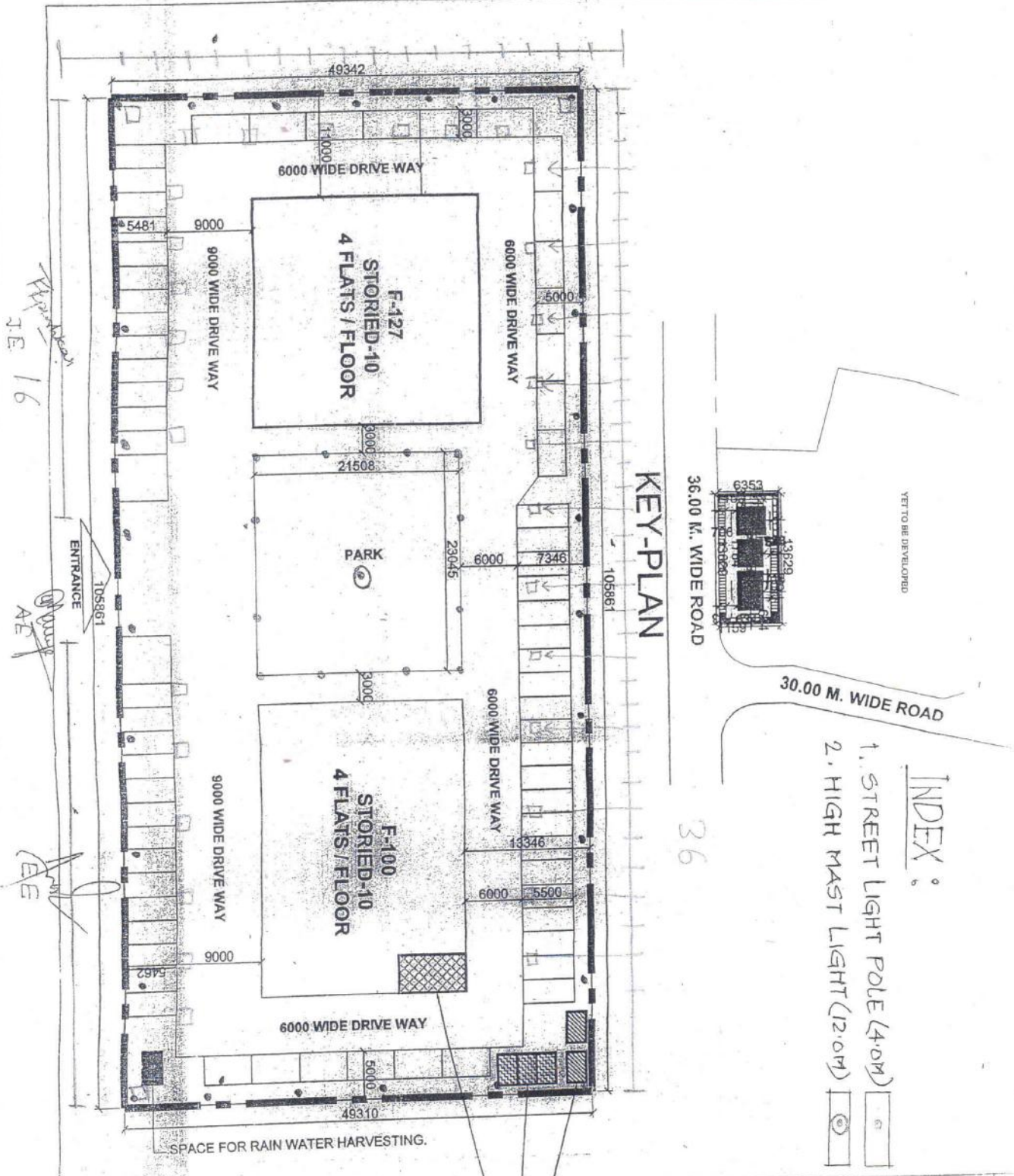

INDEX :

1. STREET LIGHT POLE (4.0M)
2. HIGH MAST LIGHT (12.0M)

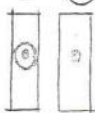

NOTE:

1. THIS PART LAY-OUT PLAN HAS BEEN PREPARED AS PER REQUEST MADE BY E.E., CD-05 MEERUT VIDE HIS LETTER NO. 1864/Y-17/275 DATED- 05.09.2016.
 2. THE ABOVE REQUEST HAS BEEN RECOMMENDED BY J.H.C VIDE HIS LETTER NO. 1127/Y-11/62 DATED 27.10.2016 & S.E. CIRCLE-2 VIDE HIS LETTER NO. 2270/SE-2/MEERUT/G-41 DATED 17.11.2016.
 3. FEASIBILITY AND CONCENT HAVE BEEN RECEIVED FROM E.E. CD-08 & E.E. ED-03 VIDE LETTER NO. 159 DATED 28-01-2017 & 158 DATED 15-02-2017
 RECEIPT:

Handwritten signature and date: 27/2/17

INDEX

- PLINTH FOR D.G.SET
- PLINTH FOR TRANSFORMER
- MAIN L.T. PANNEL & D.G PANNEL ROOM



PART I.O.P. OF SECTOR-03	
JAGRITI VIHAR, SCHEME NO. 11 MEERUT.	
ADVANCED SITE PLAN SHOWING CAMPUS FOR F-100 & F-127 (UNDER CONSTRUCTION)	
SCALE:	
DATE:	23.02.2016
V. B. PATRAK Dharmacharan	
SUBODH KUMAR Prakash, I.A.S.	
ANSHU ARCHITECT PLANNER	
SHARAD KUMAR CHIEF ARCHITECT PLANNER	
RUPAK MATHI SINGH I.A.S. ARCHITECT PLANNER	
ANAS MISHRA I.A.S. ARCHITECT PLANNER	