

परमिट नं- B.D.A./R.G.N.-5/151/1
 स्वीकृति दिनांक- 28-10-2024
 वैद्यता दिनांक- 27-10-2024

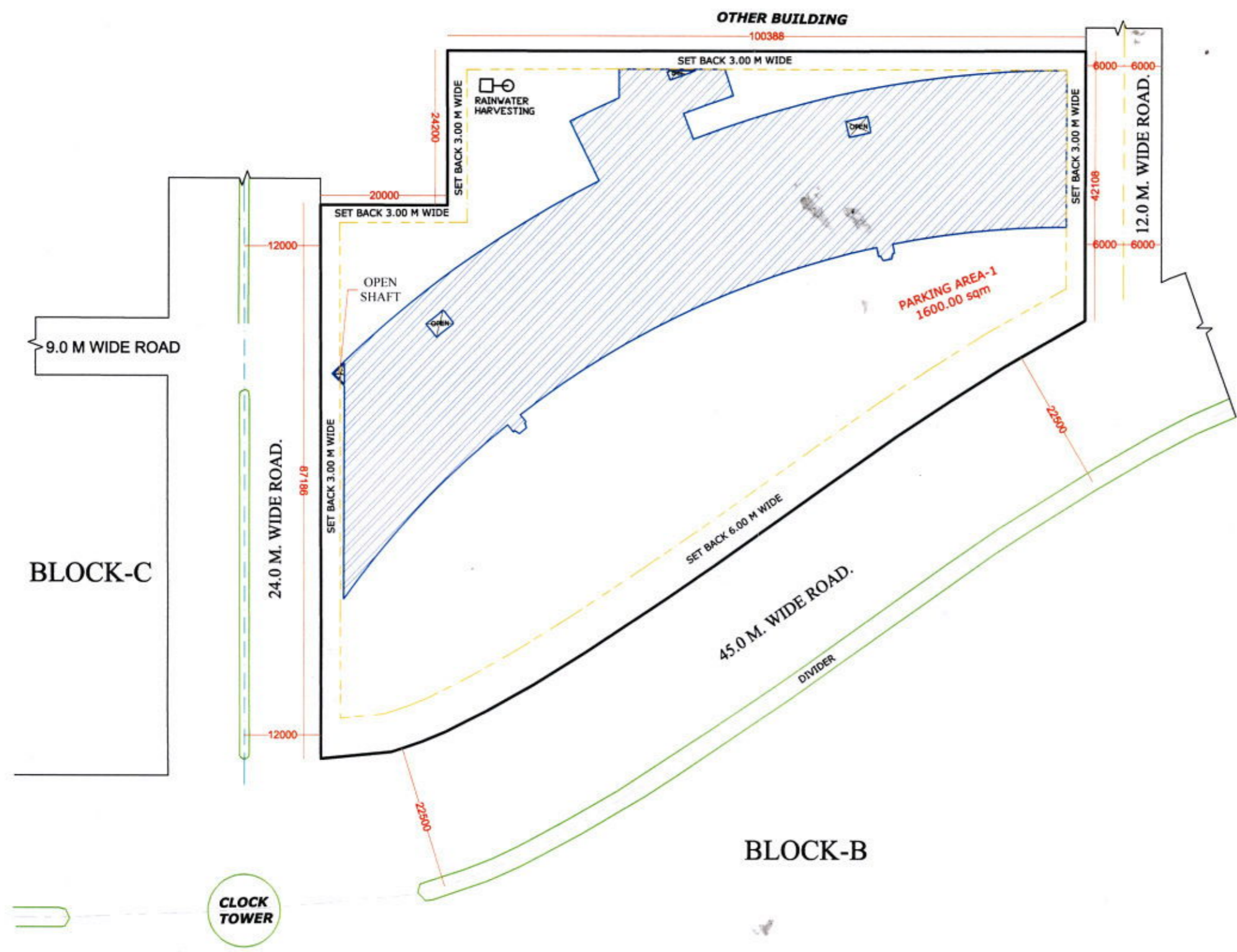

AREA STATEMENT	
TOTAL LAND AREA	= 9200.35 SqM
ALLOWABLE GROUND COVERAGE (50%)	= 4600.17 SqM
PROVIDED GROUND COVERAGE (36%)	= 3381.01 SqM
ALLOWABLE F.A.R (1.75)	= 16100.61 SqM
PROVIDED F.A.R (0.73)	= 6762.02 SqM
GROUND FLOOR	= 3381.01 SqM
FIRST FLOOR	= 3381.01 SqM
MUMMTY AREA	= 160.98 SqM
TOTAL COVD AREA ALL FLOORS	= 6923.00 SqM
PARKING REQUIRED 6762.02/100X1	= 68 ECS
PARKING PROVIDED	
PARKING AREA-1	= 1600.00 SqM

BUILDING PLAN FOR COMMERCIAL COMPLEX (BLOCK-A) AT SECTOR-5, RAMGANGA NAGAR SCHEME, BAREILLY

BAREILLY DEVELOPMENT AUTHORITY	
SCALE N.T.S.	SHET 1
	5
SITE PLAN	NORTH

SUMIT AGARWAL ARCHITECTS
 S/O: KAILASHAM, 714, JANAKPURI,
 Bareilly 243122
 Mob: 9837095138
 email: sumit.architects@gmail.com
 sumit.architects@yahoo.com
 Ar. Sumit Agarwal
 CA/99/24025

D/MAN	J.E. PLAN.	A.E. PLAN.	J.E. CONS.	A.E. CONS.
E.E.	C.T.P.	SEC.	V.C.	

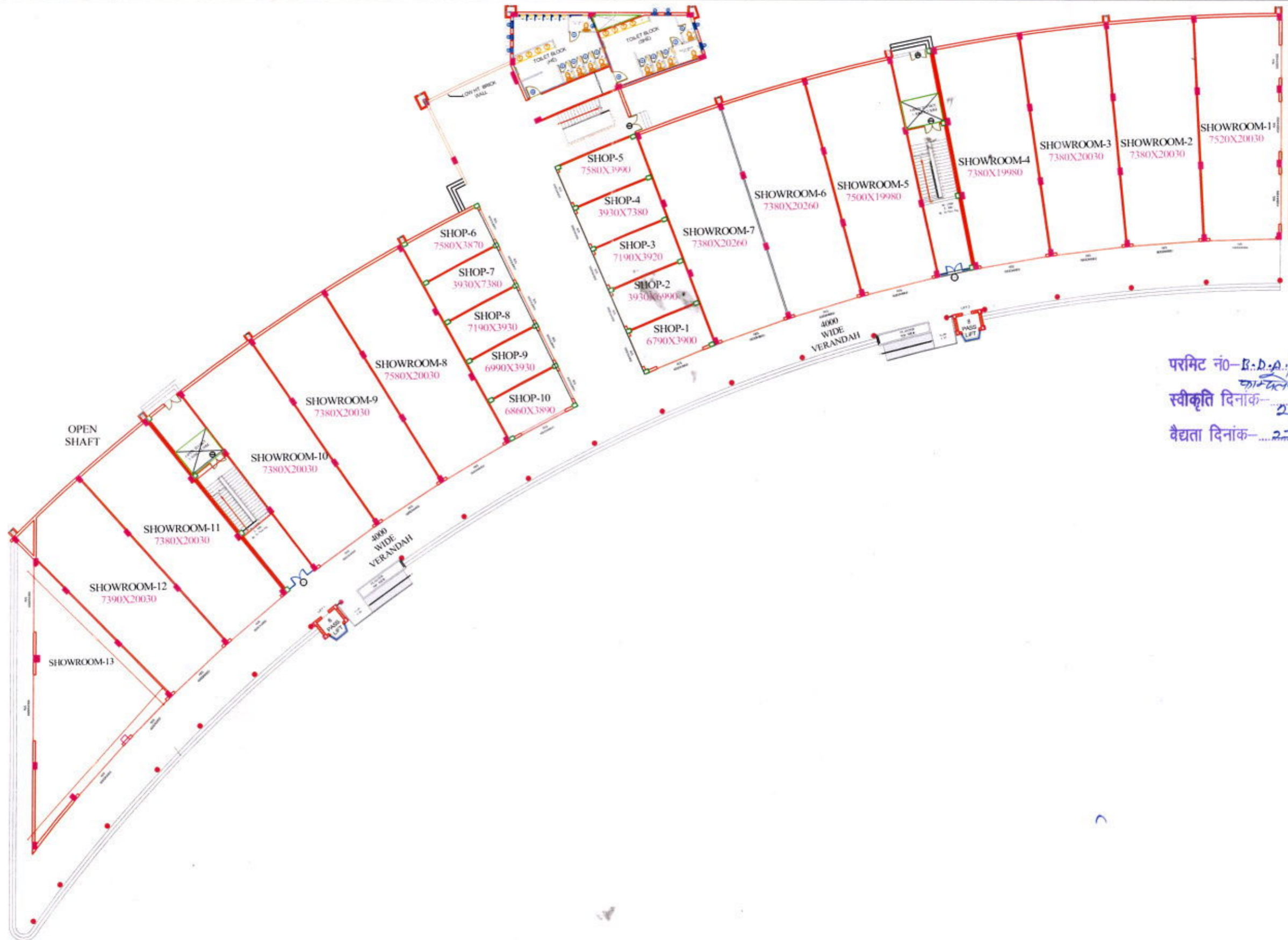

परमिट नं०-B.D.A./R.G.N.१ (5) 60
 स्वीकृति दिनांक- 28-10-2024
 वेद्यता दिनांक- 27-10-2024

**BUILDING PLAN FOR COMMERCIAL
 COMPLEX (BLOCK-A) AT SECTOR-5,
 RAMGANGA NAGAR SCHEME, BAREILLY**

GROUND FLOOR PLAN	BAREILLY DEVELOPMENT AUTHORITY		SUMIT AGARWAL ARCHITECTS Shri KAILASHAN, 714, JANAKPURI, Bareilly 243122 Mob: 9837095138 email: sumit.architects@gmail.com sumit.architects@yahoo.com					
	SCALE N.T.S.	SHET 2 5						
	NORTH							
	Ar. Sumit Agarwal CA/99/24025							

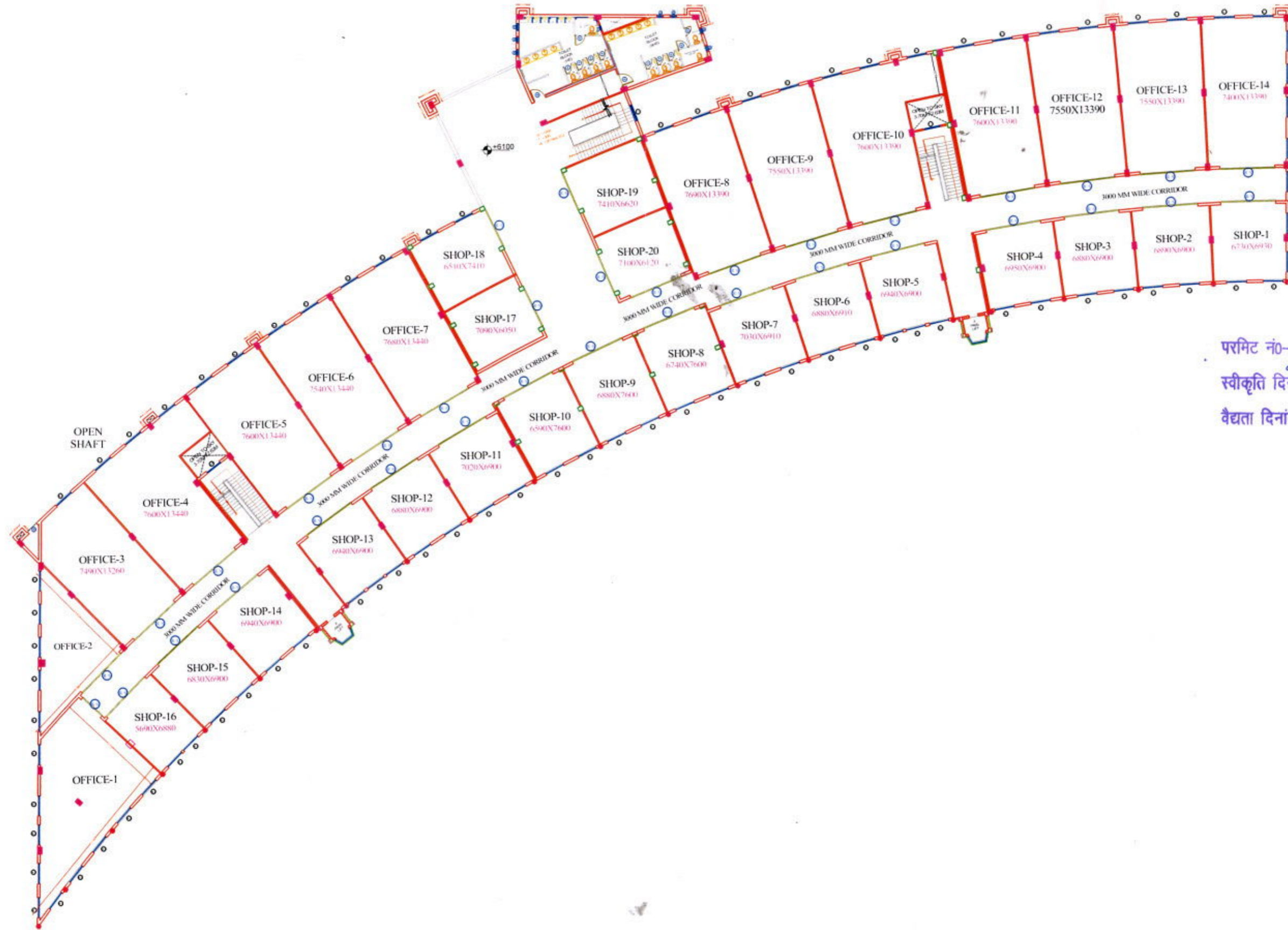

परमिट नं०-B.D.A./R.G.N.S. (5) कागशीफल
 स्वीकृति दिनांक- 28-10-2024
 वैद्यता दिनांक- 27-10-2024

BUILDING PLAN FOR COMMERCIAL COMPLEX (BLOCK-A) AT SECTOR-5, RAMGANGA NAGAR SCHEME, BAREILLY

FIRST FLOOR PLAN

BAREILLY DEVELOPMENT AUTHORITY

SCALE N.T.S.	SHET 3 5
------------------------	-----------------------

SUMIT AGARWAL ARCHITECTS
 Shri KAILASHAM, 714, JANAKPURI,
 Bareilly 243122
 Mob: 9837095138
 email: sumit.architects@gmail.com
 sumit.architects@yahoo.com

NORTH

Ar. Sumit Agarwal
 CA/99/24025

 D/MAN	 J.E. PLAN.	 A.E. PLAN.		

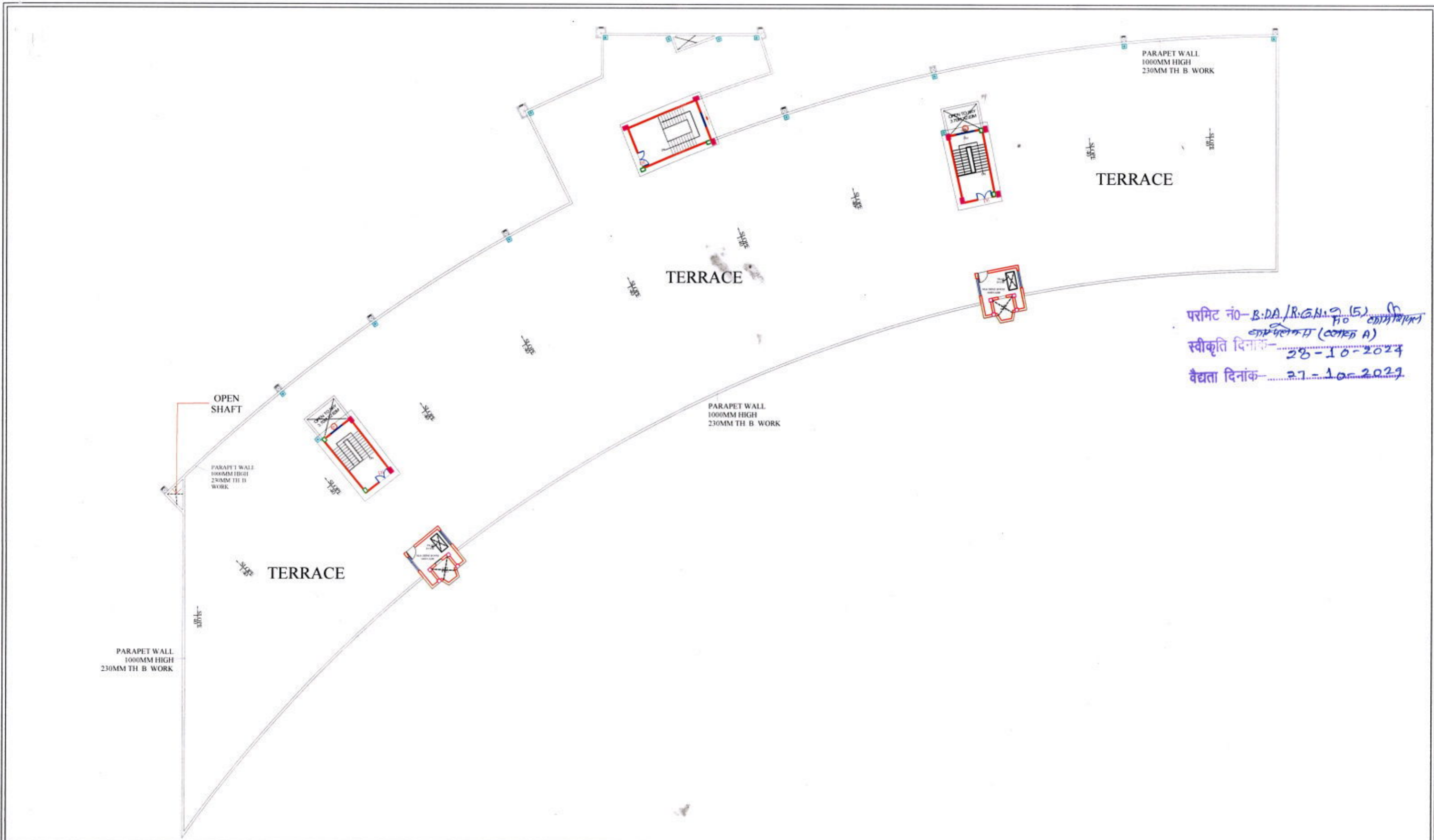

परमिट नं०-B:DA/R.G.N. 5 (5) काशीविपदा
 स्वीकृति दिनांक- 28-10-2024
 वैद्यता दिनांक- 27-10-2024

BUILDING PLAN FOR COMMERCIAL COMPLEX (BLOCK-A) AT SECTOR-5, RAMGANGA NAGAR SCHEME, BAREILLY

TERRACE FLOOR PLAN









BAREILLY DEVELOPMENT AUTHORITY

SCALE N.T.S.	SHET 4 5
------------------------	-----------------------

SUMIT AGARWAL ARCHITECTS
 Shri KAILASHAM, 714, JANAKPURI,
 Bareilly 243122
 Mob: 9837095138
 email: sumit.architects@gmail.com
 sumit.architects@yahoo.com

NORTH

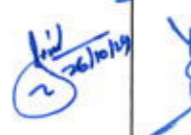
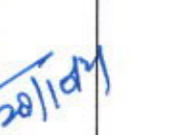
Ar. Sumit Agarwal
 CA/99/24025

 D/MAN	 J.E. PLAN.	 A.E. PLAN.	 J.E. CONS.	 A.E. CONS.
 E.E.	 C.T.P.	 SEC.	 V.E. 28/10	

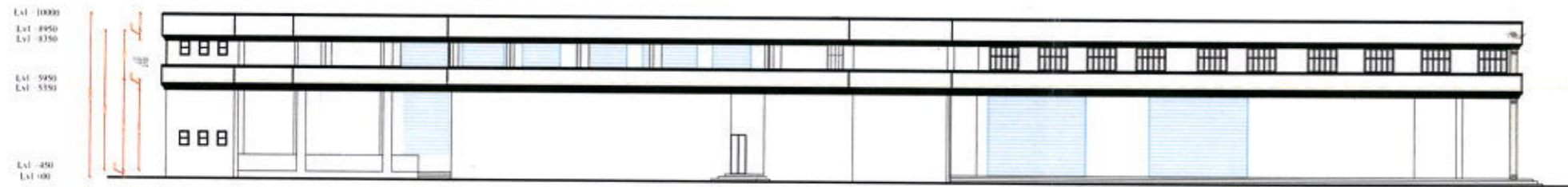

ELEVATION-A

PARAPET WALL
100MM HIGH
250MM TH H
WORK
PARAPET WALL
100MM HIGH
250MM TH H
WORK

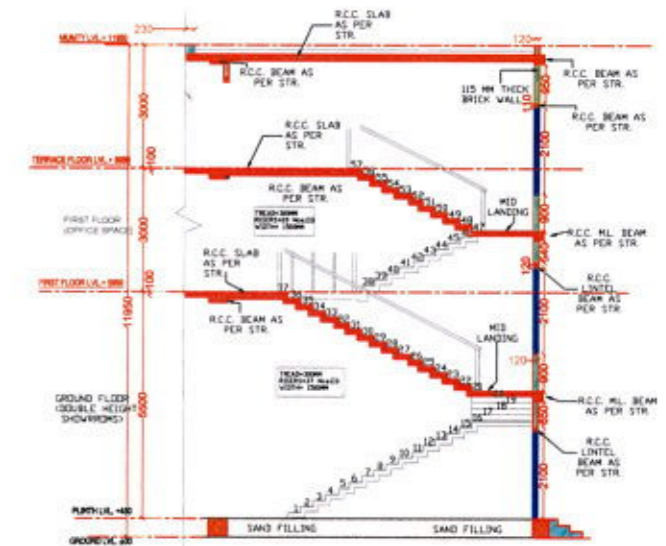

SECTION AT XX

PARAPET WALL
100MM HIGH
250MM TH H
WORK
PARAPET WALL
100MM HIGH
250MM TH H
WORK



ELEVATION-C

परमिट नं०- B.D.A./R.G.N. से 152 कृपया शिवाजी
कॉम्प्लेक्स (ब्लॉक - A)
स्वीकृति दिनांक- 28-10-2024
वैधता दिनांक- 27-10-2029



ELEVATION-B

PARAPET WALL
100MM HIGH
250MM TH H
WORK
PARAPET WALL
100MM HIGH
250MM TH H
WORK

**BUILDING PLAN FOR COMMERCIAL
COMPLEX (BLOCK-A) AT SECTOR-5,
RAMGANGA NAGAR SCHEME, BAREILLY**

ELEVATION-A,
ELEVATION-B,
ELEVATION-C &
SECTION AT XX

BAREILLY DEVELOPMENT AUTHORITY

SCALE
N.T.S.











SHEET

5
5

NORTH

SUMIT AGARWAL ARCHITECTS
Shri KAILASHAN, 714, JANAKPURI,
Bareilly 243122
Mob: 9837095138
email: sumit.architects@gmail.com
sumit.architects@yahoo.com

Ar. Sumit Agarwal
CA/99/24025

 D.J. MAN	 J.E. PLAN.	 A.E. PLAN.	 J.E. CONS.	 A.E. CONS.
 E.E.	 C.T.P.	 SEC.	 V.D.	 28/10