

**NOTES:-**  
 1. ALL DIMENSIONS ARE IN MM.  
 2. ALL DIMENSIONS ARE TO BE READ AND NOT MEASURED.  
 3. ANY DISCREPANCIES MUST BE BROUGHT TO THE NOTICE OF THE CONSULTANT BEFORE EXECUTION OF WORK AT SITE.  
 4. THIS DRAWING MUST BE READ IN CONJUNCTION WITH ALL RELEVANT ARCHITECTURAL, STRUCTURAL, PLUMBING, FIRE FIGHTING AND ELECTRICAL DRAWINGS.  
 5. THIS DRAWING IS THE SOLE PROPERTY OF MODARCHINDIA. IT SHOULD NOT BE USED, COPIED, REPRODUCED IN ANY MANNER WITHOUT THE PRIOR PERMISSION OF MODARCHINDIA.  
 6. ARCHITECTURAL DRAWING SHOULD BE FOLLOWED FOR ALL DIMENSIONS & LEVELS.

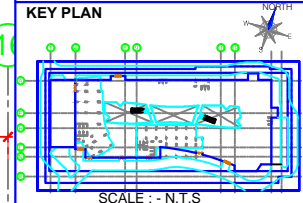

DRAWING STATUS:-  
FOR INFORMATION ONLY

No.	Date	Revision	Drawn	Check

No.	Date	Revision	Drawn	Check

STRUCTURAL CONSULTANT

**OPTIMIZATION CONSULTANTS**

PROJECT COSY OPTIMIZATION • STRUCTURAL ENGINEERING • PROJECT MANAGEMENT  
 202-203, HIMALAY HOUSE, KARAMPURA COMMERCIAL COMPLEX  
 NEW DELHI-110015, INDIA  
 Email: optpro34@yahoo.com

MEP Consultant  
**V.S. KUKREJA & ASSOCIATES PVT. LTD.**  
 CONSULTING ENGINEERS  
 165-A, GAUTAM NAGAR  
 NEW DELHI-110049  
 PH: +91 11 26521075/26501076  
 FAX: 26967867  
 EMAIL: info@vskukreja.com

PROJECT  
 BOULEVARD WALK MALL AT PLOT NO - C - 02,  
 SECTOR - 04, GREATER NOIDA (U.P.)

OWNER  
 M/S BOULEVARD WALK INFRA TECH PVT. LTD.  
 N-5, OPP. AXIS BANK, SECTOR - 18,  
 NOIDA (U.P.)

ARCHITECT

**modarchindia**  
 architecture. interior. environmental  
 Plot no:- B-99 First Floor, sec-63 Noida  
 PHONE NO: 01204206253

Drawing Title  
**14TH FLOOR PLAN (REFUGE FLOOR)**

Checked by	Approved by	Date	Scale	Drawn by
KRISHNA	AMIT GANDAL			GAUVENDRA

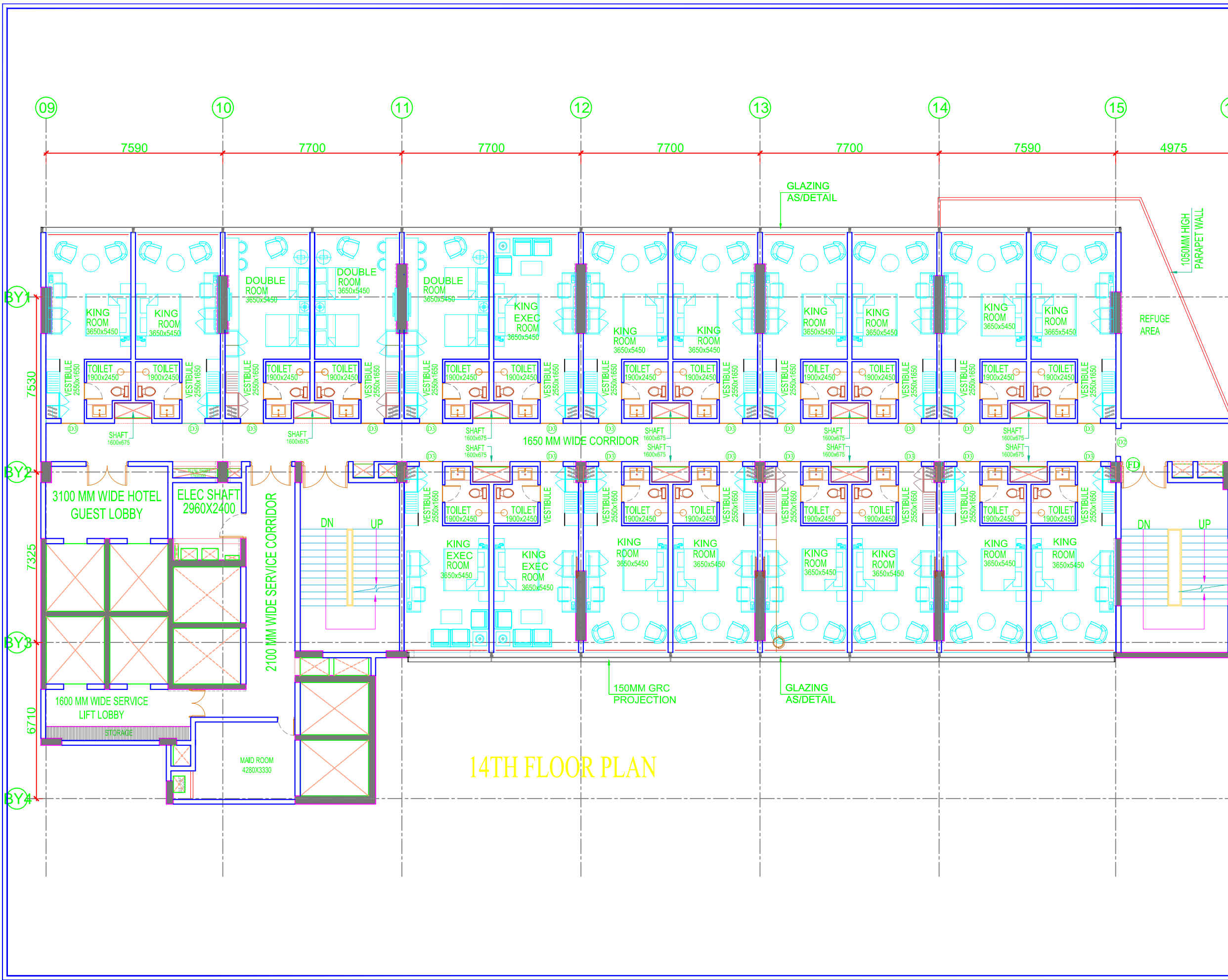

**14TH FLOOR PLAN**