

AREA TABLE-2			
S.N O.	ITEM	AREA	UNIT
1	PLOTTED AREA	9810.12	SQMT.
2	SECTOR SHOPPING-1	119.17	SQMT.
3	CONVINIENT SHOP-1	66.90	SQMT.
4	FOR INFORMAL AREA KIOSK/ BOOTH/ PLATFORM	46.56	SQMT.
5	TOTAL	10042.75	SQMT.
6	MORTGAGE-20%	2008.55	SQMT.
7	ACHIEVED MORTGAGE-20.17%	2026.22	SQMT.

AREA TABLE-3			
S.N O.	ITEM	AREA	UNIT
1	RAIN WATER HARVESTING	32.00	SQMT.
2	BORE WELL	6.25	SQMT.
3	TRANSFORMER	20.32	SQMT.
4	S.T.P.	50.92	SQMT.
5	PARK	2742.90	SQMT.
6	OVER HEAD TANK	28.27	SQMT.
	TOTAL	2980.66	SQMT.

AREA TABLE-1				
S.NO.	ITEM	AREA	UNIT	PERCENTAGE
1	TOTAL LAND AREA AS/DOCUMENT	21583.70	SQMT.	
2	TOTAL LAND AREA AS/SITE	20145.83	SQMT.	
3	EXISTING CHAK ROAD	625.52	SQMT.	
4	ROAD WIDENING AREA	1253.83	SQMT.	
5	NET PLOT AREA	18266.48	SQMT.	100.00
6	PLOTTED AREA	9810.12	SQMT.	53.706
7	ROAD AREA	5227.09	SQMT.	28.616
8	GARBAGE COLLECTION CENTER-1	22.90	SQMT.	0.1254
9	GARBAGE COLLECTION CENTER-2	48.53	SQMT.	0.266
10	FOR INFORMAL AREA KIOSK/ BOOTH/ PLATFORM-1	15.62	SQMT.	0.086
11	FOR INFORMAL AREA KIOSK/ BOOTH/ PLATFORM-2	15.52	SQMT.	0.085
12	FOR INFORMAL AREA KIOSK/ BOOTH/ PLATFORM-3	15.42	SQMT.	0.0844
13	SECTOR SHOPPING-1	119.17	SQMT.	0.652
14	CONVINIENT SHOP-1	66.90	SQMT.	0.366
15	PARK	2742.90	SQMT.	15.0160
16	RAIN WATER HARVESTING	32.00	SQMT.	0.175
17	BORE WELL	6.25	SQMT.	0.034
18	TRANSFORMER	20.32	SQMT.	0.111
19	S.T.P.	50.92	SQMT.	0.279
20	OVER HEAD TANK	28.27	SQMT.	0.155
21	PARKING	44.55	SQMT.	0.244
	TOTAL	18266.48		100.000

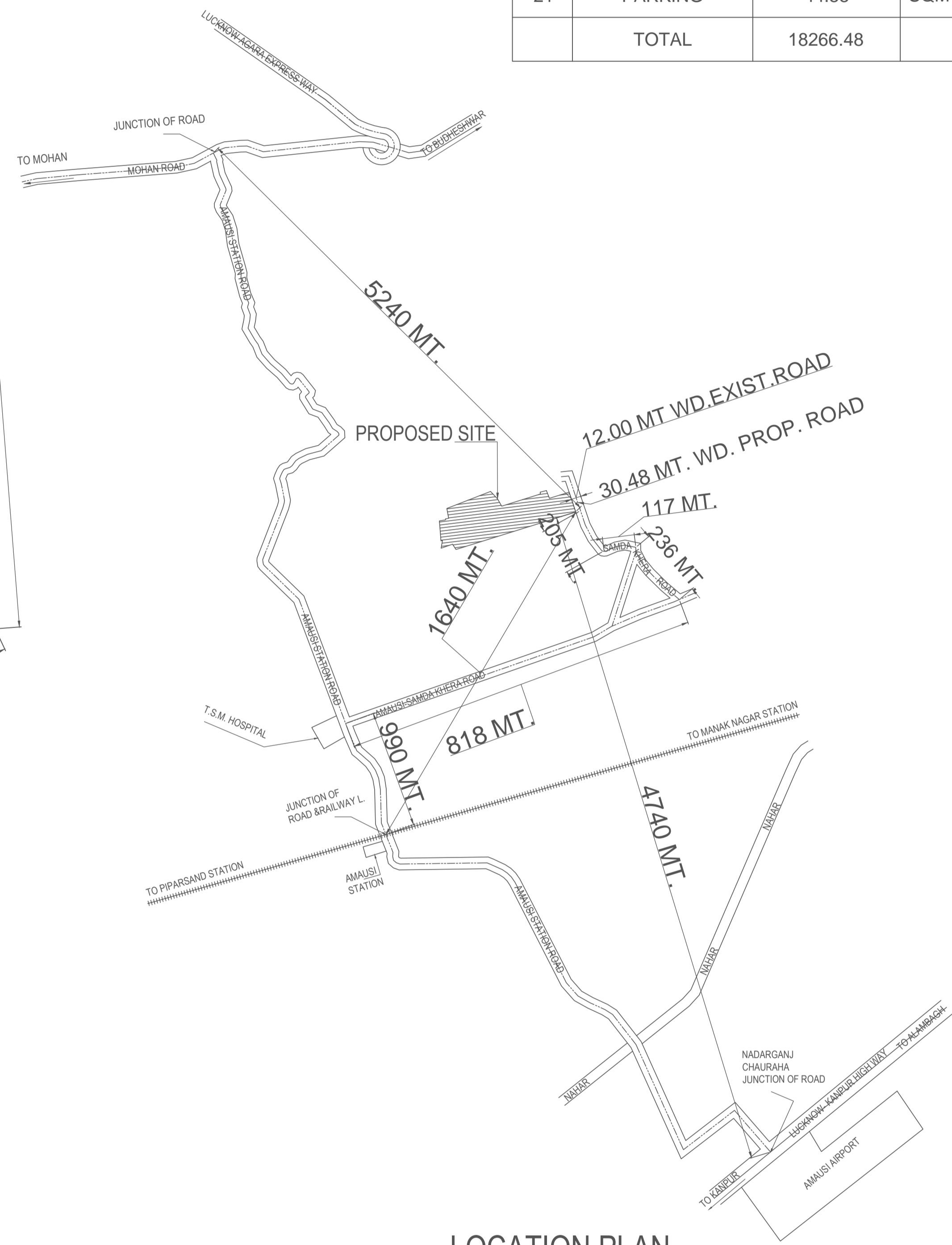

LOCATION PLAN

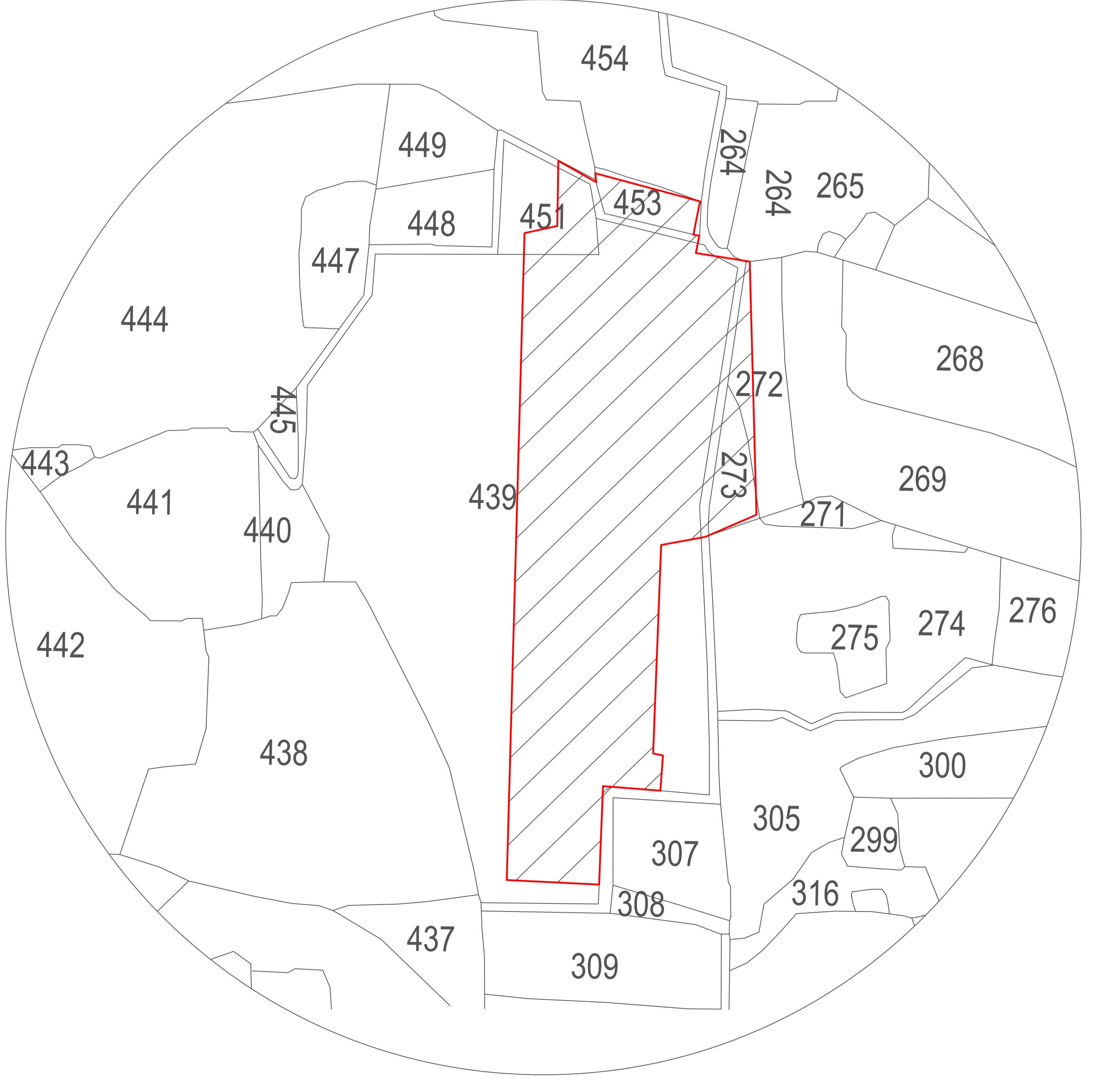

SAZRA PLAN SUPERIMPOSE

TABLE		
S.NO.	ITEMS	QUANTITY/UNIT
01	ELECTRIC POLES	31/NO.
02	STREET LIGHT	30/NO.
03	TRANSFORMER	600/KV
04	ABC ELECTRIC LINE CABLE	782/MT. 15% EXTRA

ELECTRICAL PLAN

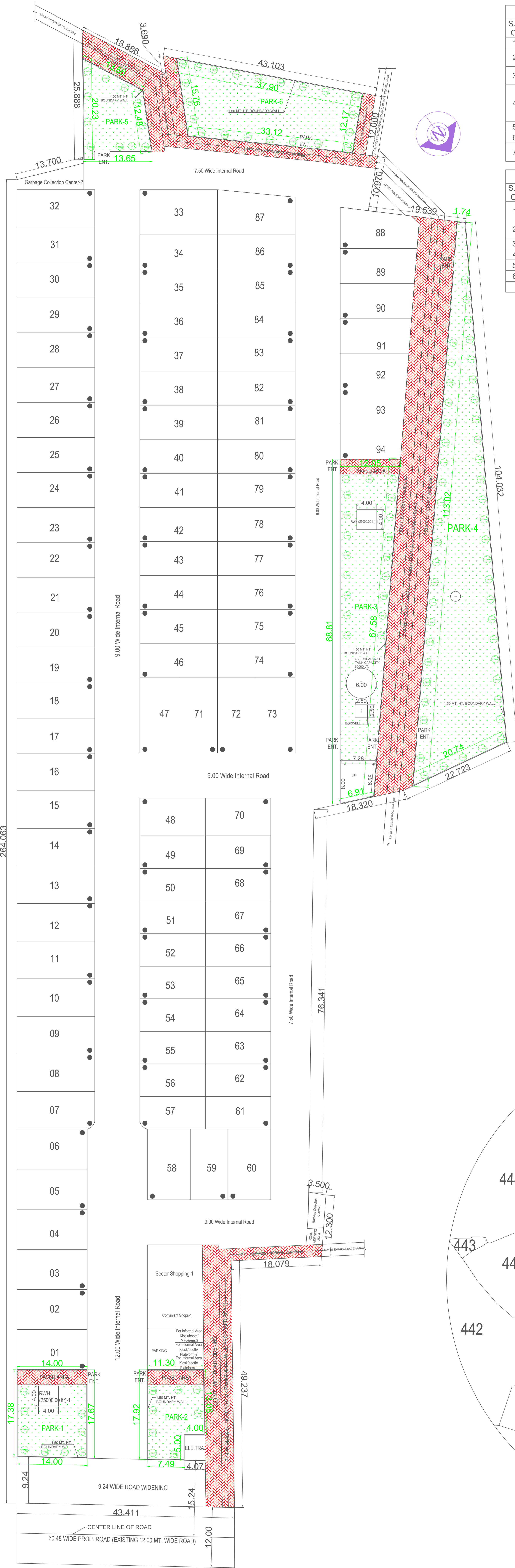

LANDSCAPE PLAN

AREA TABLE-2			
S.N O.	ITEM	AREA	UNIT
1	PLOTTED AREA	9810.12	SQMT.
2	SECTOR SHOPPING-1	119.17	SQMT.
3	CONVINIENT SHOP-1	66.90	SQMT.
4	FOR INFORMAL AREA KIOSK/ BOOTH/ PLATFORM	46.56	SQMT.
5	TOTAL	10042.75	SQMT.
6	MORTGAGE-20%	2008.55	SQMT.
7	ACHIEVED MORTGAGE-20.17%	2026.22	SQMT.

AREA TABLE-3			
S.N O.	ITEM	AREA	UNIT
1	RAIN WATER HARVESTING	32.00	SQMT.
2	BORE WELL	6.25	SQMT.
3	TRANSFORMER	20.32	SQMT.
4	S.T.P.	50.92	SQMT.
5	PARK	2742.90	SQMT.
6	OVER HEAD TANK	28.27	SQMT.
	TOTAL	2980.66	SQMT.

AREA TABLE-1				
S.NO.	ITEM	AREA	UNIT	PERCENTAGE
1	TOTAL LAND AREA AS/DOCUMENT	21583.70	SQMT.	
2	TOTAL LAND AREA AS/SITE	20145.83	SQMT.	
3	EXISTING CHAK ROAD	625.52	SQMT.	
4	ROAD WIDENING AREA	1253.83	SQMT.	
5	NET PLOT AREA	18266.48	SQMT.	100.00
6	PLOTTED AREA	9810.12	SQMT.	53.706
7	ROAD AREA	5227.09	SQMT.	28.616
8	GARBAGE COLLECTION CENTER-1	22.90	SQMT.	0.1254
9	GARBAGE COLLECTION CENTER-2	48.53	SQMT.	0.266
10	FOR INFORMAL AREA KIOSK/ BOOTH/ PLATFORM-1	15.62	SQMT.	0.086
11	FOR INFORMAL AREA KIOSK/ BOOTH/ PLATFORM-2	15.52	SQMT.	0.085
12	FOR INFORMAL AREA KIOSK/ BOOTH/ PLATFORM-3	15.42	SQMT.	0.0844
13	SECTOR SHOPPING-1	119.17	SQMT.	0.652
14	CONVINIENT SHOP-1	66.90	SQMT.	0.366
15	PARK	2742.90	SQMT.	15.0160
16	RAIN WATER HARVESTING	32.00	SQMT.	0.175
17	BORE WELL	6.25	SQMT.	0.034
18	TRANSFORMER	20.32	SQMT.	0.111
19	S.T.P.	50.92	SQMT.	0.279
20	OVER HEAD TANK	28.27	SQMT.	0.155
21	PARKING	44.55	SQMT.	0.244
	TOTAL	18266.48		100.000

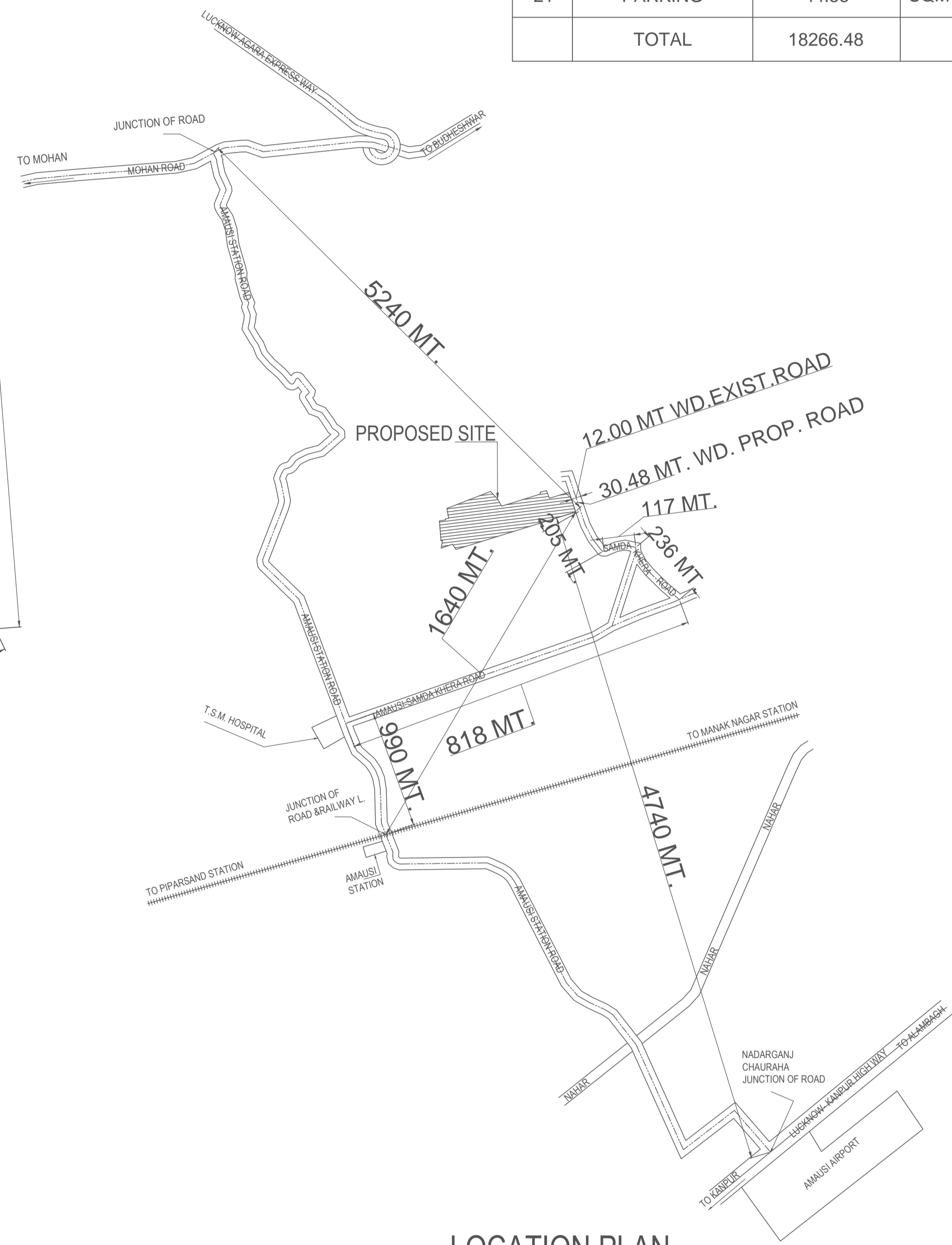

LOCATION PLAN

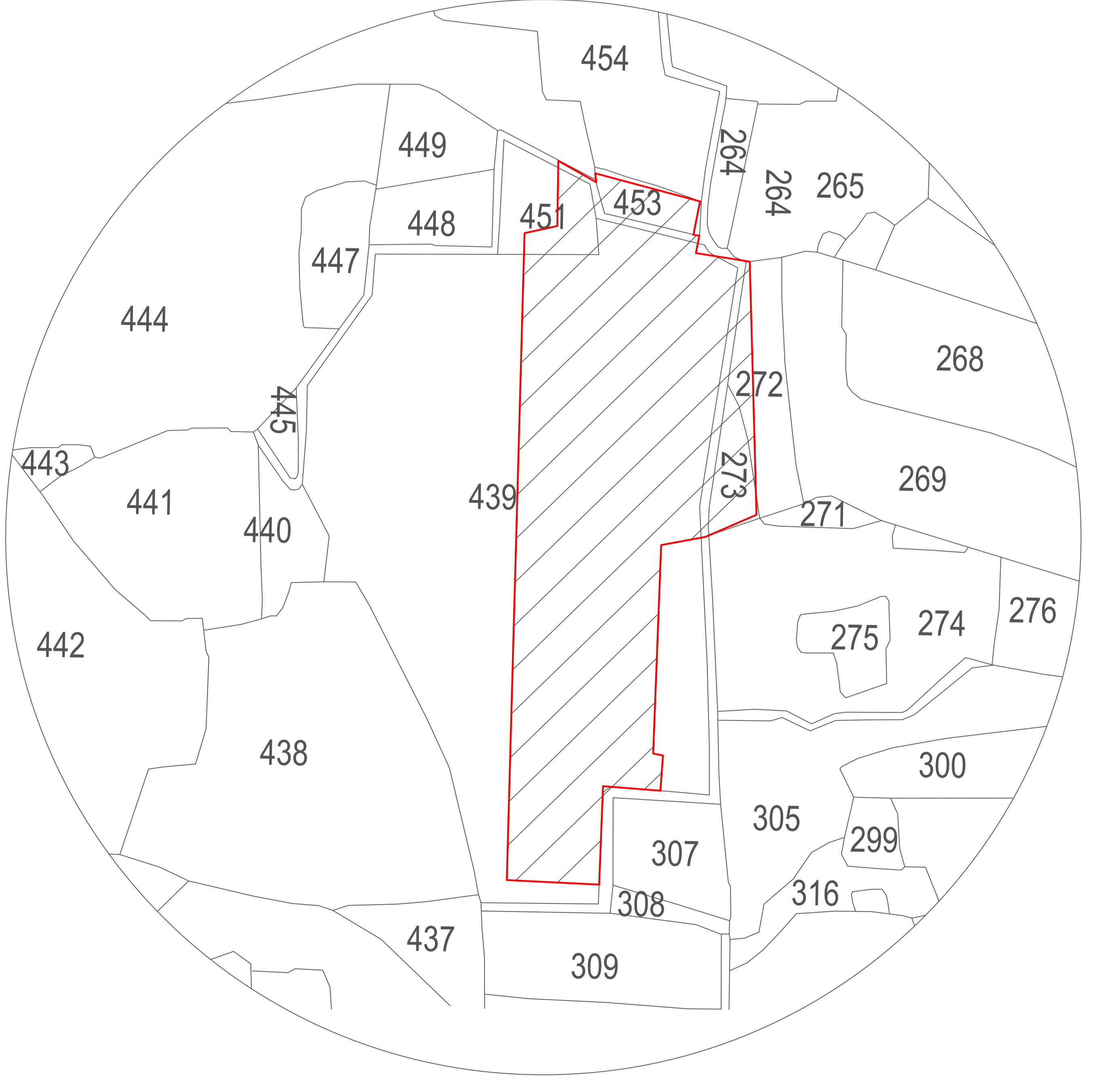

SAZRA PLAN SUPERIMPOSE

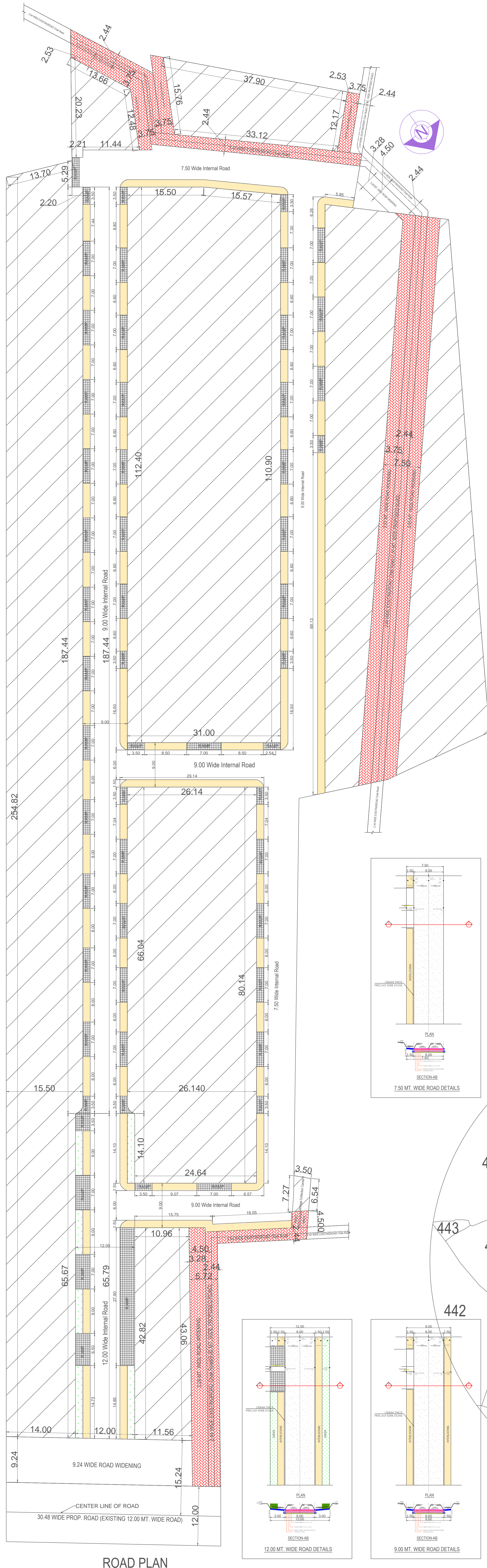

AREA TABLE-2			
S.N O.	ITEM	AREA	UNIT
1	PLOTTED AREA	9810.12	SQMT.
2	SECTOR SHOPPING-1	119.17	SQMT.
3	CONVINIENT SHOP-1	66.90	SQMT.
4	FOR INFORMAL AREA KIOSK/ BOOTH/ PLATFORM	46.56	SQMT.
5	TOTAL	10042.75	SQMT.
6	MORTGAGE-20%	2008.55	SQMT.
7	ACHIEVED MORTGAGE-20.17%	2026.22	SQMT.

AREA TABLE-3			
S.N O.	ITEM	AREA	UNIT
1	RAIN WATER HARVESTING	32.00	SQMT.
2	BORE WELL	6.25	SQMT.
3	TRANSFORMER	20.32	SQMT.
4	S.T.P.	50.92	SQMT.
5	PARK	2742.90	SQMT.
6	OVER HEAD TANK	28.27	SQMT.
	TOTAL	2980.66	SQMT.

AREA TABLE-1				
S.NO.	ITEM	AREA	UNIT	PERCENTAGE
1	TOTAL LAND AREA AS/DOCUMENT	21583.70	SQMT.	
2	TOTAL LAND AREA AS/SITE	20145.83	SQMT.	
3	EXISTING CHAK ROAD	625.52	SQMT.	
4	ROAD WIDENING AREA	1253.83	SQMT.	
5	NET PLOT AREA	18266.48	SQMT.	100.00
6	PLOTTED AREA	9810.12	SQMT.	53.706
7	ROAD AREA	5227.09	SQMT.	28.616
8	GARBAGE COLLECTION CENTER-1	22.90	SQMT.	0.1254
9	GARBAGE COLLECTION CENTER-2	48.53	SQMT.	0.266
10	FOR INFORMAL AREA KIOSK/ BOOTH/ PLATFORM-1	15.62	SQMT.	0.086
11	FOR INFORMAL AREA KIOSK/ BOOTH/ PLATFORM-2	15.52	SQMT.	0.085
12	FOR INFORMAL AREA KIOSK/ BOOTH/ PLATFORM-3	15.42	SQMT.	0.0844
13	SECTOR SHOPPING-1	119.17	SQMT.	0.652
14	CONVINIENT SHOP-1	66.90	SQMT.	0.366
15	PARK	2742.90	SQMT.	15.0160
16	RAIN WATER HARVESTING	32.00	SQMT.	0.175
17	BORE WELL	6.25	SQMT.	0.034
18	TRANSFORMER	20.32	SQMT.	0.111
19	S.T.P.	50.92	SQMT.	0.279
20	OVER HEAD TANK	28.27	SQMT.	0.155
21	PARKING	44.55	SQMT.	0.244
	TOTAL	18266.48		100.000

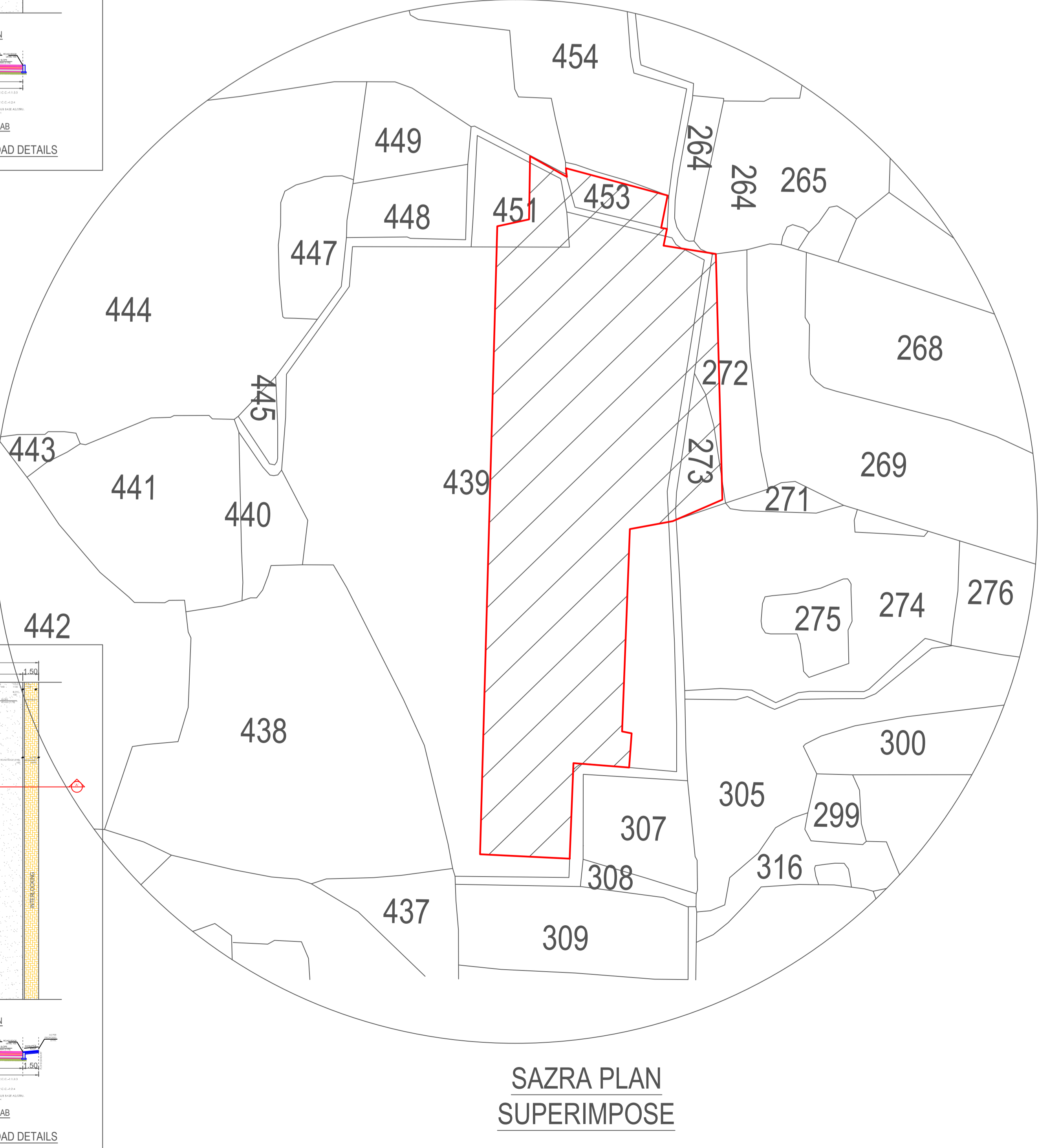
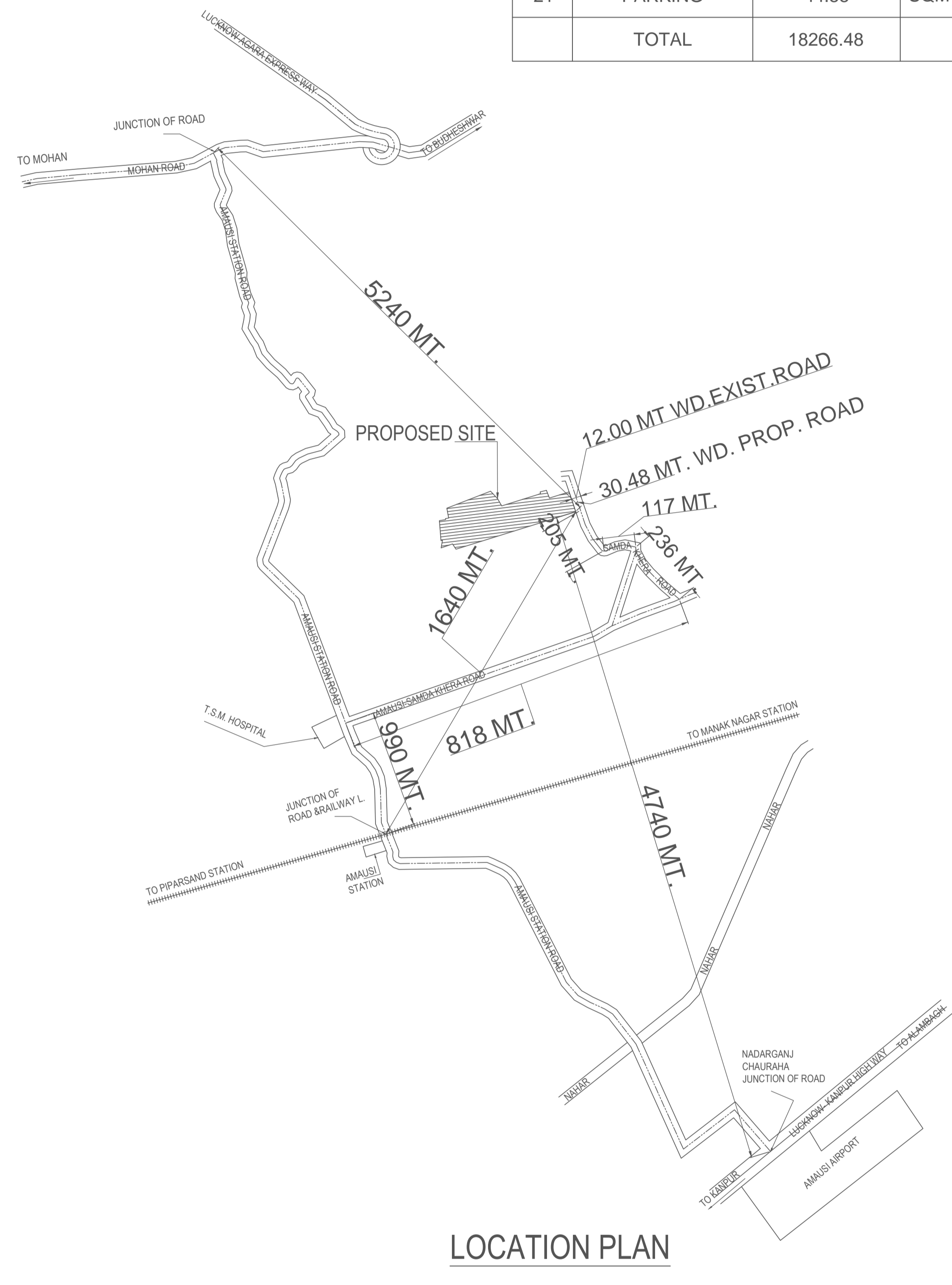

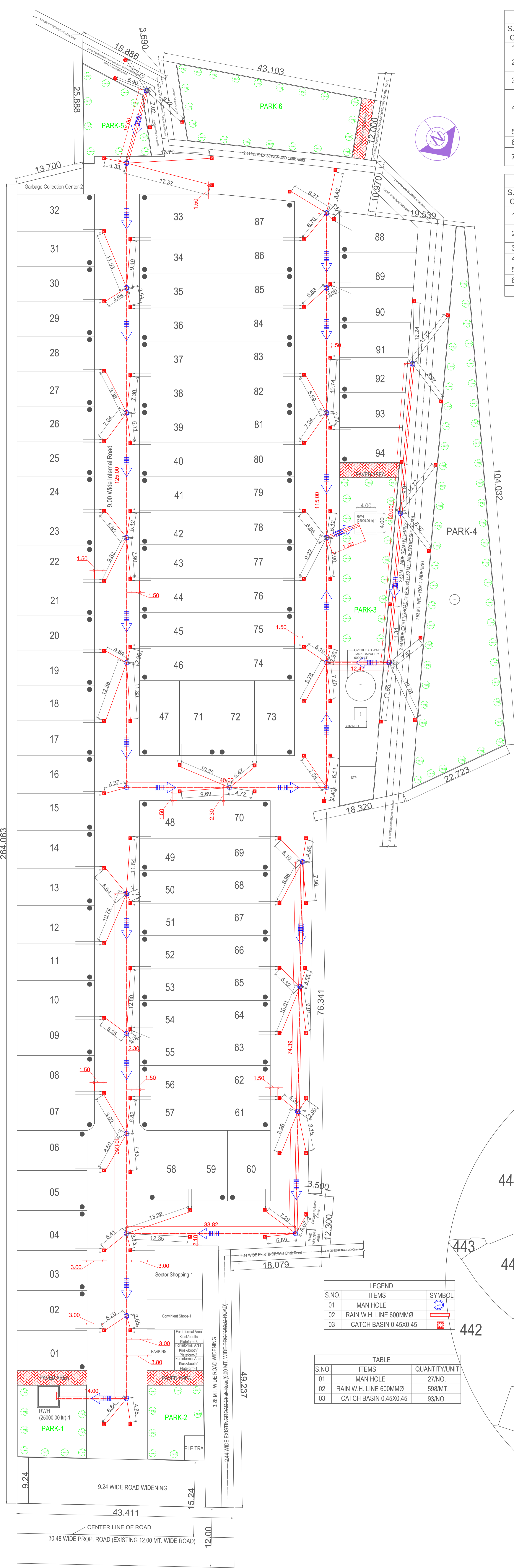

AREA TABLE-2			
S.N O.	ITEM	AREA	UNIT
1	PLOTTED AREA	9810.12	SQMT.
2	SECTOR SHOPPING-1	119.17	SQMT.
3	CONVINIENT SHOP-1	66.90	SQMT.
4	FOR INFORMAL AREA KIOSK/ BOOTH/ PLATFORM	46.56	SQMT.
5	TOTAL	10042.75	SQMT.
6	MORTGAGE-20%	2008.55	SQMT.
7	ACHIEVED MORTGAGE-20.17%	2026.22	SQMT.

AREA TABLE-3			
S.N O.	ITEM	AREA	UNIT
1	RAIN WATER HARVESTING	32.00	SQMT.
2	BORE WELL	6.25	SQMT.
3	TRANSFORMER	20.32	SQMT.
4	S.T.P.	50.92	SQMT.
5	PARK	2742.90	SQMT.
6	OVER HEAD TANK	28.27	SQMT.
	TOTAL	2880.66	SQMT.

AREA TABLE-1				
S.NO.	ITEM	AREA	UNIT	PERCENTAGE
1	TOTAL LAND AREA AS/DOCUMENT	21583.70	SQMT.	
2	TOTAL LAND AREA AS/SITE	20145.83	SQMT.	
3	EXISTING CHAK ROAD	625.52	SQMT.	
4	ROAD WIDENING AREA	1253.83	SQMT.	
5	NET PLOT AREA	18266.48	SQMT.	100.00
6	PLOTTED AREA	9810.12	SQMT.	53.706
7	ROAD AREA	5227.09	SQMT.	28.616
8	GARBAGE COLLECTION CENTER-1	22.90	SQMT.	0.1254
9	GARBAGE COLLECTION CENTER-2	48.53	SQMT.	0.266
10	FOR INFORMAL AREA KIOSK/ BOOTH/ PLATFORM-1	15.62	SQMT.	0.086
11	FOR INFORMAL AREA KIOSK/ BOOTH/ PLATFORM-2	15.52	SQMT.	0.085
12	FOR INFORMAL AREA KIOSK/ BOOTH/ PLATFORM-3	15.42	SQMT.	0.0844
13	SECTOR SHOPPING-1	119.17	SQMT.	0.652
14	CONVINIENT SHOP-1	66.90	SQMT.	0.366
15	PARK	2742.90	SQMT.	15.0160
16	RAIN WATER HARVESTING	32.00	SQMT.	0.175
17	BORE WELL	6.25	SQMT.	0.034
18	TRANSFORMER	20.32	SQMT.	0.111
19	S.T.P.	50.92	SQMT.	0.279
20	OVER HEAD TANK	28.27	SQMT.	0.155
21	PARKING	44.55	SQMT.	0.244
	TOTAL	18266.48		100.000

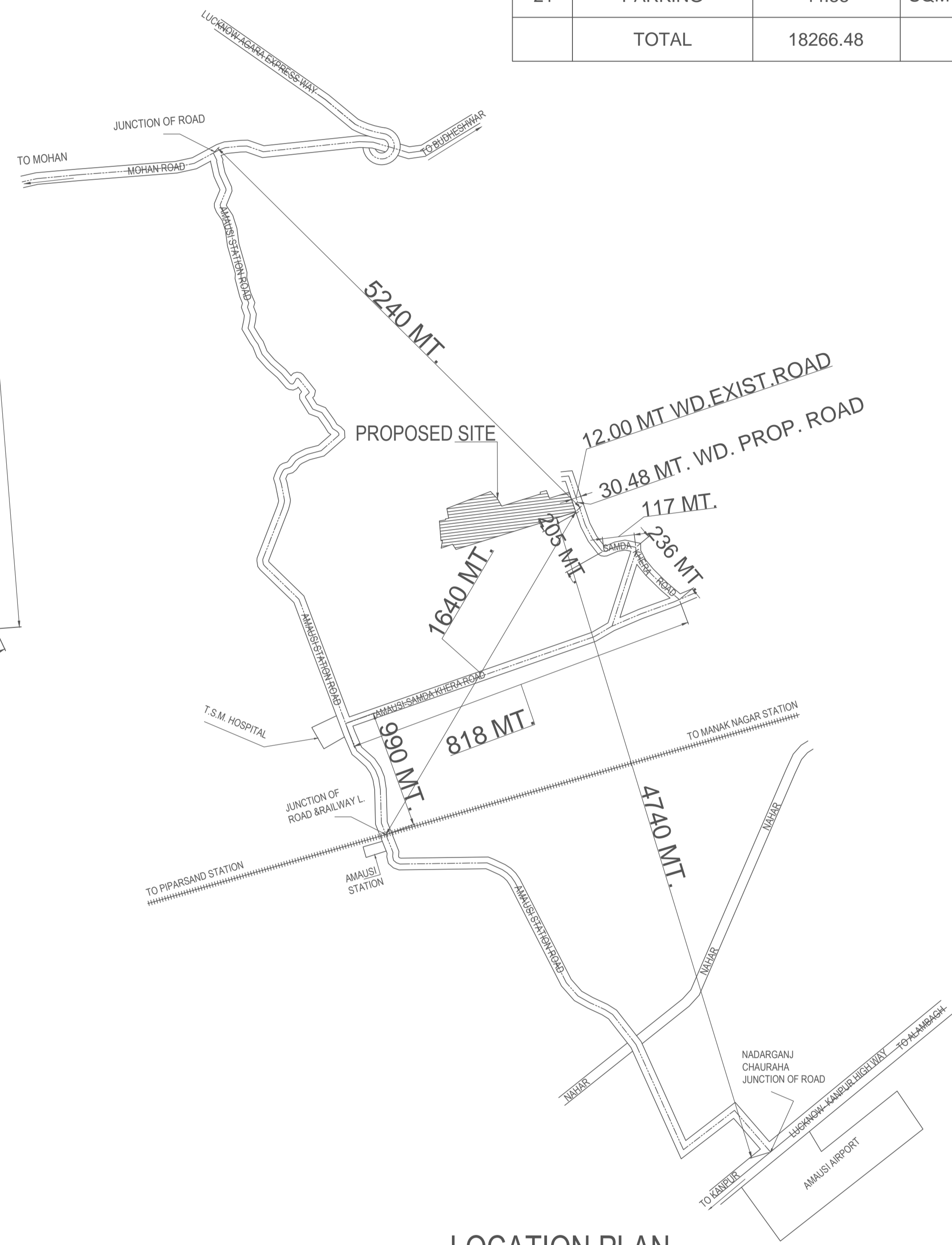

LOCATION PLAN

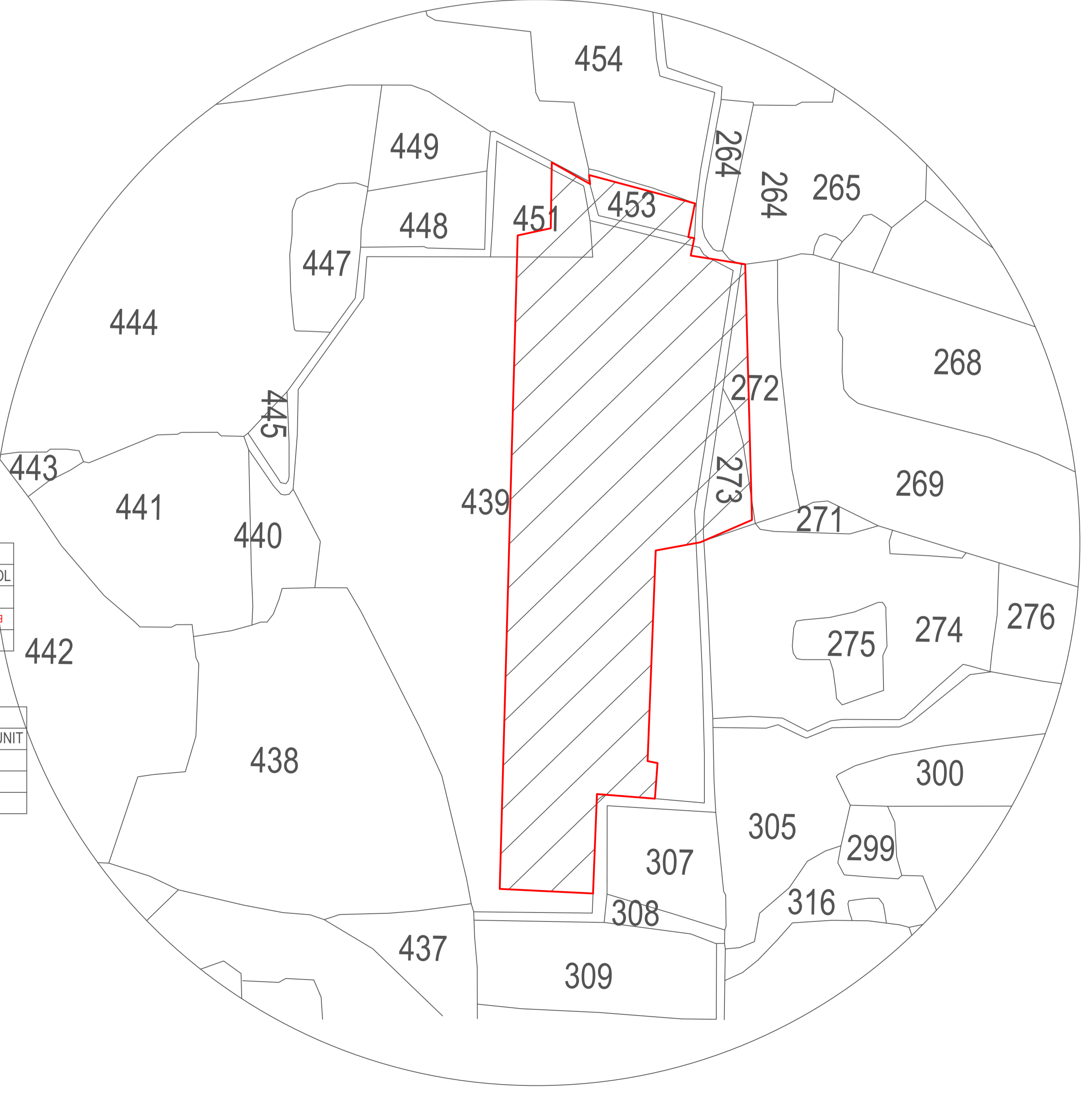

SAZRA PLAN SUPERIMPOSE

LEGEND		
S.NO.	ITEMS	SYMBOL
01	MAN HOLE	(Symbol)
02	RAIN W.H. LINE 600MMØ	(Symbol)
03	CATCH BASIN 0.45X0.45	(Symbol)

TABLE		
S.NO.	ITEMS	QUANTITY/UNIT
01	MAN HOLE	27/NO.
02	RAIN W.H. LINE 600MMØ	598/MT.
03	CATCH BASIN 0.45X0.45	93/NO.

RAIN WATER HARVESTING PLAN

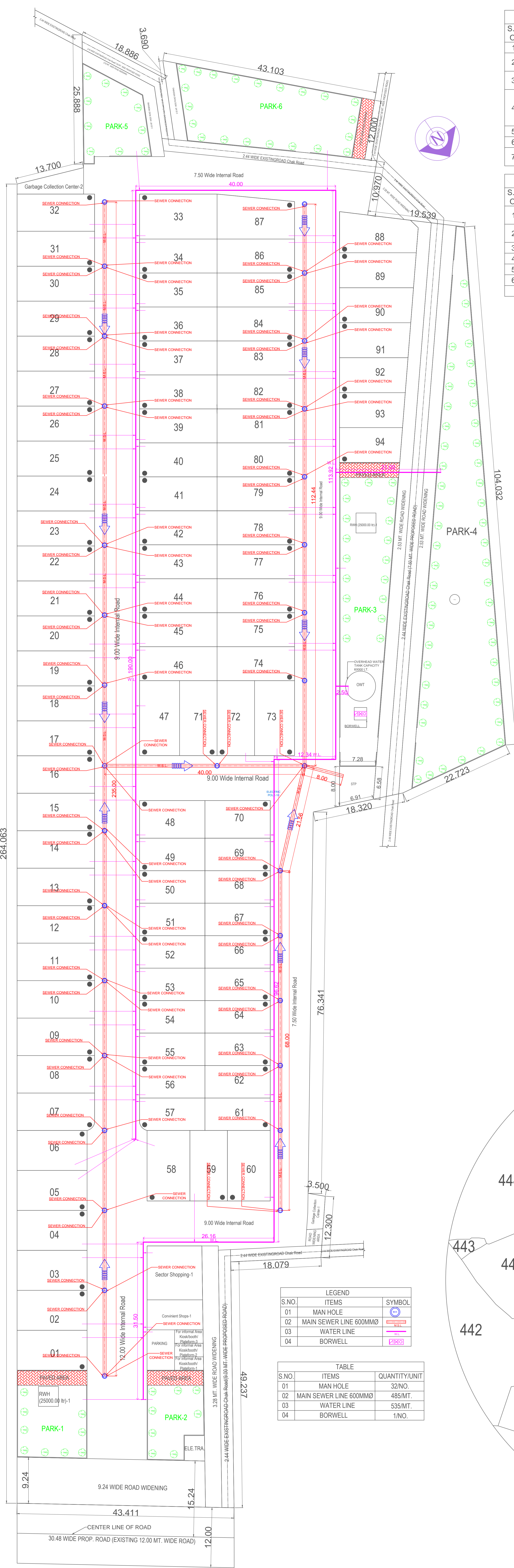

SERVICE PLAN

AREA TABLE-2			
S.N O.	ITEM	AREA	UNIT
1	PLOTTED AREA	9810.12	SQMT.
2	SECTOR SHOPPING-1	119.17	SQMT.
3	CONVINIENT SHOP-1	66.90	SQMT.
4	FOR INFORMAL AREA KIOSK/ BOOTH/ PLATFORM	46.56	SQMT.
5	TOTAL	10042.75	SQMT.
6	MORTGAGE-20%	2008.55	SQMT.
7	ACHIEVED MORTGAGE-20.17%	2026.22	SQMT.

AREA TABLE-3			
S.N O.	ITEM	AREA	UNIT
1	RAIN WATER HARVESTING	32.00	SQMT.
2	BORE WELL	6.25	SQMT.
3	TRANSFORMER	20.32	SQMT.
4	S.T.P.	50.92	SQMT.
5	PARK	2742.90	SQMT.
6	OVER HEAD TANK	28.27	SQMT.
	TOTAL	2880.66	SQMT.

AREA TABLE-1				
S.NO.	ITEM	AREA	UNIT	PERCENTAGE
1	TOTAL LAND AREA AS/DOCUMENT	21583.70	SQMT.	
2	TOTAL LAND AREA AS/SITE	20145.83	SQMT.	
3	EXISTING CHAK ROAD	625.52	SQMT.	
4	ROAD WIDENING AREA	1253.83	SQMT.	
5	NET PLOT AREA	18266.48	SQMT.	100.00
6	PLOTTED AREA	9810.12	SQMT.	53.706
7	ROAD AREA	5227.09	SQMT.	28.616
8	GARBAGE COLLECTION CENTER-1	22.90	SQMT.	0.1254
9	GARBAGE COLLECTION CENTER-2	48.53	SQMT.	0.266
10	FOR INFORMAL AREA KIOSK/ BOOTH/ PLATFORM-1	15.62	SQMT.	0.086
11	FOR INFORMAL AREA KIOSK/ BOOTH/ PLATFORM-2	15.52	SQMT.	0.085
12	FOR INFORMAL AREA KIOSK/ BOOTH/ PLATFORM-3	15.42	SQMT.	0.0844
13	SECTOR SHOPPING-1	119.17	SQMT.	0.652
14	CONVINIENT SHOP-1	66.90	SQMT.	0.366
15	PARK	2742.90	SQMT.	15.0160
16	RAIN WATER HARVESTING	32.00	SQMT.	0.175
17	BORE WELL	6.25	SQMT.	0.034
18	TRANSFORMER	20.32	SQMT.	0.111
19	S.T.P.	50.92	SQMT.	0.279
20	OVER HEAD TANK	28.27	SQMT.	0.155
21	PARKING	44.55	SQMT.	0.244
	TOTAL	18266.48		100.000

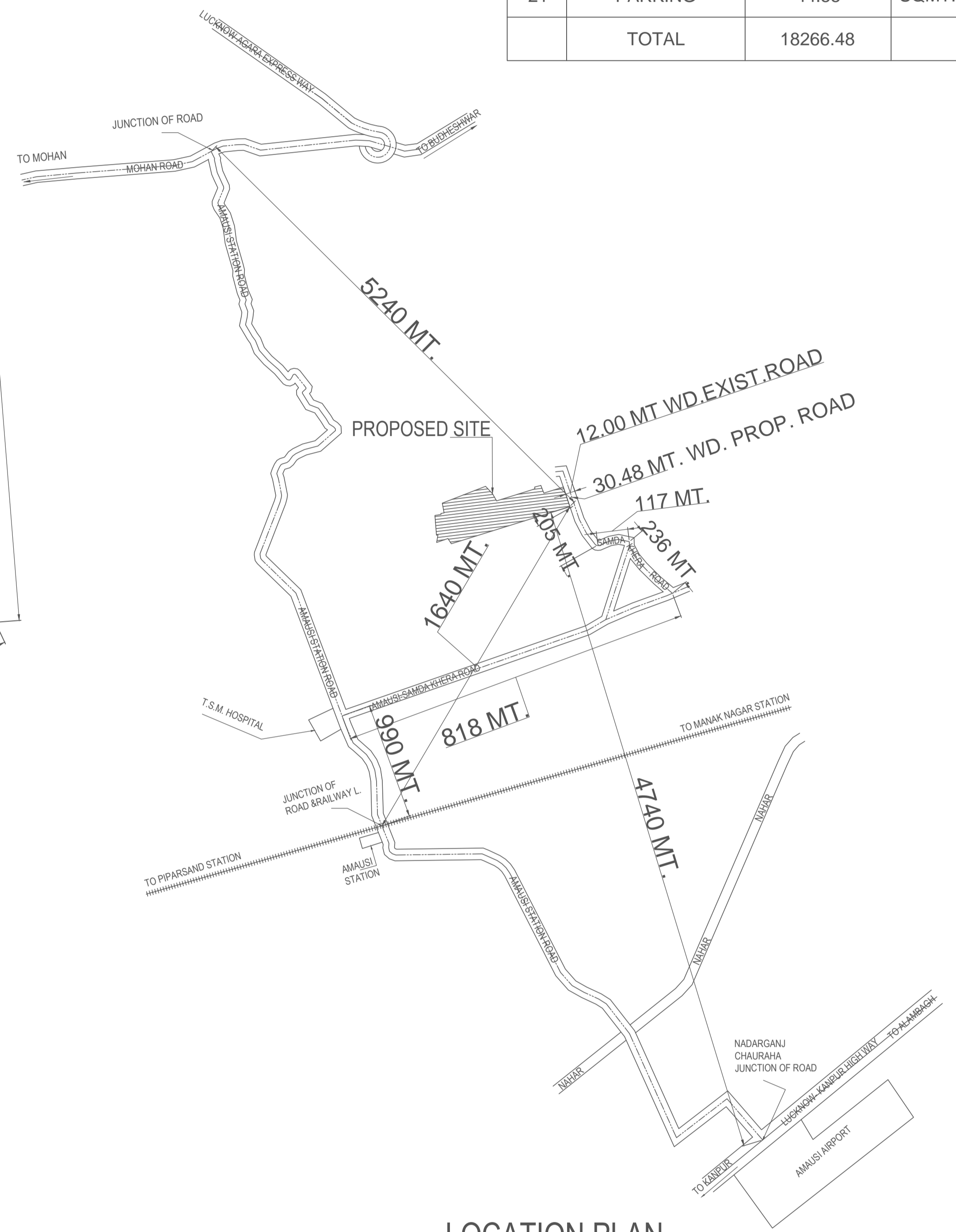

LOCATION PLAN

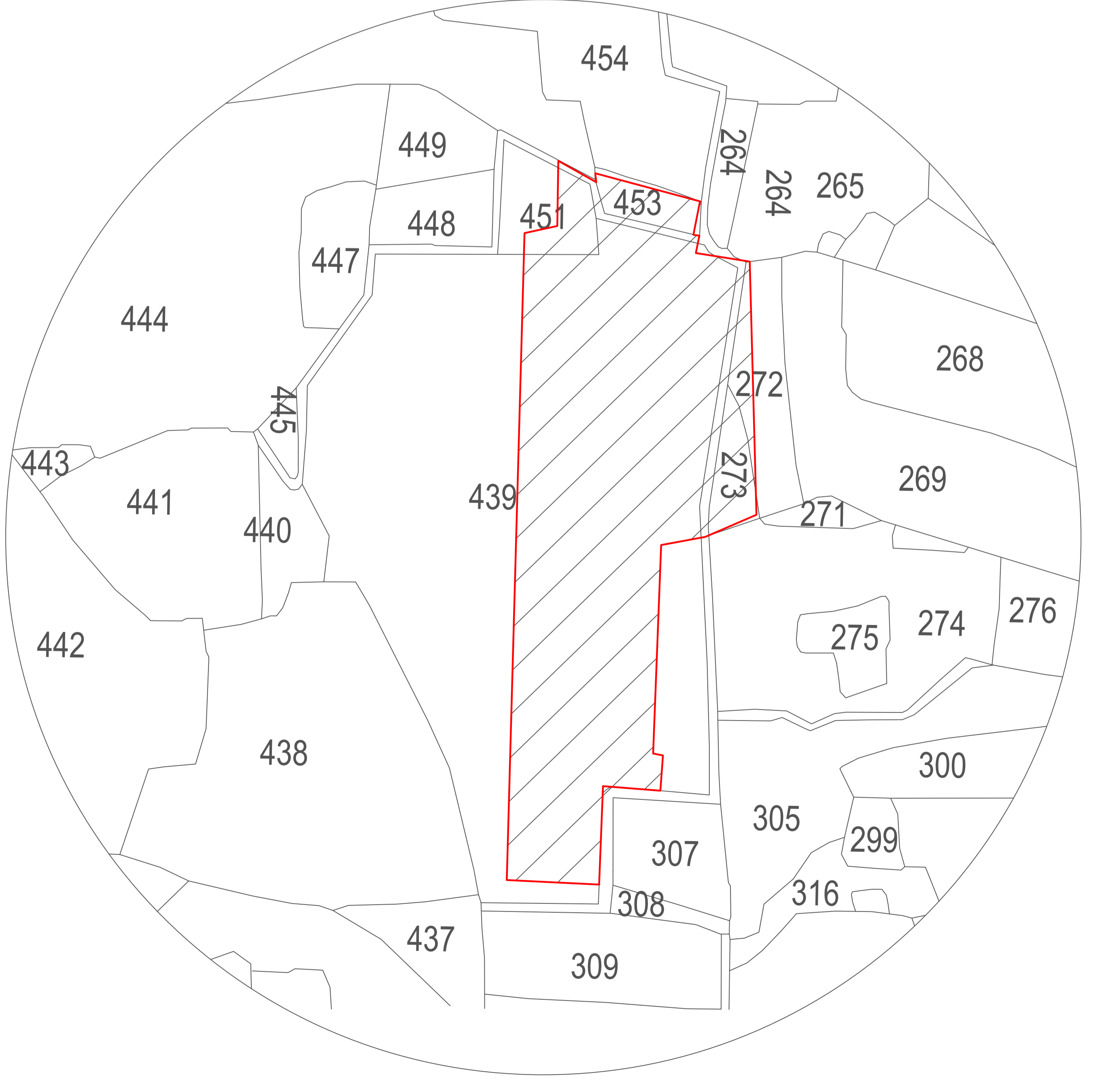

SAZRA PLAN SUPERIMPOSE

LEGEND		
S.NO.	ITEMS	SYMBOL
01	MAN HOLE	⊙
02	MAIN SEWER LINE 600MMØ	—
03	WATER LINE	—
04	BORWELL	⊗

TABLE		
S.NO.	ITEMS	QUANTITY/UNIT
01	MAN HOLE	32/NO.
02	MAIN SEWER LINE 600MMØ	485/MT.
03	WATER LINE	535/MT.
04	BORWELL	1/NO.

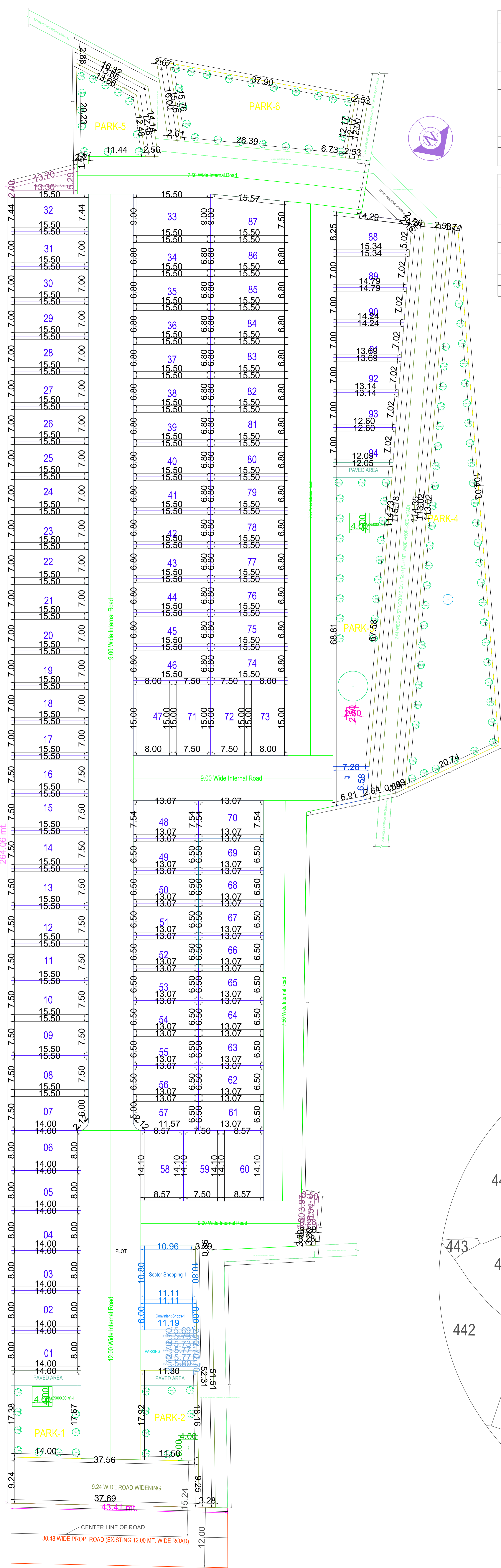

LAYOUT PLAN

AREA TABLE-2			
S.N O.	ITEM	AREA	UNIT
1	PLOTTED AREA	9810.12	SQMT.
2	SECTOR SHOPPING-1	119.17	SQMT.
3	CONVINIENT SHOP-1	66.90	SQMT.
4	FOR INFORMAL AREA KIOSK/ BOOTH/ PLATFORM	46.56	SQMT.
5	TOTAL	10042.75	SQMT.
6	MORTGAGE-20%	2008.55	SQMT.
7	ACHIEVED MORTGAGE-20.17%	2026.22	SQMT.

AREA TABLE-3			
S.N O.	ITEM	AREA	UNIT
1	RAIN WATER HARVESTING	32.00	SQMT.
2	BORE WELL	6.25	SQMT.
3	TRANSFORMER	20.32	SQMT.
4	S.T.P.	50.92	SQMT.
5	PARK	2742.90	SQMT.
6	OVER HEAD TANK	28.27	SQMT.
	TOTAL	2880.66	SQMT.

AREA TABLE-1				
S.NO.	ITEM	AREA	UNIT	PERCENTAGE
1	TOTAL LAND AREA AS/DOCUMENT	21583.70	SQMT.	
2	TOTAL LAND AREA AS/SITE	20145.83	SQMT.	
3	EXISTING CHAK ROAD	625.52	SQMT.	
4	ROAD WIDENING AREA	1253.83	SQMT.	
5	NET PLOT AREA	18266.48	SQMT.	100.00
6	PLOTTED AREA	9810.12	SQMT.	53.706
7	ROAD AREA	5227.09	SQMT.	28.616
8	GARBAGE COLLECTION CENTER-1	22.90	SQMT.	0.1254
9	GARBAGE COLLECTION CENTER-2	48.53	SQMT.	0.266
10	FOR INFORMAL AREA KIOSK/ BOOTH/ PLATFORM-1	15.62	SQMT.	0.086
11	FOR INFORMAL AREA KIOSK/ BOOTH/ PLATFORM-2	15.52	SQMT.	0.085
12	FOR INFORMAL AREA KIOSK/ BOOTH/ PLATFORM-3	15.42	SQMT.	0.0844
13	SECTOR SHOPPING-1	119.17	SQMT.	0.652
14	CONVINIENT SHOP-1	66.90	SQMT.	0.366
15	PARK	2742.90	SQMT.	15.0160
16	RAIN WATER HARVESTING	32.00	SQMT.	0.175
17	BORE WELL	6.25	SQMT.	0.034
18	TRANSFORMER	20.32	SQMT.	0.111
19	S.T.P.	50.92	SQMT.	0.279
20	OVER HEAD TANK	28.27	SQMT.	0.155
21	PARKING	44.55	SQMT.	0.244
	TOTAL	18266.48		100.000

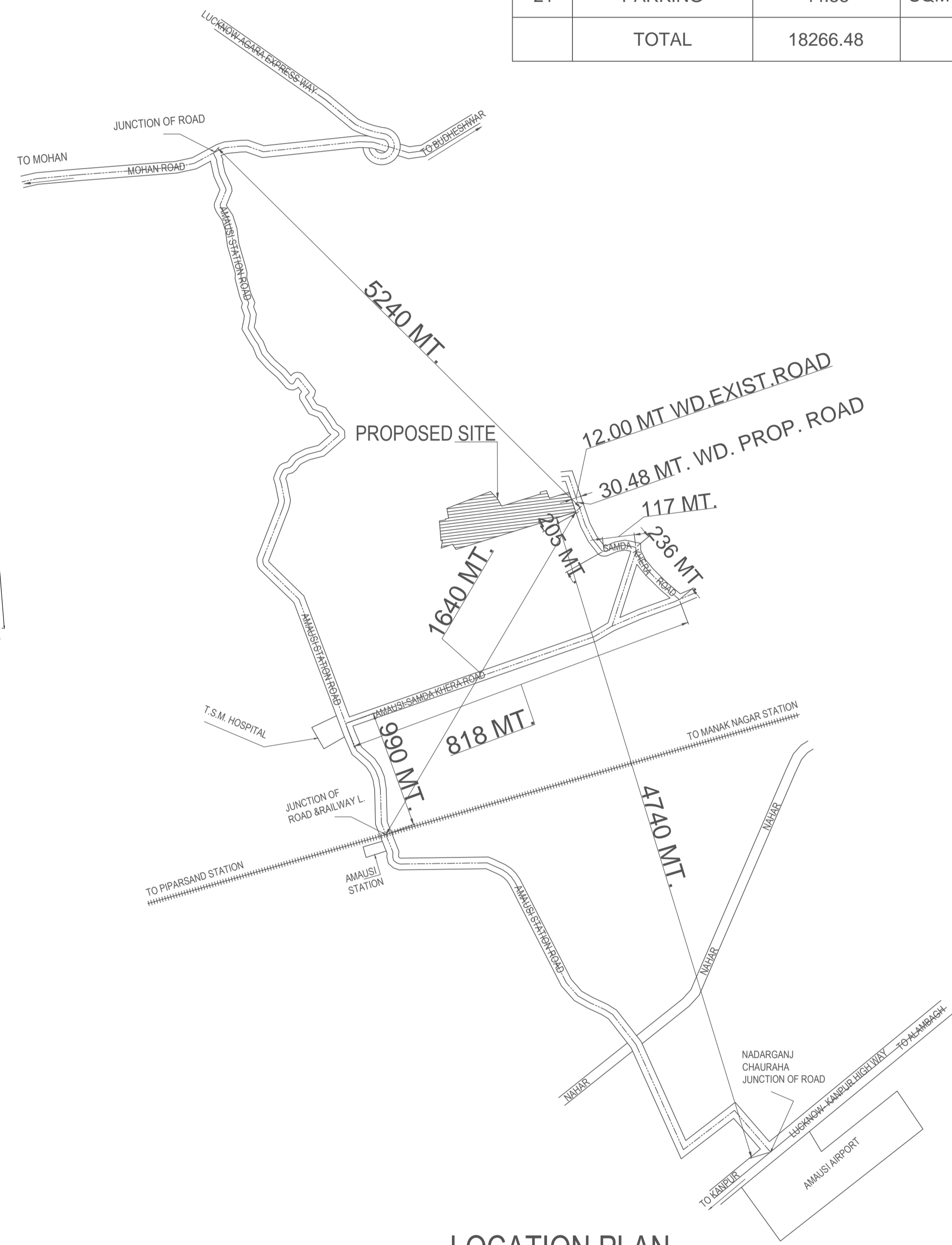

LOCATION PLAN

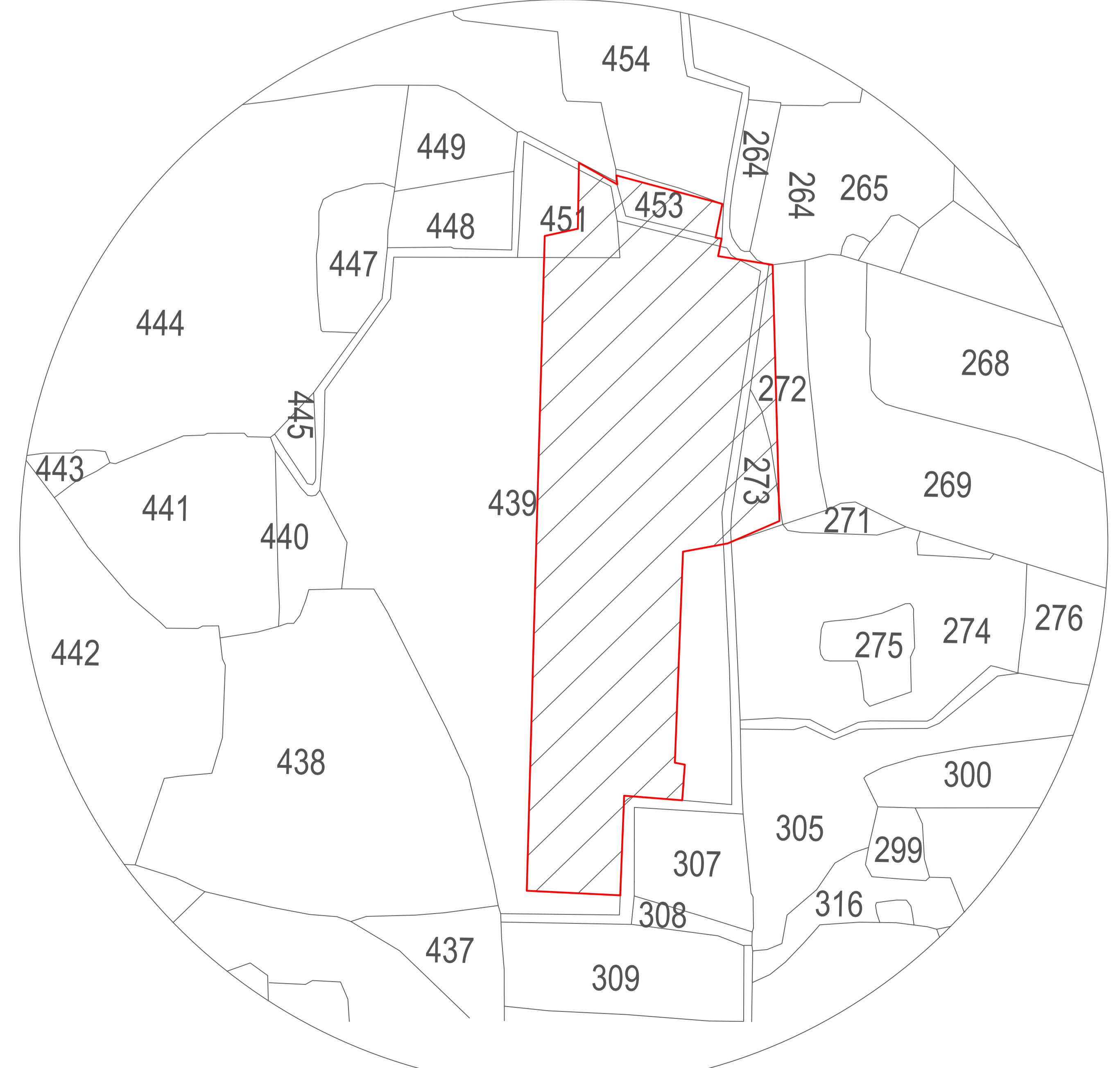

SAZRA PLAN SUPERIMPOSE