

PROJECT

PROPOSED RESIDENTIAL APARTMENTS & EXISTING COMMERCIAL COMPLEX FOR ---

MR. DHARAM KHURANA S/O MR.K. C. KHURANA & MRS. SAVITRI KHURANA w/o MR.DHARAM KHURANA & MR.DHIRAJ KHURANA s/o MR DHARAM KHURANA

SITE AT :- KHASRA NO 3344 & 3344/ 1 & 3346 KASBA AMROHA, OUTSIDE CHUNGI, NEAR BUS STATION, JOYA ROAD AMROHA

OWNER'S SIGN

SCHEDULE OF SPECIFICATION

1. P.C.C. IN FOUNDATION & LIME CONC. IN TOP TERRACE.
2. FIRST CLASS BRICK WORK IN FOUNDATION WITH 1:6 CEMENT SAND MORTAR.
3. FIRST CLASS BRICK WORK IN SUPER STRUCTURE 1:6 CEMENT SAND MORTAR.
4. 12 M.M. TH. PLASTER ON WALLS WITH 1:6 CEMENT SAND MORTAR.
5. 12 M.M. TH. PLASTER ON CEILING WITH 1:6 CEMENT SAND MORTAR.
6. R.C.C. WORK IN BEAMS COLUMNS & LINTEL M-20 MIX CONC.
7. R.C.C. WORK IN ROOF SLAB M-15 MIX CONC.
8. SALL WOOD CHAUKHATS FOR VENTILATORS.
9. SHEESHAM WOOD SHUTTERS FOR VENTILATORS.
10. FLOOR FINISH WITH POLISHED TERRAZZO.
11. **SOLAR PASSIVE ENERGY USE IS IN CONSIDERATION IN THE PROJECT.**

NORTH SIGN	LEGEND :-
	PROPOSED :-
	EXISTING :-
DRAWING NO.	
SCALE - 1:200	

ARCHITECT :-

M/S ENARCH DESIGNERS
 consultant - Architect - **Jaswant Singh**
 (M.Arch)
 office -- jigar colony road, opp. poultry farm ,
 moradabad ph.no. - 9837313291,8265972027

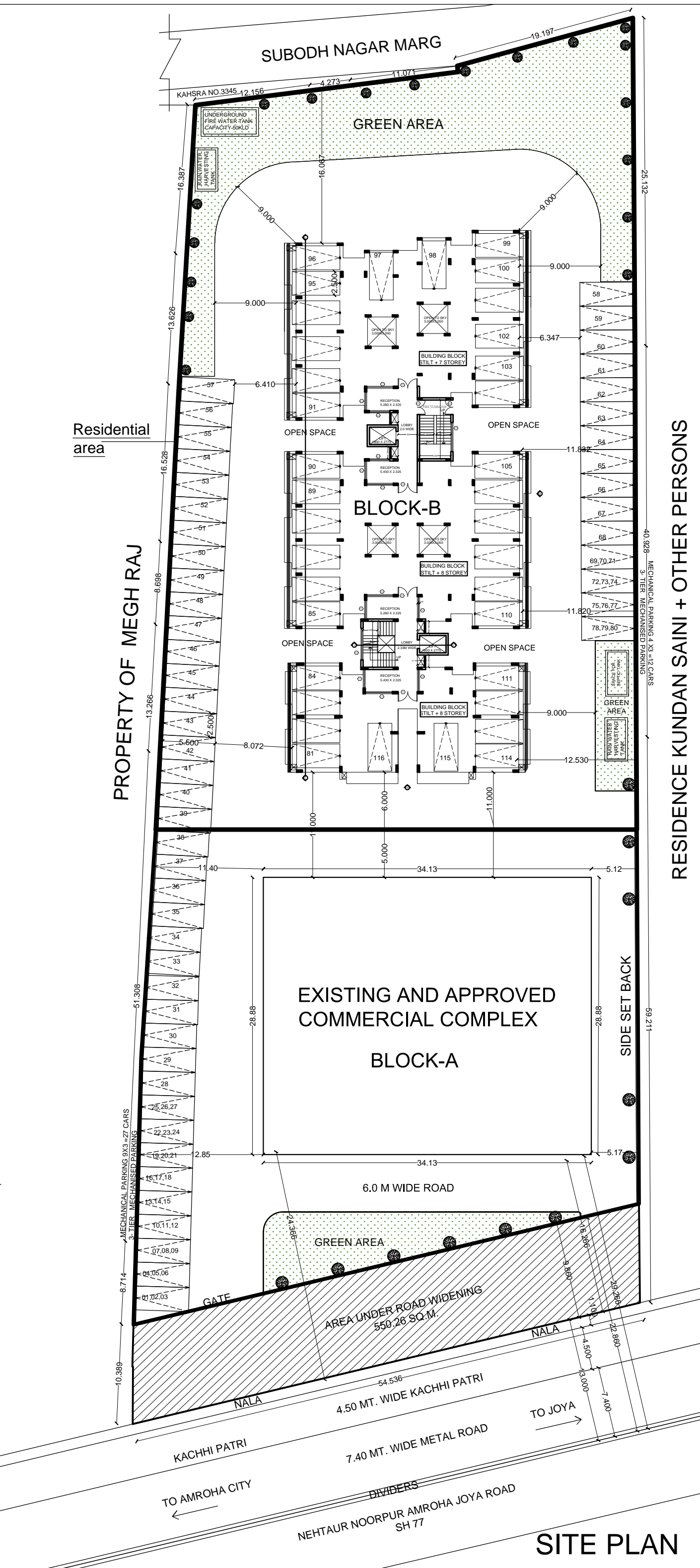

SITE PLAN