

— WASTE DISPOSAL PLAN —

DETAIL OF PREVIOUS SANCTIONED LOP

S.NO	DATE OF APPROVAL	APPROVED BY	DETAIL
(1)	26.04.2016	H.C.	—
(2)	13.06.2016	C.A.P.	DESIGN OF BOUNDARY WALL FOR BHINGA BARRACH
(3)	14.08.2016	H.C.	PROPOSED NUMBERED LAYOUT PLAN OF PARK
(4)	10.08.2016	H.C.	—
(5)	14.10.2016	H.C.	PROPOSED PLANTATION LAYOUT PLAN (64 NOS.)
(6)	16.12.2016	H.C.	PROPOSED REVISED LAYOUT PLAN
(7)	07.06.2017	H.C.	PROPOSED REVISED LAYOUT PLAN
(8)	21.12.2017	H.C.	L.O.P. FOR PMAY
(9)	01.07.2019	H.C.	L.O.P. FOR SHOWING CHANGE OF SPACE OF S.T.P.

CALCULATION OF POPULATION DENSITY OF SCHEME

S.NO.	AREA	BLOCK					Total Units	Allowed Units	Total Allowed Units	Per Unit Population	Total Population	
		A	B	C	D	E						
(1)	TILL 50 Sq.M.	-	-	-	88	-	192	280	1	280	5	1400
(2)	ABOVE 50 Sq.M. TO 150 Sq.M.	-	40	106	83	111	-	400	2	800	5	4000
(3)	ABOVE 150 Sq.M. TO 300 Sq.M.	20	25	53	11	11	-	251	4	924	5	4620
(4)	ABOVE 300 Sq.M. TO 2000 Sq.M.	-	-	-	-	-	-	-	-	-	-	-
	(i) ABOVE 300 Sq.M. TO BELOW 400 Sq.M.	-	-	2	-	4	-	6	4	24	5	120
	(ii) ABOVE 400 Sq.M. TO BELOW 500 Sq.M.	1	-	-	-	1	-	2	5	10	5	50
	(iii) ABOVE 500 Sq.M. TO BELOW 600 Sq.M.	-	-	-	-	-	-	-	-	-	-	-
	(iv) ABOVE 600 Sq.M. TO BELOW 800 Sq.M.	-	-	-	-	-	-	-	-	-	-	-
	(v) ABOVE 800 Sq.M. TO BELOW 900 Sq.M.	-	-	-	-	-	-	-	-	-	-	-
	(vi) ABOVE 900 Sq.M. TO BELOW 1000 Sq.M.	-	-	-	-	-	-	-	-	-	-	-
	(vii) ABOVE 1000 Sq.M. TO BELOW 1500 Sq.M.	-	-	-	-	-	-	-	-	-	-	-
	(viii) ABOVE 1500 Sq.M. TO BELOW 2000 Sq.M.	-	-	-	-	-	-	-	-	-	-	-
	Total	30	65	161	162	306	192	919	-	2041	-	10190
(5)	MIX LANDUSE PLOT	-	-	-	-	-	-	-	-	-	-	-
	ABOVE 150 Sq.M. TO 300 Sq.M.	-	-	5	10	-	-	15	4	60	5	300
	ABOVE 300 Sq.M. TO 2000 Sq.M.	-	-	-	-	-	-	-	-	-	-	-
	(i) ABOVE 300 Sq.M. TO BELOW 400 Sq.M.	-	-	2	2	-	-	4	4	16	5	80
	(ii) ABOVE 400 Sq.M. TO BELOW 500 Sq.M.	4	-	-	-	-	-	4	5	20	5	100
	(iii) ABOVE 500 Sq.M. TO BELOW 600 Sq.M.	2	-	-	-	-	-	2	6	12	5	60
	(iv) ABOVE 600 Sq.M. TO BELOW 800 Sq.M.	-	-	-	-	-	-	-	-	-	-	-
	(v) ABOVE 800 Sq.M. TO BELOW 900 Sq.M.	-	-	-	-	-	-	-	-	-	-	-
	(vi) ABOVE 900 Sq.M. TO BELOW 1000 Sq.M.	-	-	-	-	-	-	-	-	-	-	-
	(vii) ABOVE 1000 Sq.M. TO BELOW 1500 Sq.M.	-	-	-	-	-	-	-	-	-	-	-
	(viii) ABOVE 1500 Sq.M. TO BELOW 2000 Sq.M.	-	-	-	-	-	-	-	-	-	-	-
	Total	6	7	13	-	-	-	25	-	108	-	540
TOTAL POPULATION WITH MIX LANDUSE (10190+540)											10730	

FACILITIES FOR BAHRACH-BHINGA MARG BHUMI VIKAS @RIHASTHAN YOJANA,BAHRACH

SCHEME AREA (SQ.M.) 14961.00

TYPE	STANDARD'S	1 PER	REQUIRED FACILITIES	REQUIRED FACILITIES SAY(MANUALLY)	AS PER REDUCTION METHOD(MANUALLY)	REQUIRED FACILITIES	REQUIRED FACILITIES SAY(MANUALLY)	AS PER REDUCTION METHOD(MANUALLY)	TOTAL AREA FOR EDUCATIONAL	
EDUCATIONAL										
Degree / P. C. College	1 per 80000-100000 persons	80000	5000.00	0.33	0	0	0	0	0.00	
Junior College	1 per 10000 persons	10000	4000.00	1.07	1	1	1	1	4000.00	
Junior / High School	1 per 7500 persons	7500	3000.00	1.43	1	1	1	1	3000.00	
Primary school	1 per 5000 persons	5000	1000.00	2.15	2	2	2	2	2000.00	
Nursery school	1 per 2500 persons	2500	500.00	4.25	4	4	4	4	2000.00	
									TOTAL AREA FOR EDUCATIONAL	7000.00
MEDICAL / HEALTH FACILITY										
Hospital (100 beds)	1 per 100000 persons	100000	30000.00	0.21	0	0	0	0	0.00	
Child care / Maternity Hospital	1 per 45000 persons	45000	2000.00	0.24	0	0	0	0	0.00	
Health Centre	1 per 15000 persons	15000	800.00	0.72	1	1	1	1	800.00	
									TOTAL AREA FOR MEDICAL / HEALTH FACILITY	800.00
SOCIAL / CULTURAL CENTRE										
Community Hall	1 per 25000 persons	25000	1500.00	0.40	1	1	1	1	1500.00	
									TOTAL AREA FOR COMMUNITY FACILITY	1500.00

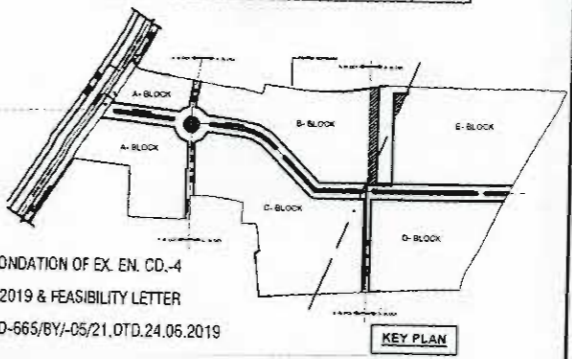
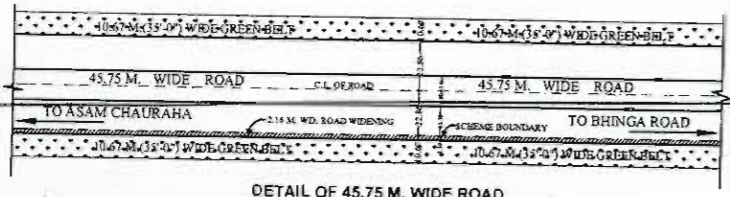

SANCTIONED SPACE FOR S.T.P. AS PER RECOMONDATION OF EX. EN. CD-4 VIDE HIS LETTER NO-545/BY-05/18, DTD.24.05.2019 & FEASIBILITY LETTER OF EX. EN. CD-4 AND S.E.-II VIDE HIS LETTER NO-565/BY-05/21, DTD.24.05.2019

SANCTIONED UNDER GROUND 33 kva HI. LINE AS PER INFORMATION RECEIVED FROM S.E.CIRCLE III VIDE HIS LETTER NO-2266/W-09/67, DTD.05.10.2020 EXISTING 33 kva HI. LINE HAS TO BE SHIFTED AS PER INFORMATION RECEIVED FROM S.E.CIRCLE III VIDE HIS LETTER NO-2266/W-09/67, DTD.05.10.2020

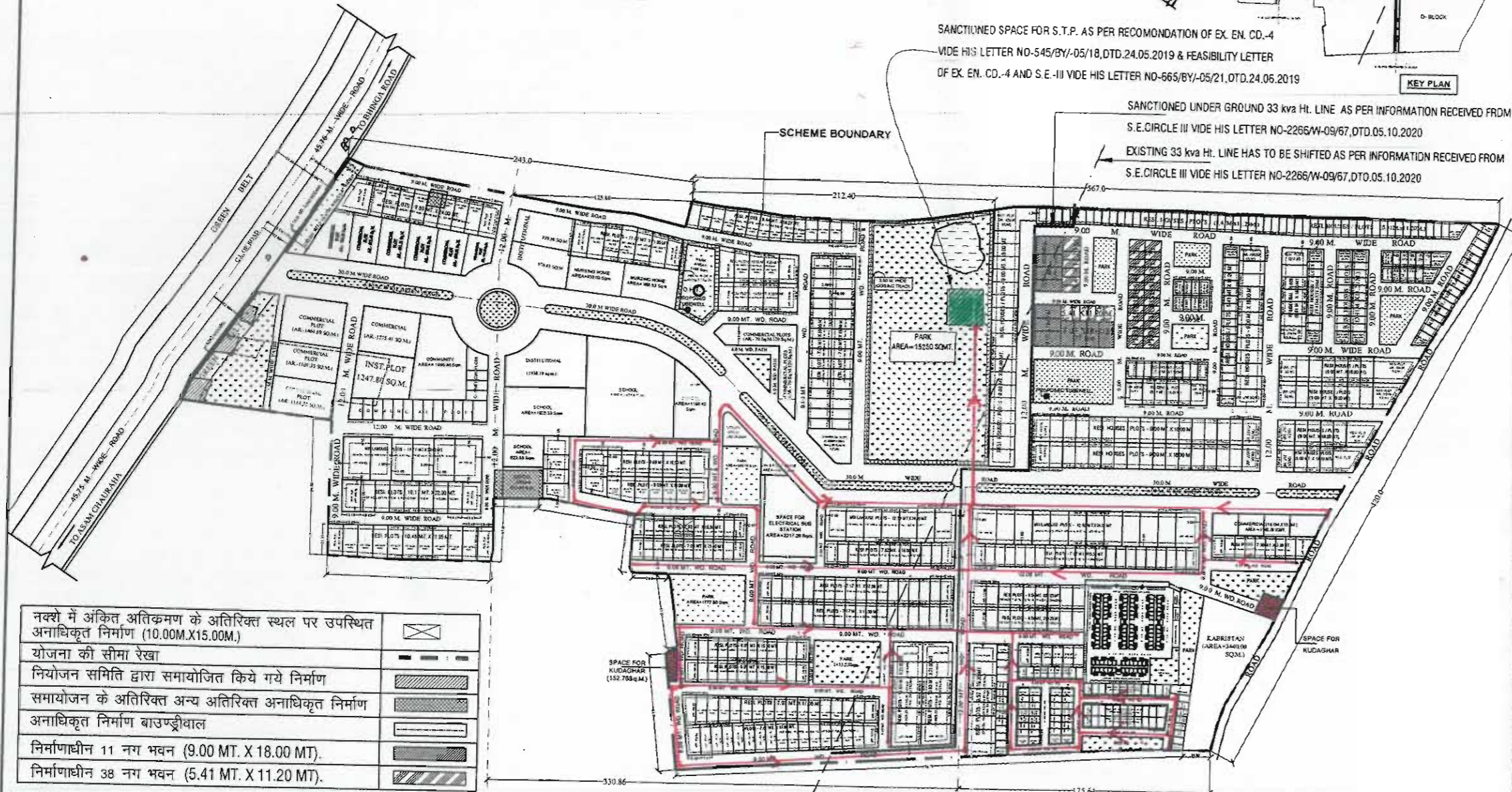

UPAVP
ARCHITECTURAL AND PLANNING SECTION UNIT-3
NEELGIRI COMPLEX, INDIRA NAGAR
LUCKNOW-226016

DRG. NO. REVISED/L.O.P./BHINGA MARG/BAHRACH/2020/..... PROCESS NAME/NO.5
FILE NO. APD/UNIT-3/BHINGA MARG/BAHRACH/01(PART-4) UPHB/PH/APD/

NOTES:
THIS LAYOUT PLAN HAS BEEN FINALIZED ON THE BASIS OF RECOMMENDATION AND FEASIBILITY OBTAINED AS BELOW :

- (1) S.E. (CIRCLE - III) LETTER NO.- 2266/67 DATED: 05.10.2020
- (2) S.E. (ELECT. CIR.) LETTER NO.- 1535/Y-61/35 DATED: 23.10.2020
- (3) E.E.C.D.-AYODHYA 3 LETTER NO.- 811/BY-1/3 DATED: 05.11.2020
- (4) S.E.(AYODHYA CIR.) LETTER NO.- 69/W-6/02 DATED: 05.11.2020
- (5) E.E.C.D.-AYODHYA 3 LETTER NO.- 668/BY-1/11 DATED: 20.11.2020
- (6) E.E.C.D.-AYODHYA 3 LETTER NO.- 886/BY-1/12 DATED: 25.11.2020
- (7) E.E.C.D.-AYODHYA 3 LETTER NO.- 937/BY-1/15 DATED: 05.12.2020
- (8) S.E.(AYODHYA CIR.) LETTER NO.- 263 DATED: 07.12.2020
- (9) E.E.C.D.-AYODHYA 3 LETTER NO.- 948/BY-1/17 DATED: 09.12.2020
- (10) E.E.C.D.-AYODHYA 3 LETTER NO.- 970/BY-1/18 DATED: 09.12.2020
- (11) S.E.(AYODHYA CIR.) LETTER NO.- 275/W-6/17 DATED: 10.12.2020
- (12) E.E.C.D.-AYODHYA 3 LETTER NO.- 985/BY-1/21 DATED: 14.12.2020
- (13) E.E.C.D.-AYODHYA 3 LETTER NO.- 1789/Y-61/54 DATED: 21.12.2020
- (14) E.E.C.D.-AYODHYA 3 LETTER NO.- 1037/BY-1/26 DATED: 23.12.2020

THE LAYOUT PLAN HAS BEEN FINALIZED ON THE BASIS OF DECISION TAKEN IN THE HIGH LEVEL COMMITTEE HEADED BY H.C. ON DATED 06.11.2020 & 11.12.2020.

→ PROPOSED SEWER LINE AS PER DESIGN
 PROPOSED SEWAGE TREATMENT PLANT (S.T.P.)
 KUDA-GHAR
 waiting JE
 AE

AREA DETAILS

S.NO.	AREA (Sq.m.)	PERCENT
TOTAL SCHEME AREA(Sqm.)	247071	
KABRISTAN AREA(Sqm.)	3440	
NET SCHEME AREA(Sqm.)	243631	
	60.00 ACRE	
1 RESI. PLOT	98528.08	40.44
2 COMMERCIAL AREA	13747.24	5.64
3 INSTITUTIONAL PLOTS	5101.86	2.09
4 NURSING HOME	1897.43	0.78
5 SCHOOL AREA	8407.54	3.45
6 COMMUNITY	2053.65	0.84
7 UTILITY	382.36	0.16
8 JAN SUVL KENDRA & P.O.	186.00	0.08
9 GREEN AREA	36780.90	15.10
10 KUDA GHAR	377.93	0.15
11 ELECTRICAL SUB STATION	2215.95	0.91
12 PARKING AREA (PMAY)	390.86	0.16
13 ROADS AREA	73561.54	30.19
TOTAL	243631.00	100.00

DRG. TITLE
PROPOSED REVISED LAY-OUT PLAN
PROJECT
BAHRACH-BHINGA MARG BHUMI VIKAS EVAM GRAH STHAN YOJNA BAHRACH

DATE : 23.12.2020

SCALE:

VIKAS SINGH D/MAN.(CIVIL)	SMITA ARCH. ASST.
ALOK KUMAR VERMA	SD : 23.12.2020
ASSTT.ARCH. PLANNER	SD : 23.12.2020
JYOTI KATIYAR	SD : 23.12.2020
ARCHITECT PLANNER	SD : 23.12.2020
S.J.YADAV	SD : 23.12.2020
SENIOR ARCHIT. PLANNER	SD : 23.12.2020
DINESH KUMAR	SD : 23.12.2020
CHIEF ARCHITECT PLANNER	SD : 23.12.2020
AJAY CHAUHAN I.A.S.	SD : 23.12.2020
HOUSING COMMISSIONER	SD : 23.12.2020

नक्शे में अंकित अतिक्रमण के अतिरिक्त स्थल पर उपस्थित अनाधिकृत निर्माण (10.00M.X15.00M.)	
योजना की सीमा रेखा	
नियोजन समिति द्वारा समायोजित किये गये निर्माण	
समायोजन के अतिरिक्त अन्य अतिरिक्त अनाधिकृत निर्माण	
अनाधिकृत निर्माण बाउण्ड्रीवाल	
निर्माणाधीन 11 नग भवन (9.00 MT. X 18.00 MT.)	
निर्माणाधीन 38 नग भवन (5.41 MT. X 11.20 MT.)	

DRG. No. 1/6	Master Document No.- 301	ANY DISCREPANCY FOUND IN THE LAYOUT KINDLY BRING IN TO THE NOTICE OF ARCHITECT PLANNER.
Document No.		
Date of Update		
Location		