

BASEMENT-2 FLOOR PLAN , (LVL -12000)

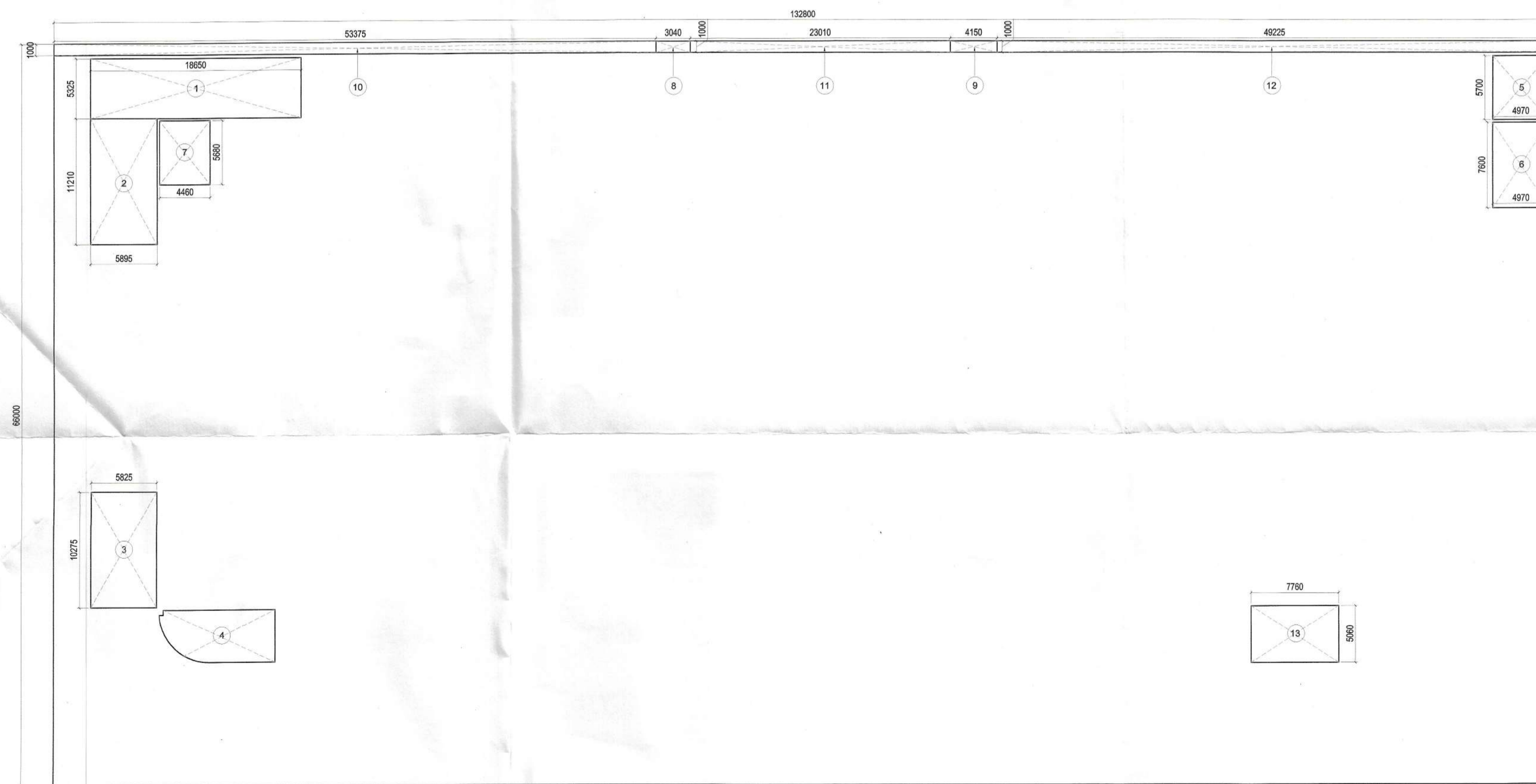

BASEMENT-2 AREA DETAIL

BASEMENT-2 AREAS DETAIL						
TOTAL AREA						
132.8	X	66.0	=	8764.8		
LESS AREA :						
1	1	X	18.650	X	Greater Noida Industrial Dev. Authority	99.311
2	1	X	5.895	X	11.21	66.083
3	1	X	5.825	X	10.28	59.852
4	1				P LINE AREA	43.570
5	1	X	4.97	X	5.70 upto Date	28.329
6	1	X	4.97	X	7.60	37.772
7	1	X	4.46	X	5.30	25.333
8	1	X	3.04	X	3.00	3.040
9	1	X	4.15	X	4.15	4.150
10	1	X	53.375	X	53.375	53.375
11	1	X	23.01	X	23.01	23.010
12	1	X	49.225	X	1.00	49.225
13	1	X	7.76	X	5.06	39.266
TOTAL						532.315
TOTAL BASEMENT-2 NON FAR AREA = TOTAL BASEMENT-2 AREA (-) LESS AREA						8232.485

15% PRESCRIBED FAR	
ITEM	AREA
SERVICES	= 99.311
SERVICES	= 66.083
SERVICES	= 59.852
SERVICES	= 43.570
SERVICES	= 28.329
SERVICES	= 37.772
SERVICES	= 25.333
SERVICES	= 3.040
SERVICES	= 4.150
TOTAL	
TOTAL	406.705

NOTE : ALL AREAS IN SQM

LEGEND :

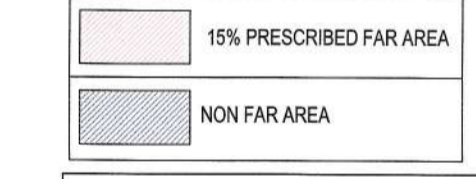

OWNERS:

M/S ADIHM DEVELOPERS PVT LTD, AT B-1/504, SATYAM APARTMENTS, THE NEW PROGRESSIVE, CGHS LTD, 20-B, VASUNDHARA ENCLAVE, DELHI-110096

PROJECT:

PROPOSED THE COMMERCIAL/MULTIPLEX AT C-3, COMMERCIAL BELT, ALPHA II, GREATER NOIDA, GAUTAMBUDH NAGAR U.P.

ARCHITECTS:

ATWIN
 BRIJ (INDIA) ARCHITECTS
 F-89, GREEN PARK, NEW DELHI -16.
 Ph. +91-11-26853815, 26858307, Fax : +91-11-26850788
 E-mail : biarch@rediffmail.com, info@atwin.in
 Website: www.atwin.in

SHEET TITLE :

BASEMENT-2
FLOOR PLAN & AREA DETAIL

DATE:	SCALE: N.T.S
DEALT BY:	
APPLICANT'S SIGNATURE	ARCHITECT'S SIGNATURE

For ADIHM DEVELOPERS PVT. LTD.
 AR. ATEESH AGARWAL
 F.I.I. DIP. PRGT. MGMT (LONDON)
 F.I.I.V-CAT/1-A-1879
 M.C.A.-2003/31212
 Authorised Signatory