

ITEM	AREA		AREA(SQ M)
U.G.T.	477.855	1	477.855
S.T.P. AREA	356.350	1	356.350
BALANCING TANK	57.153	1	57.153
	TOTAL		891.358

**LEGEND**

**LEGEND**

	CAR PARKING
	TWO-WHEELAR PARKING
	EARTH
	SERVICE AREA
	LOBBY & RAMPS AREA

PROJECT:  
PROPOSED SUBMISSION DRAWINGS  
FOR PROPOSED GROUP HOUSING AT  
PLOT No:- GH-01/B, SECTOR-10,  
GREATER NOIDA WEST (U.P) FOR  
M/s HEBE INFRASTRUCTURE PVT. LTD.

LOWER BASEMENT PLAN  
AND AREA CALCULATION

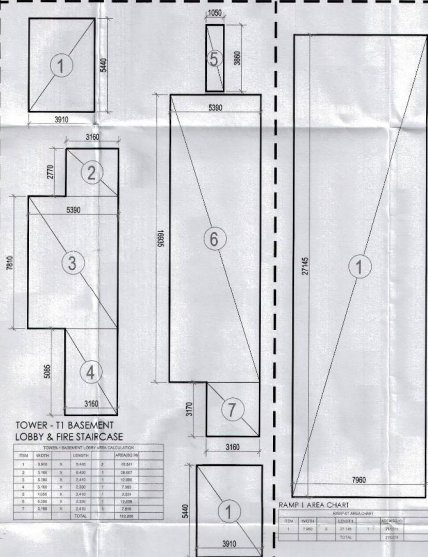
$$= 19521.45 \text{ SQ. MT.} - (112.206 + 170.143 + 192.655 + 477.865 + 216.074 + 356.347 + 57.153) \text{ SQ. MT.}$$

$$= 17939 \text{ SQMT.}$$

NO. OF ECS PROPOSED ON LOWER BASEMENT AREA  
= BASEMENT AREA / 30  
= 17939 / 30 = 597.9 (SAY 598 ECS)

For HEBE INFRASTRUCTURE PVT. LTD.  
  
 Authorised Signatory

DATE .

DRG. No.	
----------	--

SD-06