

External electrification

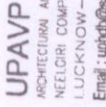
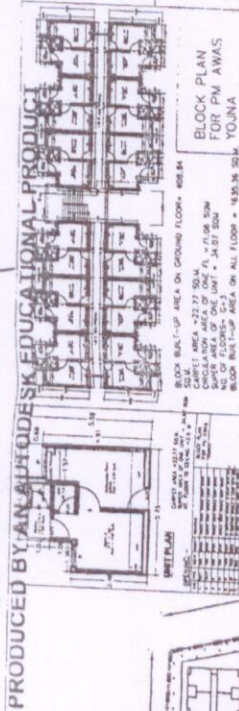

UPAVP
 ARCHITECTURE AND PLANNING SECTION
 NEELDRI COMPLEX, INDIRA NAGAR
 LUCKNOW - 226016
 Email: upavp@sanhatma.in

LAYOUT PLAN NAME
 SHEET NO.
 UPRD6/APD/UV-4/PMAY/C-D-II
 KANKAHA/189/2018

NOTE :-
 1. THIS LAYOUT PLAN HAS BEEN PREPARED ON THE BASIS OF INFORMATION RECEIVED FROM EX. EN. C.D.-11 VIDE HIS LETTER NO. 1835/M-724 DATED 24.08.2018.
 2. THIS LAYOUT PLAN HAS BEEN FINALIZED ON THE BASIS OF FEASIBILITY RECEIVED FROM EX. EN. C.D.-11 VIDE HIS LETTER NO. 1862/M-718 DATED - 28.08.2018.
 3. प्राणिमन्त्री आवास योजना के अर्न्तगत परिषद को दिये गये निर्धारित लक्ष्य के सापेक्ष उक्त योजना में भवनों का निर्माण डिमाण्ड सर्वे के आधार पर कराया जाना है।
AREA STATEMENT :-
 TOTAL LAND AREA - 42120.95 SQM (4.2 Hect.)
 COMMERCIAL AREA - 1839.62 SQ.MT. (4.32%)
 SCHOOL AREA - 1789.00 SQ.MT. (4.25%)
 GREEN AREA - 6391.78 SQ.MT. (15.17%)
 PARKING - 1352 NO. (2704.0 sq.m)
 @ 2sq.m /flat as per norms
 BLOCK AREA - 408.84 Sqm.
 GROUND COVERAGE - 11,447.52 Sqm. 27.17%
 F. A. R. - 1.08

E.M.S. TYPE DESIGN
 UNIT CARPET AREA - 22.77 SQ.MT.
 SUPER AREA OF ONE FLAT - 34.07 SQ.MT. 3676.00 Sqm
TOTAL LAND AREA - 42120.95 SQ.MT.
RESIDENTIAL:- TOTAL UNITS - 1344 432

PARTICULAR	NO. OF BLOCK	NO. OF UNIT IN EACH BLOCK	NO. OF FLOOR	TOTAL UNITS	UNIT AREA (SQ.MT)	SUPER AREA OF UNIT (SQ.MT)
E.W.S.	28	48	G+3	432	22.77	34.07

ARCHITECTURE & PLANNING UNIT - 4
 U.P. AVAS EVAM VIKAS PARISHAD LUCKNOW
 LAY-OUT PLAN OF PMAY
 VILL. - KANKAHA, MOHAN LAL GANJ, LUCKNOW.

DATE : 31-08-2018

R. S. MAURYA
 ARCH. ASSTT
 ALOK KUMAR VERMA
 ASSTT. ARCH. PLANNER
 SANJEEV KASHYAP
 ARCHITECT PLANNER
 A. K. SHUKLA

CHIEF ARCHITECT PLANNER
 AJAY CHAUHAN