

NORTH POINT		This drawing is a "COPYRIGHT" contents of this drawing or part thereof may not be used or reproduced without the permission of the Architect	
NO. OF PRINTS	DATE	ISSUED TO	REMARKS
REVISION	DATE	DESCRIPTION	BY

GENERAL NOTES:-

- 1.) INTERNAL DOOR / WINDOW & GLAZING TO BE AS PER INTERIOR DESIGN.
- 2.) FURNITURE LAYOUT IS INDICATE- TO BE AFTER INTERIOR DESIGN.
- 3.) ROADS, PATHWAYS, PLAY AREA DETAILS TO BE REFER LANDSCAPE DRWAING NO. - SD-LD- 101

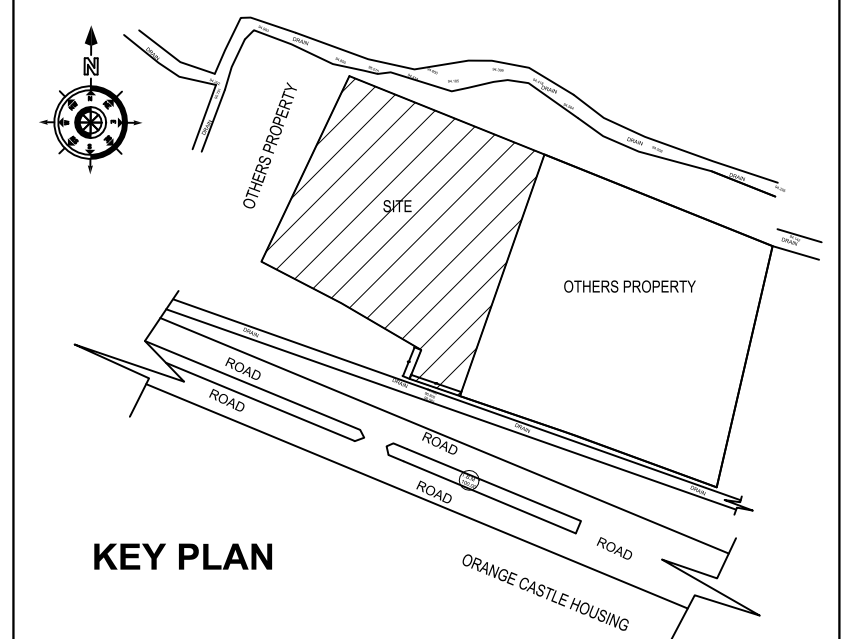

CLIENT
PRESTIGIA DEVELOPERS LLP

PROJECT

**RESIDENTIAL AT GOMTI NAGAR EXTN.
LUCKNOW**

DESIGN DEVELOPMENT DRAWING

DATE	DEALT BY	CHECKED BY
JANUARY - 2024	BILLU SHARMA	NARESH SHARMA
SCALE	PROJECT ARCHITECT	APPROVED BY
1:160	SUBODH KUMAR	DIKSHU C. KUKREJA

DRAWING TITLE
BASEMENT LEVEL-02 PLAN

ARCHITECTS:-

C. P. KUKREJA ARCHITECTS

ASHIRWAD BUILDING
D-1, GREEN PARK,
NEW DELHI - 110016,
PHONE:- 26863953 FAX:- 26865770,
EMAIL- cpka@cpkukreja.com

DRAWING NO.	REVISION
845-PDL-DD-A-BP02	R0