

MAHAGUN MANORIAL

CARPET AREA = 1878.00 SQ.FT.

BALCONY AREA = 481.00 SQ.FT.

TERRACE AREA = 402.00 SQ.FT

WING-3 (Bridewell Palace)

UNIT-NO. 103 (FIRST FLOOR)

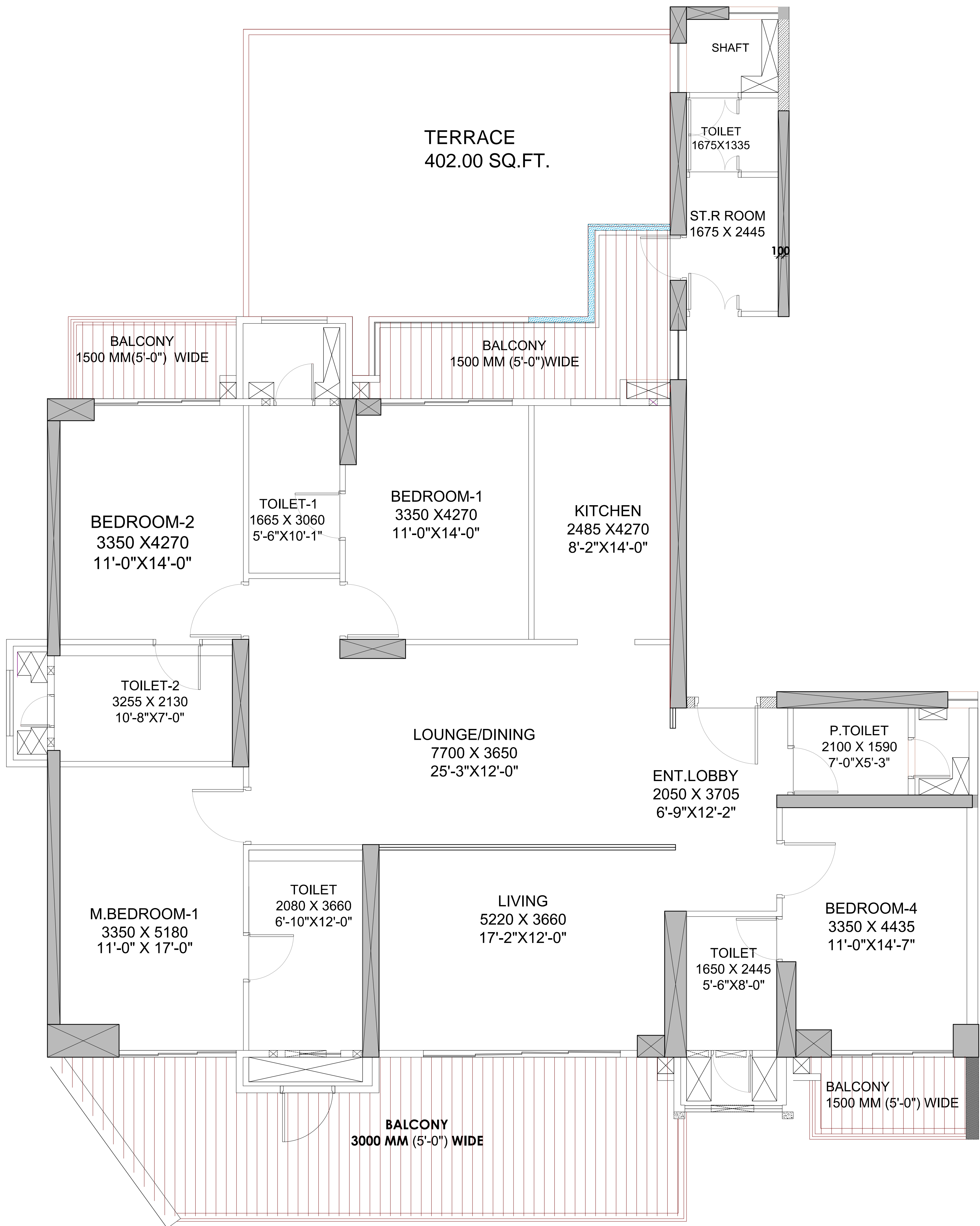

Disclaimer:- Carpet Area has been calculated based on the clarification issued by
Maharera via- MAHARERA/SECY/FILE No: -27/84/2017 Dated:-14 june 2017