

S.NO.	FLOOR	TOWER-A			TOWER-B			TOWER-C			TOWER-D			TOWER-E			TOWER-F			TOWER-G			COMMERCIAL		SCHOOL		COMMUNITY		TOTAL AREA	EWS / LIG	TOTAL COVERED AREA
		FAR	5% FACILITY	NO.OF DUS	FAR	5% FACILITY	NO.OF DUS	FAR	5% FACILITY	NO.OF DUS	FAR	5% FACILITY	NO.OF DUS	FAR	5% FACILITY	NO.OF DUS	FAR	5% FACILITY	NO.OF DUS	FAR	5% FACILITY	NO.OF DUS	FAR	5% FACILITY	NO.OF DUS	FAR	5% FACILITY	NO.OF DUS			
1	STILT/GROUND	79.261	23.465		79.261	23.465		79.261	23.465		79.261	23.465		79.261	23.465		79.261	23.465		79.261	23.465		65.160		396.124	196.245	1365.655	42.533			
2	1st	568.109	33.354	4	476.065	32.947	4	486.072	33.025	4	568.109	33.354	4	476.065	32.947	4	575.995	33.519	6	594.719	33.519	6						4635.328	172.966		
3	2nd	568.109	33.354	4	476.065	32.947	4	486.072	33.025	4	568.109	33.354	4	476.065	32.947	4	575.995	33.519	6	594.719	33.519	6						3977.799	172.966		
4	3rd																											1736.921	172.966		
5	4th																											1736.921	172.966		
6	5th																											1736.921	172.966		
7	6th																											1736.921	172.966		
8	7th																											1736.921	172.966		
9	8th																											1736.921	172.966		
10	9th																											1736.921	172.966		
11	10th																											1736.921	172.966		
12	11th																											1736.921	172.966		
13	12th																											1736.921	172.966		
14	13th																											1736.921	172.966		
15	14th																											1736.921	172.966		
16	15th																											1736.921	172.966		
17	16th																											1736.921	172.966		
18	17th																											1736.921	172.966		
19	18th																											1736.921	172.966		
20	19th																											1736.921	172.966		
21	20th																											1736.921	172.966		
22	21st																											1736.921	172.966		
23	22nd																											1736.921	172.966		
24	23rd																											1736.921	172.966		
25	24th																											1736.921	172.966		
26	25th																											1736.921	172.966		
27	26th																											1736.921	172.966		
28	27th																											1736.921	172.966		
29	28th																											1736.921	172.966		
30	29th																											1736.921	172.966		
31	30th																											1736.921	172.966		
32	FAR AREA OF EXTRA BALCONY	1.52			1.36			0.80			1.52			10.880											21.313	28.660	40.680	864.239	66.05		
33	MUMTY MACHINE ROOM																											66.050			
34	EWS / LIG MUMTY																											66.050			
35	TOTAL AREA	1216.991	201.735		1011.453	200.921		1052.085	201.077		1216.991	201.735		7548.081	662.179		17123.808	1136.919		17906.902	1136.919		205.320	21.313	820.908	438.870	52970.437	3491.630	56093.047		
36	FIRE STAIR CASE																											2776.390			
37	UPPER BASEMENT																											21566.964			
38	LOWER BASEMENT																											21566.964			
39	PODIUM																											11706.790			
40	GROUND COVERAGE	638.265			564.927			574.712			638.265			564.927			662.267			665.338			140.160		396.124	201.945	5238.066	181.136	113679.155		
41	TOTAL UNITS		8		8			8			8			64			180			180			180					456.000			

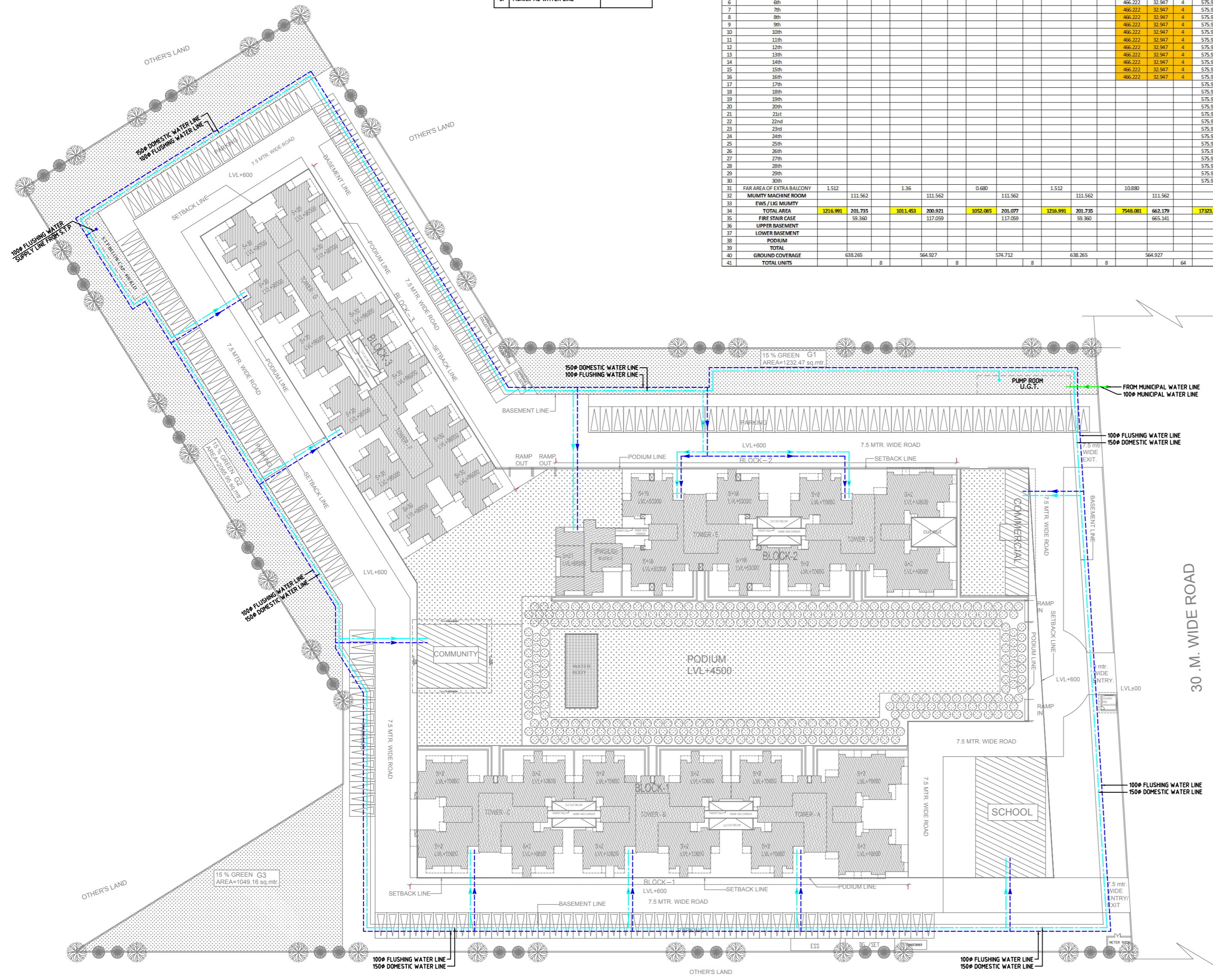

- TOTAL PLOT AREA = 28697.000 SQMT
- PERMISSIBLE GROUND COVERAGE @ 40% OF PLOT AREA = 11478.800 SQMT.
- PROPOSED COVD AREA ON GROUND FLOOR HOUSING + EWS/LIG + SCHOOL + comm. + community = 5228.066 SQMT (18.21%)
- PERMISSIBLE PRINCIPLE FAR :250 = 71742.500 SQMT.
- PROPOSED AREA (FAR + NON FAR) = 52570.437 SQMT.
- PERMISSIBLE AREA UNDER 5% FACILITY (5% OF 52570.437) = 2628.520 SQMT.
- TOTAL PROPOSED FAR (5-6) = 49941.917 SQMT.
- AREA UNDER IGBC GREEN @ 5% OF 49941.917 = 2497.094 SQMT.
- AREA UNDER EWS/LIG = 3491.610 SQMT.
- NET PROPOSED FAR AREA = 43953.213 SQMT.(153)
- TOTAL COVERED AREA OF UPPER BASEMENT = 21566.964 SQMT.
- TOTAL COVERED AREA OF LOWER BASEMENT = 21566.964 SQMT.
- TOTAL COVERED AREA OF STILT/PODIUM(NON TOWER) = 11706.790 SQMT.
- TOTAL COVERED AREA OF FIRE STAIRCASE = 2776.390 SQMT.
- TOTAL COVERED AREA (5+9+11+12+13+14) = 113679.155 SQMT.

- DETAIL OF DENSITY
- PERMISSIBLE DENSITY = 1650 PPH
 - NO. OF PERSON (1650 X 2.8697) = 4735.005 SAY 4735
 - PERMISSIBLE DWELLING UNITS (4735 / 5) = 947 NOS.
 - PROPOSED NO. OF DWELLING UNITS = 456 NOS.
 - PROPOSED DENSITY OF HOUSING UNITS (456 X 5 / 2.8697) = 794.50 PPH



DEVELOPER :- M/S Ramprastha Urban Development Pvt. Ltd.
 Project:-
 PROPOSED GROUP HOUSING ON
 KH.NO. 69m,70m,70mi,71m,71mi,72m,72mi,73m,73mi,76m,76mi,77/2 ,79mi
 AT VILLAGE CHHAJARS,TEHSHIL - DADRI, DIST - GAUTAM BUDDHA NAGAR, U.P.

TITLE:- DUAL PLUMBING SITE LAYOUT PLAN
 SCALE =
 Drawn - Drg. No SUB-P-PL-03

Owner :- ANJU YADAV
 KANTA YADAV
 SURAT SINGH,
 M/S HARJAS PICTURES PVT. LTD.
 M/S MAHAMAYA ISPAT UDYOG PVT. LTD.
 M/S RAMPRASTHA PROPERTIES PVT. LTD.

Owner Sign:-

Architect Sign:-

PLUMBING CONSULTANTS :-
PEE CONSULTANTS
 815-C, EAST OF LONI ROAD
 SHAHADRA, DELHI-110093
 PH: 011-22816297,22815897
 EMAIL: pdss_in@yahoo.com,
 nrcons@gmail.com

Architect:-
RD DESIGN ATRIUM
 ARCHITECTS & URBAN PLANNERS
 1st FLOOR, D-1,SECTOR-7 NOIDA-201301
 Ph: 0120-4220363, 4323408
 e-mail- office@rddesign.in

