

LEGEND :

S. No.	SYMBOL	DESCRIPTION
1.		CHAMBER 750 x 750 x 1000 MM
2.		

NOTES :

- Clear height of 11 KV Meter / VCB room shall be minimum 3.6 mtr.
- Plinth Level of 11 KV Meter room shall be 450 mm above final finished ground level of internal road
- Trench detail shall be finalized after receiving foundation detail of 11 KV Meter / VCB Panel
- The exact size of DG exhaust pipe shall be finalized by the vendor after calculating the Back Pressure as per actual site conditions
- The foundation of 11 KV VCB Panel shall be as per manufactures details.

THE CABLE / TRENCH SHOWN IN THE DRAWING IS CONCEPTUAL ONLY. THE CONTRACTOR ARE ADVICE TO PREPARE SHOP DRAWING FOR APPROVAL BEFORE EXECUTION.

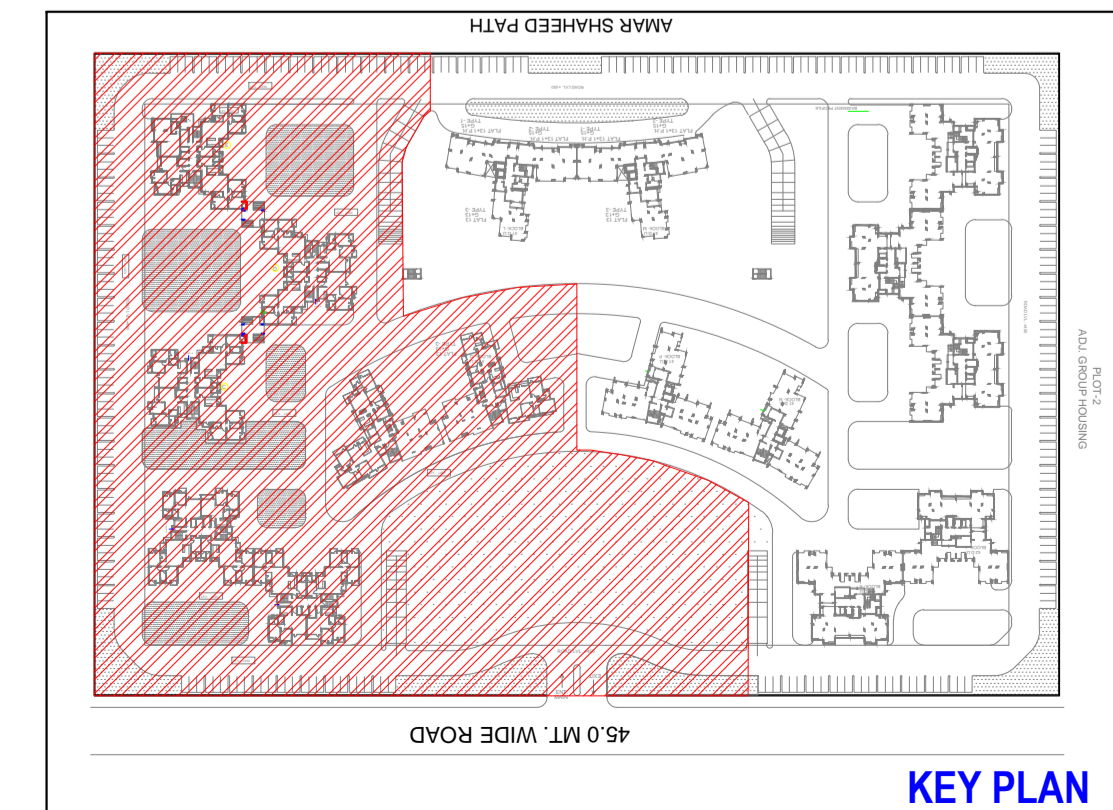

R1	02.06.2016	Club building Added
rev. no.	date	revision
project CELEBRITY GREENS AT LUCKNOW		
title SETTING OUT PLAN		
subtitle LAYOUT PLAN		
drawing released for <input checked="" type="checkbox"/> APPROVAL <input type="checkbox"/> SUBMISSION <input type="checkbox"/> TENDER <input type="checkbox"/> CONSTRUCTION		
drg. no.	CG / SO / EE-01	drawn by Mandeep
scale	1:400	designed by M. Sadiq
date	Aug. 2015	checked by Anand Havelia
architects Mr. PRITAM PATTANAYAK		
services consultant Consummate Engineering Services (P) Ltd.		
Noida Office : B - 67, Sector - 67, Noida - 201 301 Tel : (0120) 2593500 (30 Lines) Lko. Office : R 006, Rohtas Puri, Gomti Nagar, Lucknow e mail : mail@cespi.in, website : www.cespi.in		