

RIVER

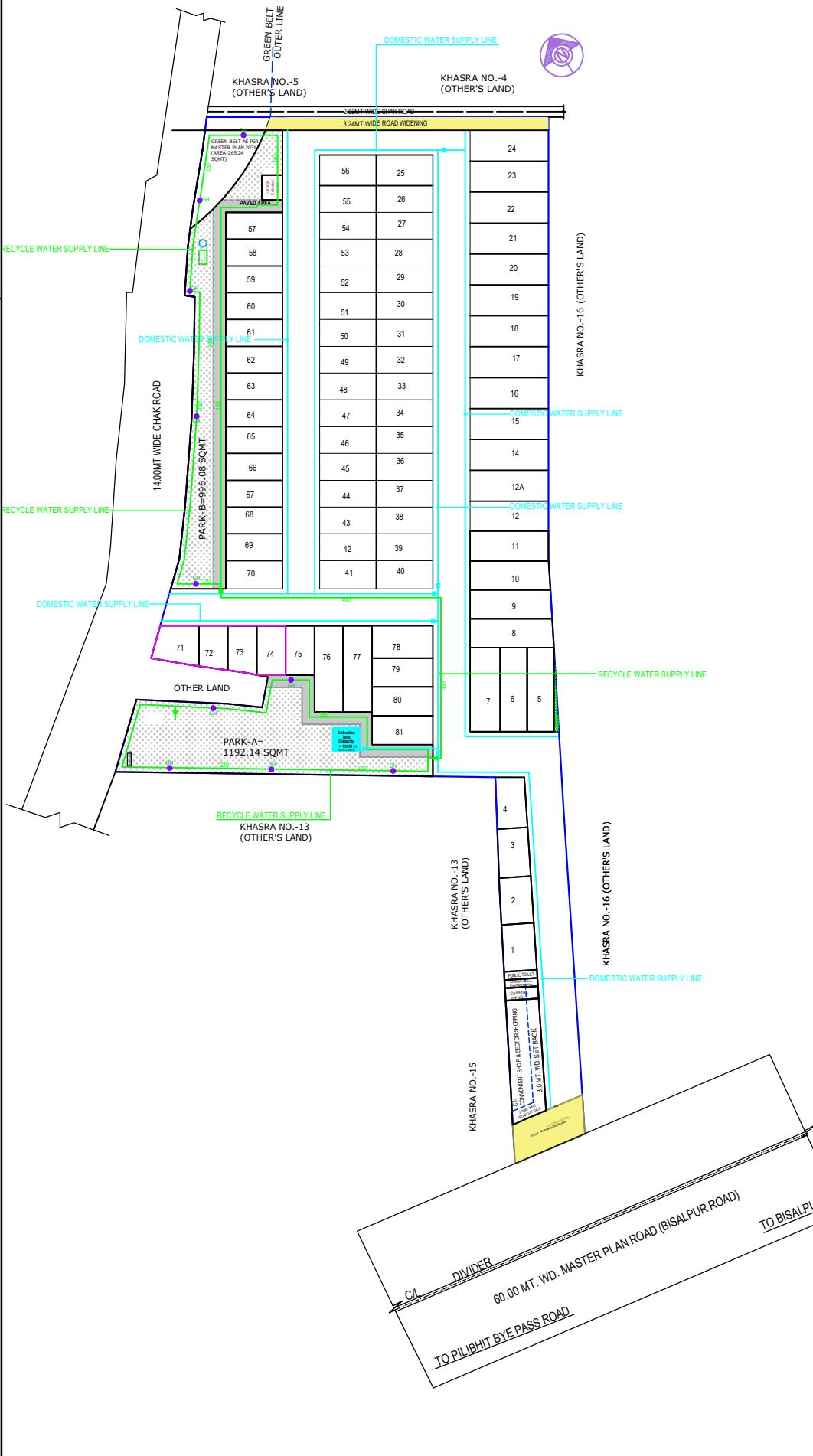

- NOTES : WATER SUPPLY**
1. The depth of domestic water supply main shall be - 900 mm
 2. The depth of recycle water supply shall be - 1100 mm
 3. The depth of rising main line shall be - 1200 mm
 4. Pipe material for external Domestic water supply, tube well rising main & recycle water supply line shall be : UPVC (IS: 4973)

LEGEND :

S.No.	SYMBOL	DESCRIPTION
1.		COLD WATER SUPPLY LINE
2.		RECYCLE WATER SUPPLY LINE
3.		RISING MAINS FROM TUBEWELL (RSM)
4.		ISOLATING VALVE FOR RECYCLE WATER SUPPLY LINE
5.		ISOLATING VALVE FOR DOMESTIC WATER SUPPLY LINE
6.		GARDEN HYDRANT
7.		
8.		

Rev. No.	Date	Revision
Project : KING'S PALM PARADISE AT BAREILLY		
Title : MEP DRAWING		
Subtitle : EXTERNAL WATER SUPPLY		
Drawing Released For :		
<input type="checkbox"/> APPROVAL	<input type="checkbox"/> SUBMISSION	
<input type="checkbox"/> ADVANCE COPY	<input type="checkbox"/> CONSTRUCTION	
Drg. No. : <input type="text"/>		
Scale : <input type="text"/>		
Date : <input type="text"/>		
Ckd By : <input type="text"/>		
CLIENT'S SIGNATURE :	ARCHITECT'S SIGNATURE	
	MOHIT SINGH B.ARCH SPA BHOPAL CA/2018/92317	
Architect :	STUDIO DESIGN VIEWS	
<small>First Floor, Design Complex, Piloth Road, Bareilly MB. (051)-2540554, +91-896615714 WEBSITE : www.studiodesignviews.com</small>		
Services Consultant :	graft studio	
<small>Shop no. 09, Shri Jagdamba Market Rithala, Rohini, Delhi, 110085</small>		

