

कार्य का नाम:- जनपद बिजनौर की तहसील नजीबाबाद में परिषद की "कोटद्वार रोड भूमि विकास एवं गृहस्थान योजना संख्या-1, नजीबाबाद" में आंतरिक जलापूर्ति पाईप लाईन डालने का कार्य  
 मुख्य अभियंता (म0) द्वारा स्वीकृत जलापूर्ति परिकल्पना, जिसको उपनिदेशक, गुण नियंत्रण एवं परिकल्पना खण्ड-1, लखनऊ के पत्र संख्या-636/ वाई-62/26 दिनांक 27.09.2017 द्वारा निर्गत किया गया है, के आधार पर तैयार

ड्राईंग-



UPHDB  
 ARCHITECTURE AND PLANNING SECTION  
 NEELGIRI COMPLEX, INDIRA NAGAR,  
 LUCKNOW-226016  
 E-MAIL: uphdb@sancharnet.in

DATE:- 09.02.16  
 PROPOSED TRANSPORT LAYOUT PLAN OF KOTDWAR ROAD  
 BHOOMI VIKAS EVAM GRAHSTHAN YOJNA,  
 NAJIBABAD, DISTT. BIJNOR.  
 FILES NO. - APD/UN-2/NTR/40-1/07/319  
 DRG. NO. - APD/UN-2/CIR-V/NTB/No1/LOP-01

1. ALL DIMENSIONS ARE IN METER.  
 2. FIGURED DIMENSIONS SHALL BE FOLLOWED.  
 3. ANY DISCREPANCY, IF FOUND IN THE DRAWING SHALL BE BROUGHT TO THE NOTICE OF A.P. UNIT-2, BEFORE EXECUTION OF WORK.  
 4. THIS TRANSPORT LAYOUT PLAN HAS BEEN PREPARED ON THE BASIS OF INFORMATION RECEIVED FROM E.E.-CD-24 VIDE HIS LETTER NO 546 /G-18/ DATED 05.05.15 ON WHICH FEASIBILITY PROVIDED BY E.E.-CD-24 VIDE HIS LETTER NO -890 /Y-41/ 90, DATED - 20.07.15.  
 5. THIS DETAILED LAYOUT PLAN HAS BEEN PREPARED ON THE BASIS OF INFORMATION / REQUIREMENT AND DETAILED TOPOGRAPHICAL SURVEY PROVIDED BY E.E.-CD-24 VIDE HIS LETTER NO.1210 /Y-41 /110, DATED -22.09.15 AND S.E.CIR.V, VIDE HIS LETTER NO.1892 /W-16 /24, DATED -22.09.15 & WHICH IS AGAIN REVISED ON THE BASIS OF LATEST DETAILED TOPOGRAPHICAL SURVEY PROVIDED BY E.E.-CD-24 VIDE HIS LETTER NO.1559 /Y-41 /126, DATED -02.12.15.  
 6. THIS DETAILED LAYOUT PLAN HAS BEEN PREPARED ON THE BASIS OF FEASIBILITY RECEIVED FROM E.E.-CD-24 VIDE HIS LETTER NO.1628 /Y-41/134, DATED-19.12.15.  
 7. THIS DETAILED LAYOUT PLAN HAS BEEN FINALIZED ON THE BASIS OF FEASIBILITY RECEIVED FROM E.E.-CD-24 VIDE HIS LETTER NO.947 /41/01, DATED-21.01.16 AND S.E.CIR.-V VIDE HIS LETTER NO.158/W-16/05, DATED 29.01.16.

PROPERTY DETAIL-

S.NO.	PARTICULARS	SIZE(M)	AREA	TOTAL (NOS.)
1	Resi. Plots	11.30 X 22.70	256.50	34
		9.00 X 18.00	162.00	64
		8.50 X 15.00	127.50	30
		6.00 X 12.00	72.00	111
		TOTAL		239
2	Resi. Houses	5.41 X 11.20	60.59	37
		4.85 X 8.40	40.74	309
	TOTAL		346	
3	COMMERCIAL PLOTS	-	6051.05	10
4	COMMUNITY CENTRE	-	2572.68	1
5	PRIMARY SCHOOL	-	1981.75	1
6	S.T.P.	-	2234.09	1
	TOTAL			13
	G.TOTAL			598

SCHEME AREA = 123009.19 SQM  
 SCHEME AREA = 12.301 HECTARE

LANDUSE DETAILS:-

S.NO	DESCRIPTION	AREA (hect.) approx	% age
1.	RESIDENTIAL AREA	49716.35	40.42
2.	COMMERCIAL AREA	6155.67	4.95
3.	EDUCATIONAL	1981.75	1.61
4.	FACILITY/S.T.P.	2234.09	1.82
5.	COMMUNITY CENTRE	2572.68	2.09
6.	GREEN / OPEN AREA	18456.06	15.00
7.	CIRCULATION AREA	41908.59	34.07
	TOTAL	123009.19	100.00

PROPOSED TRANSPORT LAYOUT PLAN OF KOTDWAR ROAD  
 BHOOMI VIKAS EVAM GRAHSTHAN YOJNA,  
 NAJIBABAD, DISTT. BIJNOR.

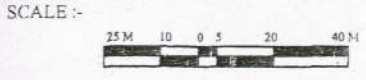

DEEP MALA  
 ARCH. ASSTT. I  
 HEMA SHAH  
 ASSTT. ARCHITECT PLANNER  
 GOPAL GARG  
 ARCHITECT PLANNER  
 R.P.SINGH  
 ADDITIONAL HOUSING COMM. & SECRETARY  
 SHAHABUDDIN MOHAMMAD  
 ASSTT. ARCHITECT PLANNER

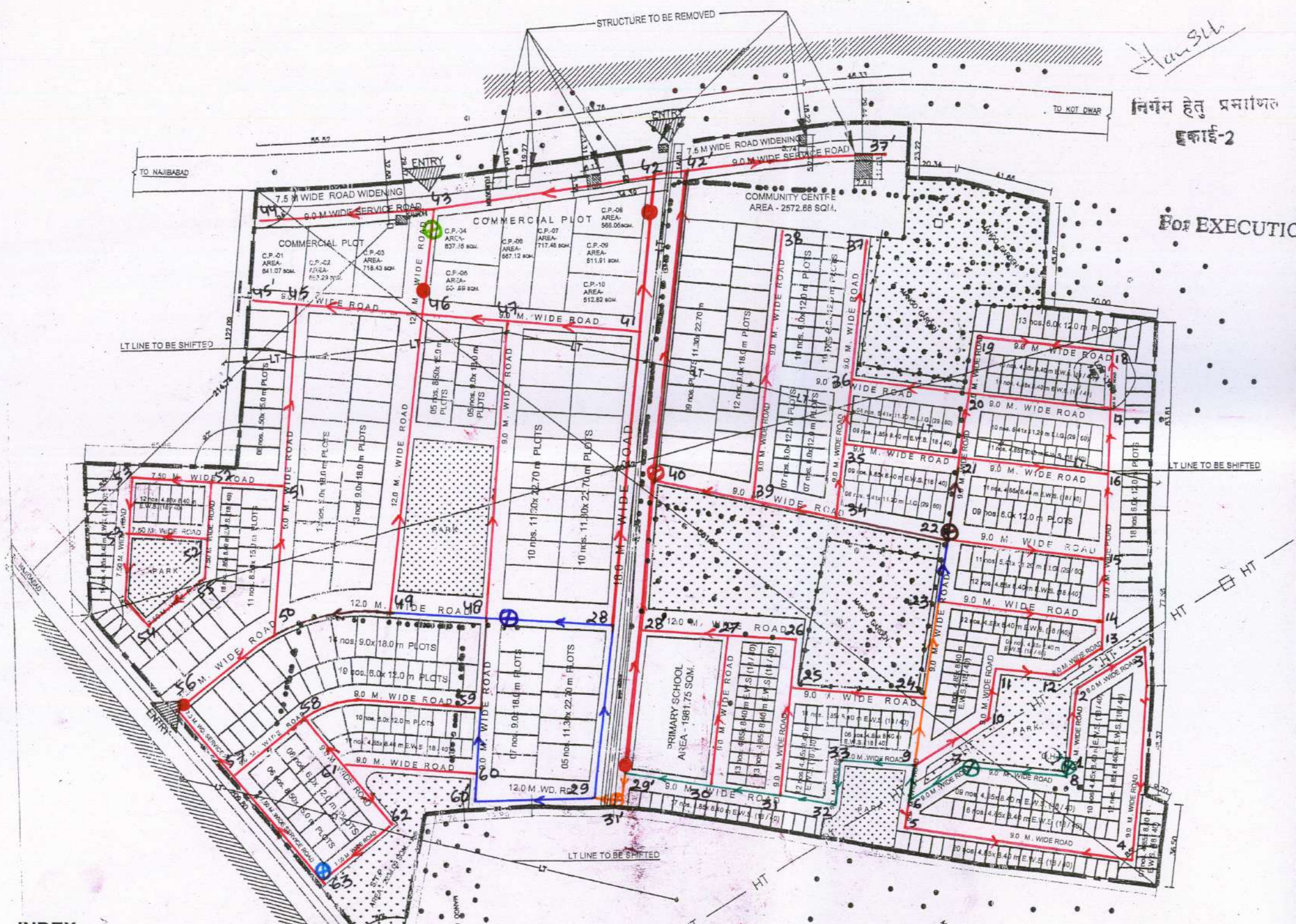

INDEX.

- |                                      |  |   |  |
|--------------------------------------|--|---|--|
| 1. WATER LINE 200mm dia (Sanctioned) |  | 6. C.I. SLUICE VALVE 200mm dia (Proposed) |  |
| 2. WATER LINE 150mm dia (Sanctioned) |  | 7. C.I. SLUICE VALVE 150mm dia (Proposed) |  |
| 3. WATER LINE 125mm dia (Sanctioned) |  | 8. C.I. SLUICE VALVE 125mm dia (Proposed) |  |
| 4. WATER LINE 100mm dia (Sanctioned) |  | 9. C.I. SLUICE VALVE 100mm dia (Proposed) |  |
| 5. WATER LINE 80mm dia (Sanctioned)  |  | 10. C.I. SLUICE VALVE 80mm dia (Proposed) |  |
|                                      |  | 11. FIRE HYDRENT 80mm dia (Proposed)      |  |
|                                      |  | 12. AIR VALVE 20mm dia (Proposed)         |  |
|                                      |  | 13. SCOURE VALVE 80mm dia (Proposed)      |  |

Controlled Copy No. 01...

अवर अभियंता, सहायक अभियंता, आयुक्त अभियंता

अधीक्षण अभियंता  
 पंचम वृत्त, मुरादाबाद