

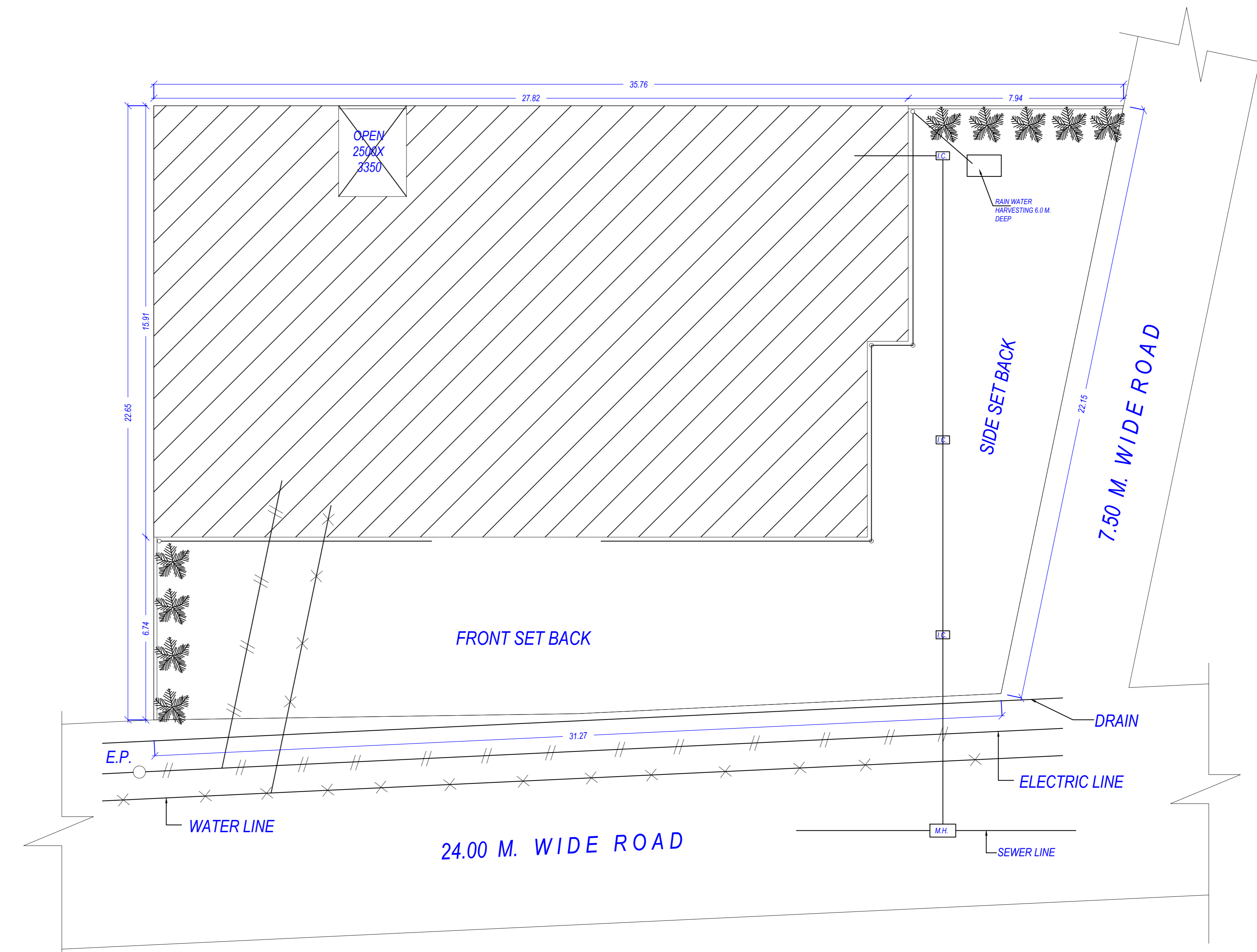

**PARKING PLAN**  
SCALE 1:100



**LANDSCAPE & SERVICES PLAN**  
SCALE 1:100

Note: - 1) This drawing is prepared as per the current prevailing Building Bye Laws.  
2) If Map sanctioned is used for purpose anything other than stated in application will lead to rejection of Map.

Total Plot Area: -	745.41	Total FAR Area: -	1592.66
Total Coverage Area: -	426.67	Total BUA Area: -	1997.30

OWNER'S NAME AND SIGNATURE SRV Infraestate Pvt Ltd.arpawamishra@gmail.com.8887512341	
ARCHITECT'S NAME AND SIGNATURE PAWAN MISHRA CA/0434606 Registered Architect Lucknow Development Authority	
 	
Building Plan Application Number LDA/BP/22-23/1216	
Sanctioned On 28 Jul 2022	
Valid Till 28 Jul 2027	
Approved By Vice Chairman (Vice Chairman)	
Examined By Ram Kumar Awasthi (Junior engineer) Jaiveer Singh (Junior engineer) Nagendra Singh (Assistant Engineer) Bhupendra Veer Singh (Executive engineer)	
Nitin Mital (Chief Town Planner) Pawan Kumar Gangwar (Secretary)	