

← WASTE DISPOSAL PLAN →

REVISED LAY OUT PLAN OF INTERNAL DRAIN OF EWS & LIG FLATS
AT SECTOR-13, VRINDAVAN YOJNA, LUCKNOW, UP

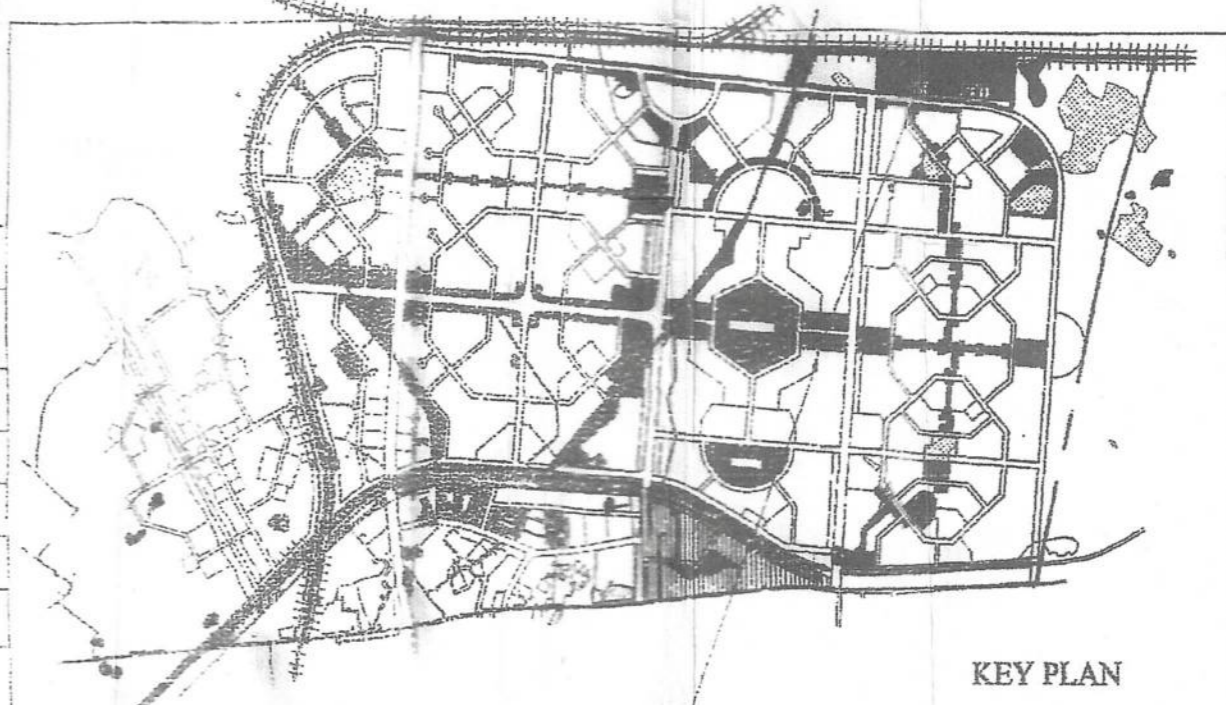
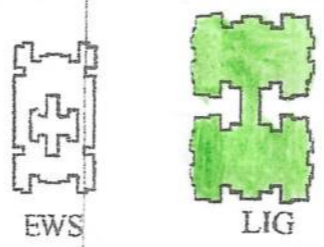

LAND USE			
1	RESIDENTIAL AREA	25440.00 M ²	26.36 %
2	OPEN/ GREEN AREA	37553.10 M ²	38.92 %
3	SCHOOL PLOT	1196.50 M ²	1.24 %
4	COMMERCIAL-1	3507.00 M ²	3.65 %
5	COMMUNITY CENTER	2531.00 M ²	2.62 %
6	AANGAN BARI KENDRA	697.00 M ²	0.72 %
7	ROADS AREA	25572.00 M ²	26.50 %
TOTAL		96496.60 M ²	100.00 %

PROPERTY DETAIL										
LAND AREA		96496.60 M ²								
S.N.	PARTICULAR	NO. OF BLOCK	NO. OF UNIT EACH BLOCK	NO. OF FLOOR	TOTAL UNITS	UNIT AREA (SQ.M)	CARPET AREA OF UNIT (SQ.M)	BLOCK AREA (SQ.M)	AREA (GROUND COVER) (SQ.M)	AREA (P.A.P) (SQ.M)
(A)	E.W.S.	30	08	G+3	960	40.00	27.00	1280	9600	38400
(B)	L.I.G.	33	08	G+3	1056	60.00	40.00	1920	15840	63360
TOTAL		63			2016			3200	25440	101760
F.A.R. ACHIEVED										1.054
GROUND COVERAGE (%)										26.36 %

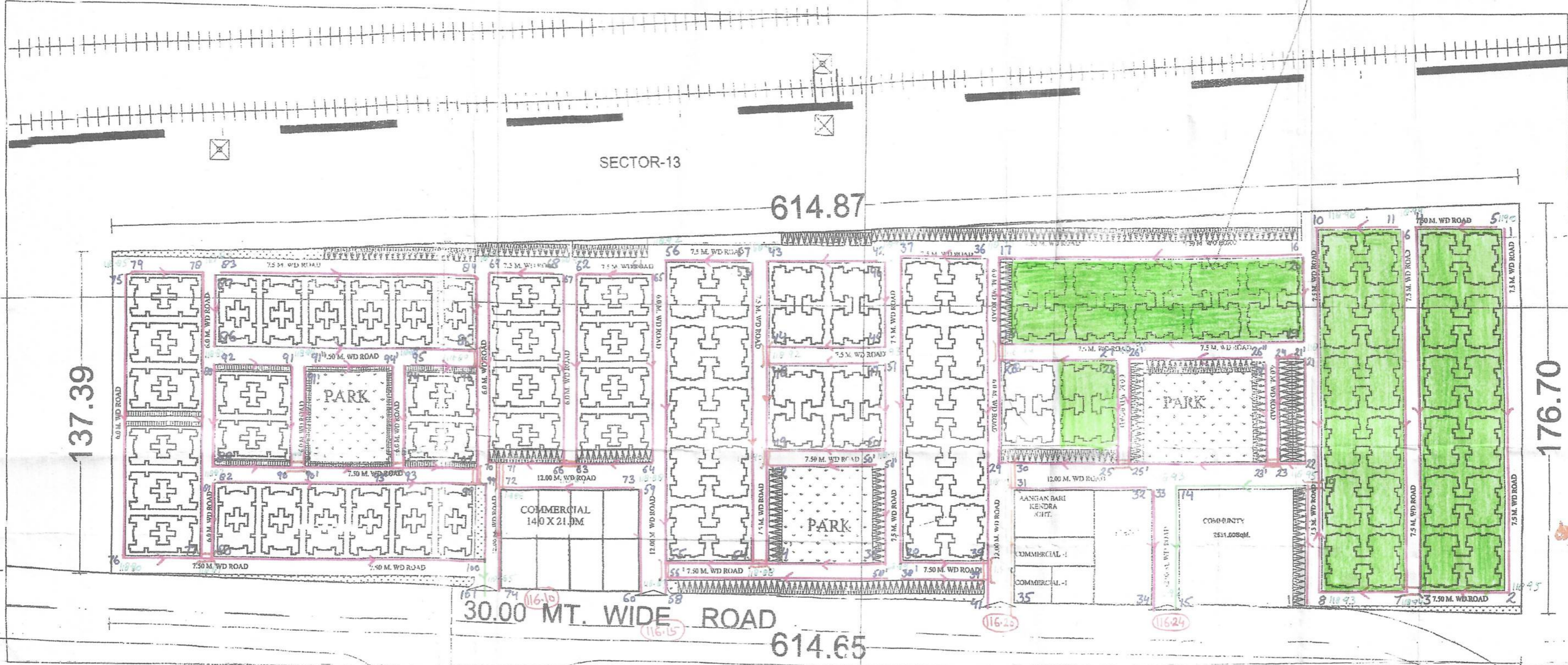

- INDEX:-
- Proposed LIG Houses
 - Proposed Drain as per Design
- INDEX
- Invert Level
 - Grade of Trunk-drain
 - CK
 - C1
 - C2
 - CUL

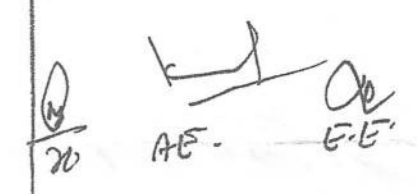

<p>SEVOTTAM</p>	<p>UPAVP</p> <p>ARCHITECTURE AND PLANNING UNIT-5</p> <p>NEELGIRI COMPLEX,</p> <p>INDIRA NAGAR LUCKNOW</p> <p>Email : uphdb@sachamtel.in</p>	<p>NOTE :-</p> <p>THIS PART LAYOUT PLAN HAS BEEN PREPARED ON THE BASIS OF DEMAND RECEIVED FROM S.E. VRINDAVAN CIRCLE, VIDE HIS LETTER NO. 2412/M-14/233 DATED 05.10.2016 AND E.E. NK.-3 LETTER NO. 1495 / 2016 DT:07.10.2016</p>	<p>ARCHITECTURE & PLANNING UNIT-5</p> <p>U.P. AVAS EVAM VIKAS PARISHAD, LUCKNOW</p> <p>REVISED LAY OUT PLAN OF EWS AND LIG FLATS AT SECTOR-13, VRINDAVAN YOJNA, LUCKNOW, UP.</p> <p>SCALE: 5 2.5 0 5 10 15M.</p> <p>DATE: 30.11.2016</p> <p>VIBHA S./Krishna Kant</p> <p>A.I.A.</p> <p>ARCH.ASSTT.</p>	<p>MUKESH KUMAR RUHELA</p> <p>B.ARCH, M.PLANNING (HOUSING), A.I.T.P.</p> <p>ASSTT.ARCH. PLANNER</p> <p>SANJEEV KASHYAP</p> <p>B.PLANN, M.PLANN (ENVIRONMENTAL) A.I.T.P.</p> <p>ARCHITECT PLANNER</p>	<p>CHIEF ARCHITECT PLANNER</p> <p>RUDRA PRATAP SINGH</p> <p>I.A.S</p> <p>AVAS AYUKT</p>

WASTE (SEWAGE) DISPOSAL PLAN. Proposed L.I.G. Houses (576 No)

INDEX

टिप्पणी:-

- 1-मवन निर्माण उपविधि के प्रस्तर 2.1.5 के अनुसार ले-आउट में बोल्ट लाईन से चिन्हांकित सम्पत्ति रेखा के पंजीकरण हेतु निर्गत की जा रही है।
- 2-मानचित्र वैधता अवधि दिनांक-27.09.2023 से दिनांक-26.09.2028 है।

LEGEND:-

- 1.- 480 NOS E.W.S. FLATS ----- AREA=15876.62 Sqm.
- 1.- 576 NOS L.I.G. FLATS ----- AREA= 36197.83 Sqm.

- 1- 250 M M Φ
- 2- 300 M M Φ
- 3- 450 M M Φ

NOTE :

THIS REVISED LAYOUT / NUMBERING PLAN HAS BEEN PREPARED ON THE BASIS OF DEMAND RECEIVED FROM E.E. CD-LKO- 5 VIDE HIS LETTER NO-965, DATED-11-09-23, E.E. CD-LKO- 2 VIDE HIS LETTER NO-2118, DATED-25-09-23 AND S.E. VRINDAVAN CIRCLE, VIDE HIS LETTER NO. 3637, DATED-25-09-23.

27/09/23 वा0सहा0
 27/09/23 वा0सहा0
 27.09.23 वा0सहा0
 27.09.23 वा0सहा0

SECTOR-13

नोट:-प्रस्तावित अल्प आय वर्ग प्लैट (जी0+3) प्रकार-576 नग

नोट:-प्रस्तावित दुर्बल आय वर्ग प्लैट (जी0+3) प्रकार-480 नग

614.87

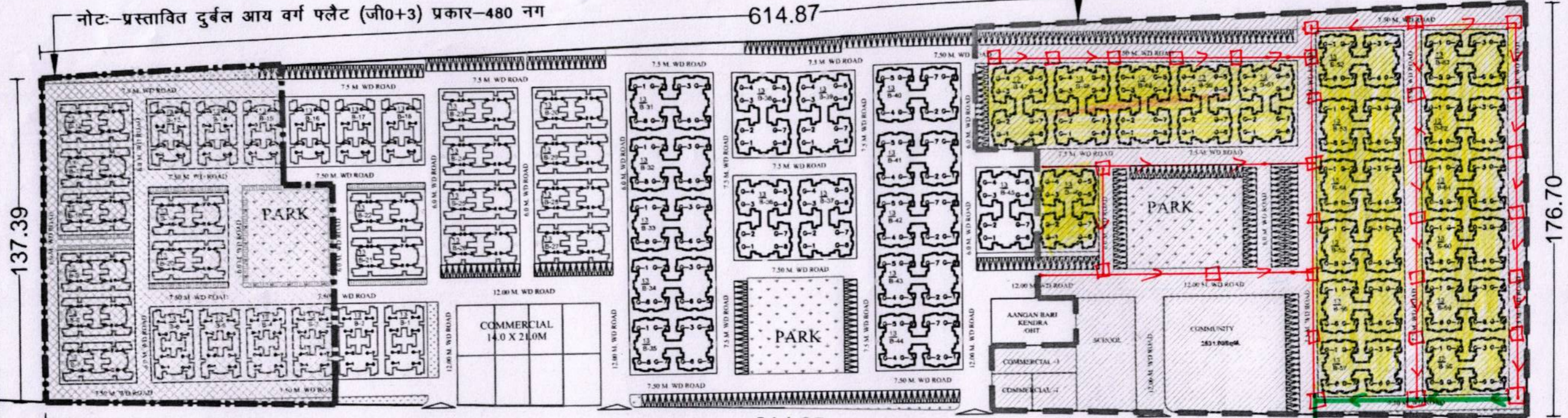

614.65

30.00 MT. WIDE ROAD

TYPICAL BLOCK NUMBERING PLAN-32 (L.I.G.) units

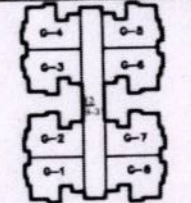

SECTOR	BLOCK	FLOOR	UNIT NUMBER
13	B-31	G.	1 TO 8
13	B-31	F.	9 TO 16
13	B-31	S.	17 TO 24
13	B-31	T.	25 TO 32

TYPICAL BLOCK NUMBERING PLAN-32 (E.W.S.) units

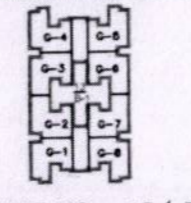

SECTOR	BLOCK	FLOOR	UNIT NUMBER
13	B-1	G.	1 TO 8
13	B-1	F.	9 TO 16
13	B-1	S.	17 TO 24
13	B-1	T.	25 TO 32

NOTE :
 THIS REVISED NUMBERING PLAN HAS BEEN PREPARED ON THE BASIS OF DEMAND RECEIVED FROM S.E. VRINDAVAN CIRCLE, VIDE HIS LETTER NO. 2572M-14/112, DATED- 04.11.2020.

ARCHITECTURE & PLANNING UNIT-6
 U.P. AVAS EVAM VIKAS PARISHAD, LUCKNOW
 REVISED LAYOUT/ NUMBERING PLAN OF EWS AND LIG FLAT'S AT SECTOR-13, VRINDAVAN YOJNA, LUCKNOW.

UPAVP
 ARCHITECTURE AND PLANNING UNIT-6
 NEELGIRI COMPLEX,
 INDIRA NAGAR LUCKNOW
 Email : uphnb@sachamat.in

FILE NO.- UPHDB/JUNIT-6/VRINDAVAN/SEC-13/40
 DRG.NO.- UPHDB/JUNIT-6/VRINDAVAN/SEC-13/40 EWS & LIG Flats/Sec-13/25/2023

DATE	VALID UP TO
09-11-2020	08-11-2025
CHECKED BY VIKRAM SINGH GAUTAM DIP.ARCH. ARCH.ASSTT.	SD - 09-11-2020
VIBHA SRIVASTAVA A.I.I.A ASSTT.ARCH.PLANNER	SD - 09-11-2020
VIKAS KUMAR B.ARCH ARCHITECT PLANNER	SD - 09-11-2020
DINESH KUMAR CHIEF ARCHITECT PLANNER	SD - 09-11-2020

VIKRAM SINGH GAUTAM
 VIBHA SRIVASTAVA
 VIKAS KUMAR
 DINESH KUMAR