

NOTES:-

1. ALL WORK SHALL BE IN ACCORDANCE WITH THE LATEST EDITIONS OF THE IS CODES.
2. THE CONTRACTOR SHALL BE RESPONSIBLE FOR OBTAINING ALL NECESSARY PERMITS AND APPROVALS FROM THE LOCAL AUTHORITIES.
3. THE CONTRACTOR SHALL MAINTAIN ACCESS TO ALL ADJACENT PROPERTIES AND PUBLIC UTILITIES AT ALL TIMES.
4. THE CONTRACTOR SHALL BE RESPONSIBLE FOR PROTECTING ALL EXISTING UTILITIES AND STRUCTURES.
5. THE CONTRACTOR SHALL MAINTAIN ADEQUATE DRAINAGE AND FLOOD CONTROL MEASURES THROUGHOUT THE CONSTRUCTION PERIOD.
6. THE CONTRACTOR SHALL BE RESPONSIBLE FOR THE PROTECTION AND RESTORATION OF ALL VEGETATION AND LANDSCAPE FEATURES.
7. THE CONTRACTOR SHALL MAINTAIN ADEQUATE SAFETY MEASURES AND SIGNAGE AT ALL TIMES.
8. THE CONTRACTOR SHALL BE RESPONSIBLE FOR THE PROTECTION AND RESTORATION OF ALL EXISTING UTILITIES AND STRUCTURES.
9. THE CONTRACTOR SHALL MAINTAIN ADEQUATE DRAINAGE AND FLOOD CONTROL MEASURES THROUGHOUT THE CONSTRUCTION PERIOD.
10. THE CONTRACTOR SHALL BE RESPONSIBLE FOR THE PROTECTION AND RESTORATION OF ALL VEGETATION AND LANDSCAPE FEATURES.

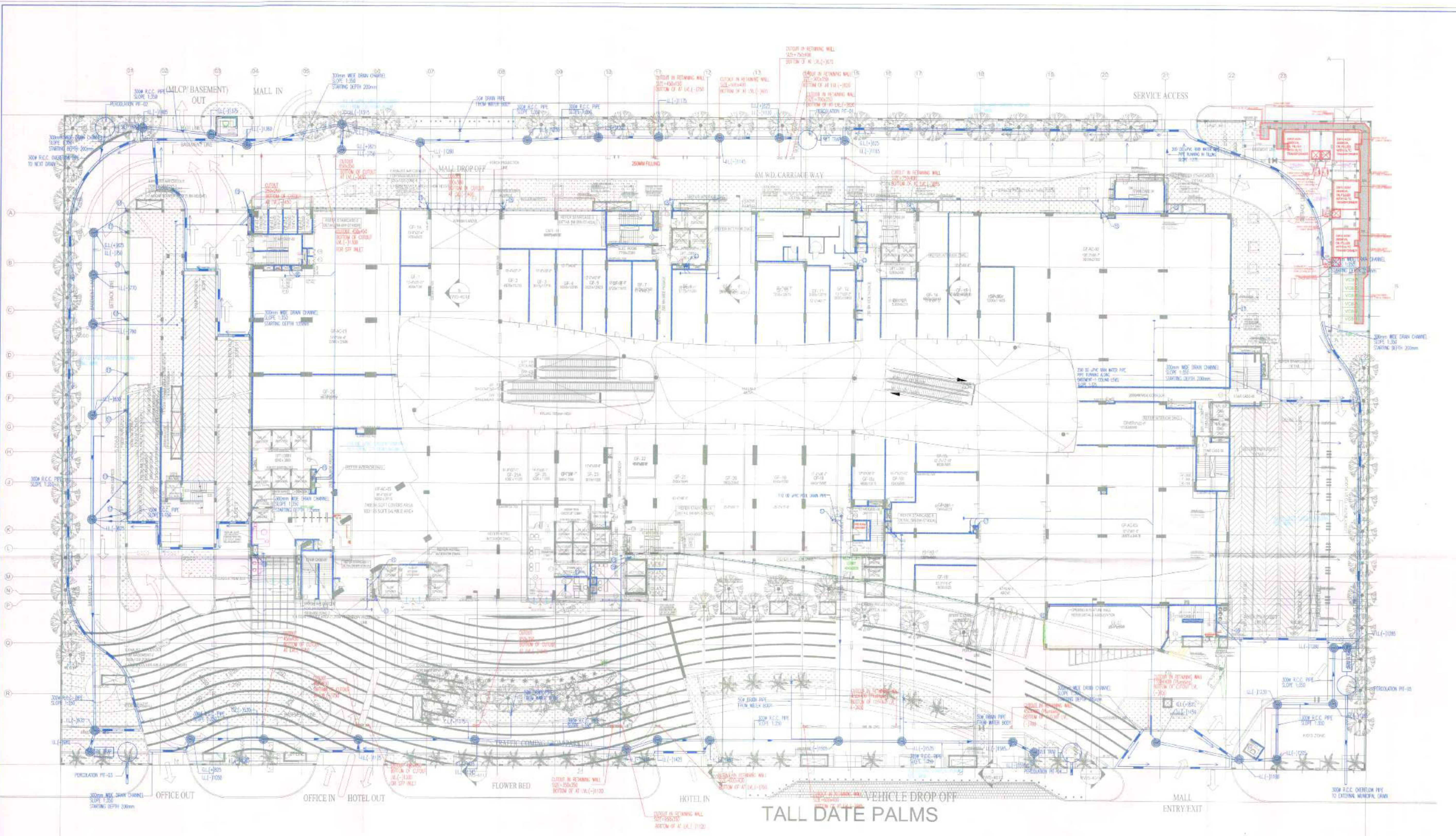

DRAWING STATUS:
FOR INFORMATION ONLY



For Legal Response with M/s. P. Ltd.
Auth. Signature



OPTIMIZATION CONSULTANTS
M/S. P. CONSULTING ENGINEERS
200-201, HUDA ROAD, SECTOR-16, GROUND FLOOR, GATE NO. 16, NOIDA-201301, U.P., INDIA
M/S. P. CONSULTING ENGINEERS
B-50, Basement, Siam Nagar, New Delhi-110017
Tel: No: 011-49548197, 49548205
Email: info@pconsulting.com

PROJECT:
M/S. BOULEVARD WALK INFRATECH PVT. LTD.
14.6 OPP. AXIS BANK, SECTOR-16, NOIDA (U.P.)

CLIENT:
M/S. BOULEVARD WALK INFRATECH PVT. LTD.
14.6 OPP. AXIS BANK, SECTOR-16, NOIDA (U.P.)

ARCHITECT:
modarchindia
architecture interior environmental
Plot no- B-99 First Floor, sec-63 Noida
PHONE NO: 0120426233

Drawing Title:
SITE PLAN DRAINAGE LAYOUT
DATE: 12.06.2024
SCALE: 1:500
M/BW/PL-048

NOTES:

1. ALL SEWER LINES SHALL BE 150MM DIA UNLESS OTHERWISE SPECIFIED.
2. ALL SEWER LINES SHALL BE 150MM DIA UNLESS OTHERWISE SPECIFIED.
3. ALL SEWER LINES SHALL BE 150MM DIA UNLESS OTHERWISE SPECIFIED.
4. ALL SEWER LINES SHALL BE 150MM DIA UNLESS OTHERWISE SPECIFIED.
5. ALL SEWER LINES SHALL BE 150MM DIA UNLESS OTHERWISE SPECIFIED.
6. ALL SEWER LINES SHALL BE 150MM DIA UNLESS OTHERWISE SPECIFIED.
7. ALL SEWER LINES SHALL BE 150MM DIA UNLESS OTHERWISE SPECIFIED.
8. ALL SEWER LINES SHALL BE 150MM DIA UNLESS OTHERWISE SPECIFIED.
9. ALL SEWER LINES SHALL BE 150MM DIA UNLESS OTHERWISE SPECIFIED.
10. ALL SEWER LINES SHALL BE 150MM DIA UNLESS OTHERWISE SPECIFIED.
11. ALL SEWER LINES SHALL BE 150MM DIA UNLESS OTHERWISE SPECIFIED.
12. ALL SEWER LINES SHALL BE 150MM DIA UNLESS OTHERWISE SPECIFIED.
13. ALL SEWER LINES SHALL BE 150MM DIA UNLESS OTHERWISE SPECIFIED.
14. ALL SEWER LINES SHALL BE 150MM DIA UNLESS OTHERWISE SPECIFIED.
15. ALL SEWER LINES SHALL BE 150MM DIA UNLESS OTHERWISE SPECIFIED.
16. ALL SEWER LINES SHALL BE 150MM DIA UNLESS OTHERWISE SPECIFIED.
17. ALL SEWER LINES SHALL BE 150MM DIA UNLESS OTHERWISE SPECIFIED.
18. ALL SEWER LINES SHALL BE 150MM DIA UNLESS OTHERWISE SPECIFIED.
19. ALL SEWER LINES SHALL BE 150MM DIA UNLESS OTHERWISE SPECIFIED.
20. ALL SEWER LINES SHALL BE 150MM DIA UNLESS OTHERWISE SPECIFIED.
21. ALL SEWER LINES SHALL BE 150MM DIA UNLESS OTHERWISE SPECIFIED.
22. ALL SEWER LINES SHALL BE 150MM DIA UNLESS OTHERWISE SPECIFIED.
23. ALL SEWER LINES SHALL BE 150MM DIA UNLESS OTHERWISE SPECIFIED.
24. ALL SEWER LINES SHALL BE 150MM DIA UNLESS OTHERWISE SPECIFIED.
25. ALL SEWER LINES SHALL BE 150MM DIA UNLESS OTHERWISE SPECIFIED.

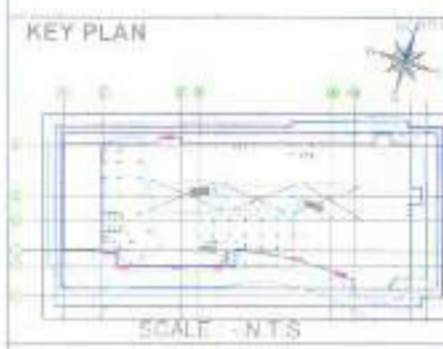

DRAWING STATUS
FOR INFORMATION ONLY

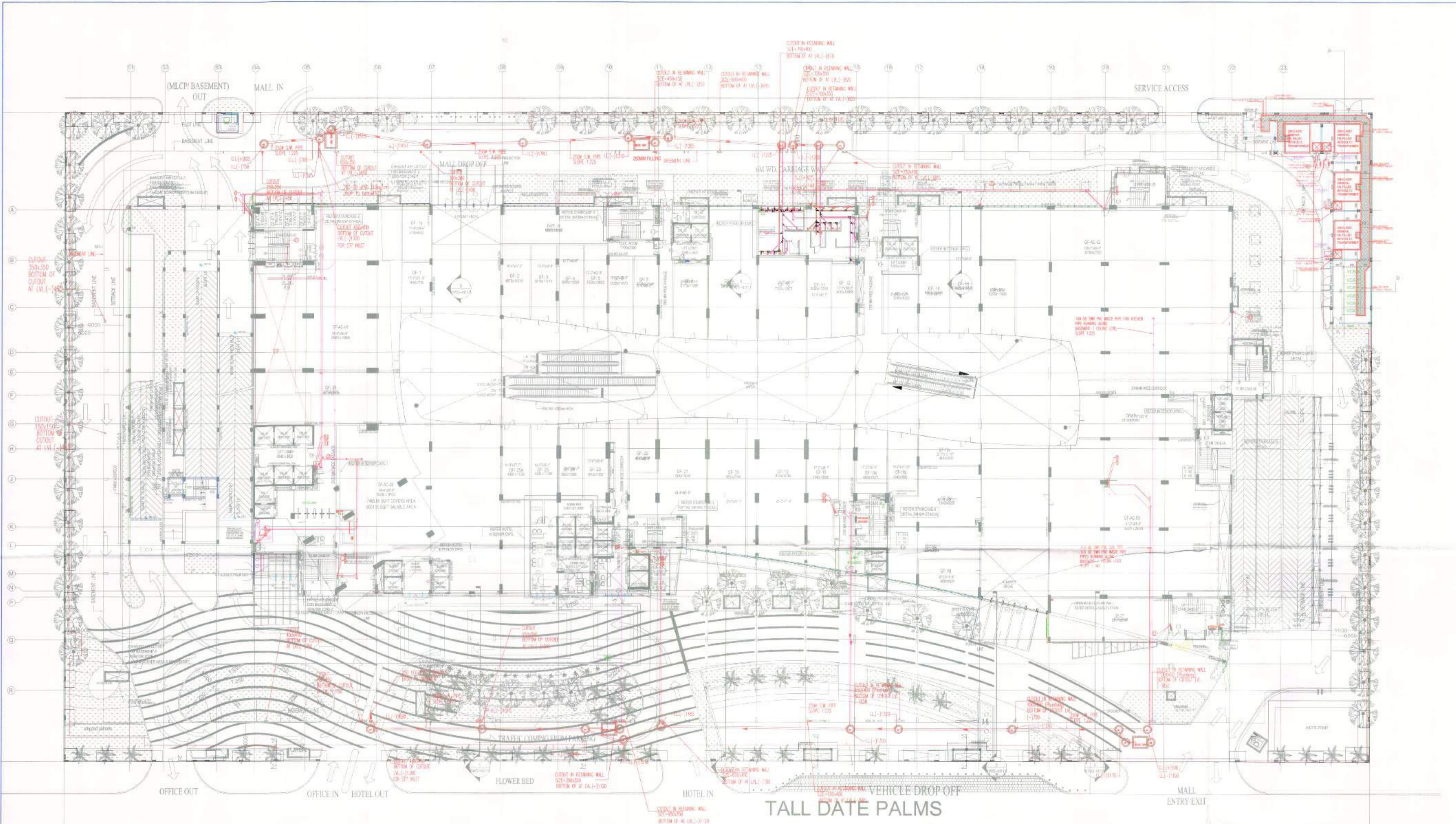

For Regal Interiors Pvt. Ltd. & Co. Ltd.
Auth. Signature



STRUCTURAL ENGINEERING
OPTIMIZATION CONSULTANTS
402/298, HANUMANI MANSION, 4TH FLOOR, HANUMANI MANSION, NEW DELHI, INDIA
MEP Consultant

Consulting
B-56, Basement, Scans Nagar
New Delhi-110017
Tel No: 81143845137, 43842305
Email: info@vvcconsulting.co.in

PROJECT
BOULEVARD WALK MALL AT PLOT NO. C-02
SECTOR - 04, GREATER NOIDA (U.P.)

OWNER
M/S BOULEVARD WALK INFOTECH PVT.LTD.
115, GPF AXIS BANK, SECTOR - 18,
NOIDA (U.P.)

ARCHITECT
modarchindia
architecture interior environmental
Plot no: B-99 First Floor, sec-63 Noida
PHONE NO: 01204206253

Drawing Title
SITE PLAN
SEWERAGE LAYOUT
Date: 10.08.2018
Scale: 1:500
Project: ME-60/PL-066