

24MT SERVICE ROAD

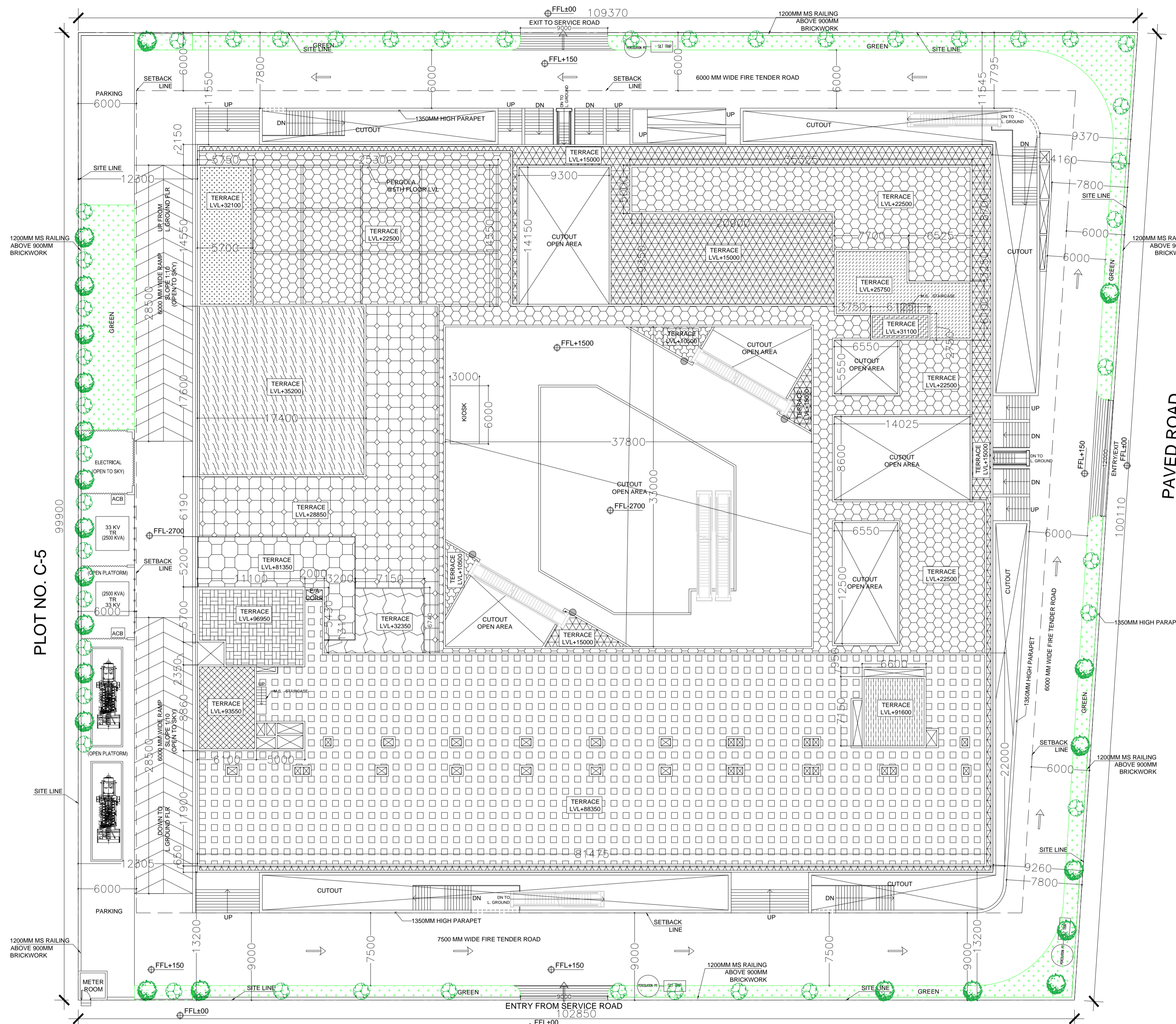

SITE PLAN

130M WIDE ROAD

NOTES

- THIS DEVELOPMENT HAS BEEN CONCEIVED, DESIGNED AND DRAFTED ON THE BASIS OF THE FOLLOWING
1. ALL USEABLE OFFICE SPACES/RETAIL SPACES (LIKE SHOP AREAS, ENTERTAINMENT AND ATRIUM) WILL BE CENTRALLY AIR-CONDITIONED. THEREFORE, NO PROVISION HAS BEEN MADE FOR NATURAL VENTILATION OF SPACES.
 2. ALL TOILETS WILL BE MECHANICALLY (PROVISION OF HVAC) VENTILATED. CONDITIONED AIR FROM THE FLOOR WILL BE SUCKED IN TO THE TOILETS AND VENTED OUT THROUGH A VENT SHAFT
 3. ALL SPACES (RETAIL SPACES, SERVICE AREAS, PARKING BASEMENT, ETC) WILL BE ARTIFICIALLY LIT.
 4. 100% STANDBY GENERATING CAPACITY WILL BE PROVIDED FOR THE ENTIRE ELECTRICAL REQUIREMENT OF THE TOTAL SCHEME. THIS THEREFORE INCLUDES STANDBY GENERATION FOR ALL COMMON SERVICES, FIRE SERVICES, LIFTS ETC.
 5. BASEMENT WILL BE MECHANICALLY (PROVISION OF HVAC) VENTILATED.
 6. THIS BUILDING WILL BE SPRINKLED AS PER NBC NORMS.
 7. HANDICAP RAMP WITH RAILING PROVIDED.
 8. ALL NON-TOWER SLABS ARE STRUCTURALLY DESIGNED AS PER FIRE TENDER LOAD.
 9. THE PUBLIC HEALTH SERVICES I.E. WATER SUPPLY, SEWERAGE, STORM WATER, DRAINAGE/RAIN WATER HARVESTING SCHEMES WILL BE PROVIDED AS PER PUBLIC HEALTH NORMS.
 10. THE STRUCTURE OF THE BUILDING SHALL BE DESIGNED AND SUPERVISED BY A QUALIFIED STRUCTURAL ENGINEER AND A CERTIFICATE TO THIS EFFECT BE FURNISHED AT THE TIME OF SEEKING FULL COMPLETION CERTIFICATE OF THE BUILDING.
 11. THE OWNER SHALL BE PROVIDED WITH FIRE FIGHTING SYSTEM BEFORE OCCUPYING THE BUILDING A CERTIFICATE OF COMPLIANCE FROM THE FIRE DEPARTMENT WILL BE FURNISHED AT THE TIME OF SEEKING FULL COMPLETION OF THE BUILDING.

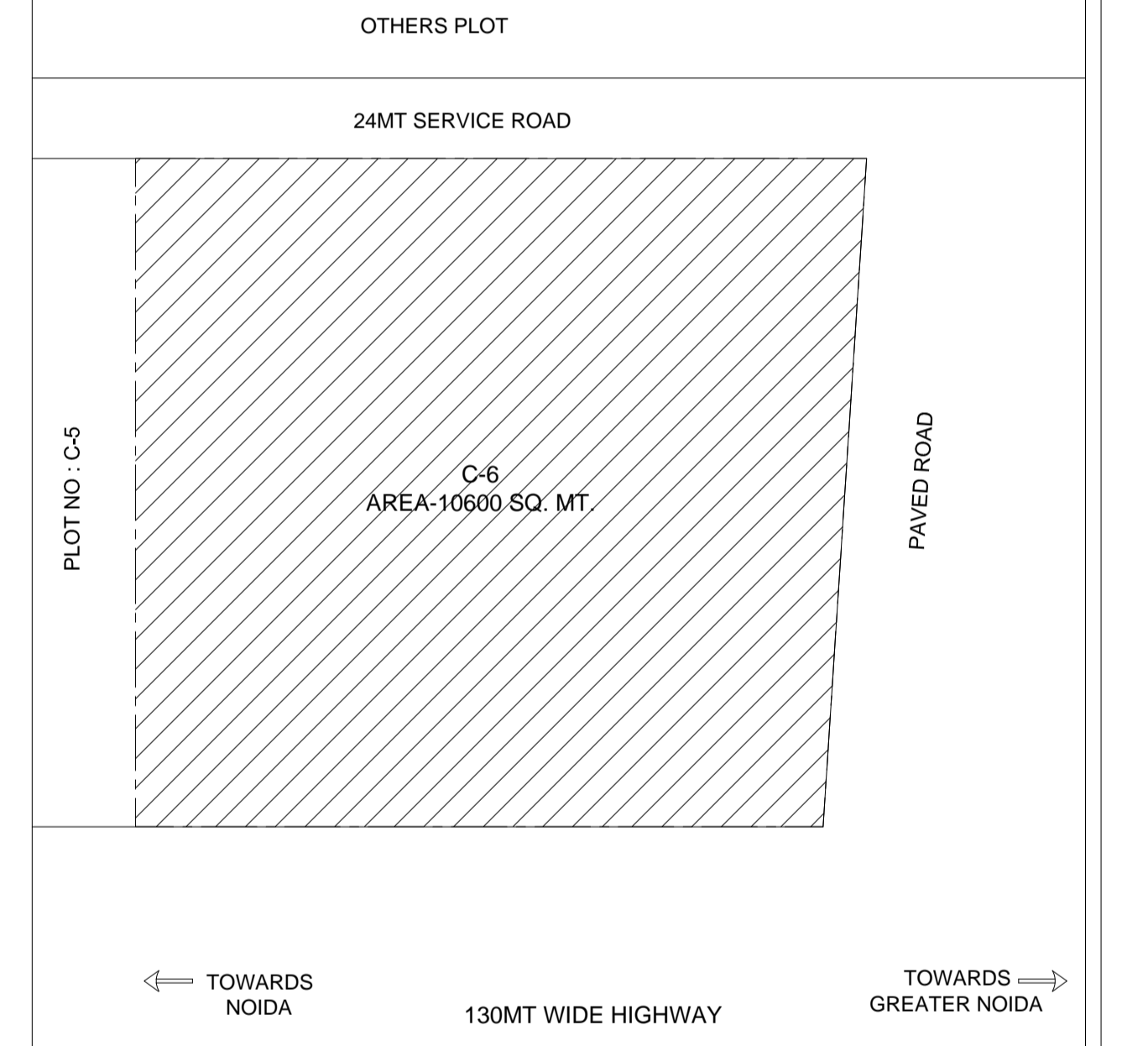

OWNER'S SIGN _____ ARCHITECT'S SIGN _____

CLIENT:
PARTH BUILTECH PVT.LTD.

PROJECT:
**NIRALA DIADEM
AT PLOT NO. C-6, SECTOR-10, GR. NOIDA WEST**

TITLE
SANCTION DRAWINGS ELECTRICITY SUPPLY PLAN

THIS DRAWING IS THE PROPERTY OF GIAN P. MATHUR & ASSO. (H) LTD AND SHALL NOT BE USED, COPIED OR REPRODUCED WITHOUT THEIR WRITTEN PERMISSION

DEALT **SUGANDHA**
CHKD **RAHUL**

GIAN P. MATHUR AND ASSOCIATES (H) LTD.
C - 55, East Of Kailash, New Delhi-110065
T : 46599599 | F 46599512
E : info@gpmindia.com | W : www.gpmindia.com

SCALE - 1:200 DRG.NO. -